

REVISIONS

ISS	ZONE	DESCRIPTION\PER REQUEST\DATE

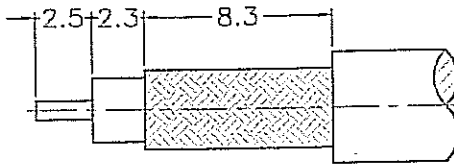

RECOMMENDED
CABLE STRIPPING DIM'S
(建議剝線尺寸)

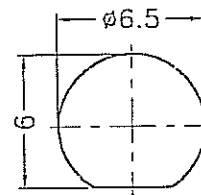

RECOMMENDED
MOUNTING HOLE
(建議架設孔)

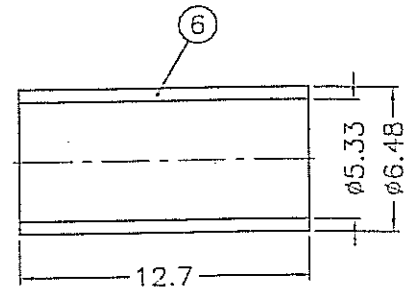
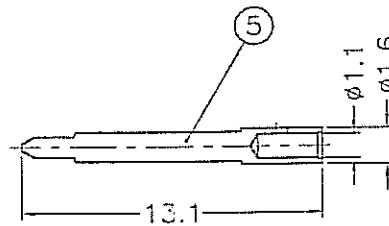
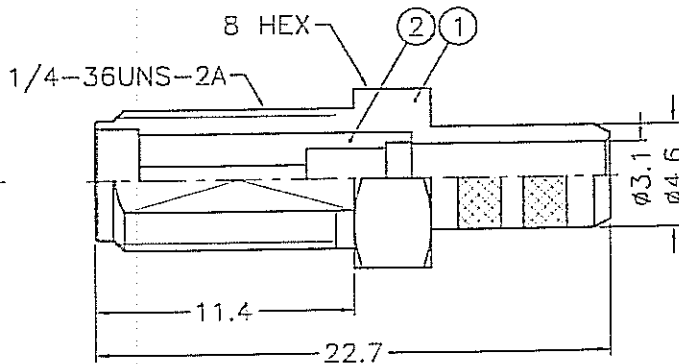
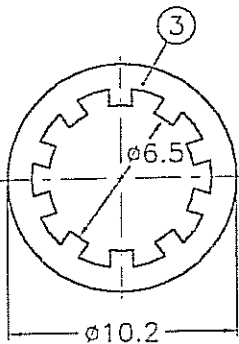
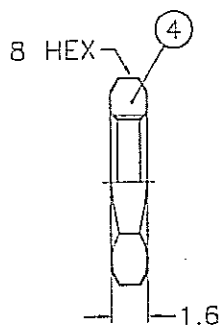

NOTES: FINISH (PLATING THICKNESS IN MICRO-INCHES)

1. BRASS PER QQ-B-626
2. BRASS PER QQ-B-613
3. GOLD PL. 3 MIN. THICK OVER NICKEL PL. 100 MIN. THICK OVER COPPER STRIKE
4. GOLD PL. 50 MIN. THICK OVER NICKEL PL. 100 MIN. THICK OVER COPPER STRIKE
5. TEFLON MIL-P-1946B

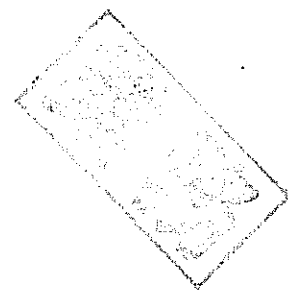

NO.	DESCRIPTION	MATERIAL	FINISH	Q'TY	DRAWING NO.
6	FERRULE	COPPER	NOTE 3	1	FR-648/533X 127C
5	CONTACT PIN	NOTE 1	NOTE 4	1	RSMA6111A2-3- 16/11
4	HEX NUT	NOTE 1	NOTE 3	1	HNS-1/4-36X16
3	LOCK WASHER	NOTE 2	NOTE 3	1	LW-102/65X05
2	INSULATOR	NOTE 5	NATURAL	1	SMA7000-2T-50
1	BODY	NOTE 1	NOTE 3	1	SMA7400-1-46/ 31-C

DIMENSIONS ARE IN MILLIMETERS
UNLESS OTHERWISE SPECIFIED TOLERANCES
0.5-6 = ±0.2
6-30 = ±0.4
30-120 = ±0.6
120-315 = ±1
315-1000 = ±1.6
1000-2000 = ±2.4

PART NO.	
APPROVED <i>Tony</i>	DATE 11-15-02'
CHECKED <i>Boeder</i>	DATE 11-15-02'
DRAWN <i>Dicker</i>	DATE 11-15-02'

Amphenol	
Danbury,CT,USA-Tainan,Taiwan-Shenzhen,China	
TITLE	SMA REVERSE POLARITY BULKHEAD CRIMP JACK (FOR RG-58C/U, 58/U)
DRAWING NO.	RSMA6411A1-3GT50G-58U-50
FILE NO.	F:\DWG\RSMA\6411A1\58U-50\3GT50GSZ