

Female insert - VS-MSTBAH 2,5/ 5-GB-5,08-BK-A - 1657915

Please be informed that the data shown in this PDF Document is generated from our Online Catalog. Please find the complete data in the user's documentation. Our General Terms of Use for Downloads are valid (<http://download.phoenixcontact.com>)

MSTB contact insert, for PCB assembly, 24 V, 5-pos., with angled solder pins, RAL 9005 (black), for panel mounting frame VS-PPC-F2-MSTB-...-1R-P



Key commercial data

Packing unit	50 pc
GTIN	 4 046356 132497
Weight per Piece (excluding packing)	2.6 g
Custom tariff number	85366990
Country of origin	Germany

Technical data

Mechanical characteristics

Number of positions	5
Insertion/withdrawal cycles	≥ 100
Connection method	Printed circuit connection
Color	black

Ambient conditions

Ambient temperature (operation)	-40 °C ... 70 °C
---------------------------------	------------------

Material data

Inflammability class according to UL 94	V0
Contact carrier material	PBT
Contact material	Copper alloy
Contact surface material	Gold over nickel

Electrical characteristics

Number of positions	5
Rated current	16 A

Female insert - VS-MSTBAH 2,5/ 5-GB-5,08-BK-A - 1657915

Classifications

eCl@ss

eCl@ss 4.0	272607xx
eCl@ss 4.1	27260701
eCl@ss 5.0	27260701
eCl@ss 5.1	27260701
eCl@ss 6.0	27261204
eCl@ss 7.0	27440205
eCl@ss 8.0	27440205

ETIM

ETIM 3.0	EC000438
ETIM 4.0	EC000438
ETIM 5.0	EC000438

UNSPSC

UNSPSC 6.01	31261501
UNSPSC 7.0901	31261501
UNSPSC 11	31261501
UNSPSC 12.01	31261501
UNSPSC 13.2	31261501

Approvals

Approvals

Approvals

UL Recognized / cUL Recognized / GOST / cULus Recognized

Ex Approvals

Approvals submitted

Approval details

UL Recognized 	
Nominal current I _N	16 A
Nominal voltage U _N	24 V

Female insert - VS-MSTBAH 2,5/ 5-GB-5,08-BK-A - 1657915

Approvals

cUL Recognized	
Nominal current I _N	16 A
Nominal voltage U _N	24 V

GOST	
------	--

cULus Recognized	
------------------	--

Accessories

Accessories

Panel mounting frame

Panel mounting frames - VS-PPC-F2-MSTB-MNNA-1R-P - 1608087



MSTB panel mounting frame, IP67, for push-pull interlocking, metal, for PCB connection, for square panel cutout, with grommet, without mounting screws

Panel mounting frames - VS-PPC-F2-MSTB-POBK-1R-P - 1608281



MSTB panel mounting frame, IP67, for push-pull interlocking, plastic, for PCB connection, for square panel cutout, with grommet, without mounting screws

Drawings

Female insert - VS-MSTBAH 2,5/ 5-GB-5,08-BK-A - 1657915

Dimensioned drawing

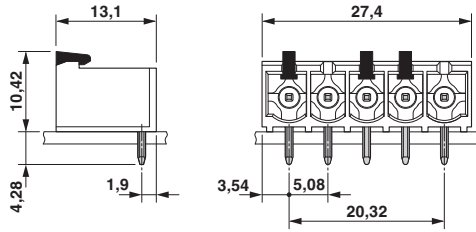

MSTB contact insert

Drilling diagram

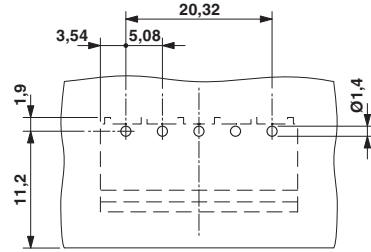

Drilling diagram