

Datasheet

Insulated Female Crimp Bullet Connector

RS Stock number [624-1263](#)

Drawing(mm):

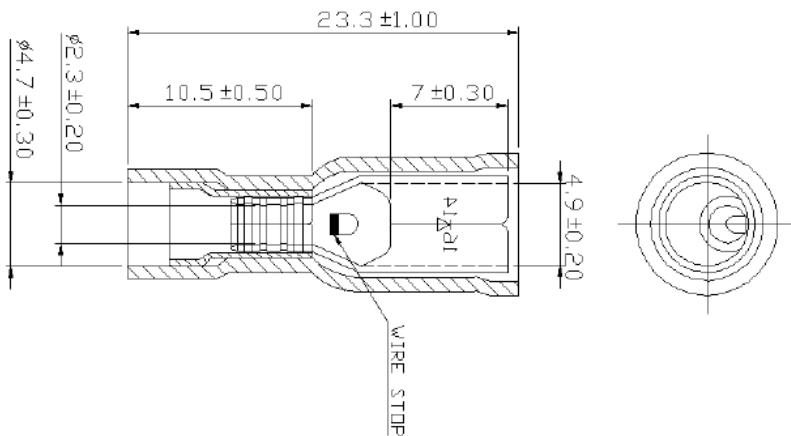

Specifications:

Max. Electrical Current:	A.W.G: 16 14
	Amp: 10 15
Max. Electrical Rating:	75°C 600 volts
Insulation Material:	Vinyl
Insulation Colour:	Blue
Terminal Material:	Brass
Wire Range:	16-14 A.W.G (1.5 – 2.5mm ²)
Terminal Surface Treatment:	Tin Plated
Double Crimp:	With copper sleeve on barrel
Terminals Thickness:	0.40mm