

UNO UNIVERSAL PLUG

Truly universal plug which fixes into any base material, solid or hollow.



Product information

Features and benefits

- Unique geometry guarantees maximum expansion and grip.
- Instant grip resulting from split plug design.
- Anti-rotation features prevent spinning in the hole.
- Lip prevents plug slipping into over-sized holes.

Applications

- Shelves
- Suspended ceilings
- Electrical fittings
- Cable trays
- Boilers
- Radiators
- Lighting
- Bathroom fittings

Base materials

Suitable for use in:

- Concrete
- Hollow-core Slab
- High-Density Natural Stone
- Solid Brick
- Solid Sand-lime Brick
- Hollow Brick
- Vertically-perforated clay block
- Lightweight Concrete Block
- Hollow Lightweight Concrete Block
- Aerated Concrete Block
- Plasterboard

Installation guide

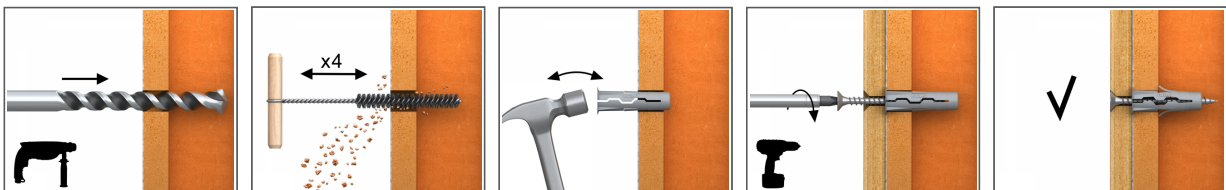

1. Drill a hole of required diameter.
2. Insert UNO plug into hole and tap home.
3. Insert screw of required diameter into plug through fixture and tighten.

Product information

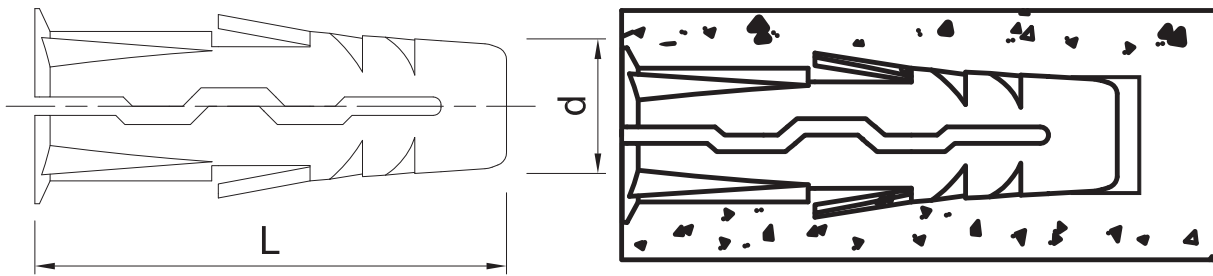

Size	Product Code	Plug		Screw		Fixture	
		Diameter	Length	Diameter	Length	Max. thickness	Hole diameter
		d	L	d	L	t _{fix}	d _f
[mm]							
Ø5	UNO-K-05	5	24	3	25 - 40	1 - 16	4
		-	-	3.5	25 - 50	1 - 26	4
		-	-	4	25 - 80	1 - 56	5
		-	-	4.5	25 - 80	1 - 56	5
Ø6	UNO-K-06	6	28	3.5	25 - 50	1 - 22	4
		-	-	4	25 - 80	1 - 52	5
		-	-	4.5	25 - 80	1 - 52	5
		-	-	5	30 - 260	1 - 232	6
Ø7	UNO-K-07	7	30	4	25 - 80	1 - 50	5
		-	-	4.5	25 - 80	1 - 50	5
		-	-	5	30 - 260	1 - 230	6
		-	-	6	30 - 200	1 - 170	7
Ø8	UNO-K-08	8	32	4.5	25 - 80	1 - 48	5
		-	-	5	30 - 260	1 - 228	6
		-	-	6	30 - 200	1 - 168	7
Ø10	UNO-K-10	10	36	5	30 - 260	1 - 224	6
		-	-	6	30 - 260	1 - 224	7
		-	-	8	30 - 260	1 - 224	9

Installation data

Size			Ø5	Ø6	Ø7	Ø8	Ø10
Fixing diameter	d	[mm]	5	6	7	8	10
Hole diameter in substrate	d ₀	[mm]	5	6	7	8	10
Min. hole depth in substrate	h ₀	[mm]	34	38	40	42	46
Installation depth	h _{nom}	[mm]	24	28	30	32	36
Min. substrate thickness	h _{min}	[mm]	50	55	60	65	70
Min. spacing	s _{min}	[mm]	24	28	30	32	36
Min. edge distance	c _{min}	[mm]	24	28	30	32	36

Basic performance data

Performance data for single fixing in tension without influence of edge distance and spacing

Substrate	Concrete C20/25	Solid clay brick 15MPa	Aerated concrete 600 Mark V	Hollow brick 15MPa	Perforated brick 15MPa	Plasterboard min. 12.5 mm	
MEAN ULTIMATE LOAD N_{Ro,m}							
Plug Ø5 + screw Ø3.5	[kN]	1.77	0.79	0.28	0.94	0.62	0.24
Plug Ø6 + screw Ø3.5	[kN]	1.63	1.18	0.73	0.87	0.72	0.30
Plug Ø7 + screw Ø4.0	[kN]	1.67	0.88	0.86	1.32	0.87	0.37
Plug Ø8 + screw Ø4.5	[kN]	2.49	1.39	0.84	1.15	0.94	0.40
Plug Ø10 + screw Ø5.0	[kN]	6.81	1.50	0.73	1.42	1.66	0.45

Basic performance data

Substrate		Concrete C20/25	Solid clay brick 15MPa	Aerated concrete 600 Mark V	Hollow brick 15MPa	Perforated brick 15MPa	Plasterboard min. 12.5 mm
CHARACTERISTIC LOAD N_{rk}							
Plug Ø5 + screw Ø3.5	[kN]	1.39	0.47	0.27	0.72	0.39	0.17
Plug Ø6 + screw Ø3.5	[kN]	1.48	0.85	0.63	0.51	0.21	0.21
Plug Ø7 + screw Ø4.0	[kN]	0.89	0.32	0.51	0.71	0.60	0.25
Plug Ø8 + screw Ø4.5	[kN]	1.25	0.68	0.48	0.95	0.81	0.26
Plug Ø10 + screw Ø5.0	[kN]	3.59	0.69	0.42	1.18	0.92	0.34
DESIGN LOAD N_{Rd}							
Plug Ø5 + screw Ø3.5	[kN]	0.77	0.19	0.13	0.29	0.15	0.07
Plug Ø6 + screw Ø3.5	[kN]	0.82	0.34	0.31	0.20	0.20	0.08
Plug Ø7 + screw Ø4.0	[kN]	0.49	0.13	0.25	0.28	0.24	0.10
Plug Ø8 + screw Ø4.5	[kN]	0.69	0.38	0.24	0.38	0.32	0.10
Plug Ø10 + screw Ø5.0	[kN]	1.99	0.38	0.21	0.47	0.37	0.13
RECOMMENDED LOAD N_{rec}							
Plug Ø5 + screw Ø3.5	[kN]	0.55	0.14	0.09	0.21	0.11	0.05
Plug Ø6 + screw Ø3.5	[kN]	0.59	0.24	0.22	0.14	0.14	0.06
Plug Ø7 + screw Ø4.0	[kN]	0.35	0.09	0.18	0.20	0.17	0.07
Plug Ø8 + screw Ø4.5	[kN]	0.49	0.27	0.17	0.27	0.23	0.07
Plug Ø10 + screw Ø5.0	[kN]	1.42	0.27	0.15	0.34	0.26	0.09

Product commercial data

Size	Product Code	Plug		Screw	Quantity [pcs]			Weight [kg]			Bar Codes	Art No.
		Diameter [mm]	Length [mm]		Box	Outer	Pallet	Box	Outer	Pallet		
Ø5	UNO-K-05	5	24	25 - 40	200	4800	153600	0.32	7.7	275.8	5906675009513	63088
Ø6	UNO-K-06	6	28	25 - 50	200	4800	153600	0.32	7.7	275.8	5906675009544	63091
Ø7	UNO-K-07	7	30	25 - 80	100	2400	76800	0.32	7.7	275.8	5906675009575	63093
Ø8	UNO-K-08	8	32	25 - 80	100	2400	76800	0.32	7.7	275.8	5906675009599	63098
Ø10	UNO-K-10	10	36	30 - 260	50	1200	38400	0.32	7.7	275.8	5906675009612	63101