

Deep groove ball bearings, single row, SKF Energy Efficient (E2) bearings

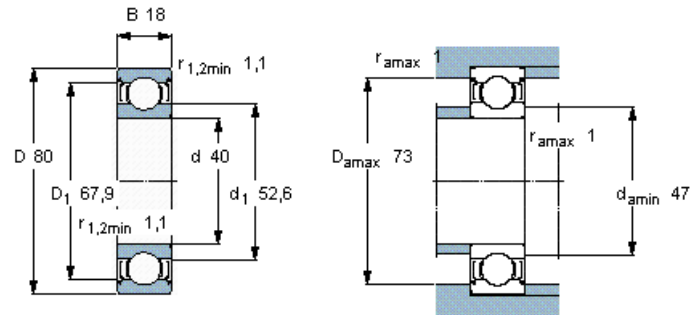

Principal dimensions			Basic load ratings		Fatigue load limit P_u	Speed ratings		Mass	Designation
d	D	B	dynamic	static		Reference speed	Limiting speed		
mm			kN		kN	r/min		kg	-
40	80	18	30,7	18,6	0,78	19000	10000	0,37	E2.6208-2Z/C3



Calculation factors

k_r 0,025
 f_0 14