



Polymer
Optics
Limited

Our Focus is in Plastics

Polymer Optics Ltd.

6 Kiln Ride, Wokingham,
Berks., RG40 3JL, England
Tel/Fax: +44 (0) 1189 893341
www.polymer-optics.co.uk

60mm Reflector Collimator for Cree MPL LED - Part No. 274



- Designed for Cree MPL LEDs
- High light collection efficiency of >85%
- Precision moulded using POL's patent applied for metallised optical insert moulding technique with a polycarbonate frame construction for superior mechanical and thermal stability
- Also available for other Cree LED package types

The 274 60mm Reflector Optic base is designed to locate into the Cree MPL LED package and align to the LED array. The optic base can be simple attached to the PCB using Loctite 460 specialist adhesive, or a similar adhesive type that won't affect the plastic components.

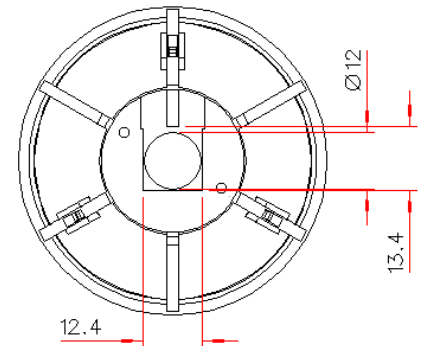
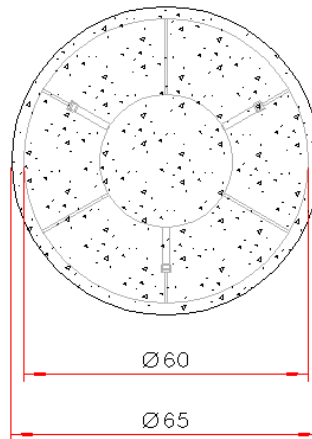
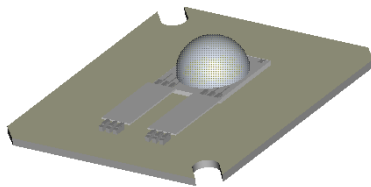
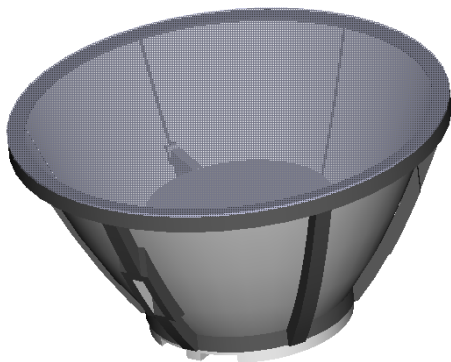

ORIENTATION OF BASE TO MPL LED PACKAGE

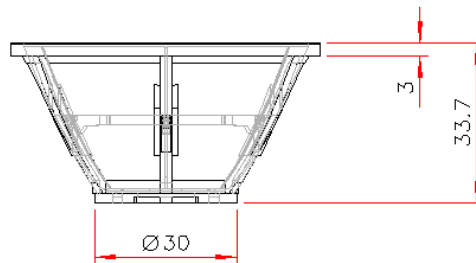

Typical dimensional tolerances to +/-0.2mm



Our Focus is in Plastics

Polymer Optics Ltd.

6 Kiln Ride, Wokingham,
Berks., RG40 3JL, England
Tel/Fax: +44 (0) 1189 893341
www.polymer-optics.co.uk

60mm Reflector Collimator for Cree MPL LED - Part No. 274



The POL 274 optic's narrow, high intensity beam is ideal for demanding applications, such as:

- ✓ General lighting – spots and down-lights
- ✓ Architectural spot lights
- ✓ Theatrical lights and follow-spots
- ✓ High level flood lights
- ✓ Street lights
- ✓ Medical lighting applications

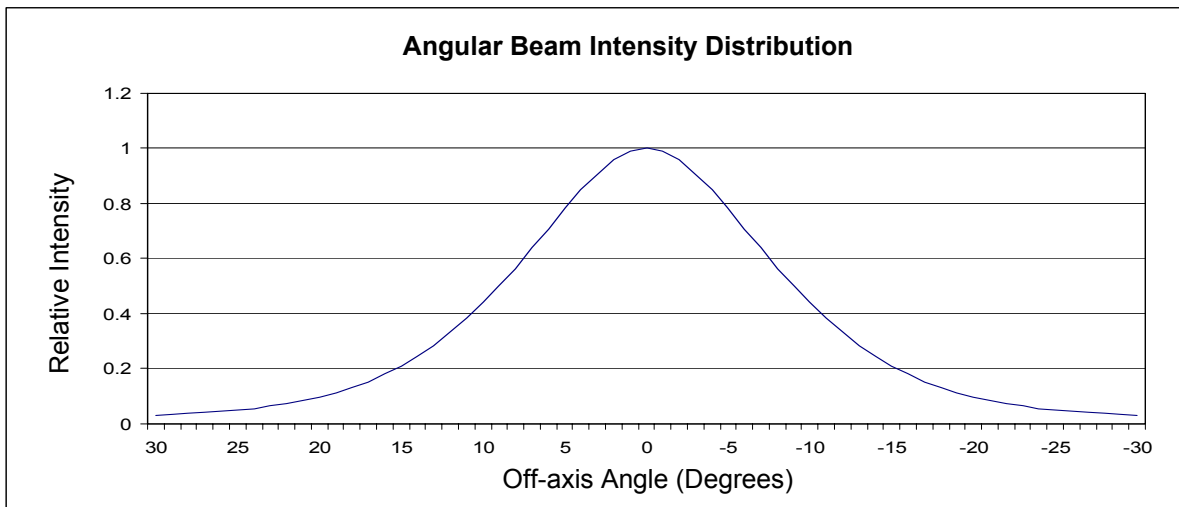

Typical illuminance values using 1200 lumen Cree MPL LED = 4 cd/lumen			
Range	0.5m	1m	2m
Illuminance	19200 lux	4800 lux	1200 lux

Performance values given are typical values and will vary dependant on LED binning, colour and drive profile