

## DETAILS

<b>Product Number</b>	FA11212_TINA-RS
<b>Family</b>	Tina
<b>Type</b>	Assembly
<b>Color</b>	black
<b>Diameter</b>	16,1 mm
<b>Height</b>	9,4 mm
<b>Style</b>	round
<b>Optic Material</b>	PMMA
<b>Holder Material</b>	PC
<b>Fastening</b>	pin, tape
<b>Status</b>	ready
<b>ROHS Compliant</b>	Yes
<b>Date Updated</b>	10/10/2013



## OPTICAL PROPERTIES

LED	Viewing	Light	Effi-		Connector
	Angle	Beam	ciency	cd/lm	
LUXEON T	sim: 16	Real spot	sim: 92 %	sim: 8.840	-
LUXEON H50-2	sim: 16	Real spot	sim: 92 %	sim: 8.500	-
LUXEON Rebel	10 deg	Real spot	93 %	16.900	-
LUXEON Z ES	12 deg	Real spot	89 %	19.800	-
LUXEON TX	15 deg	Real spot	88 %	10.500	-
XB-H	15 deg	Real spot	88 %	10.300	-

D

C

B

A

4

4

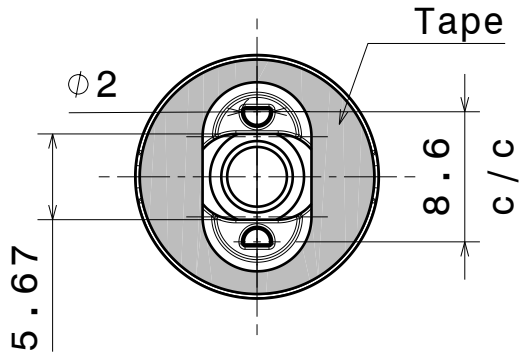

Bottom view

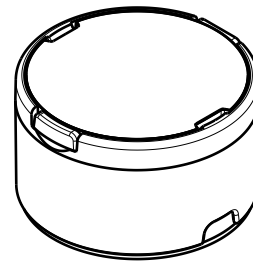

Isometric view

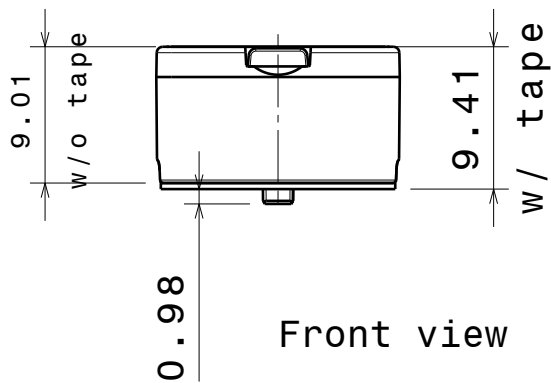

Front view

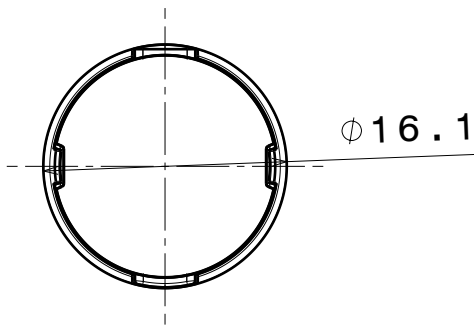

Top view

Materials  
 Lens: PMMA  
 Holder: PC  
 Tape: PU Foam

3

3

2

2

1

1

This drawing is our property.  
 It can't be reproduced  
 or communicated without  
 our written agreement.



Ledil Oy  
 Salorankatu 10  
 FIN 24240 SALO  
 Finland

DRAWING TITLE Mechanical Drawing

DRAWN BY  
 as

DATE  
 10.9.2012

TINA-RE

CHECKED BY  
 sn

DATE  
 -

SIZE  
 A4

PART NUMBER  
 TINA-RE

REV  
 001

DESIGNED BY  
 -

DATE  
 -

SCALE 2:1

WEIGHT 1,46 g

SHEET

1/1

D

A

Luminaire: Ledil Oy FA11212\_TINA-RS\_(Luxeon\_Z\_ES) Efficiency=89%  
Lamps: 1 x Luxeon Z ES (LXZ2-3090) 51.1lm @ 250mA CCT=3000K P=0.7W I=250mA

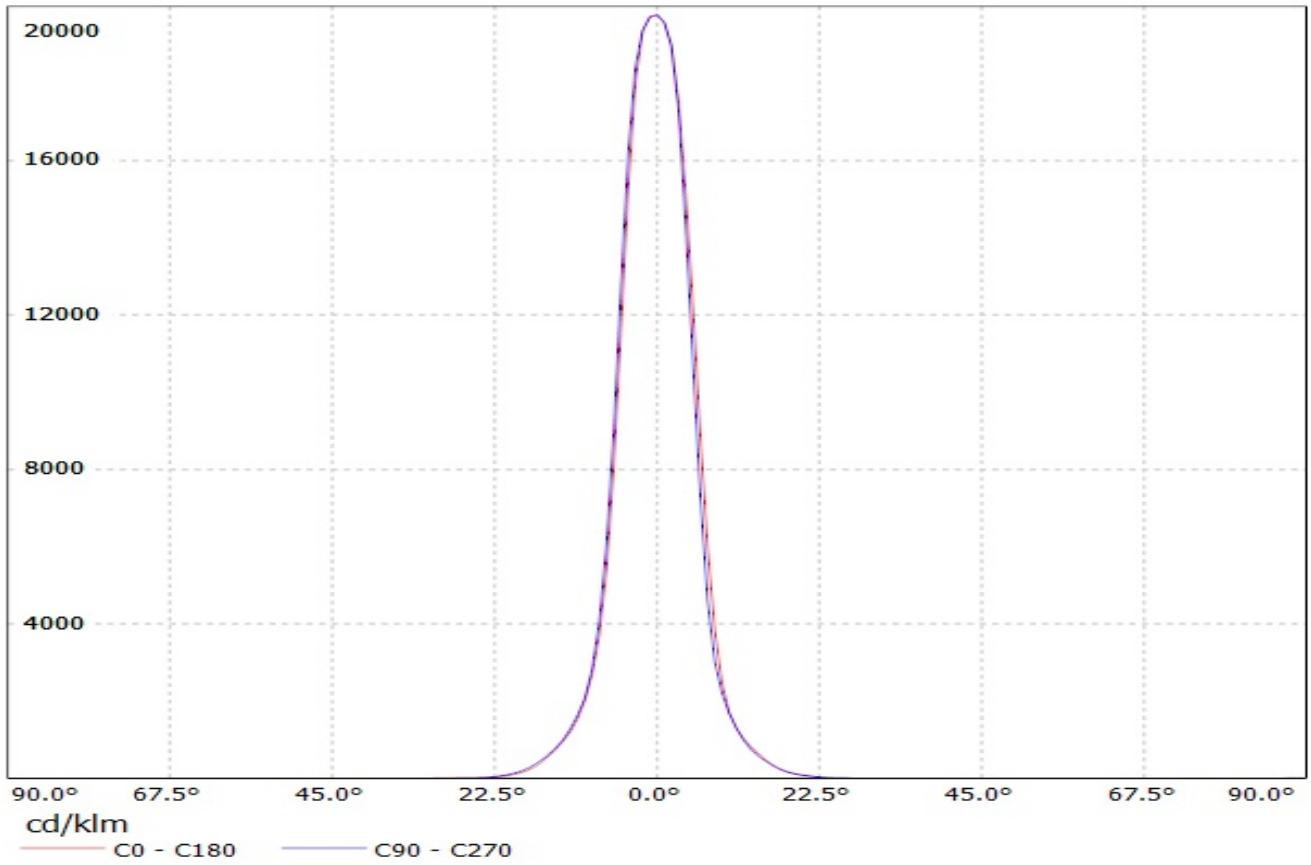

Luminaire: Ledil Oy FA11212\_TINA-RS\_(Luxeon\_TX) Efficiency=88%  
Lamps: 1 x Luxeon TX (L1T2-3585) 108lm @ 250mA CCT=3521K P=0.73W I=250mA

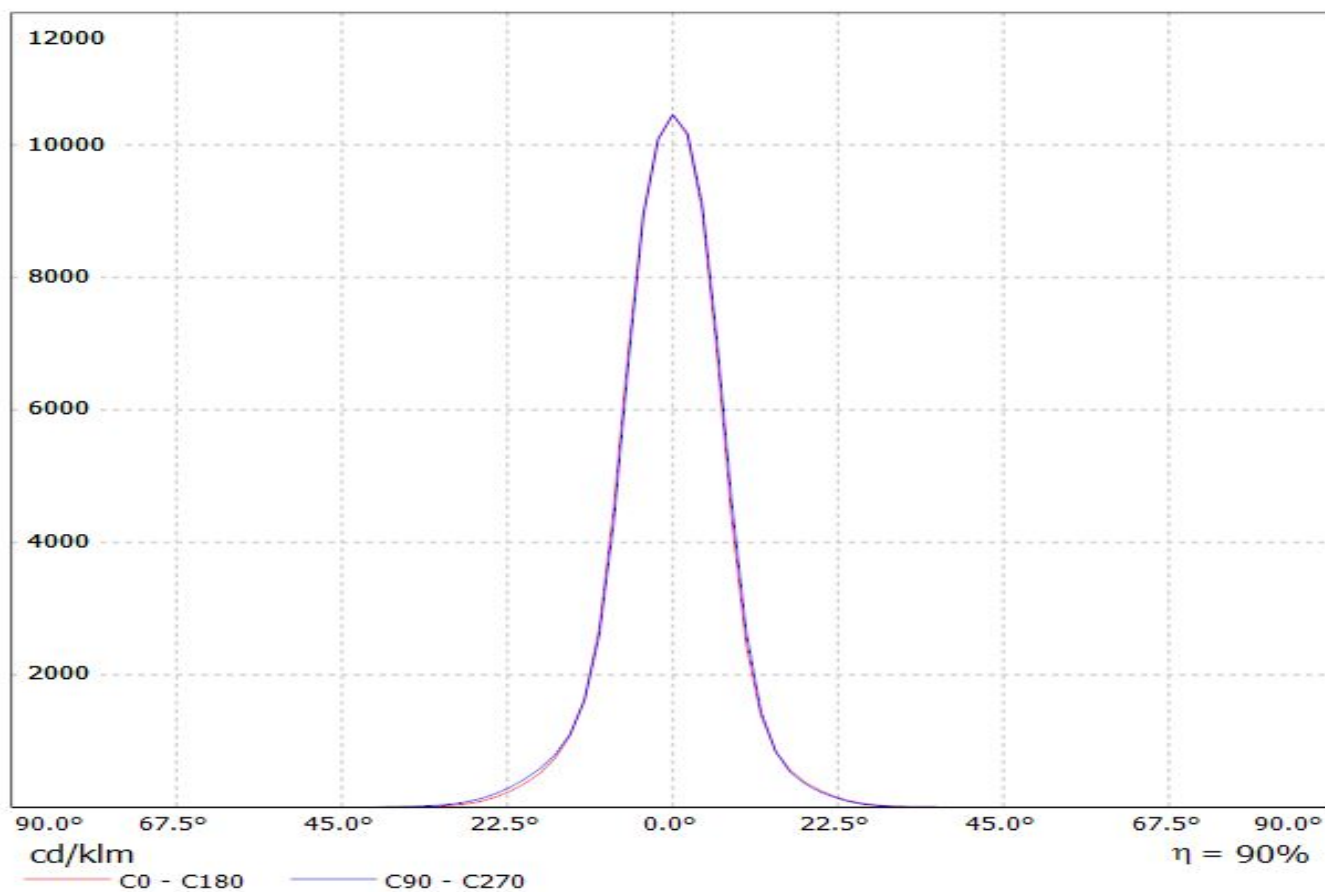

Luminaire: Ledil Oy FA11212\_TINA-RS\_(XB-H)

Lamps: 1 x Cree XB-H (XBHAWT-0-3C0-T50-0B-0001) 106lm @ 250mA CCT= P=0.73W I=250mA

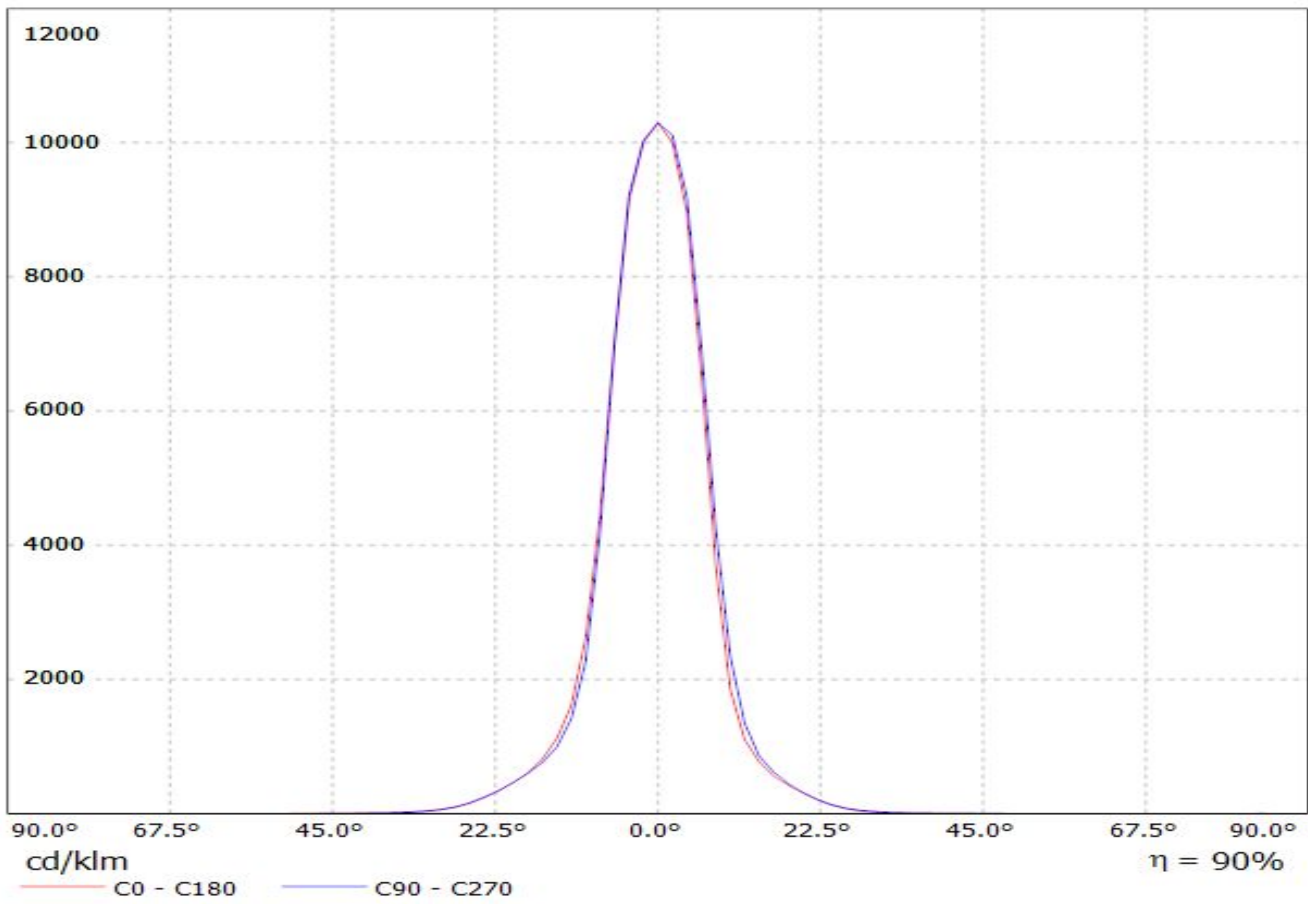

Luminaire: Ledil Oy FA11212\_TINA-RS\_(Luxeon\_Z\_ES) Efficiency=89%  
Lamps: 1 x Luxeon Z ES (LXZ2-3090) 51.1lm @ 250mA CCT=3000K P=0.7W I=250mA

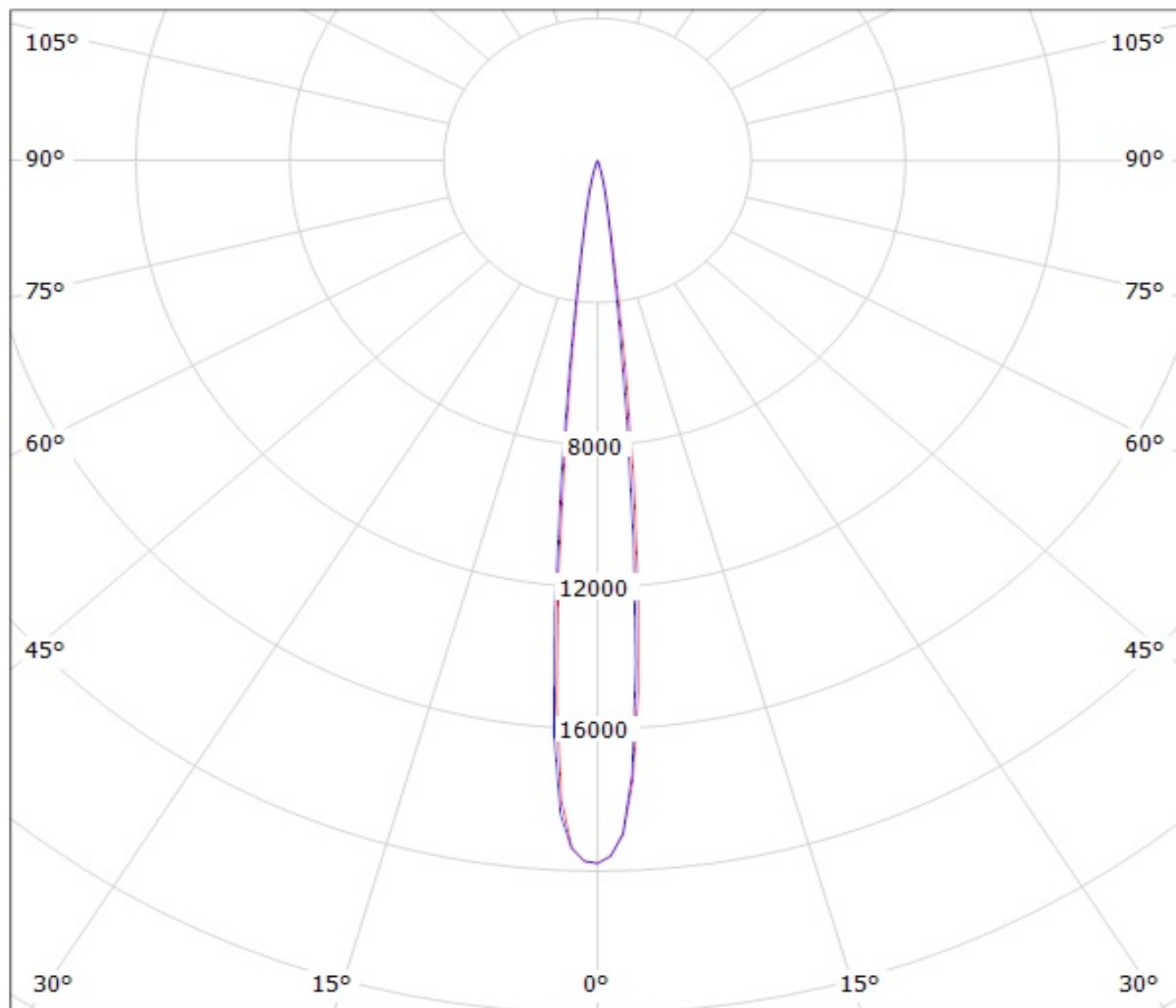

cd/klm

— C0 - C180

— C90 - C270

Luminaire: Ledil Oy FA11212\_TINA-RS\_(Luxeon\_TX) Efficiency=88%  
Lamps: 1 x Luxeon TX (L1T2-3585) 108lm @ 250mA CCT=3521K P=0.73W I=250mA

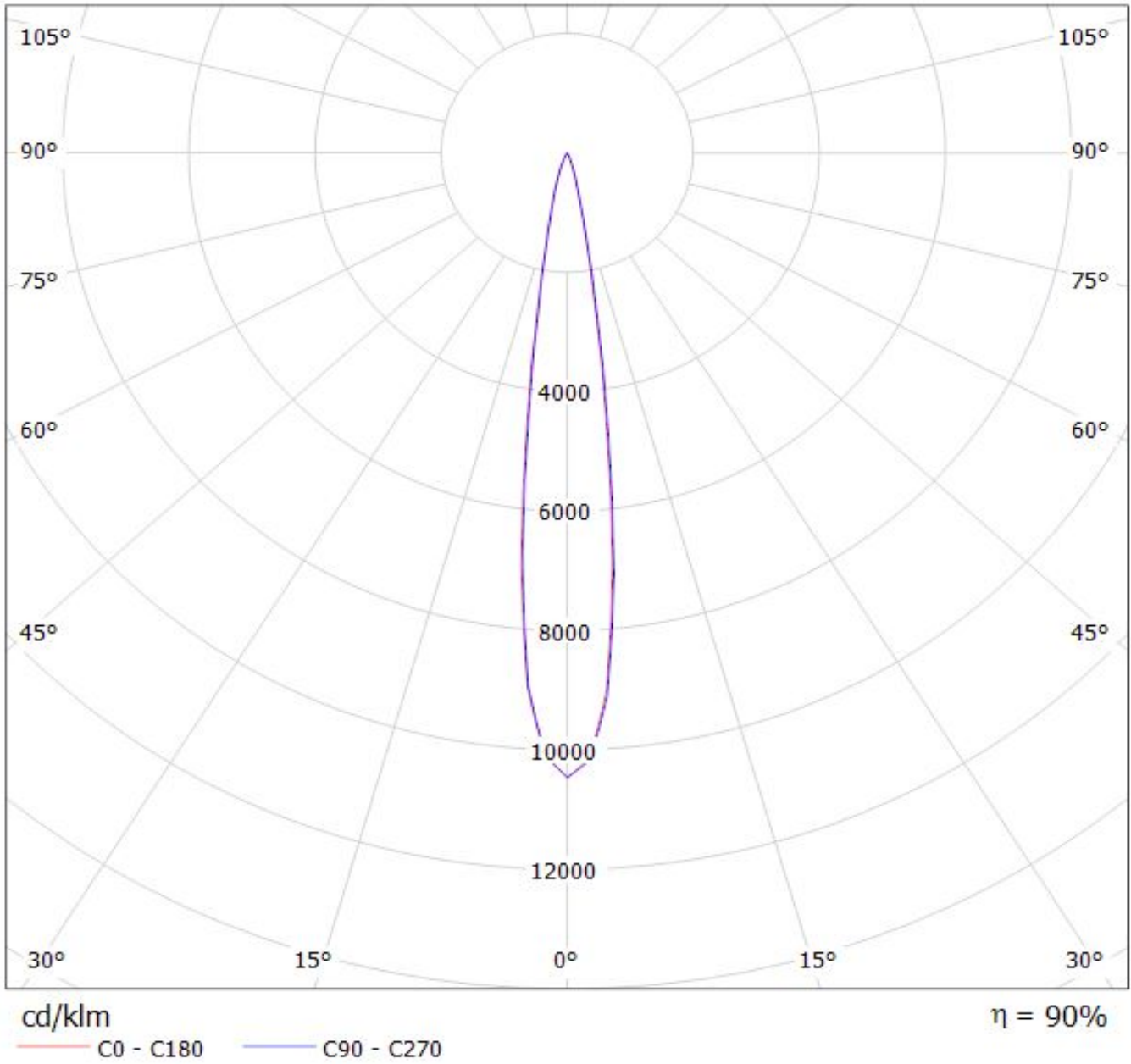

Luminaire: Ledil Oy FA11212\_TINA-RS\_(XB-H)

Lamps: 1 x Cree XB-H (XBHAWT-0-3C0-T50-0B-0001) 106lm @ 250mA CCT= P=0.73W I=250mA

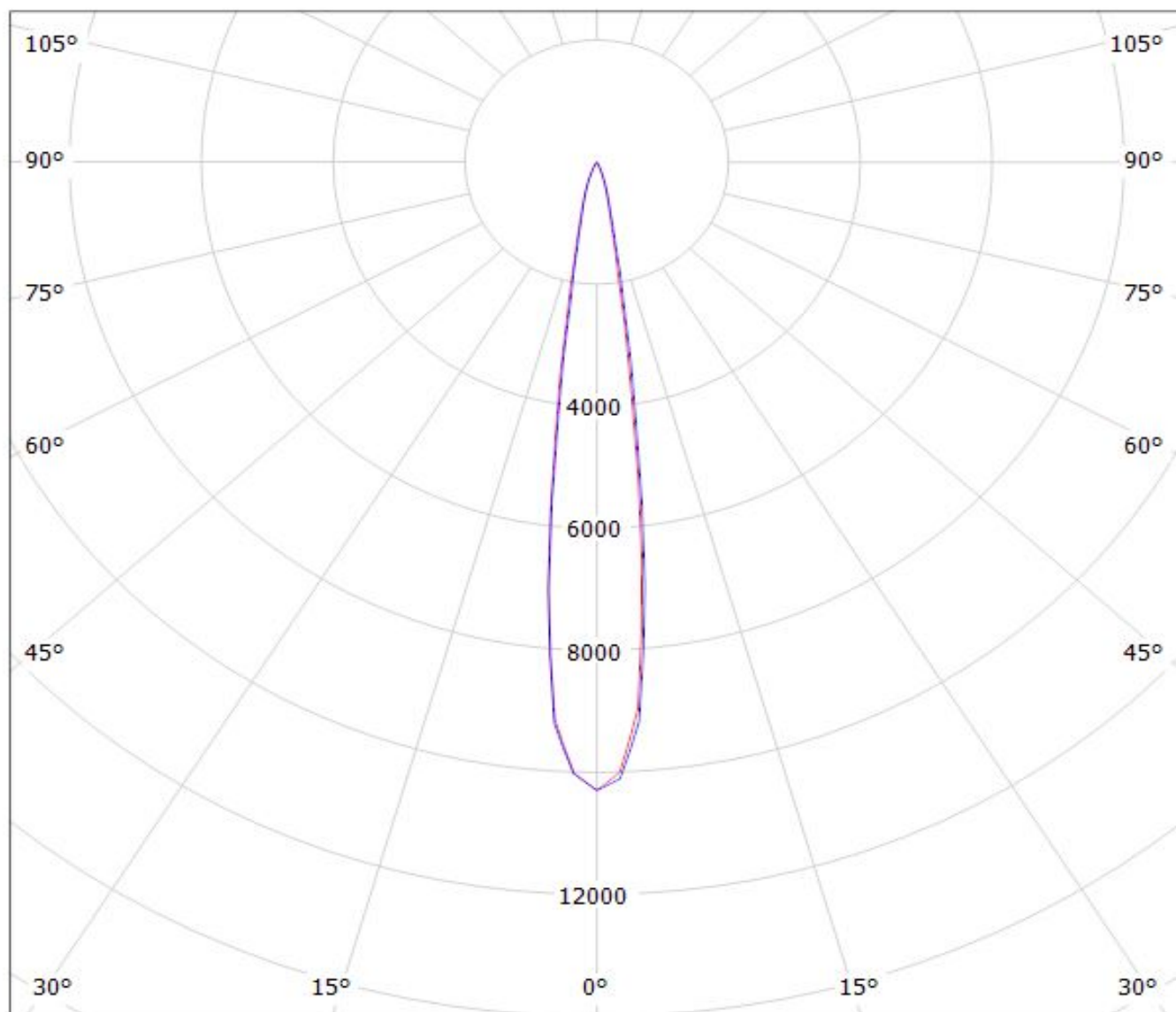

cd/klm

— C0 - C180

— C90 - C270

$\eta = 90\%$

**NOTE: The typical divergence will be changed by different color, chip size and chip position tolerance. The typical total divergence is the full angle measured where the luminous intensity is half of the peak value.**