

IEC Appliance Outlet J, Screw-on Mounting, Front Side, Quick-connect Terminal



Description

- Panel Mount:
Screw-on mounting, from front side
- 1 Function:
- Connector, Pin temperature 70 °C, Protection class I
- Quick connect terminals

Approvals

- VDE Certificate Number: 40012242
- UL File Number: E103791

Weblinks

[pdf-datasheet](#), [html-datasheet](#), [General Product Information](#), [Approvals](#), [CE declaration of conformity](#), [RoHS](#), [CHINA-RoHS](#), [REACH](#), [Mating Connectors](#), [e-Shop](#), [SCHURTER-Stock-Check](#), [Distributor-Stock-Check](#), [CAD-Drawings](#), [Accessories](#), [Detailed request for product](#)

Technical Data

Ratings IEC	16A / 250VAC; 50Hz
Ratings UL/CSA	20A / 250VAC; 60Hz
Dielectric Strength	> 4 kVAC between L-N > 2 kVAC between L/N-PE (1 min/50Hz)
Allowable Operation Temp.	-25 °C to 70 °C
Degree of Protection	from front side IP 40 acc. to IEC 60529
Protection Class	Suitable for appliances with protection class I acc. to IEC 61140
Material: Housing	PA6, black / grey / white, UL 94V-0

Dimensions

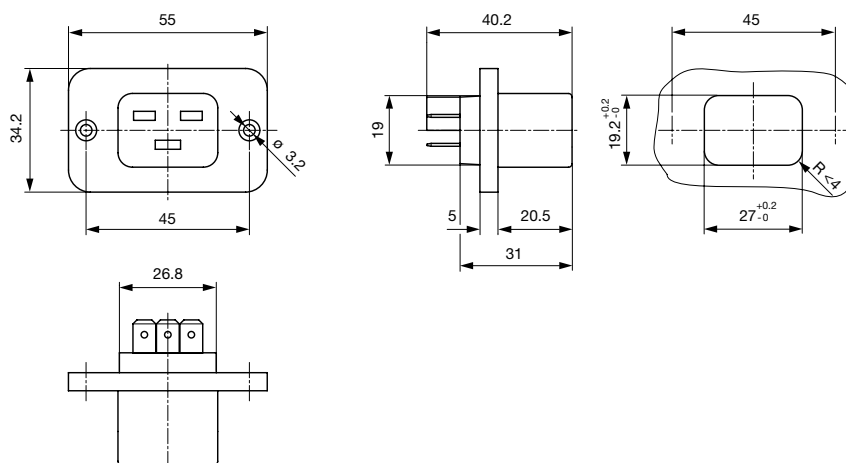

Length of the terminal please find at the order code configuration table

Config. Code

5017 - H - A B C 0 - D - E O

The characters are placeholders for the correspondingly keys of selections from the key tables.

5017 - **H** - A B C 0 - D - E O = Type

Type	Configuration key	Color	Configuration key
protection class I	X	White	D

5017 - H - A B C 0 - D - E O = Terminals

Terminal L	Configuration key
Blade terminal (6.3 x 0.8 mm)	9



5017 - H - A B C 0 - D - E O = Terminals

Terminal N	Configuration key
Blade terminal (6.3 x 0.8 mm)	9

Symbols similar as in table A

5017 - H - A B C 0 - D - E O = Terminals

Terminal Ground	Configuration key
Blade terminal (6.3 x 0.8 mm)	9

Symbols similar as in table A

5017 - H - A B C 0 - D - E O = Color

Color	Configuration key
Black	A
Grey	B

5017 - H - A B C 0 - D - E O = Style

Style	Configuration key
flange with countersunk holes	1
flange with through holes	2

5017 - H - A B C 0 - D - E O = Features

Features	Configuration key
not used	0
dead cover	1
holder for 1 fuse (text legible, when inlet on top)	2
holder for 1 fuse (text legible, when inlet on bottom)	3
holder for 1 or 2 fuses (text legible, when inlet on top)	4
holder for 1 or 2 fuses (text legible, when inlet on bottom)	5
voltage selector with 1 fuse	6
voltage selector with 2 fuses	7
thermal circuit breaker for rated current 4A	A
thermal circuit breaker for rated current 6A	B
thermal circuit breaker for rated current 8A	C
thermal circuit breaker for rated current 10A	D
thermal circuit breaker for rated current 15A	E
thermal circuit breaker for rated current 20A	F
V-Lock	V

All Variants

Config. Code	Description	Order Number
5017-X-9990-A-1	5017, IEC Appliance Outlet , 70°C, version: I, L: Blade terminal (6.3 x 0.8 mm), N: Blade terminal (6.3 x 0.8 mm), ground: Blade terminal (6.3 x 0.8 mm), color: Black, design: flange with countersunk holes, dimension S:	6183.0004

The listed variants should be available from stock Other versions on request www.schurter.com/contact

Availability for all products can be searched real-time: <http://www.schurter.com/en/Stock-Check/Stock-Check-SCHURTER>

Packaging unit 50 Pcs

Mating Inlets/Plugs

Category / Description



[Plug Overview complete](#)

IEC Plug I, Cord Connector (Rewireable), Straight	4796
IEC Plug I, Cord Connector (Rewireable), Angled	4789

[Plug further types to 5017](#)