

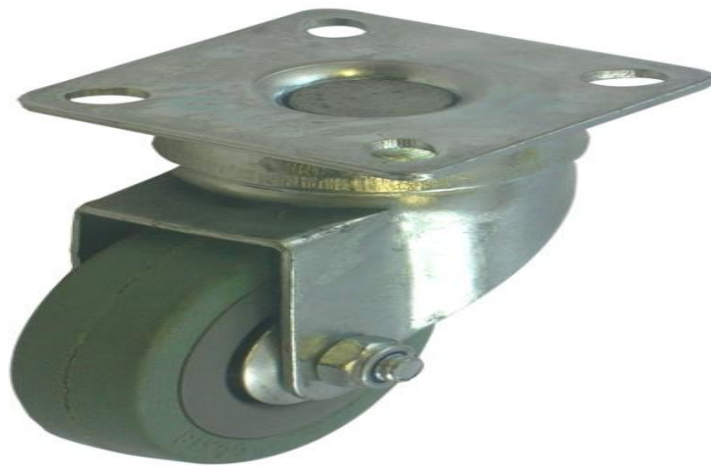

## Product Datasheet

ENGLISH

# 50mm Swivel Castor with Grey Rubber Tyred Wheel, 50kg load capacity



Specification	
Application	General Purpose / Industrial
Features	Ball Bearing Swivel Head
Fixing Centres	36x36mm
Fixing Centres Length	36mm
Fixing Centres Width	36mm
Fixing Hole Size	6mm
Fixing Plate Dimensions	50x50mm
Fixing Plate Length	50mm
Fixing Plate Width	50mm
Hub Bearing Type	Plain
Hub Material	Polypropylene
Load Capacity	50kg
Number of Fixing Holes	4
Overall Height	72mm
Rotation	Swivel
Tyre Material	Grey Rubber Tyre
Weight Class	Light Duty
Wheel Diameter	50mm
Wheel Width	18mm