

TRANSVERSE AUX. SWITCH, 1CO,  
SCREW CONNECTION, FOR CIRCUIT-BREAKERS,  
SZ S00/S0

**General technical data:**

<b>Product brand name</b>		SIRIUS
<b>Product designation</b>		auxiliary switch, transverse on the front
<b>Design of the product</b>		transverse auxiliary switches
<b>Size of the circuit-breaker</b>		S00
<b>Protection class IP / frontal/front side</b>		IP20
<b>Ambient temperature</b>		
• during storage	°C	-50 ... 80
• during the operating phase	°C	-20 ... 60

**Auxiliary circuit:**

<b>Number of NC contacts / for auxiliary contacts</b>		
• instantaneous switching		0
<b>Number of NO contacts / for auxiliary contacts</b>		
• instantaneous switching		0
<b>Number of changeover contacts / of the auxiliary contacts</b>		
• non-delayed		1
<b>Operating current / of the auxiliary contacts</b>		
• at AC-12		
• at 24 V	A	10
• at 230 V	A	10
• at 400 V	A	10
• at 690 V	A	10
• maximum	A	10
• at AC-15		
• at 24 V	A	4
• at 230 V	A	3
• at 690 V	A	0.5
• at 400 V	A	1.5
• at DC-13		
• at 24 V	A	1
• at 110 V	A	0.22

- at 125 V
- at 220 V
- at 250 V

A	0.22
A	0.1
A	0.1

#### Installation/mounting/dimensions:

<b>Type of fixing/fixation</b>		plug-in fixing
<b>Width</b>	mm	45
<b>Height</b>	mm	12
<b>Depth</b>	mm	17

#### Connections:

<b>design of the electrical connection</b>		screw-type terminals
<ul style="list-style-type: none"> <li>• for auxiliary and control current circuit</li> </ul>		
<b>Type of connectable conductor cross section</b>		
<ul style="list-style-type: none"> <li>• for auxiliary contacts           <ul style="list-style-type: none"> <li>• solid</li> <li>• finely stranded               <ul style="list-style-type: none"> <li>• with wire end processing</li> </ul> </li> </ul> </li> <li>• for AWG conductors / for auxiliary contacts</li> </ul>		2x (0.5 ... 1.5 mm <sup>2</sup> ), 2x (0.75 ... 2.5 mm <sup>2</sup> )  2x (0.5 ... 1.5 mm <sup>2</sup> ), 2x (0.75 ... 2.5 mm <sup>2</sup> )  2x (20 ... 14)

#### Certificates/approvals:

<b>verification of suitability</b>	CE / UL / CSA / CCC
------------------------------------	---------------------

#### Further information:

##### Information- and Downloadcenter (Catalogs, Brochures,...)

<http://www.siemens.com/industrial-controls/catalogs>

##### Global Industry Mall (Online ordering system)

<http://www.siemens.com/industrial-controls/mall>

##### Service&Support (Manuals, Certificates, Characteristics, FAQs,...)

<http://support.automation.siemens.com/WW/view/en/3RV2901-1D/all>

##### Image database (product images, 2D dimension drawings, 3D models, device circuit diagrams, ...)

[http://www.automation.siemens.com/bilddb/cax\\_en.aspx?mlfb=3RV2901-1D](http://www.automation.siemens.com/bilddb/cax_en.aspx?mlfb=3RV2901-1D)

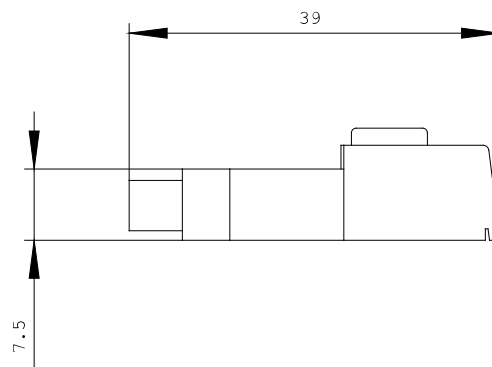
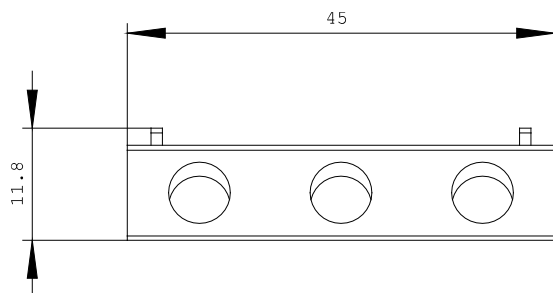



last change:

Apr 26, 2010