

## Compliance with EN60079-15: 2006 Electrical apparatus for explosive atmospheres Type of Protection « n » for Zone 2

### RJ11FTVX series: rugged and sealed RJ11/12 connectors

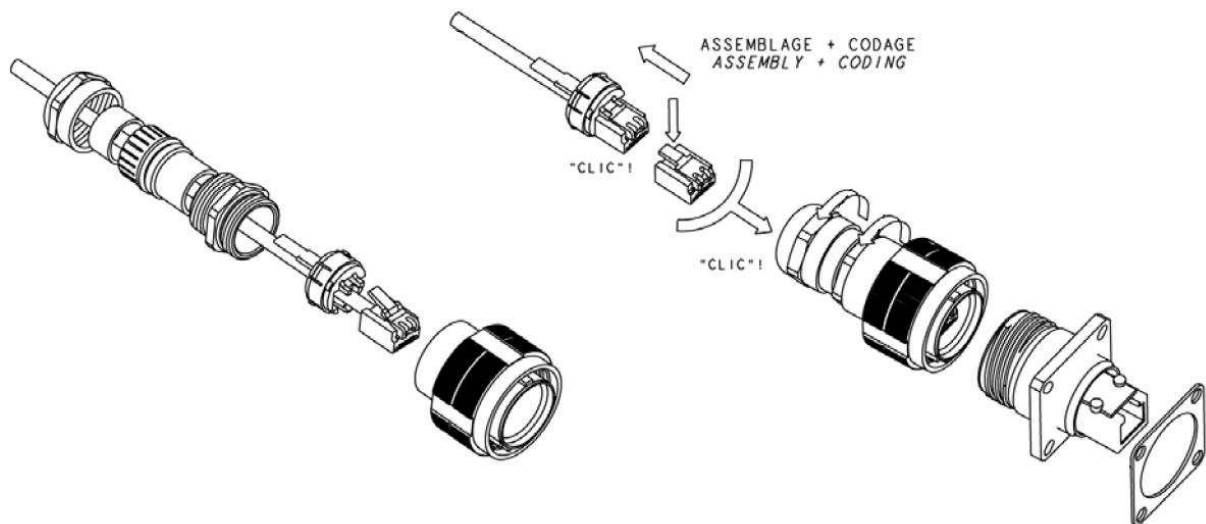

Report Prepared by :

Amphenol Socapex  
Industrial Engineering Department  
BP 29 – 948 promenade de l'Arve  
74311 Thyez cedex

Tests authorized by :

Amphenol Socapex  
BP29 – 948 promenade de l'Arve  
74311 Thyez cedex



## Introduction

This report will demonstrate compliance of RJ11FTVX series with requirements of EN60079-15: 2006 Electrical apparatus for explosive atmospheres – type of protection “n”.

## Electrical Characteristics

Voltage : 60V<sub>eff</sub> max

RJ11/12 jack contacts of RJ11FTVX series are rated for at least 1.5A.

As RJ11FTVX is low power non-sparking electrical material voltage and current have to be chosen to handle a max power of 20W.

## Review of Requirements (by section)

### 1. Scope

EN60079-15: 2006 describes requirements for construction, testing and marking of Group II electrical apparatus with type of protection “n” dedicated to be used in explosive atmospheres of gas.

It's applicable to non-sparking electrical apparatus as well as apparatus with parts or circuits producing arcs or sparks or having hot surfaces which, if not protected in one of the ways specified in this standard, could be capable of igniting a surrounding explosive atmosphere.

RJ11FTVX series is designed for device group II, category 3G. It may be operated within zone 2 as a low power non sparking connector under specified electrical characteristics.

Following paragraphs will show compliance with a T6 temperature classification and an operating temperature range of – 40°C / + 60°C.

### 2. Normative references

Please consult EN60079-15: 2006 and EN60079-0: 2006

### 3. Definitions

Please consult EN60079-15: 2006 and EN60079-0: 2006

### 4. General : Group of material and surface temperature

RJ11FTVX series will be classified as Group II (no specific explosive gas atmosphere) with a T6 classification.

### 5. Temperatures

#### *Ambient temperature:*

The operating temperature range of RJ11FTVX series is – 40°C to + 60°C. As this range is special compared to standard one - 20°C / + 40°C, EN60079-15 rating code II3G ExnAIIIT6 will be followed by the symbol “X”.

#### *Surface temperature:*

RJ11FTVX series meets the requirement for a T6 classification.

To evaluate this T6 classification for an ambient temperature of -40°C / +60°C, representative samples were tested at an ambient temperature of 20°C. A derating curve gives us then the heating for an ambient of around 68°C: at 68.1°C of ambient and with a current of 1.5A per contact the hottest point (inside the plug) is 80° (T6 – 5°C).



## 6. Requirements for electrical material

### *Mechanical resistance:*

Representative samples were tested following articles 26.4.2 mechanical resistance. A mass of 1kg (diameter of 25mm) falls twice on each mated pair from a height of 0.7m. No deterioration which could affect the IP protection level has been observed. Then plugs of each mated pairs were submitted to drop tests described in article 26.4.3: 4 falls from 1m height on horizontal floor in concrete. As for mechanical resistance tests, no deterioration able to affect the IP protection has been observed. Then mated pairs were submitted successfully to IP67 tests following EN60529.

Furthermore, as RJ11FTVX shells are based on military specification MIL-DTL-38999 serie III, its mechanical resistance equals many of the parameters established by this standard.

### *Protection degree :*

RJ11FTVX is IP67 and IP68.

### *Clearances, creepage distances and separations:*

RJ11FTVX is a low power non-sparking electrical material. The protection degree is IP67 and IP68. The maximum voltage of use is 60V<sub>eff</sub> and power should not exceed 20W.

So no special creepage and clearance are required.

As RJ11FTVX is a passive component which doesn't contain any power, this connector is not concerned by any transient.

### *Dielectric Withstanding Voltage (DWV):*

RJ11FTVX has been successfully tested under a test volatge of 500V during 1 minute, according to 6.8.1.

Moreover, according to 6.8.2 and 34, each panel mount receptacle is controlled during production and has to support test volatge of 500V during 1 minute without any breakdown or flashover.

## 7. Non metallic shell or part of shell

Not applicable: the shell of RJ11FTVX is completely metallic.

## 8. Metallic shell

As RJ11FTVX is designed for group II zone 2 applications, no constraint is specified.

## 9. Shell Closing

Not applicable: RJ11FTVX doesn't contain any closing to satisfy the IP67 and IP68 degree of protection.

## 10. Coupling system

Requirements of EN60079-0 are not applicable for EN60079-15.

## 11. Rotation of through bulkhead

Not applicable: there is no necessary rotation to insure the connection of cable on RJ11FTVX.

## 12. Material used for transversal sealing

Each panel mount receptacle of RJ11FTVX is compounded for transversal sealing (IP67 and IP68), even in unmated conditions.



The temperature range of used compounds is  $-50^{\circ}\text{C} / +180^{\circ}\text{C}$  so it's in accordance with our temperature range of use  $-40^{\circ}\text{C} / +60^{\circ}\text{C}$ .

### 13. Ex components

RJ11FTVX is an Ex component. He complies with ATEX European Union Directive 94/9/EC relating to Group II category 3G locations (annex VIII) except of CE marking: as passive components, connectors are not submitted to CE marking. So RJ11FTX will have to be used as an Ex component with systems, materials or enclosures on which the integration has been foreseen, for example by respecting recommended panel drillings.

### 14. Wiring elements and wiring localisation

RJ11FTVX contains standard RJ11/12 components which are suitable for use with phone or RJ12 cables of the market and is a non-sparking electrical connection.

RJ11FTVX plug is equipped with an increased safety metallic gland (EExeII2G/D) suitable for use in Zone 2. For other information on this gland see hereunder article 16.

### 15. Wiring elements of ground conductors

Not applicable.

### 16. Shell entry

RJ11FTVX plug contains a cable entry: an increased safety metallic gland (EExeII2G/D) suitable for use in Zone 2 and compliant with EN60079-0 and EN60079-7.

The acceptable outside cable diameters are from 4mm to 5.5mm.

The torques to apply with this gland are:

- torque on body of metallic gland = 9Nm
- torque on nut of metallic gland = 7Nm

### 17. Supplementary requirements for non-sparking rotating machine

Not applicable. RJ11FTVX does not have any rotating features.

### 18. Supplementary requirements for connection apparatus

Not applicable. Description given for connection apparatus doesn't correspond to RJ11FTVX.

### 19. Supplementary requirements for non-sparking fuses and fuse assemblies

Not applicable. The products covered by this document do not have any built-in fuses.

### 20. Supplementary requirements for non-sparking plugs and sockets

In use RJ11FTVX will be connected on one material. It is mechanically immobilized by a thread coupling with anti decoupling device. This standard coupling system of military specification MIL-DTL-38999 serie III will avoid any involuntary separation.

RJ11FTVX will have the warning marking: WARNING – DO NOT SEPARATE WHEN ENERGIZED.

As RJ11FTVX receptacles are compounded, they are IP67 and IP68 even in unmated conditions.

Moreover sealing caps are available for plugs and receptacles and provide an IP67 and IP68 sealing.

### 21. Supplementary requirements for non-sparking luminaries

Not applicable. The product doesn't contain any luminaries.



22. Supplementary requirements for non-sparking battery elements

Not applicable. The product doesn't contain any battery elements.

23. Supplementary requirements for low power non-sparking material

RJ11FTVX series is a low power non-sparking rugged RJ11/12 connector rated for a voltage of 60Veff max with a max power of 20W.

RJ11FTVX provides an IP67 and IP68 protection degree which is superior to IP54.

As RJ11FTVX is a passive component which doesn't contain any power, this connector is not concerned by any transient.

24. Supplementary requirements for non-sparking current transformers

Not applicable: RJ11FTVX doesn't contain any current transformer.

25. Other electrical material

Not concerned.

26. Supplementary general requirements for producing arcs, sparks or hot surfaces material

Not applicable, RJ11FTVX doesn't produce any arcs, sparks or hot surfaces.

27. Supplementary requirements for enclosed-break devices and non-incendive components which produce arcs, sparks or hot surfaces

Not applicable, RJ11FTVX doesn't produce any arcs, sparks or hot surfaces and doesn't utilize these devices or features.

28. Supplementary requirements for hermetically sealed devices which produce arcs, sparks or hot surfaces

Not applicable, RJ11FTVX doesn't produce any arcs, sparks or hot surfaces and doesn't utilize these devices or features.

29. Supplementary requirements for closed or encapsulated devices which produce arcs, sparks or hot surfaces

Not applicable, RJ11FTVX doesn't produce any arcs, sparks or hot surfaces and doesn't utilize these devices or features.

30. Supplementary requirements for energy-limited materials and circuits which produce arcs, sparks or hot surfaces

Not applicable, RJ11FTVX doesn't produce any arcs, sparks or hot surfaces and doesn't utilize these devices or features.

31. Supplementary requirements for materials protected by restricted-breathing enclosures and which produce arcs, sparks or hot surfaces

Not applicable, RJ11FTVX doesn't produce any arcs, sparks or hot surfaces and doesn't utilize these devices or features.

32. General information on verification and tests

The tests made on RJ11FTVX series follow endurance, mechanical resistance and IP protection degree.



All Amphenol Socapex interconnection system are designed and manufactured following the corporations ISO9001 approved product design and testing procedures.

### 33. Type tests

To certify RJ11FTVX series as a zone 2 reinforced & sealed RJ11/12 connector, Amphenol Socapex has performed the tests required by standard IEC60079-15 in his own laboratory. Test reports can be provided on request.

### 34. Verifications and individual tests

#### *Generalities :*

As explained above in article 33, Amphenol Socapex performs in its own laboratory the tests on RJ11FTVX required by standard EN60079-15. Please ask us to consult test reports.

#### *Specific individual testings: Dielectric Withstanding Voltage (DWV) test:*

Each panel mount receptacle is controlled during production and has to support test voltage of 500V during 1 minute without any breakdown or flashover.

### 35. Marking

RJ11FTVX is suitable for use in zone 2 hazardous locations and is marked according to clause 35. Description of marking:

Manufacturer's name : AMPHENOL

Manufacturer's type: [Amphenol Socapex commercial designation (example: RJ11FTVX2SA1N)]

Certification code: II3G ExnAIIIT6X, see note 1

Operating ambient temperature: - 40°C to + 60°C, see note 2

Certification org. and code: Not applicable

Batch identification code: Date code of production (example : 0822 for week 22 of year 2008)

As RJ11FTVX will be connected on one material, according to clause 20, the marking will contain the warning: WARNING – DO NOT SEPARATE WHEN ENERGIZED.

#### Note 1 :

X indicates special conditions. In our case it refers to extended ambient temperature range – 40°C to + 60°C compared to the standard one – 20°C to + 40°C.

#### Note 2 :

Ambient temperature range won't be listed on RJ11FTVX plugs and receptacles: they are small products and certification code is already followed by an "X".

RJ11FTVX complies with ATEX European Union Directive 94/9/EC relating to Group II category 3G locations (annex VIII) except of the CE marking: as passive components, connectors are not submitted to CE marking. So RJ11FTVX will have to be used as an Ex component with systems, materials or enclosures on which the integration has been foreseen, for example by respecting recommended panel drillings.

### 36. Documentation & 37. Instructions

RJ11FTVX is delivered with a notice where information for proper installation, use and performance is precised.



## **Conclusion**

In conclusion, this document shows the compliance of RJ11FTVX series manufactured by Amphenol Socapex with EN60079-15: 2006.

All the verification tests have been performed by Amphenol Socapex on representative samples of all the products covered by this document.

All products covered by this document are also subject to Manufacturing Department Production Testing in accordance with the ISO9001 approved test procedures.