

SIRIUS

Einspeisesystem Cage Clamp

Feeder System Cage Clamp

Système d'arrivée Cage Clamp

Sistema de alimentación Cage Clamp

Sistema di alimentazione Cage Clamp

Grampo de caixa do sistema de alimentação

3RV19..



Betriebsanleitung Instructivo	Operating Instructions Istruzioni operative	Instructions de service Instruções de Serviço	Bestell-Nr./Order No.: 3ZX1012-0RV10-2BA1
--	--	--	--

Vor der Installation, dem Betrieb oder der Wartung des Geräts muss diese Anleitung gelesen und verstanden werden.
Read and understand these instructions before installing, operating, or maintaining the equipment.
Ne pas installer, utiliser ou intervenir sur cet équipement avant d'avoir lu et assimilé ces instructions.
Leer y comprender este instructivo antes de la instalación, operación o mantenimiento del equipo.
Leggere con attenzione queste istruzioni prima di installare, utilizzare o eseguire manutenzione su questa apparecchiatura.
Ler e compreender estas instruções antes da instalação, operação ou manutenção do equipamento.

	⚠ GEFAHR Gefährliche Spannung. Lebensgefahr oder schwere Verletzungsgefahr. Vor Beginn der Arbeiten Anlage und Gerätespannung frei schalten.	⚠ DANGER Hazardous voltage. Will cause death or serious injury. Disconnect power before working on equipment.	⚠ DANGER Tension dangereuse. Danger de mort ou risque de blessures graves. Mettre hors tension avant d'intervenir sur l'appareil.
	⚠ PELIGRO Tensión peligrosa. Puede causar la muerte o lesiones graves. Desconectar la alimentación eléctrica antes de trabajar en el equipo.	⚠ PERICOLO Tensione pericolosa. Può provocare morte o lesioni gravi. Scollegare l'alimentazione prima di eseguire interventi sull'apparecchiatura.	⚠ PERIGO Tensão perigosa. Perigo de morte ou ferimentos graves. Desligue a corrente antes de trabalhar no equipamento.

Eine sichere Gerätefunktion ist nur mit zertifizierten Komponenten gewährleistet.
Reliable functioning of the equipment is only ensured with certified components.
Le fonctionnement sûr de l'appareil n'est garanti qu'avec des composants certifiés.
El funcionamiento seguro del aparato sólo está garantizado con componentes certificados.
Il funzionamento sicuro dell'apparecchiatura è garantito soltanto con componenti certificati.
O funcionamento seguro do aparelho apenas pode ser garantido se forem utilizados os componentes certificados.

Montage Assembly Montaje Montaggio Montagem

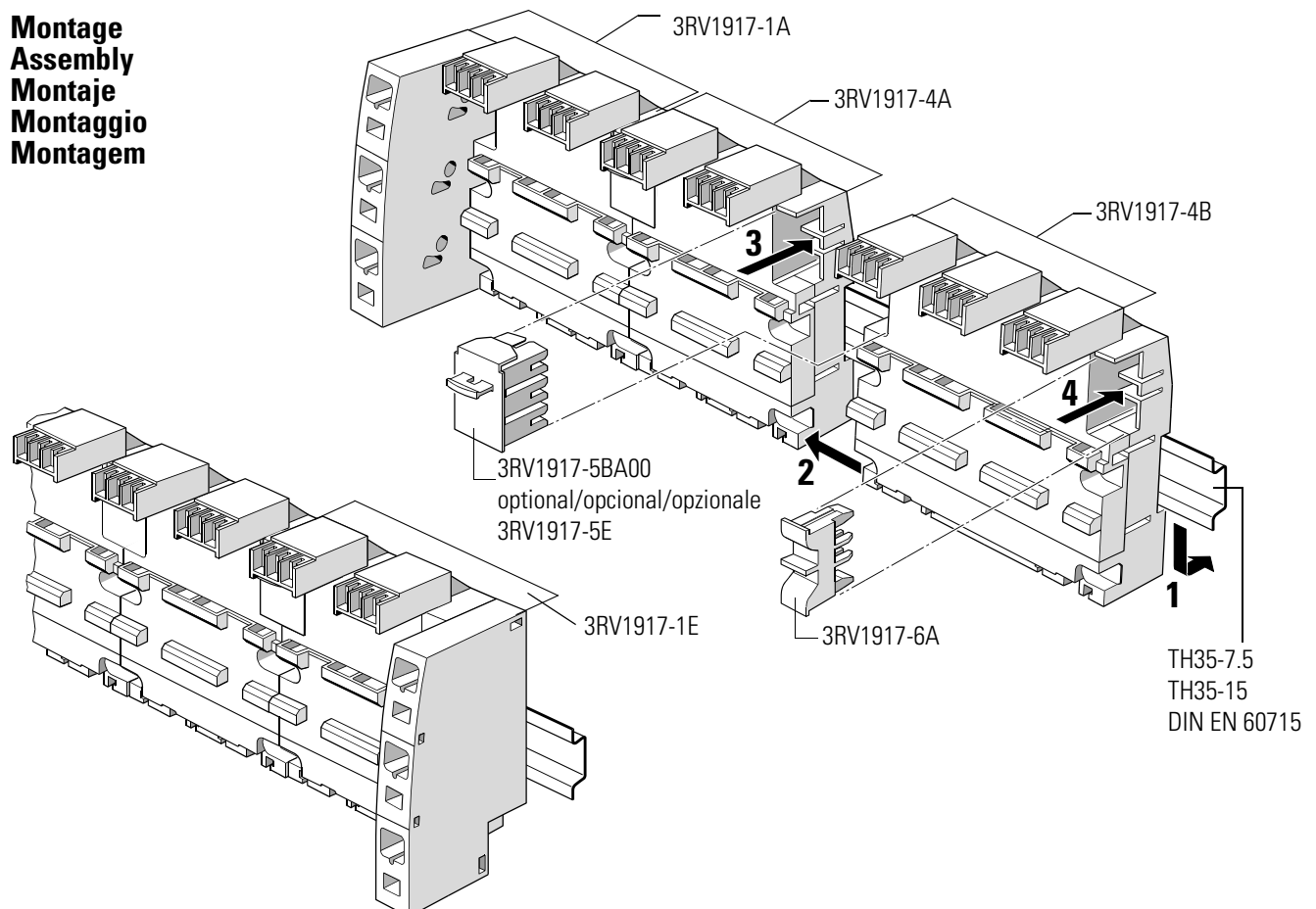



**WARNUNG / WARNING / ATTENTION /
ADVERTENCIA / ATTENZIONE / AVISO**

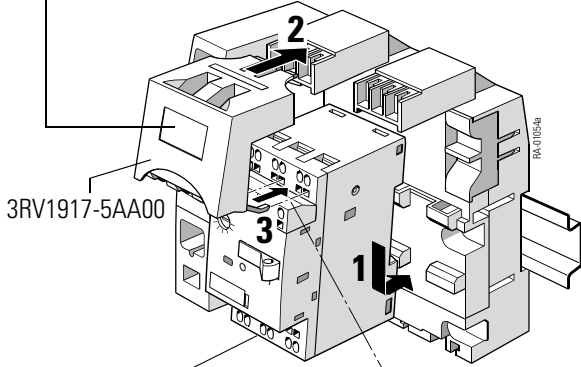

Nicht unter Last stecken oder ziehen!
Do not connect or unplug under load!
Ne pas embrocher ni débrocher en charge!
¡No conectar o desconectar bajo carga!
Non innestare o estrarre sotto carico!
Não conectar nem desconectar sob tensão!

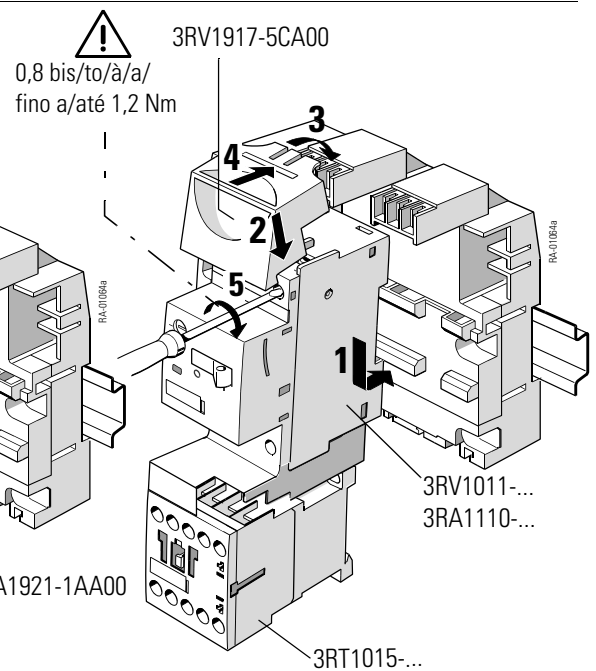
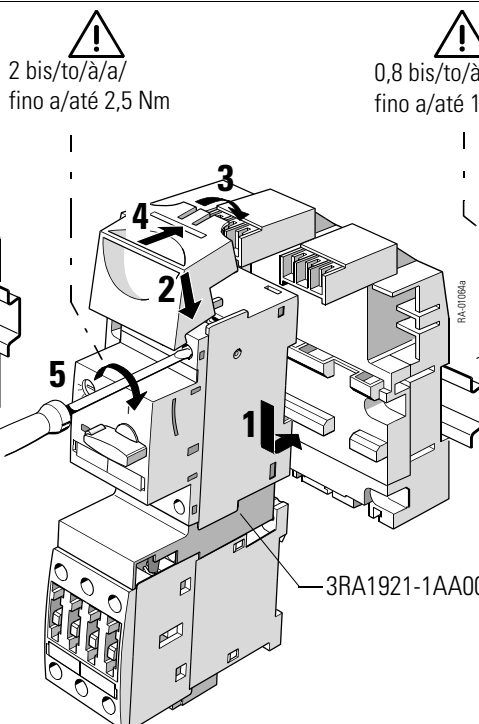
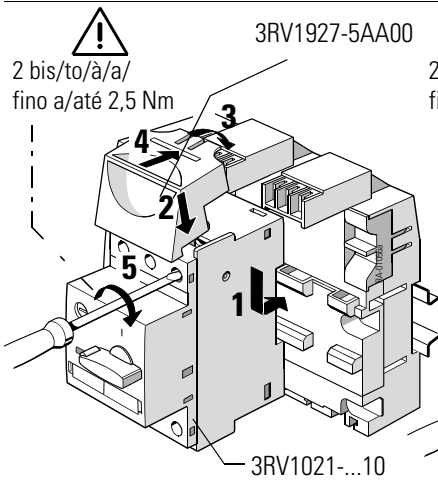
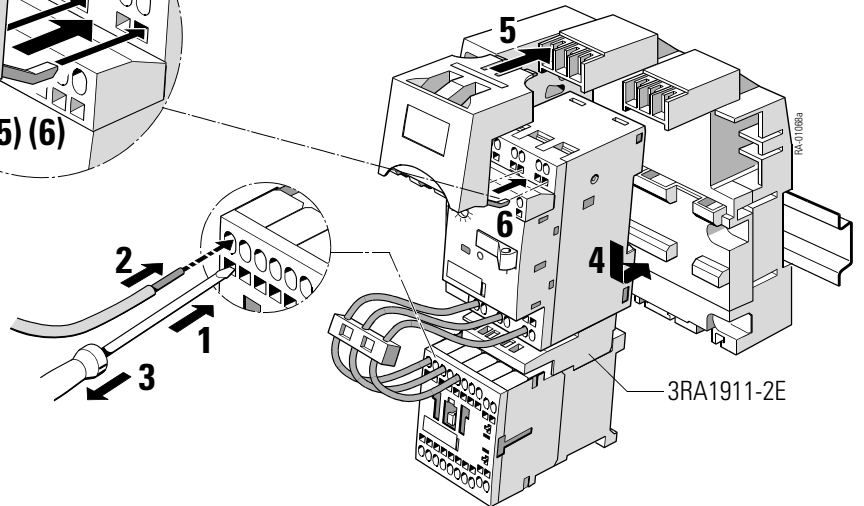
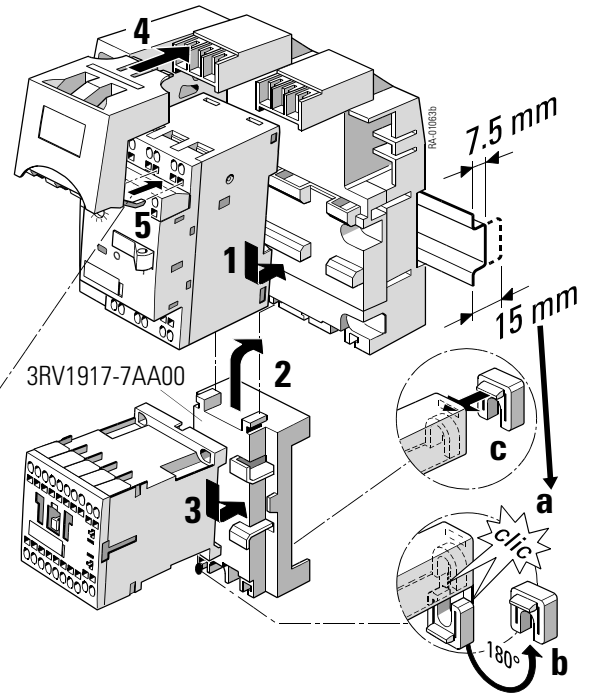
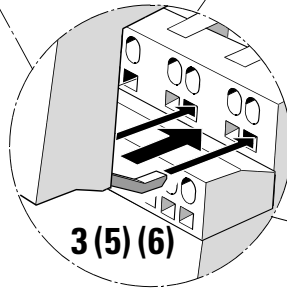

⚠ ab/from/à partir de/a partir
de/a partire da/a partir do
E03 3RV1011-...2.

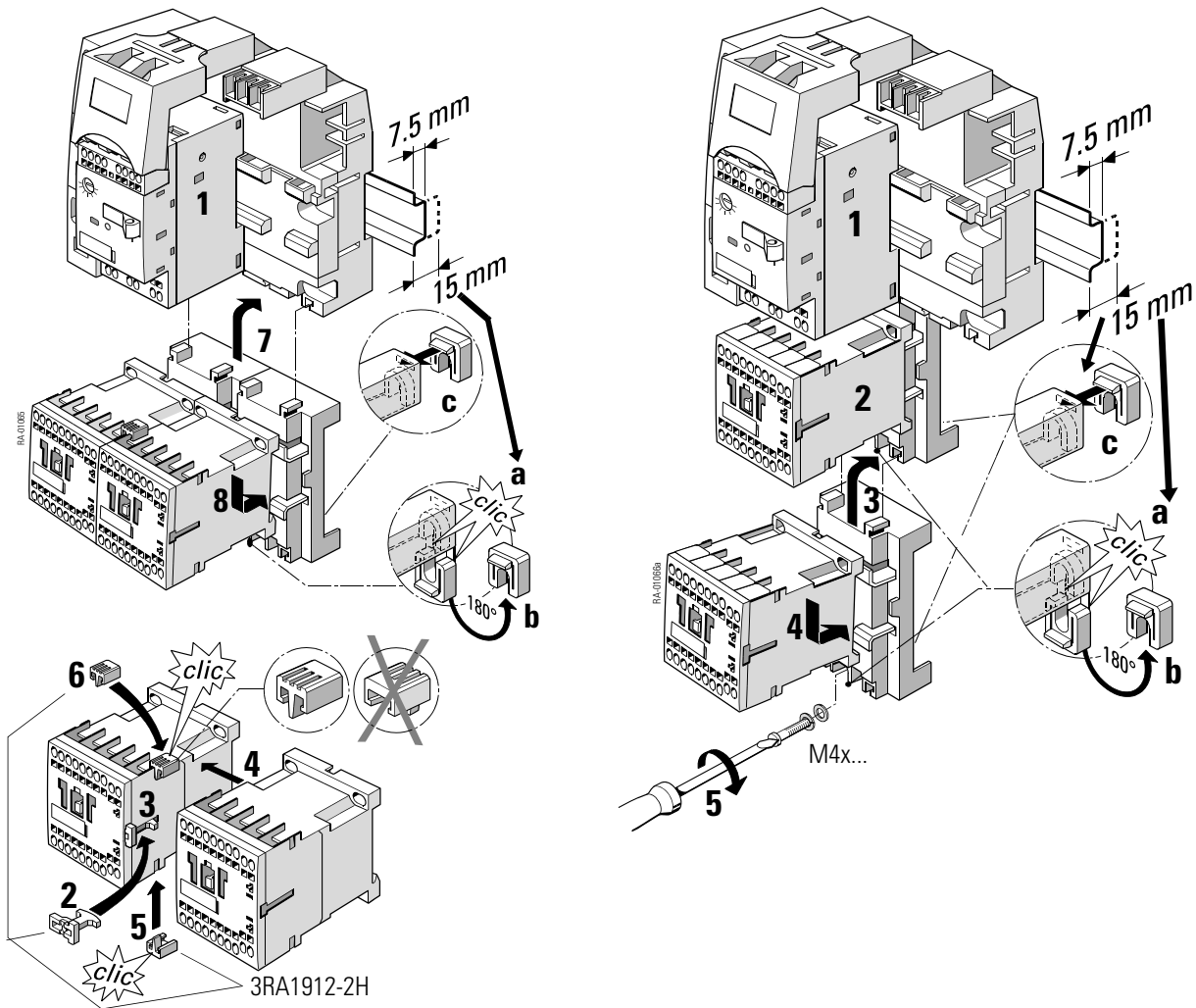

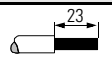
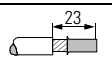
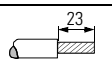

3RV1917-1A/1E L1/L2/L3	
	4 ... 25 mm ²
	4 ... 25 mm ²
	6 ... 25 mm ²
AWG	10 to 3
	∅ 5,5 x 0,8 mm 8WA2806

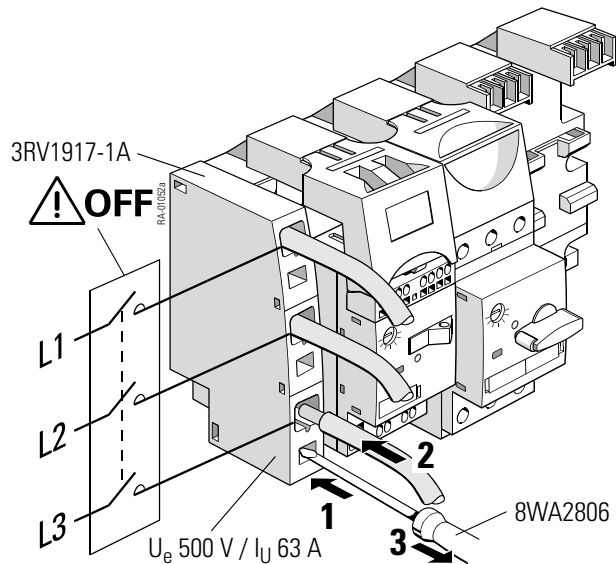

Umgebungstemperatur/Ambient temperature/ Température ambiante/Temperatur ambiente/ Temperatura ambiente/Temperatur ambiente				
LS S00	3RV1011-	... 12A	100 %	60 °C
LS S0	3RV1.21-	≤16A	100 %	60 °C
LS S0	3RV1.21-	>16A	87%	60 °C
LS S0	3RV1.21-	>16A	100%	40 °C

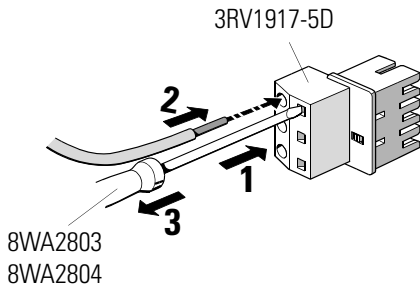

3RV1917-5D L1/L2/L3	
	1,5 ... 6 mm ²
	1,5 ... 4 mm ²
	1,5 ... 6 mm ²
AWG	15 to 10
	Ø 3,5 x 0,5 mm 8WA2803 8WA2804

Kurzschlusschutz für Klemmenblock 3RV1917-5D
 Short circuit protection for terminal block 3RV1917-5D
 Protection contre courts-circuits du bornier 3RV1917-5D
 Protección contra cortocircuitos para bloque de bornes 3RV1917-5D
 Protezione contro cortocircuito per blocco morsetti 3RV1917-5D
 Proteção contra curto-circuito para bloco de bornes 3RV1917-5D

	$I_{d \max}^{2)}$
1,5 mm ²	<7,5 kA
2,5 mm ²	<9,5 kA
4 mm ²	<9,5 kA
6 mm ²	<12,5 kA

²⁾ für nachgeschaltetes Kurzschlusschutzgerät
 for short circuit protection device connected downstream
 pour dispositif de protection contre les courts-circuits
 connecté en aval
 para equipo de protección contra cortocircuitos
 conectado en serie
 per dispositivo di protezione contro cortocircuito
 collegato a valle
 para dispositivo de proteção contra curto-circuito
 conectado a jusante

3RV1917-1A ¹⁾
 3RV1917-1E ¹⁾
 3RV1917-4A ¹⁾
 3RV1917-4B ¹⁾
¹⁾ 3RV1917-5D
 ab/from/à partir de/a partir de/a partir de/a partir de/
 a partir do
 E02

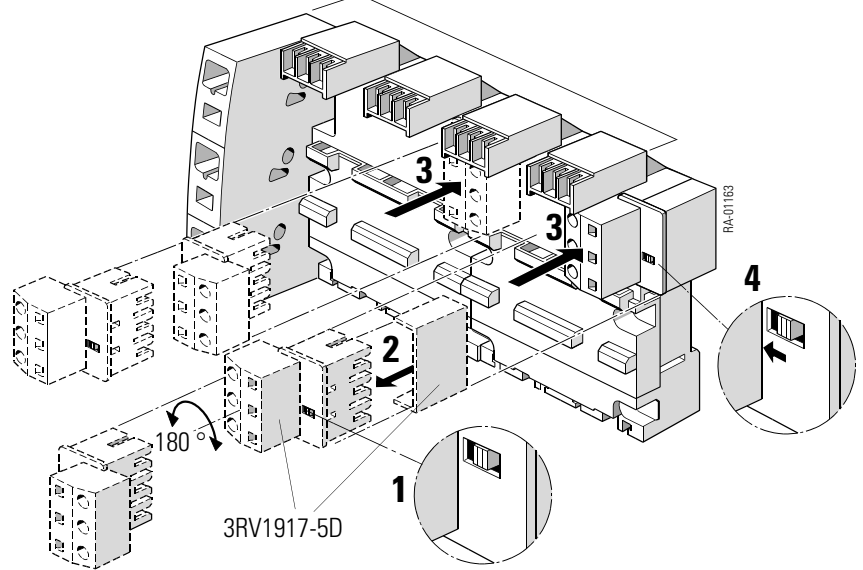

Achtung

Auf kurzschlussfeste Verlegung der Leitungen (DIN EN 60439-1 Abschnitt 7.5.5.1.2) vom Klemmenblock zum nachgeschalteten Kurzschlusschutzgerät (z. B. 5SY..) ist zu achten!

NOTICE!

Please ensure short circuit proof cable laying (DIN EN 60439-1, Section 7.5.5.1.2) between terminal block and short circuit protection device (e.g. 5SY..) connected downstream.

Attention

Veiller à ce que les conducteurs reliant le bornier au dispositif de protection contre les courts-circuits branché en aval (par ex. 5SY..) soient posés de manière à empêcher tout court-circuit (EN 60439-1 paragraphe 7.5.5.1.2).

Atención

Tender los cables de modo que queden protegidos contra cortocircuitos (DIN EN 60439-1, apartado 7.5.5.1.2) desde el bloque de bornes hasta el equipo de protección contra cortocircuitos conectado en serie (p. ej.: 5SY..).

Attenzione

Assicurare una posa dei cavi resistente al cortocircuito (DIN EN 60439-1, sezione 7.5.5.1.2) dal blocco morsetti al dispositivo di protezione contro cortocircuito collegato a valle (ad es.: 5SY..).

Atenção

Ter atenção a uma colocação resistente a curto-circuito da fiação (DIN EN 60439-1 seção 7.5.5.1.2) do bloco de bornes até ao dispositivo de proteção contra curto-circuito conectado a jusante (p. ex. 5SY..)!

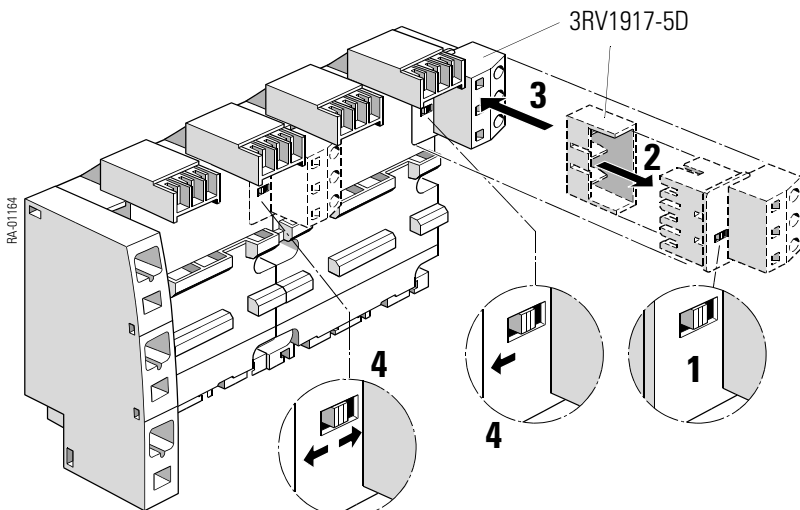

Systemaufbau mit Klemmenblock 3RV1917-5D
 System configuration with terminal block 3RV1917-5D
 Configuration système avec bornier 3RV1917-5D
 Configuración con bloque de bornes 3RV1917-5D
 Struttura del sistema con blocco morsetti 3RV1917-5D
 Estrutura do sistema com bloco de bornes 3RV1917-5D

	$I_d \text{ max}$	I^2t	¹⁾ (50 kA/440 V AC)
4 mm ²	<9,5 kA	85 kA ² s	3RV1021-4DA10
6 mm ²	<12,5 kA	140 kA ² s	3RV1031-4EA10
10 mm ²	<15 kA	180 kA ² s	3RV1031-4HA10
16 mm ² 25 mm ²	<19 kA	440 kA ² s	3RV1042-4JA10

¹⁾ Empfehlung für vorgeschaltetes Kurzschlusschutzgerät
 Series-connected short-circuit protective device recommended
 Recommendation pour appareil de protection contre les courts-circuits en amont
 Protección contra cortocircuitos conectada en serie recomendada
 Raccomandazione per dispositivo di protezione contro cortocircuito collegato a monte
 Recomendação para dispositivo de proteção contra curto-circuito conectado a montante

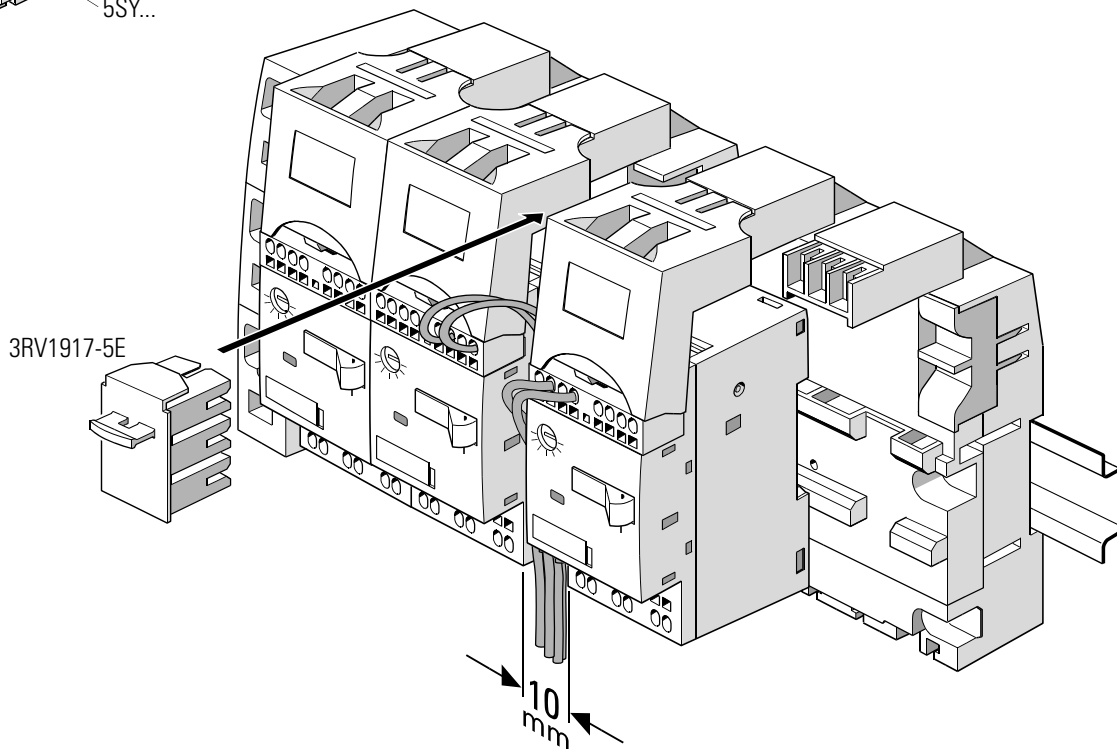
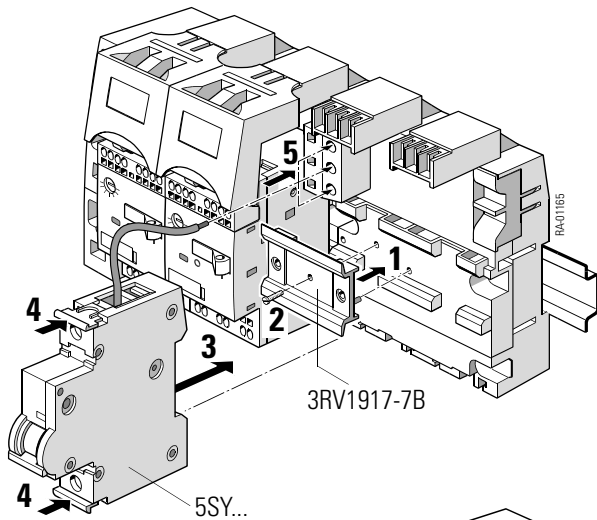
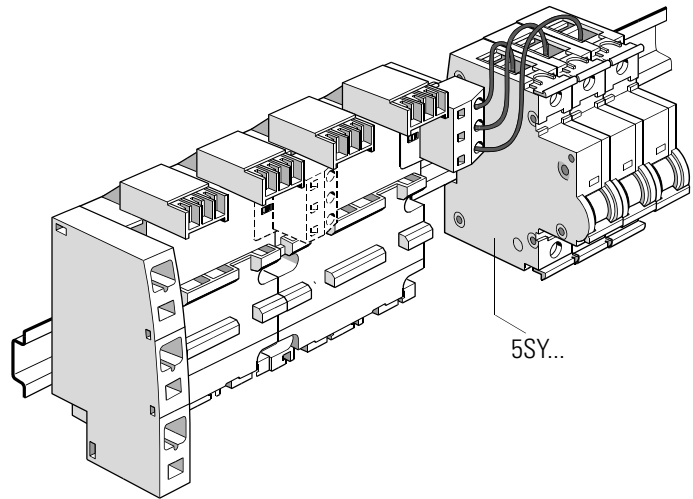
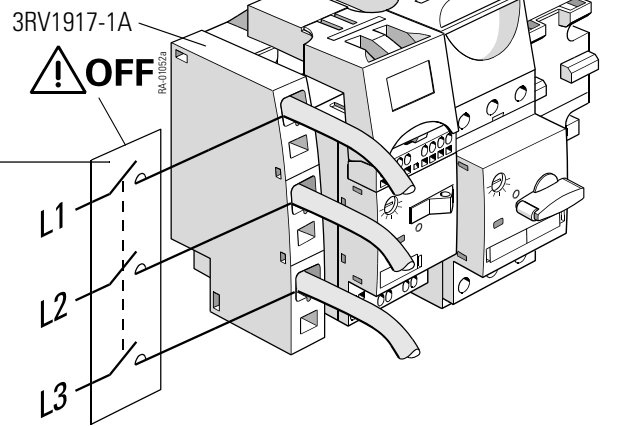

Demontage
Disassembly
Démontage
Desmontaje
Smontaggio
Desmontagem

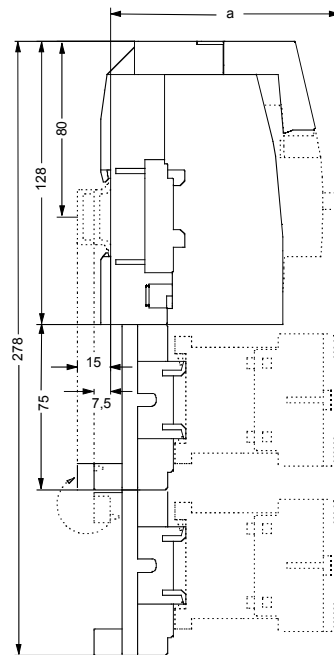
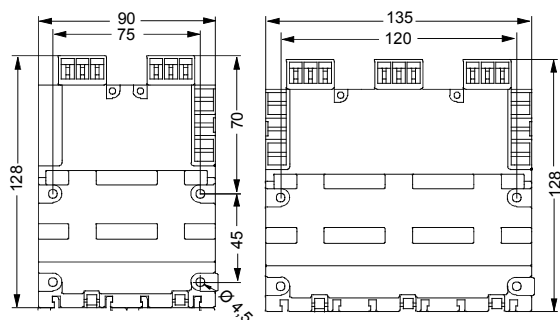
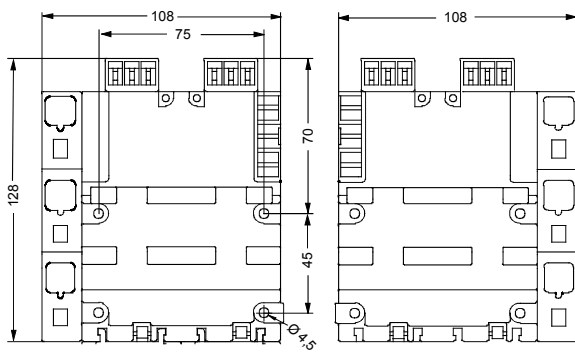
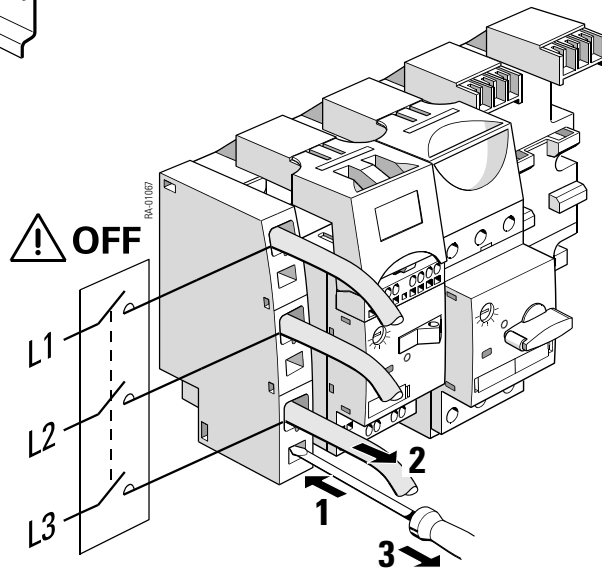
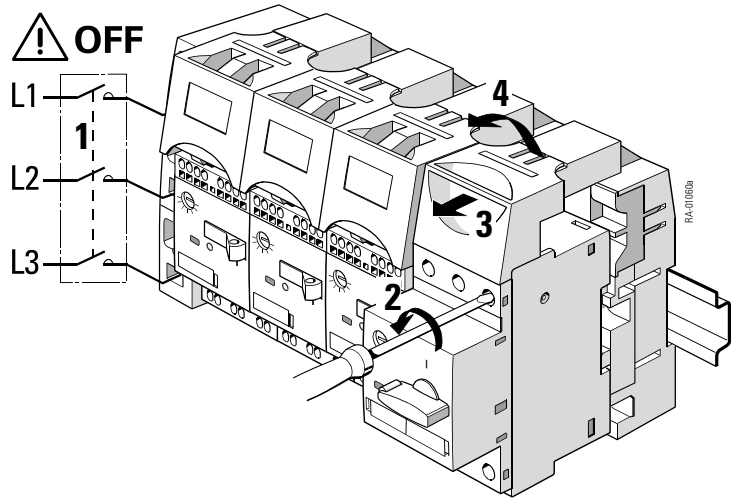
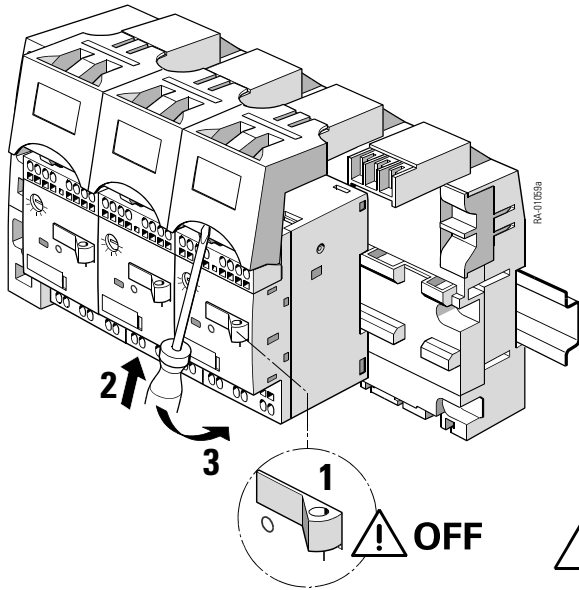

	S00	S0
a	104	125

Technical Assistance: Telephone: +49 (0) 911-895-5900 (8⁰⁰ - 17⁰⁰ CET)
 E-mail: technical-assistance@siemens.com
 Internet: www.siemens.de/lowvoltage/technical-assistance

Fax: +49 (0) 911-895-5907

Technical Support: Telephone: +49 (0) 180 50 50 222

Technische Änderungen vorbehalten. Zum späteren Gebrauch aufbewahren!
 Subject to change without prior notice. Store for use at a later date.
 © Siemens AG 2003

Bestell-Nr./Order No.: 3ZX1012-ORV10-2BA1
 Printed in the Federal Republic of Germany