

## DETAILS

<b>Product Number</b>	CA14120_STRADA-SQ-FS2
<b>Family</b>	Strada-SQ
<b>Type</b>	Lens
<b>Color</b>	clear
<b>Diameter</b>	25x25 mm
<b>Height</b>	8.2 mm
<b>Style</b>	square
<b>Optic Material</b>	PMMA
<b>Holder Material</b>	
<b>Fastening</b>	pin, tape
<b>Status</b>	ready
<b>ROHS Compliant</b>	Yes
<b>Date Updated</b>	25/03/2015



## OPTICAL PROPERTIES

LED	Viewing Angle	Light Beam	Efficiency	cd/lm	Connector
XHP70	Asymmetric deg	Streetligh...	78 %	0.420	: Protective Plate, Glass
MK-R	Asymmetric deg	Streetligh...	81 %	0.425	-
LUXEON M	Asymmetric deg	Streetligh...	81 %	0.440	-
MHB-A	sim: Asym	Streetligh...	-	sim: 0.000	-

D

C

B

A

4

4

Tape

∅2

25.4

c/c

21.52

c/c

Bottom view

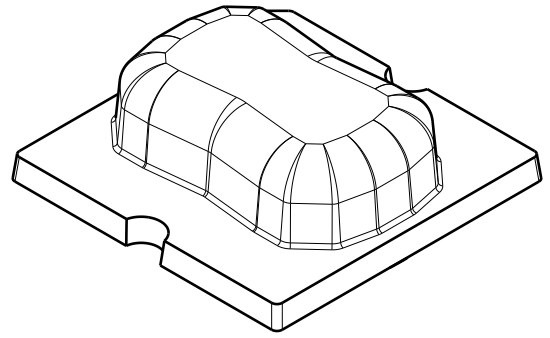

Isometric view

3

3

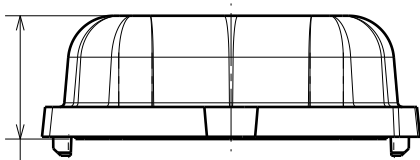

8.15

Front view

with tape

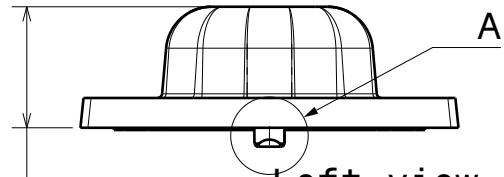

8

Left view

w/o tape

A

2

2

25

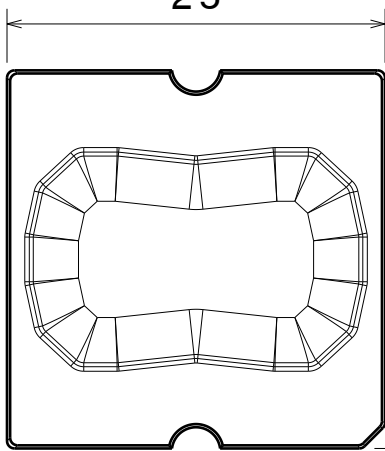

25

Top view

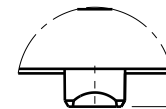

Detail A

1.25

Tolerances if not otherwise shown  
 According to DIN ISO 2768-1  
 Linear measures:  
 Up to 30mm class M, otherwise class C.  
 According to DIN ISO 2768-2  
 Form and position: class L

LEDiL

Ledil Oy  
 Salorankatu 10  
 FIN 24240 SALO  
 Finland

THIRD ANGLE PROJECTION:

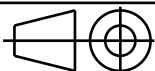

DRAWING TITLE

Datasheet STRADA-SQ-FS2

This drawing is the property  
 of LEDiL Oy. It may not be  
 reproduced, copied or  
 communicated without a written  
 agreement with LEDiL Oy.

SIZE

A4

PART NUMBER

-

SCALE

2:1

WEIGHT

-

SHEET

1/1

D

A

1

1

Luminaire: LEDiL Oy CA14120\_STRADA-SQ-FS2\_(XHP70)\_glass

Lamps: 1 x Cree\_XHP70\_glass-chassis\_260.488lm@250mA\_P=1.38405W\_I=0.2499A

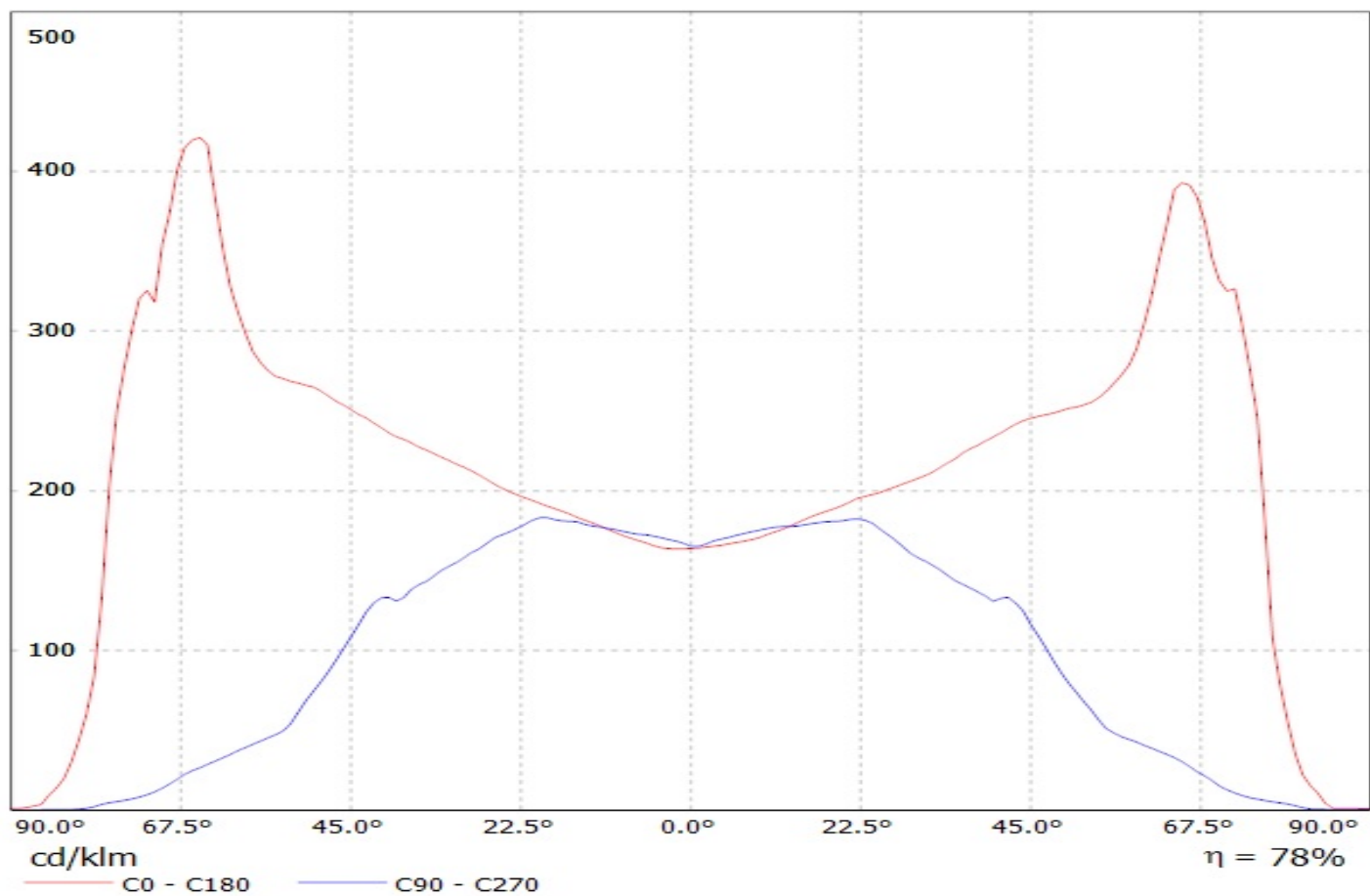

Luminaire: LEDiL Oy CA14120\_STRADA-SQ-FS2\_(MK-R)+glass Eff.80.8%  
Lamps: 1 x Cree\_MK-R\_354.207lm@250mA\_CCT=3276K\_P=2.84547W\_I=249.8mA

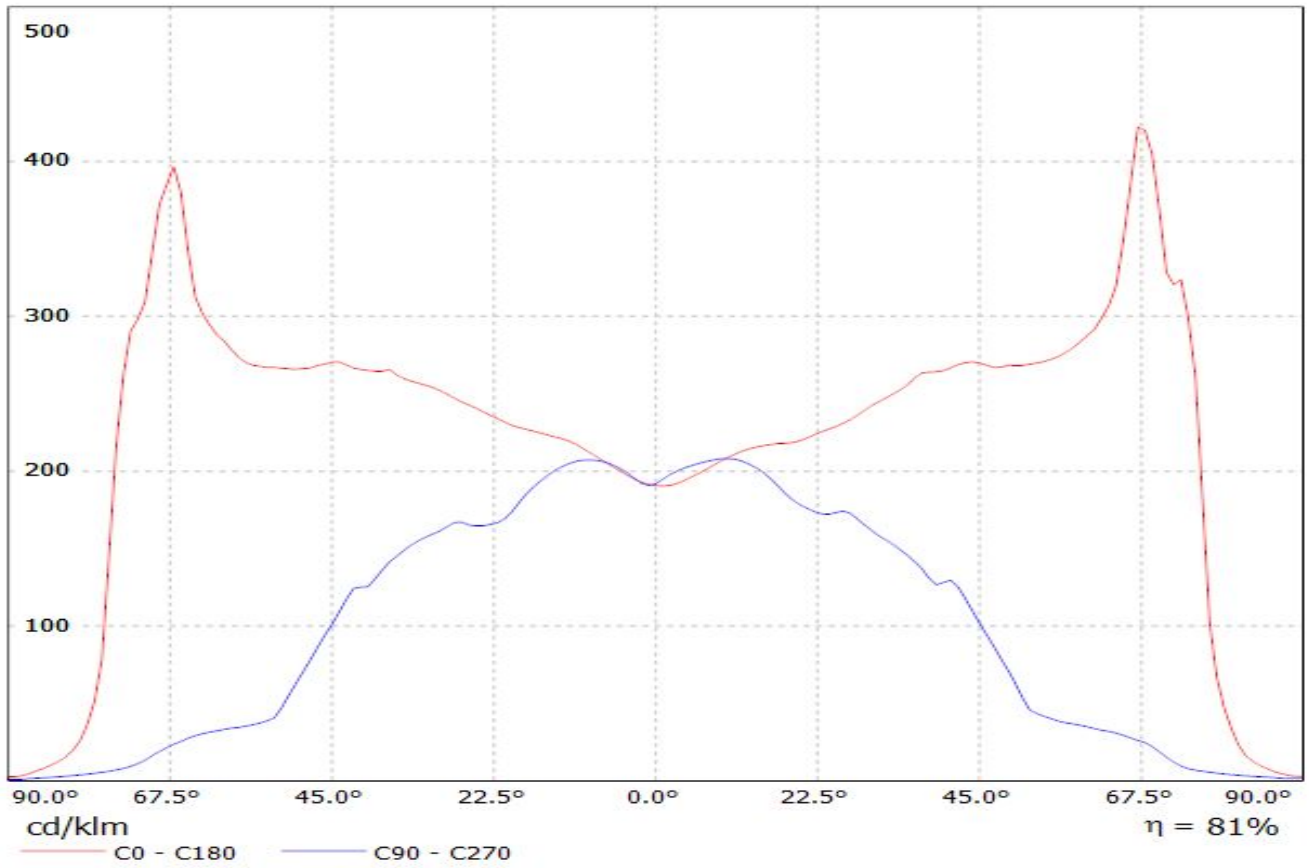

Luminaire: LEDiL Oy CA14120\_&\_CA14122\_(LUXEON\_M)\_glass  
Lamps: 1 x LUXEON\_M\_(LXR7-SW30)\_340lm@250mA\_P=2.79W\_I=249.8mA

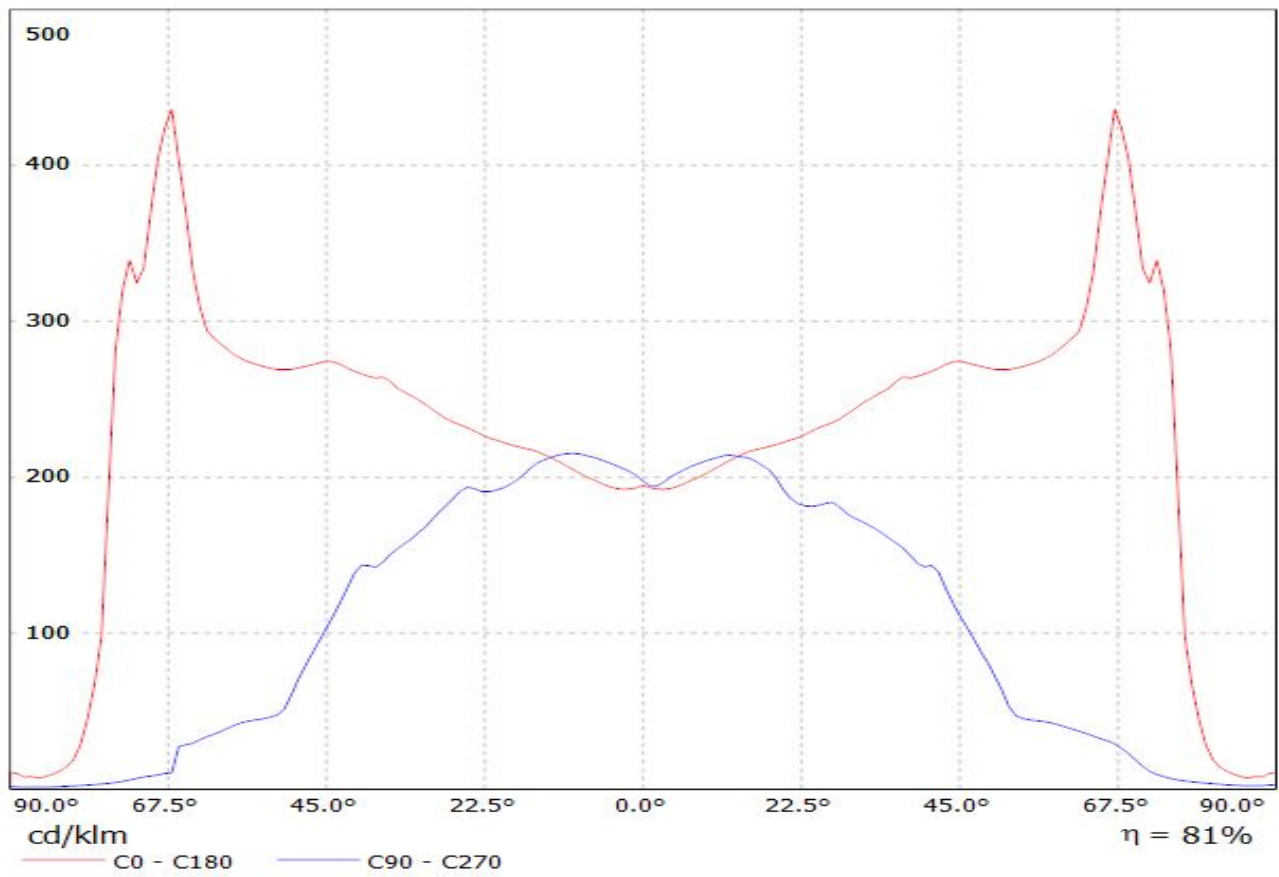

Luminaire: LEDiL Oy CA14120\_STRADA-SQ-FS2\_(XHP70)\_glass

Lamps: 1 x Cree\_XHP70\_glass-chassis\_260.488lm@250mA\_P=1.38405W\_I=0.2499A

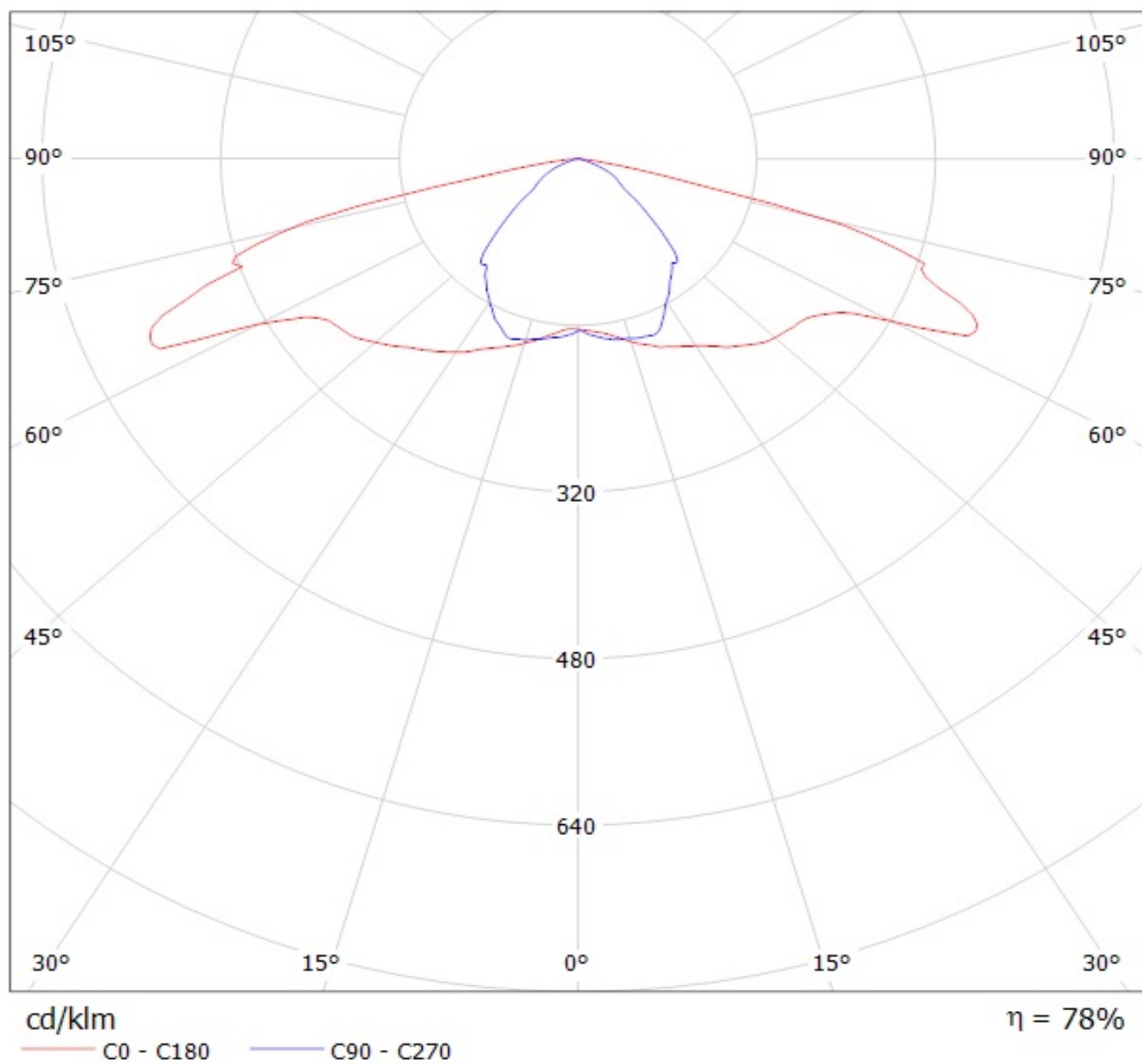

Luminaire: LEDiL Oy CA14120\_STRADA-SQ-FS2\_(MK-R)+glass Eff.80.8%  
Lamps: 1 x Cree\_MK-R\_354.207lm@250mA\_CCT=3276K\_P=2.84547W\_I=249.8mA

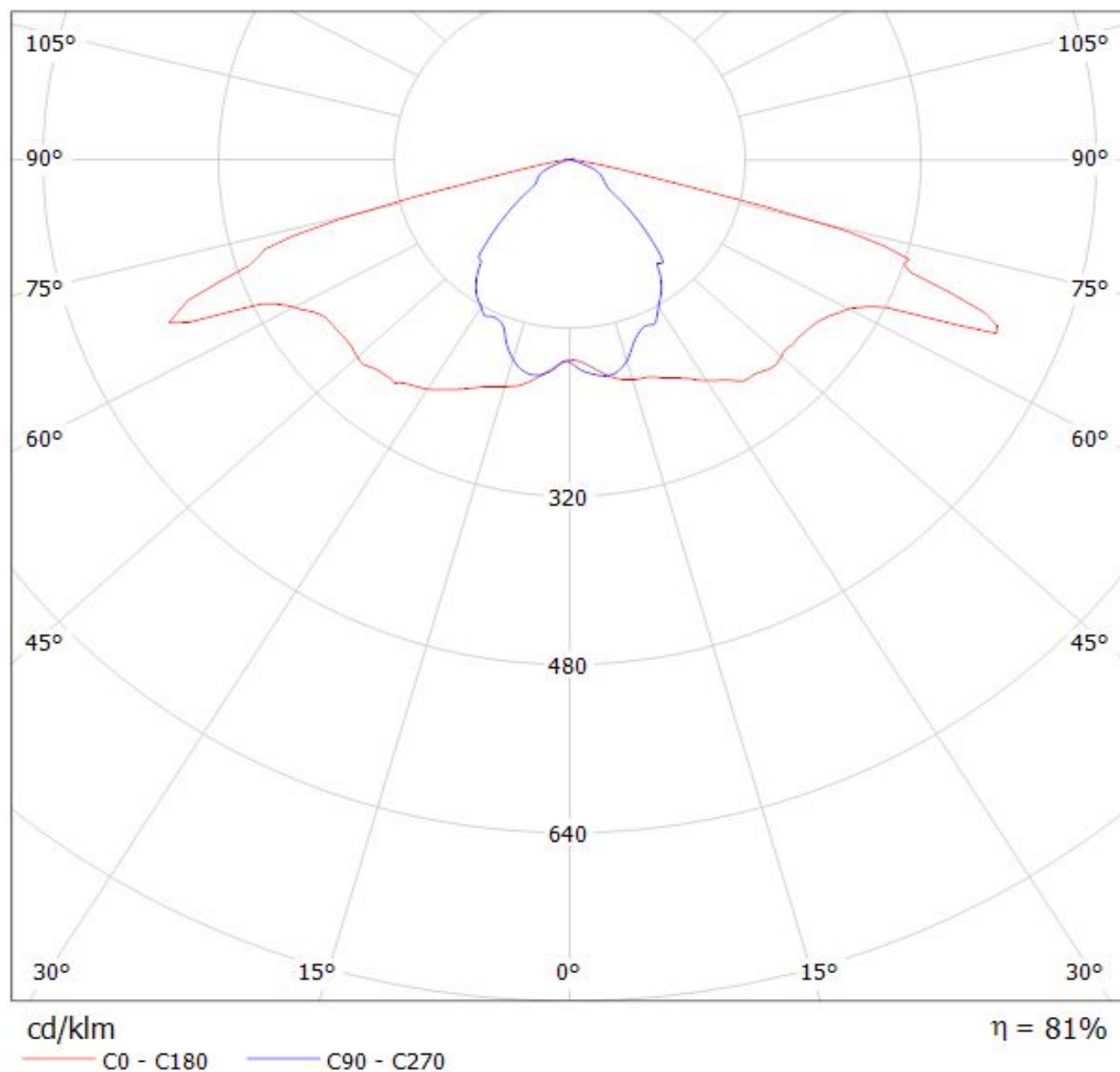

Luminaire: LEDiL Oy CA14120\_ & CA14122\_(LUXEON\_M)\_glass  
Lamps: 1 x LUXEON\_M\_(LXR7-SW30)\_340lm@250mA\_P=2.79W\_I=249.8mA

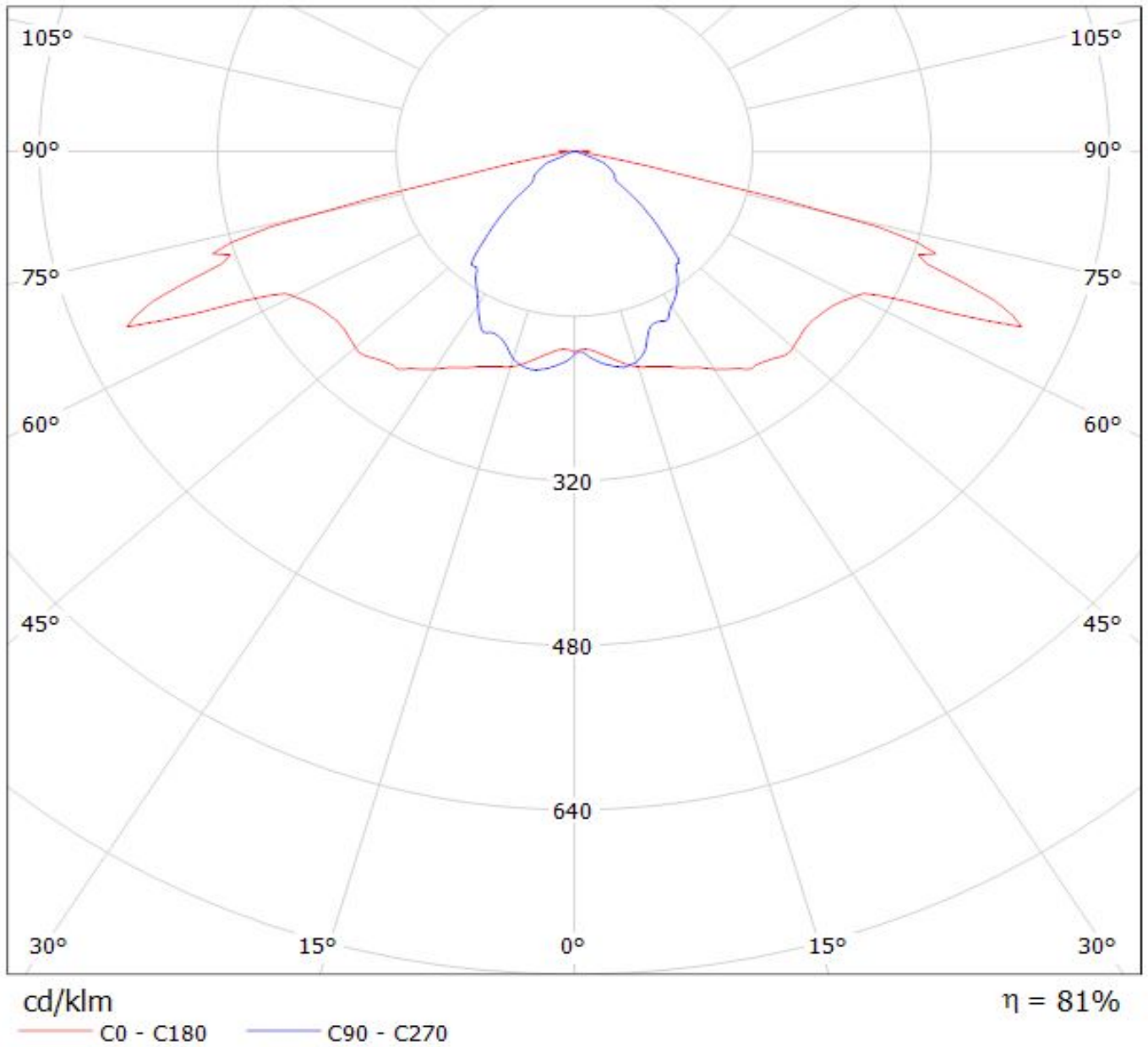

**NOTE: The typical divergence will be changed by different color, chip size and chip position tolerance. The typical total divergence is the full angle measured where the luminous intensity is half of the peak value.**