

Deep groove ball bearings, single row

Principal dimensions			Basic load ratings		Fatigue load limit P_u	Speed ratings		Mass	Designation
d	D	B	dynamic	static		Reference speed	Limiting speed		
mm			kN		kN	r/min		kg	-
80	170	39	130	86,5	3,25	8500	5300	3,60	6316 *

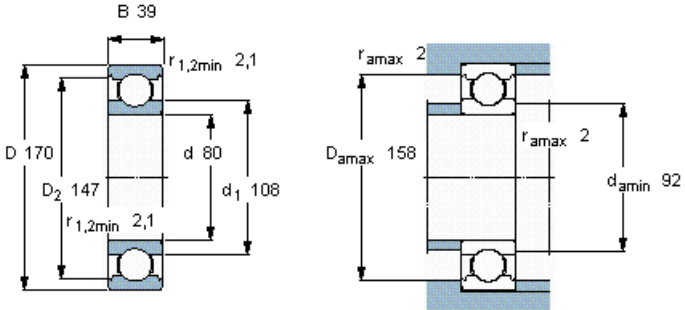

Calculation factors

k_r 0,03
 f_0 13