

## DETAILS

<b>Product Number</b>	FP13026_LISA2-WW-PIN
<b>Family</b>	Lisa2
<b>Type</b>	Assembly
<b>Color</b>	black
<b>Diameter</b>	9,9 mm
<b>Height</b>	6,8 mm
<b>Style</b>	round
<b>Optic Material</b>	PMMA
<b>Holder Material</b>	PC
<b>Fastening</b>	pin, glue
<b>Status</b>	ready
<b>ROHS Compliant</b>	Yes
<b>Date Updated</b>	3/10/2013



## OPTICAL PROPERTIES

LED	Viewing Angle	Light Beam	Efficiency	cd/lm	Connector
LUXEON Q	sim: 54	Very Wide	sim: 84 %	sim: 1.000	-
SFH4725s (IR)	34 deg	Very Wide	-	sim: 0.000	-
SFH 4715S (IR)	36 deg	Very Wide	-	sim: 0.000	-
NCSxx19B	41 deg	Very Wide	86 %	1.500	-
XP-E2	43 deg	Very Wide	88 %	1.350	-
XT-E	47 deg	Very Wide	84 %	1.100	-
XP-G2	47 deg	Very Wide	88 %	1.200	-
LH351B	56 deg	Very Wide	88 %	1.020	-
LH351Z	60 deg	Very Wide	90 %	0.950	-

Relative intensity of FP13026\_LISA2-WW-PIN\_(SFH4725S)

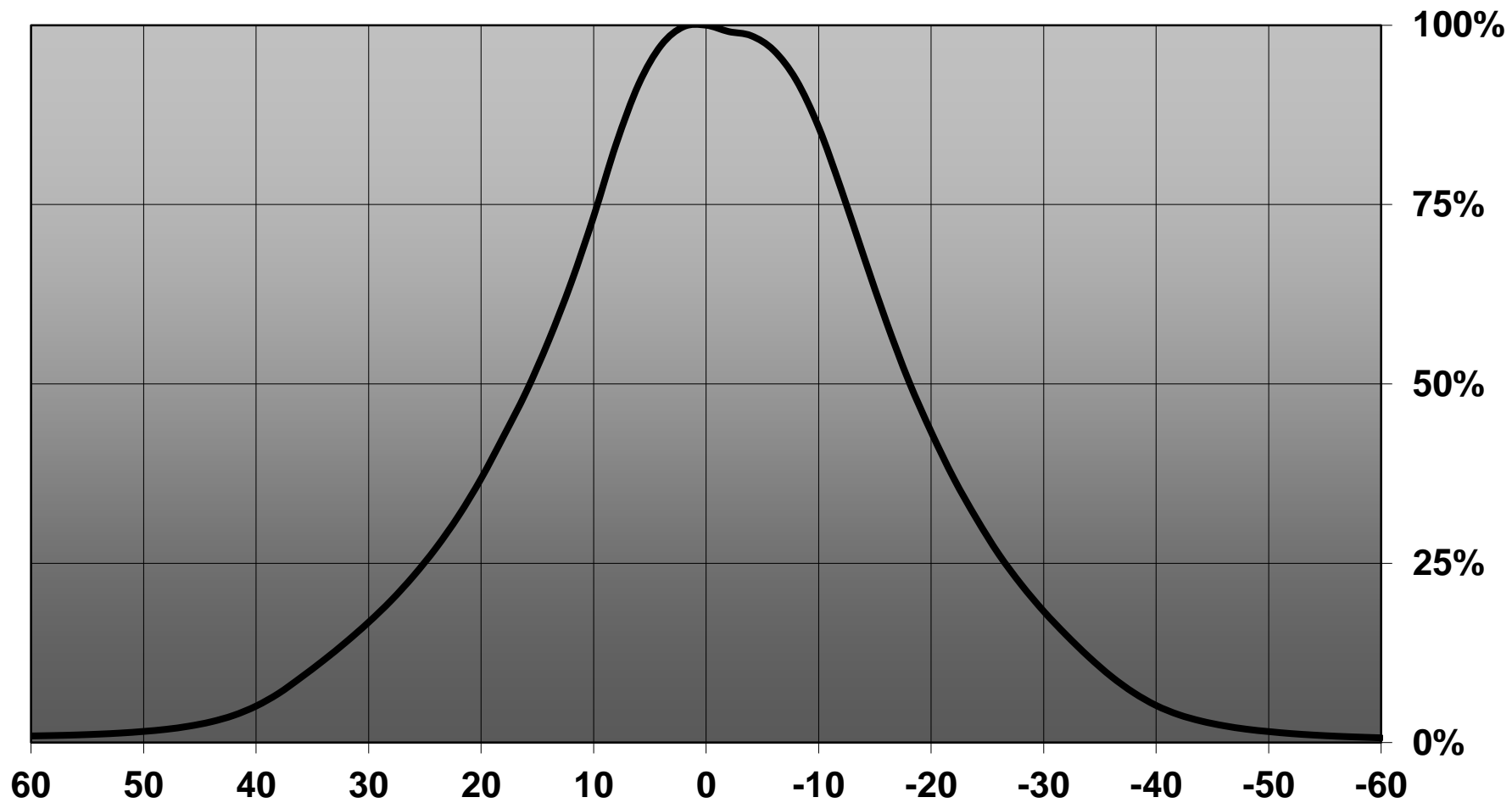

Relative intensity of FP13029&FP13026\_LISA2-WW-SFH-IR

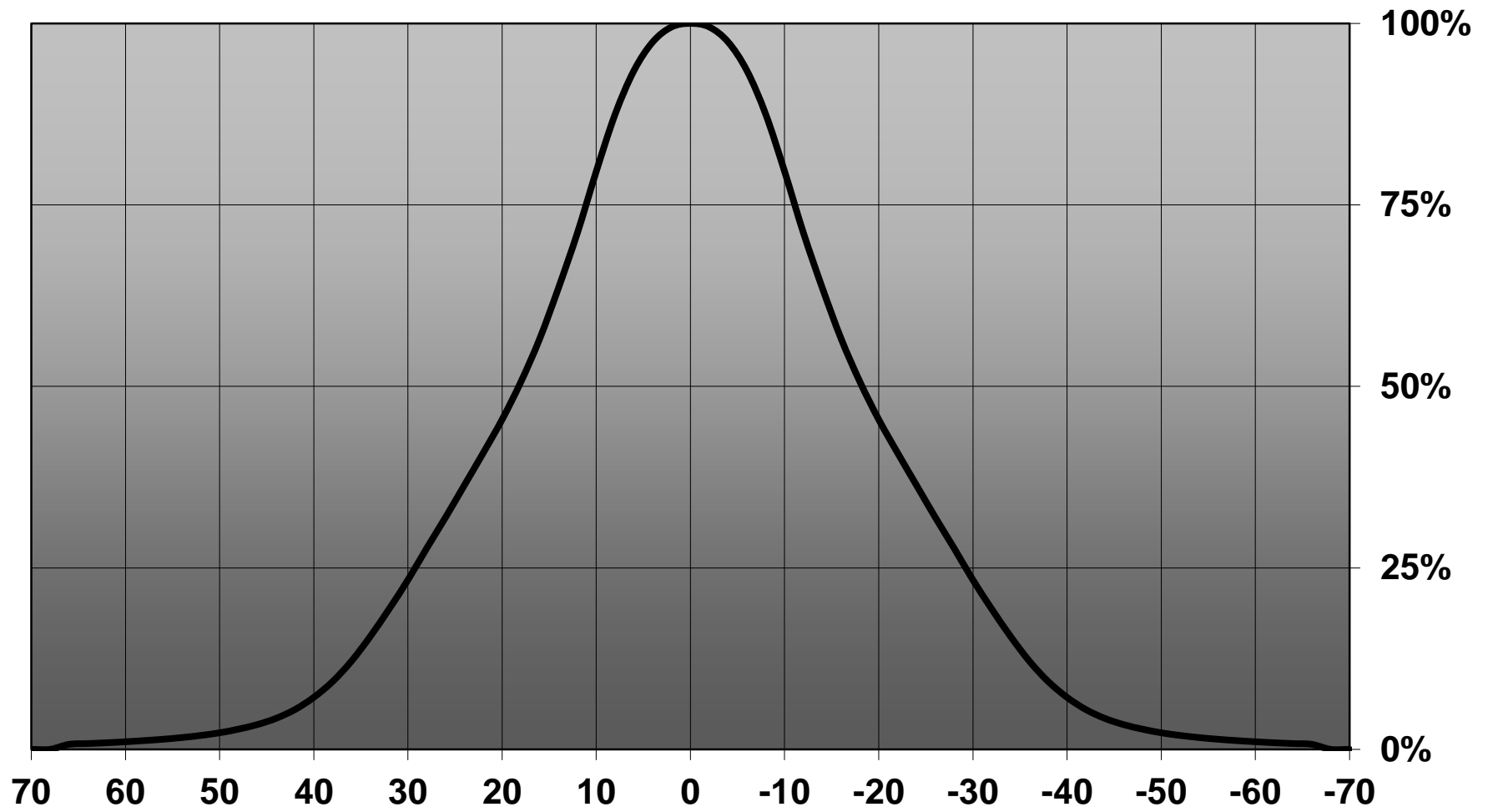

Relative intensity of FP13026\_LISA2-WW-PIN (LH351B)

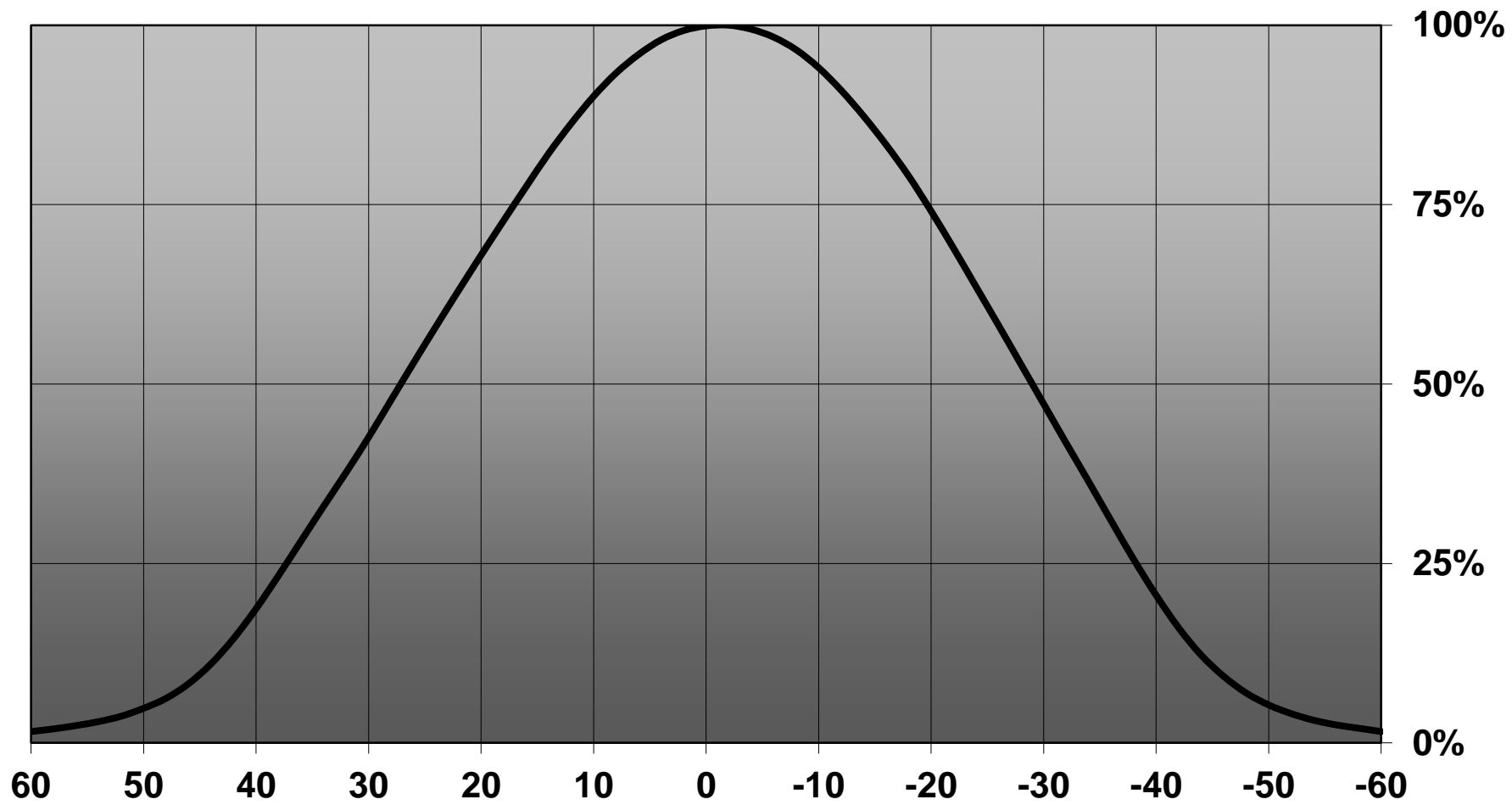

D

C

B

A

4

4

3

3

2

2

1

1

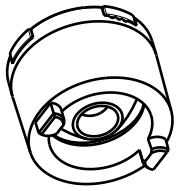
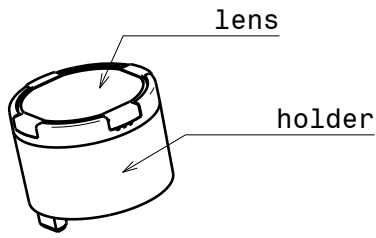

Isometric view  
Scale: 2:1

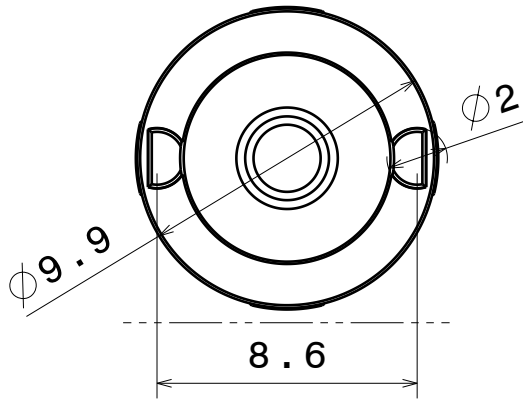

Bottom view

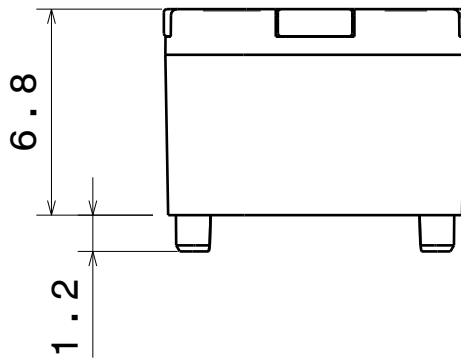

Front view

Materials:  
Lens PMMA  
Holder PC

This drawing is our property.  
It can't be reproduced  
or communicated without  
our written agreement.



Ledil Oy  
Salorankatu 10  
FIN-24240 SALO  
Finland

DRAWING TITLE

Datasheet Lisa2-Pin-XT Series Assy

DRAWN BY pl	DATE 20.06.2012	DRAWING TITLE Datasheet Lisa2-Pin-XT Series Assy		
CHECKED BY	DATE	SIZE A4	DRAWING NUMBER	REV 1
DESIGNED BY pl	DATE 20.06.2012	SCALE 4:1	WEIGHT (g)	SHEET 1/1

D

A

Luminaire: Ledil Oy FP13026&FP13029\_LISA2-WW-PIN\_(NCSxx19B) Eff. 86%  
Lamps: 1 x Nichia NCSxx19B (NCSL119BE) 88lm @ 250mA CCT=3000K P=0.8W I=250mA

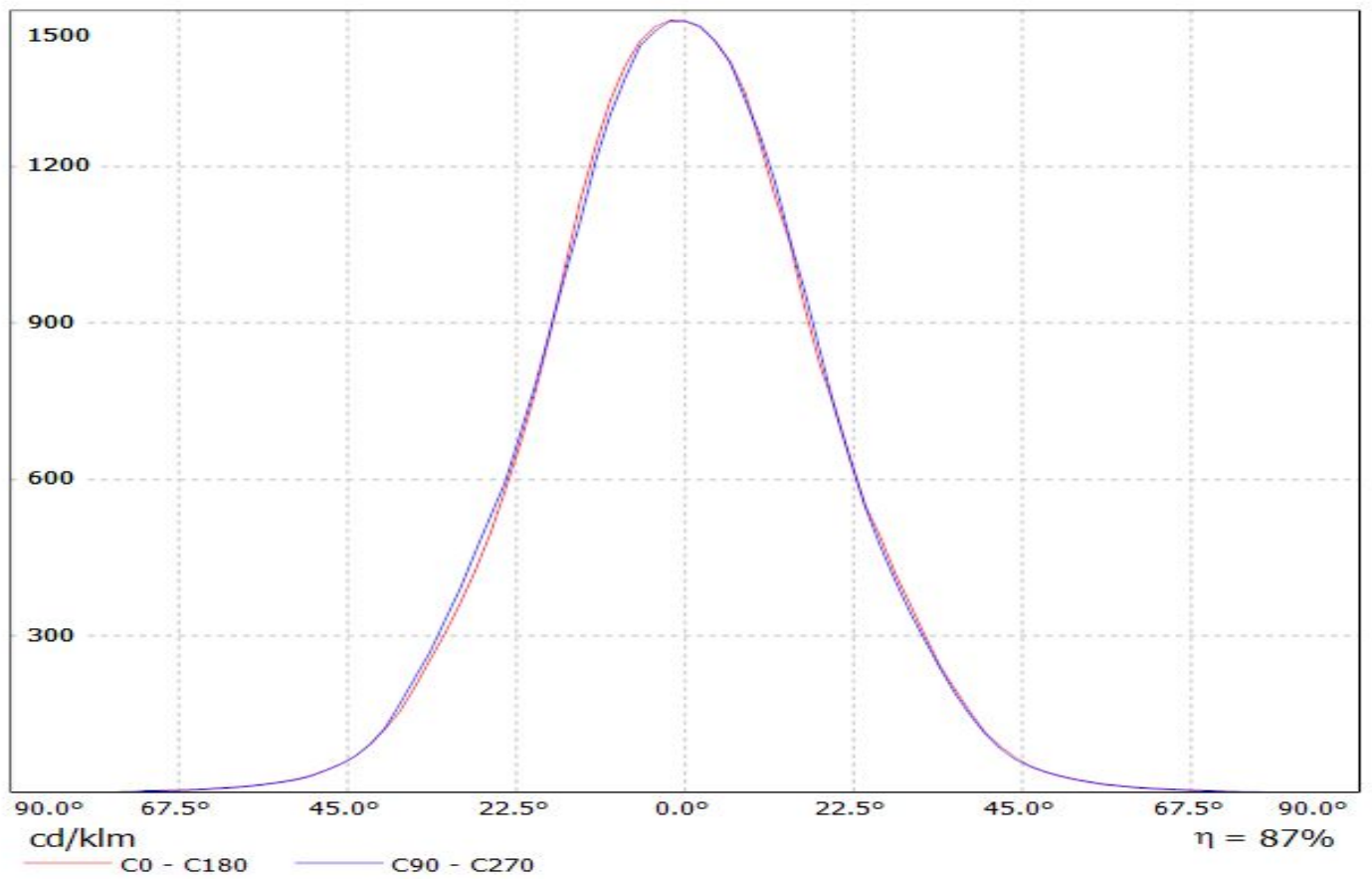

Luminaire: Ledil Oy FP13026&FP13029\_LISA2-WW\_PIN&CLIP (XP-E2) Eff. 88%  
Lamps: 1 x Cree XP-E2 cool white 92lm@250mA CCT=5600K P=0.75W I=250mA

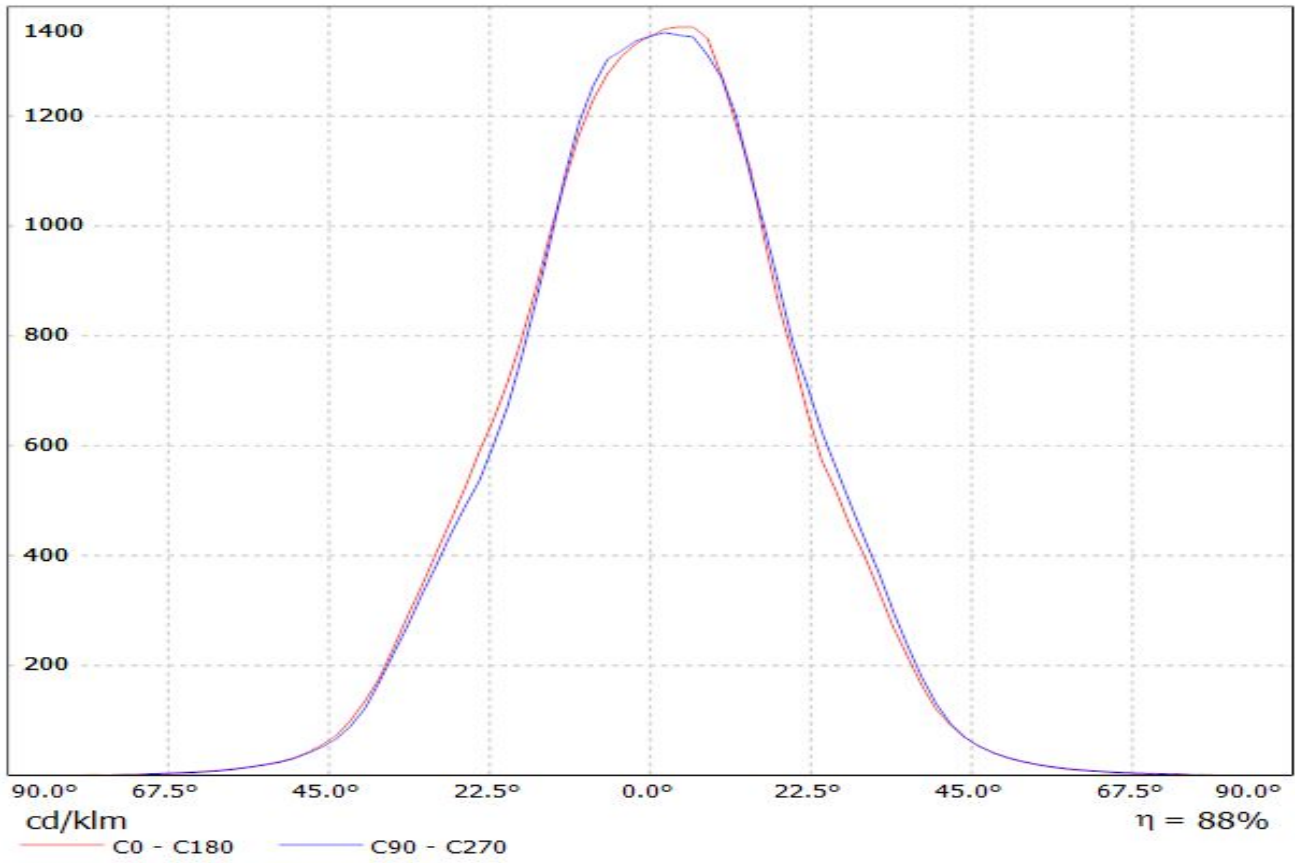

Luminaire: LEDIL OY FP13026\_LISA2-WW-PIN & FP13029\_LISA2-WW-CLIP-XTE (Cree XT-E 98lm @ 250mA) Efficiency=84%  
Lamps: 1 x CREE XT-E (98.9lm)

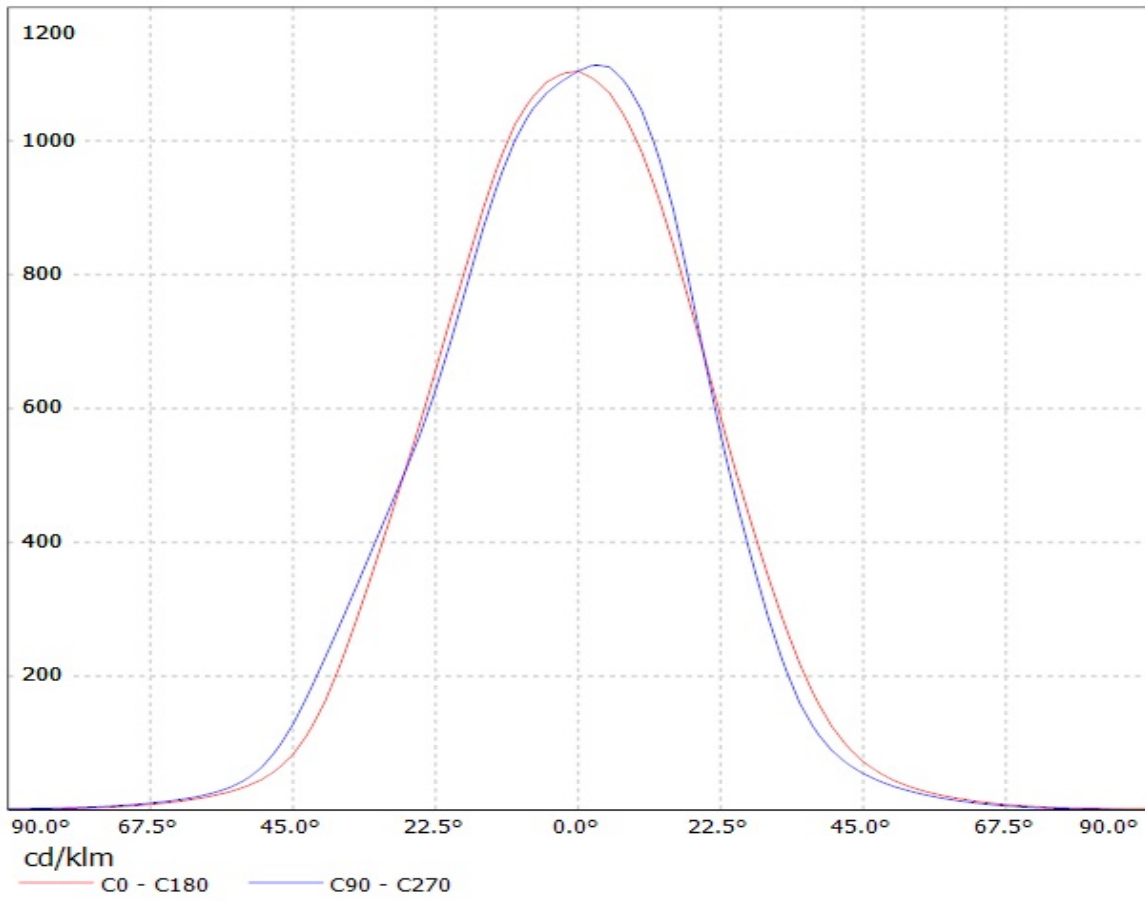

Luminaire: LEDiL Oy FP13026&FP13029\_LISA2-WW\_(XP-G2) Eff. 89%  
Lamps: 1 x Cree\_(XP-G2) 104lm@250mA CCT=6600K P=0.76W I=250mA

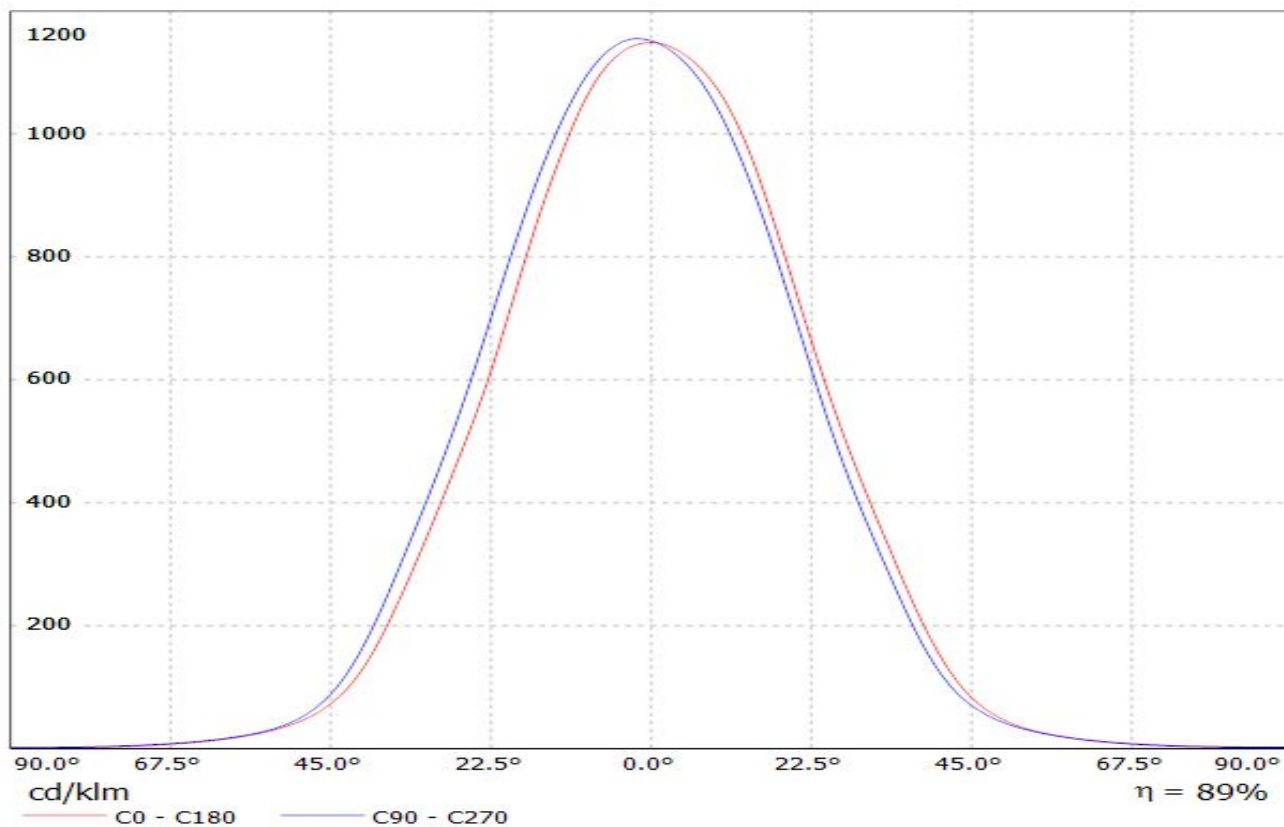

Luminaire: LEDil Oy FP13026\_LISA2-WW-PIN\_(LH351Z)

Lamps: 1 x Samsung LH351Z (90.14lm @ 250mA) CCT=6500K P=0.7W I=250mA

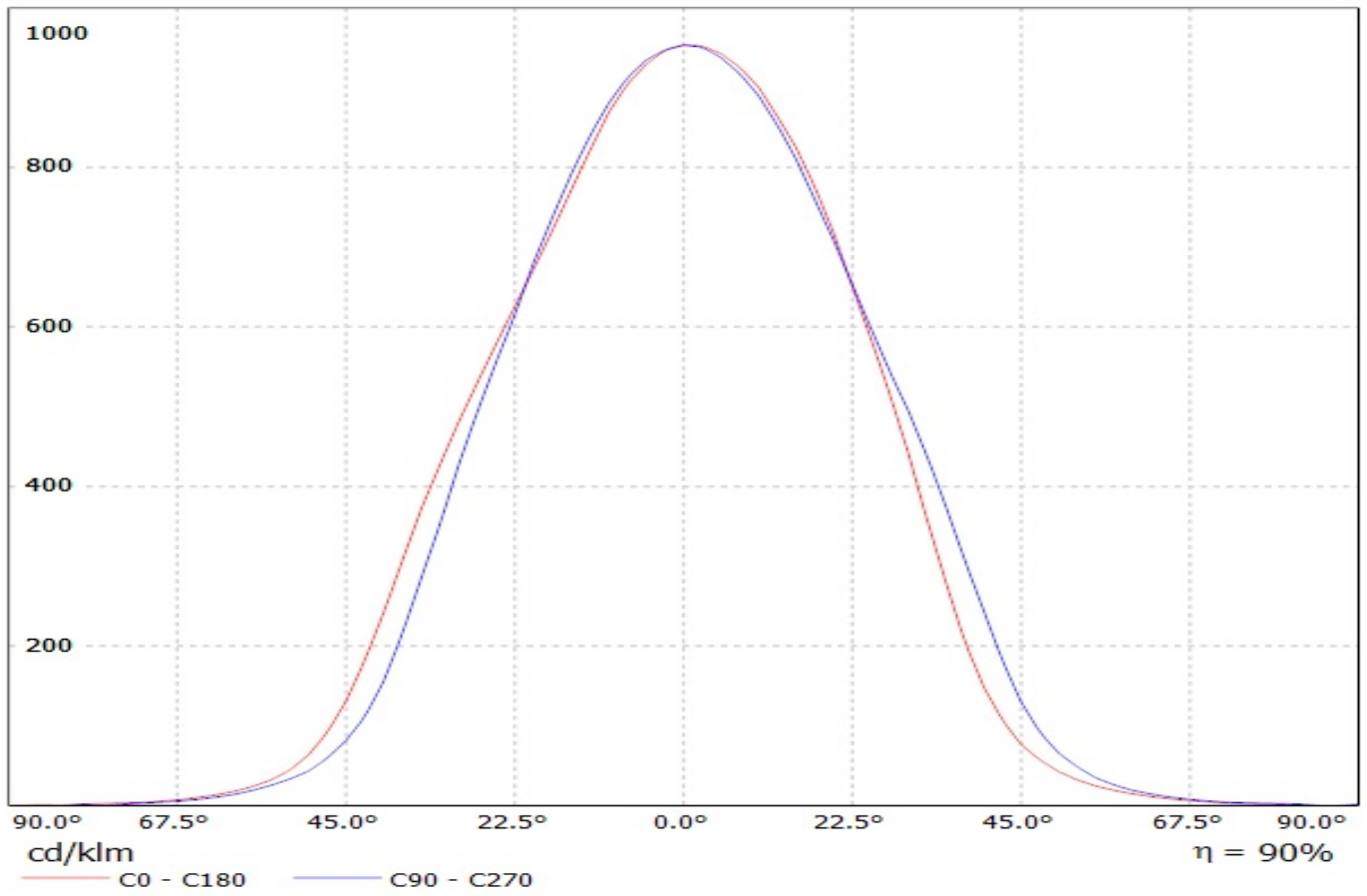

Luminaire: Ledil Oy FP13026&FP13029\_LISA2-WW-PIN\_(NCSxx19B) Eff. 86%  
Lamps: 1 x Nichia NCSxx19B (NCSL119BE) 88lm @ 250mA CCT=3000K P=0.8W I=250mA

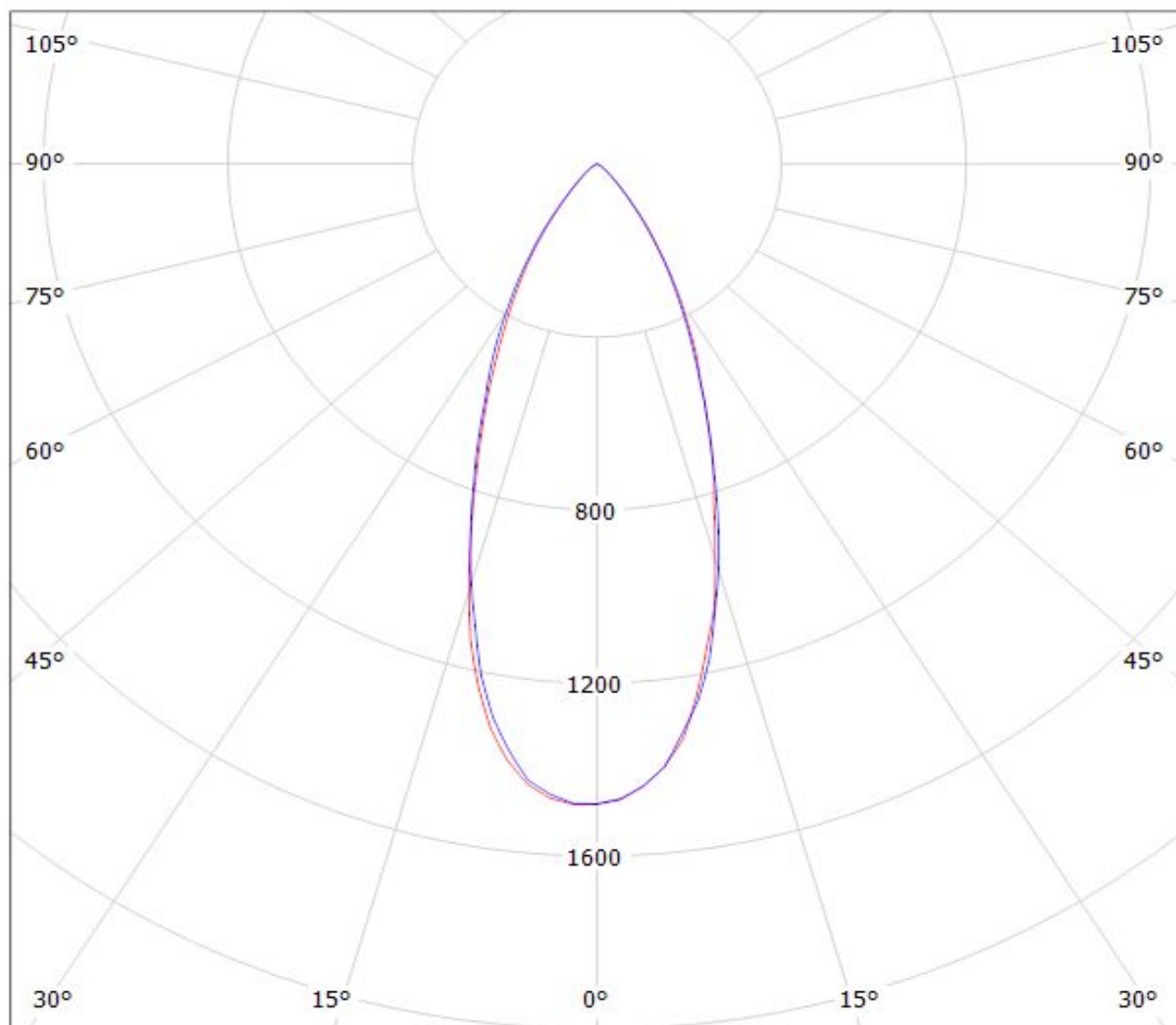

cd/klm

— C0 - C180

— C90 - C270

$\eta = 87\%$

Luminaire: Ledil Oy FP13026&FP13029\_LISA2-WW\_PIN&CLIP (XP-E2) Eff. 88%  
Lamps: 1 x Cree XP-E2 cool white 92lm@250mA CCT=5600K P=0.75W I=250mA

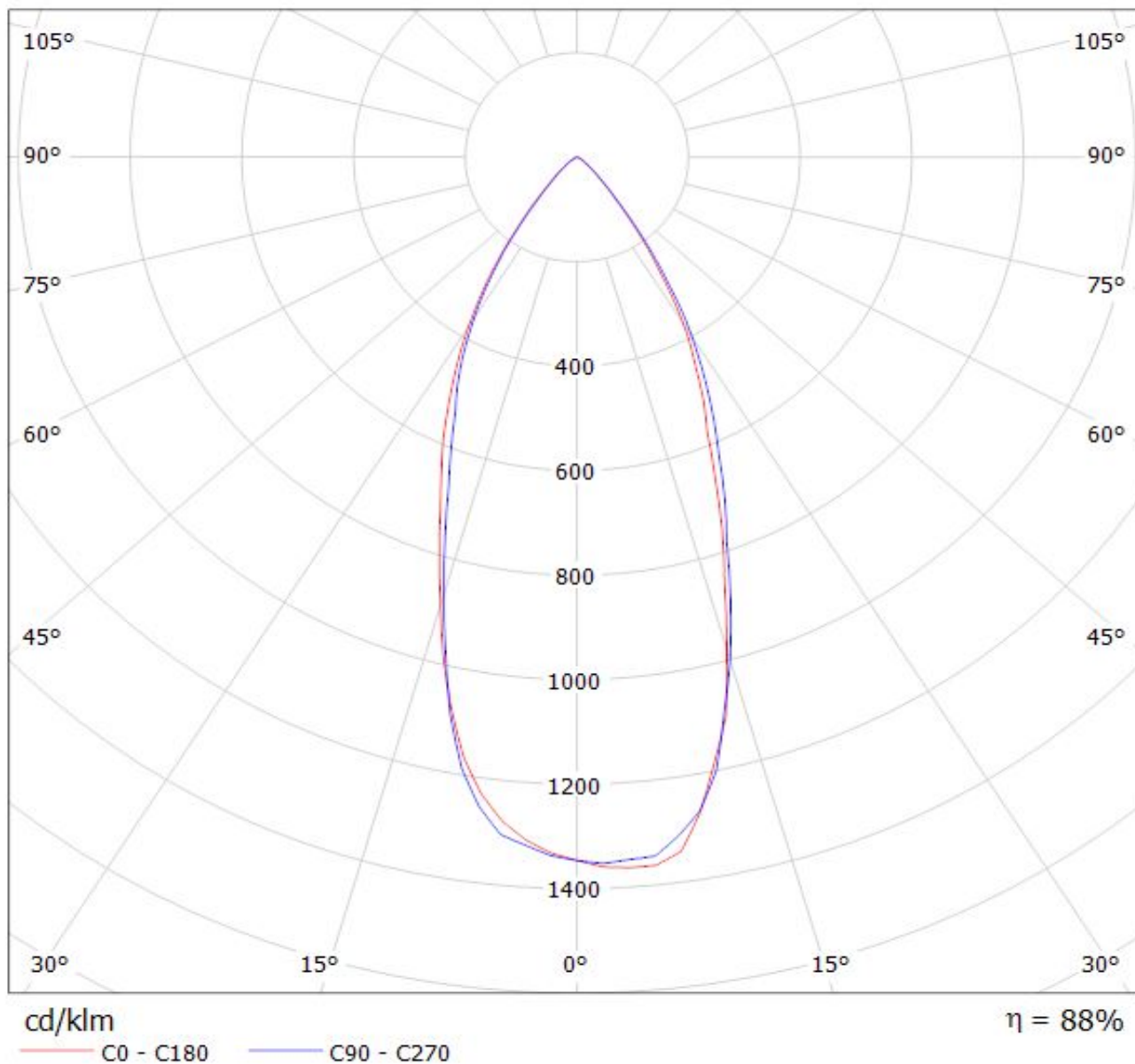

Luminaire: LEDIL OY FP13026\_LISA2-WW-PIN & FP13029\_LISA2-WW-CLIP-XTE (Cree XT-E 98lm @ 250mA) Efficiency=84%  
Lamps: 1 x CREE XT-E (98.9lm)

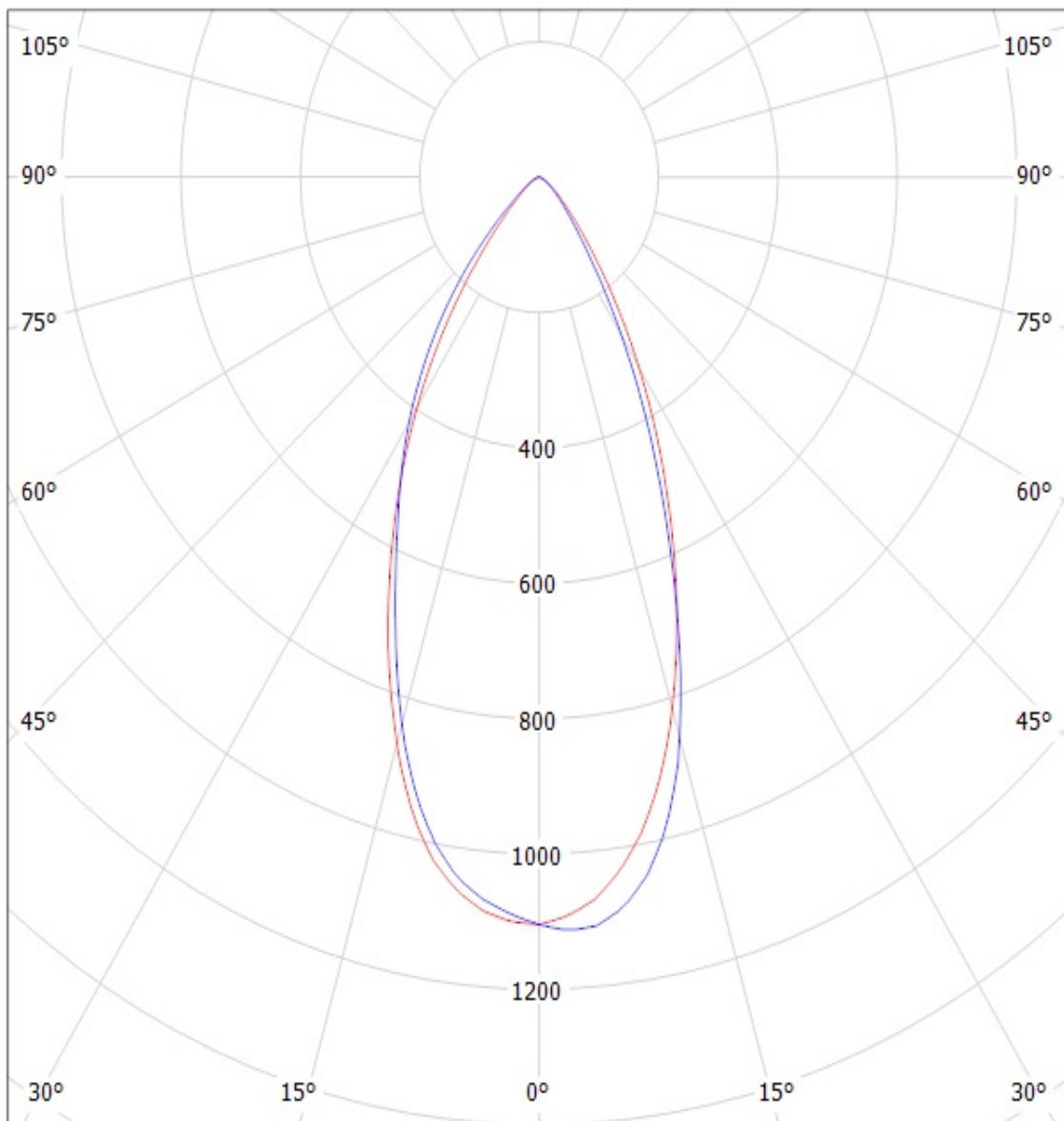

cd/klm

— C0 - C180    — C90 - C270

Luminaire: LEDiL Oy FP13026&FP13029\_LISA2-WW\_(XP-G2) Eff. 89%  
Lamps: 1 x Cree\_(XP-G2) 104lm@250mA CCT=6600K P=0.76W I=250mA

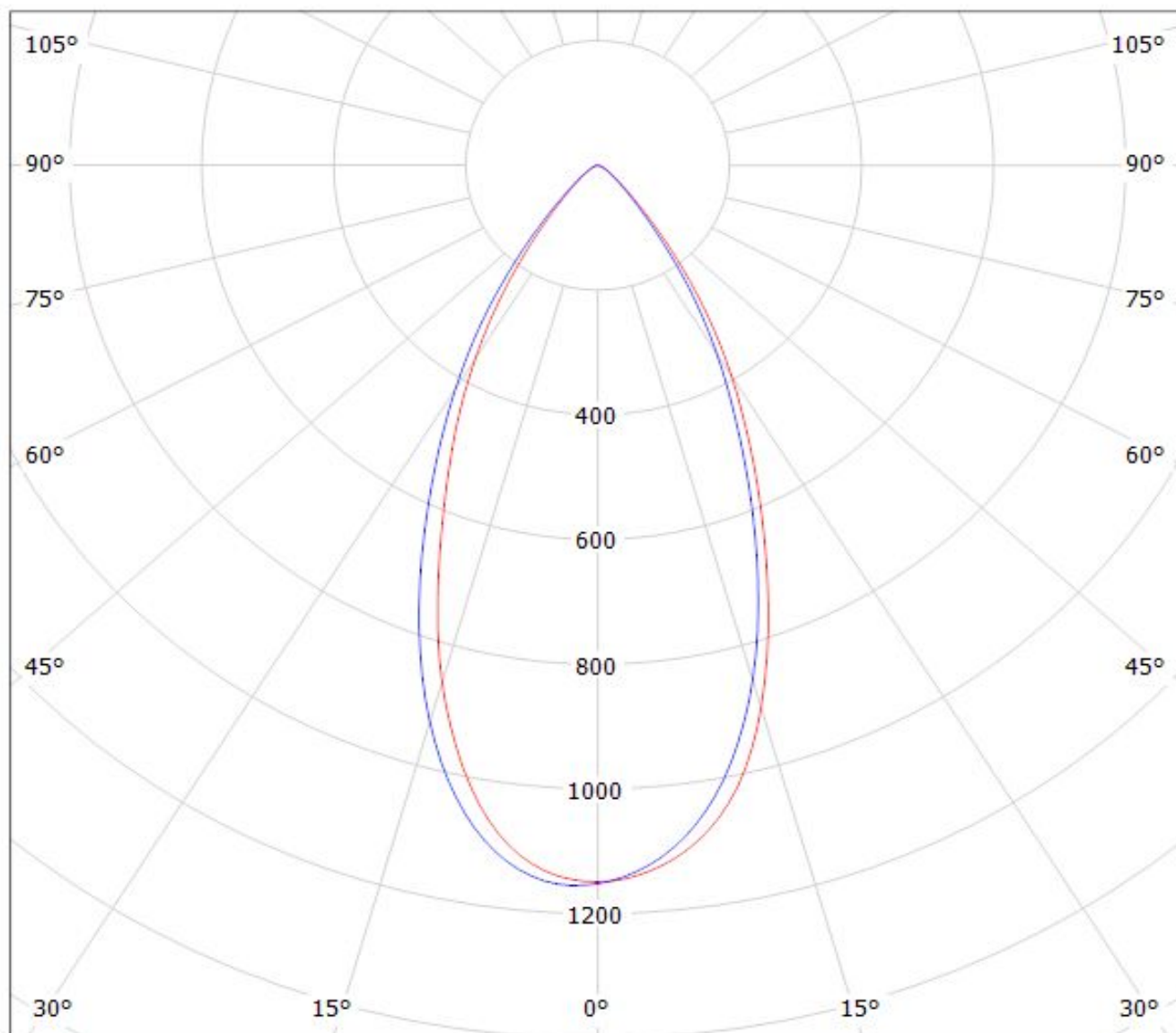

cd/klm

$\eta = 89\%$

— C0 - C180

— C90 - C270

Luminaire: LEDil Oy FP13026\_LISA2-WW-PIN\_(LH351Z)

Lamps: 1 x Samsung LH351Z (90.14lm @ 250mA) CCT=6500K P=0.7W I=250mA

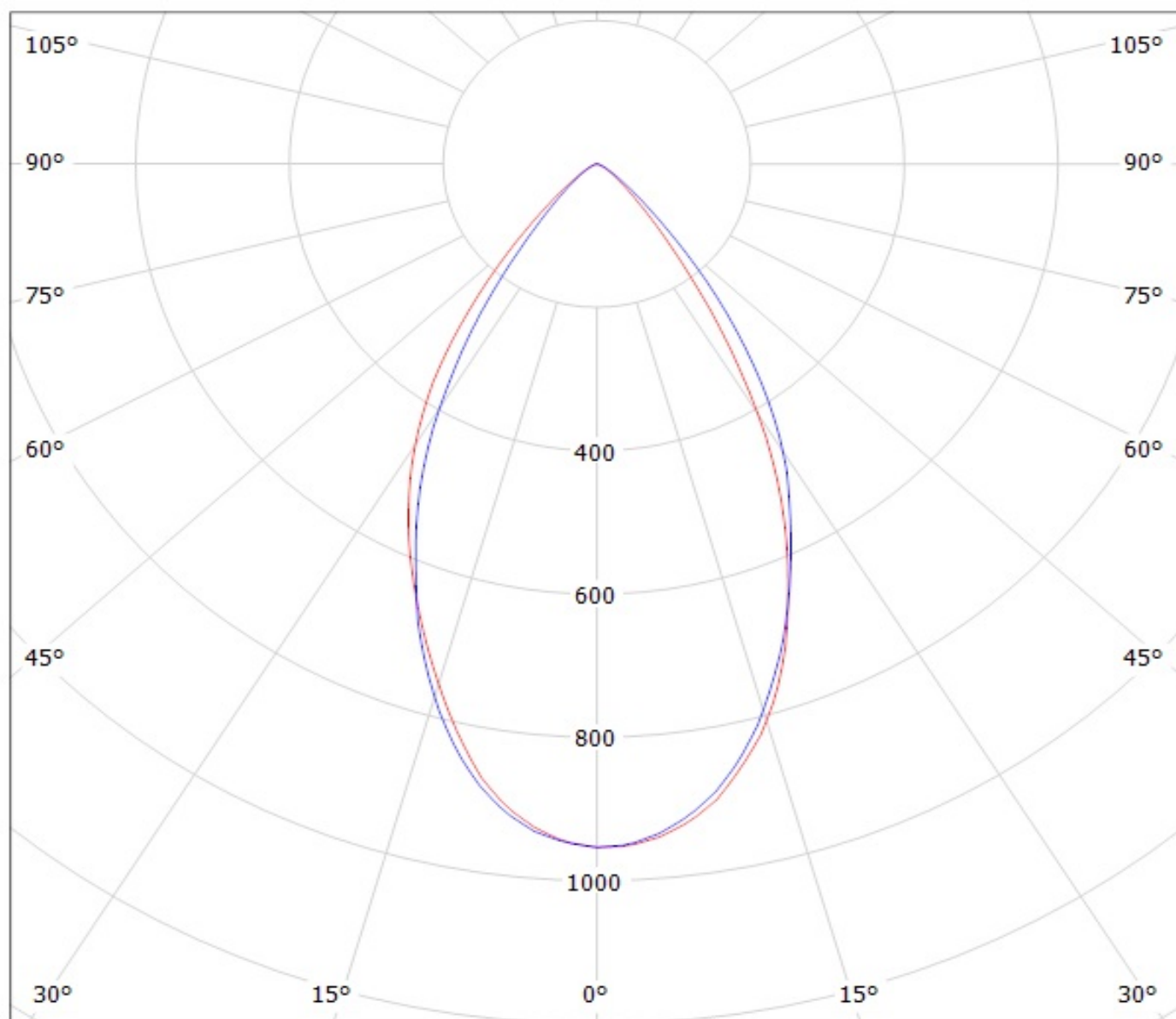

cd/klm

— C0 - C180

— C90 - C270

$\eta = 90\%$

**NOTE: The typical divergence will be changed by different color, chip size and chip position tolerance. The typical total divergence is the full angle measured where the luminous intensity is half of the peak value.**