

Illuminated Navimec™

Technical Data

- through-hole or SMD
- 50mA/24VDC
- single pole/momentary
- 10.000.000 operations life time
- IP67 sealing
- temperature range:
LED: -30/+85°C

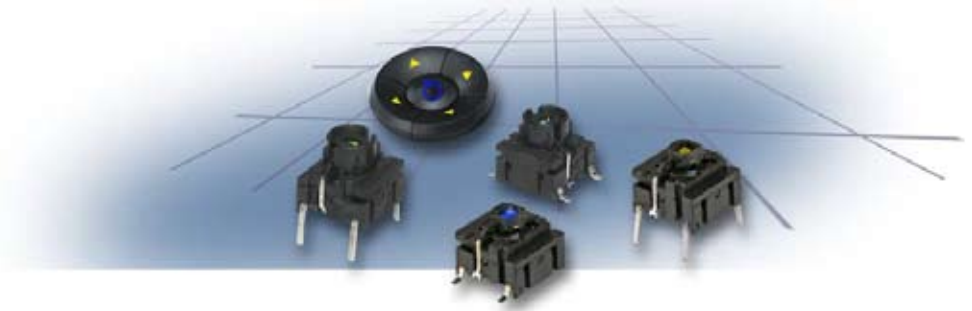

Dimensions 1ZB (through-hole)

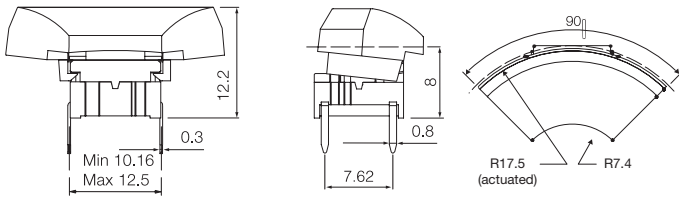

Top View

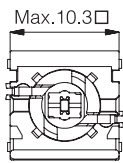

PCB layout and Circuit Diagram

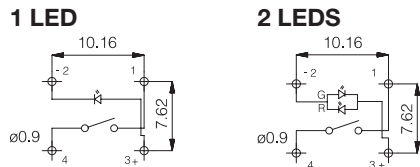

Dimensions 1ZC (SMD)

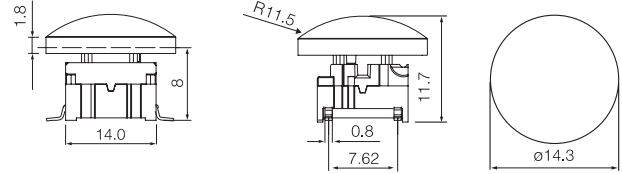

Top View

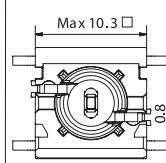

PCB layout and Circuit Diagram

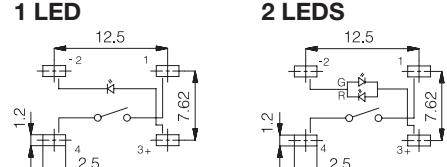

How to order



Switch **Mounting**
SH9 surface mount
TH9 through-hole

LED **Illuminated Cap**

- 01
- 22
- 42
- 61
- 82
- 2242
- 8222
- 8242



Switch **Mounting**
SH9 surface mount
TH9 through-hole

LED **Illuminated Cap**

- 01
- 22
- 42
- 61
- 82
- 2242
- 8222
- 8242



Recommended panel cut-out:
 ø35.0-35.5 Depending on application

Design example

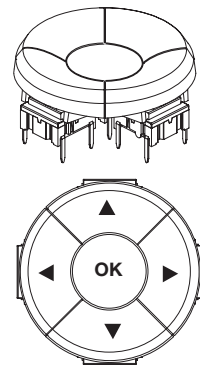

Consisting of:
 4x4ATH9XXXX + 4x 1ZB16
 and
 1x4FTH9XXXX + 1x 1ZC16
 (4F in centre position)

Navimec™ Legends

- Part No. 1ZB16LM136 ▲
- Part No. 1ZC16LM123 ⏻
- Part No. 1ZC16LM118 OK
- Part No. 1ZC16LM105 ENTER

Keycaps shown on this page can also be used on multimec® switches 3A and 3F

Ordering example: 4x4ATH901 + 1ZB16LM136 and 1x4FTH982 + 1ZC16LM118

For updates of products and/or changes of specifications please see www.mec.dk