



3-pole

3-pole EMERGENCY STOP

6-pole

6-pole EMERGENCY STOP

E X - S A F E T Y S W I T C H

| 80 A |

Technical data

80 A 3-pole und 6-pole

Marking to 94/9/EC	⊕ II 2 G ⊕ II 2 D T 53 °C		
Type of protection	EEx ed ia IIC T6		
EC-Type Examination Certificate	PTB 00 ATEX 1091		
Rated voltage	up to 690 V, 50/60 Hz		
Rated current	max. 80 A		
Switching capacity AC 3	230 V/80 A	400 V/80 A	500 V/80 A 690 V/63 A
Short-circuit backup fuse	max. 160 A (400 V) max. 100 A (690 V)		
Degree of protection acc. to EN 60529	IP 66		
Enclosure material	Glass-fibre reinforced polyester		
Connecting terminals	2 x 25 mm ² Auxiliary contact 2 x 4 mm ²		
Cable entry	M25 (Ø 8 - 17 mm) M32 (Ø 12 - 21 mm) M50 (Ø 21 - 35 mm)		
Auxiliary contact			
1 x NO	making – lagging breaking – leading		
1 x NC	making – leading breaking – lagging		
Weight	approx. 6.5 kg (3-pole version) approx. 9.0 kg (6-pole version)		

**Ordering details safety switch 80 A 3-pole
 Version with 2 auxiliary contacts (NO)**

Version	Cable entry	Order No.
3-pole	2 x M50 / 1 x M25	GHG 264 0020 R0001
3-pole EMERGENCY STOP	2 x M50 / 1 x M25	GHG 264 0020 R0002

**Ordering details safety switch 80 A 6-pole
 Version with 2 auxiliary contacts (1 x NO, 1 x NC)**

Version	Cable entry	Order No.
6-pole	4 x M50 / 1 x M25	GHG 264 0021 R0001
6-pole EMERGENCY STOP	4 x M50 / 1 x M25	GHG 264 0021 R0002

Customised versions on request.

For fixing materials and accessories, see page 7.44.

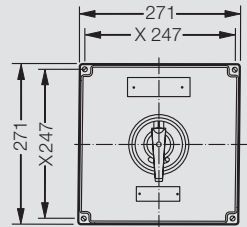

3-pole

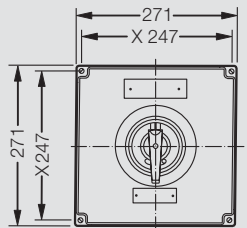
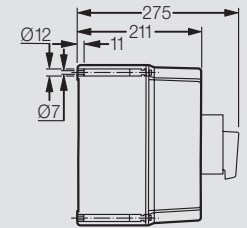

6-pole

