

Control gear for low-pressure sodium lamp SOX 35W

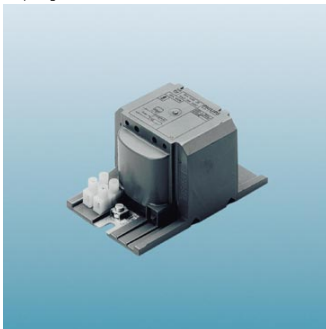

Impregnated



Encapsulated

- Impregnated (slim cross-section) or encapsulated electromagnetic ballasts, of copper/iron construction, for use with an external ignitor
- Fully comply with international standards on safety and performance; design compliance to IEC 922/923
- Orthocyclic winding process results in small coil volume and reduced weight, with minimum watt losses
- Impregnated ballasts fitted with double-insert contacts; encapsulated ballasts standard equipped with screw terminal blocks
- Impregnated ballasts should be limited to built-in situations, not exposed to humid conditions; encapsulated ballasts are suitable for application in luminaires or poles under normal humid conditions (not dripproof)

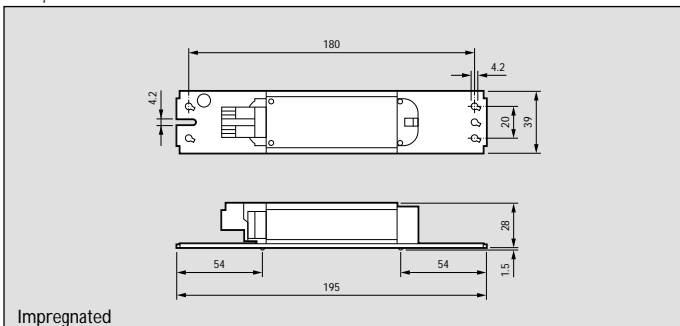

Impregnated

Dimensions in mm

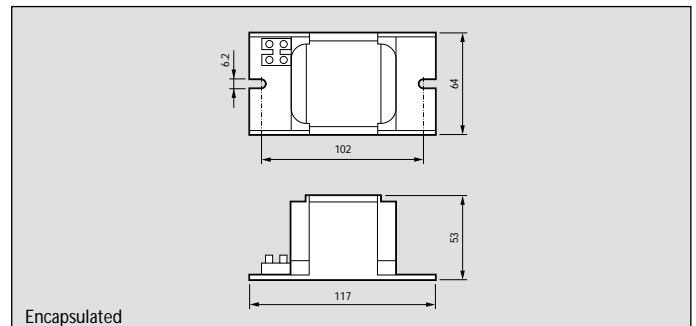

Encapsulated

Type	Ignitor type	Mains		Without PF correction		With PF correction		Cable cap.	Losses	Tw	Δt	Approvals	Ordering number
		Voltage	Freq.	Nom.	Cos φ	Cap.	Mains current						
		V	Hz	A		μF/V	Max. A	Nom. A	nF	W	°C	°C	
HID Impregnated parallel PAR													
BSX 35 L80	SX 26	220	50	0.6	0.35	8/250	0.28	0.22	5	11.2	130	60	9137 002 003..
BSX 35 L81	SX 26	230	50	0.6	0.35	8/250	0.28	0.22	5	11.6	130	60	A 9137 002 006..
BSX 355 L82	SX 26/SX 72	240	50	0.6	0.35	8/250	0.28	0.22	5	12.6	130	60	9137 002 009..
HID Encapsulated parallel PAR													
BSX 35 L11	SX 26	220	50	0.6	0.35	8/250	0.28	0.22	5	9.0	130	50	CF 9136 537 303..
BSX 35 L40	SX 26	230	50	0.6	0.35	8/250	0.28	0.22	5	9.2	130	50	ABC 9136 537 304..
BSX 355 L32	SX 26/SX 72	240	50	0.6	0.35	8/250	0.28	0.22	5	9.6	130	50	9136 537 305..

