

# White Moulded Wiring Accessories

profile<sup>+</sup>  
plus



**new**

2005  
1<sup>st</sup> Edition



*Ashley is part of the Hager group. And that's important to you. It means you'll enjoy the benefits of massive on-going investment in better manufacturing resources, research and development and customer service, plus a multitude of skills and technologies between the member companies.*

*Hager itself was founded in 1955. It began as a family business and is still independently owned, even though, today, it is one of the world's leading manufacturers and suppliers of electrical control and distribution systems.*

*In addition to Ashley the group includes Hager, and Klik.*



*Customer service centre for national sales enquiries.*

*Technical engineers offer both national and local support.*

### Help is just a call or click away

#### Sales Hotline

For all your sales enquiries.  
e-mail:

**0870 240 2400**  
sales@hager.co.uk

#### Technical Helpline

For all your technical enquiries.  
e-mail:

**0870 607 6677**  
technical@hager.co.uk

#### Hager Online

[www.hagergroup.co.uk](http://www.hagergroup.co.uk)

For general information on Hager brands.  
e-mail:

info@hager.co.uk

## hager



Hager offer a comprehensive range of electrical distribution equipment up to 800 Amps.

## ashley



Ashley, whose wiring accessories are synonymous with quality and reliability.

## klik



Klik has transformed the speed and efficiency of electrical connections.

## The History of Ashley

Ashley has a long established reputation for providing innovative electrical and electronic products. The original business began in Liverpool in 1923, rapid growth meant by 1925 the company was formally registered as Ashley Wireless Telephone Company Ltd producing components for the early radio set manufacturers.

Due to changing market conditions the decision was made in 1932 to develop into the domestic wiring accessory market. The products were principally lampholders, ceiling roses, and bell transformers. This decision set the trend for Ashley to become a major force in wiring accessories. By 1938 the production was relocated to Ulverston in the Lake District.

Over the following years the range was expanded, which helped to build a reputation for providing reliable, trusted, and competitive wiring accessories. To service the rapidly increasing demand production was expanded to include several sites in the Lake District.

The emphasis on listening to customers and providing intelligent solutions was enhanced in the 1980's when Ashley was merged with Rock Accessories. This added the market leading Klik luminaries support couplers to the Ashley & Rock basket of products. In 1998 Ashley became part of the Hager group, significant investment resulted in many new product ranges. The Ashley brand is now UK market leader in both ceiling products and junction boxes, the Klik brand continues to strengthen its market leading position.

The continuing commitment of the Hager group to wiring accessories will see further exciting developments over the next 3 years.

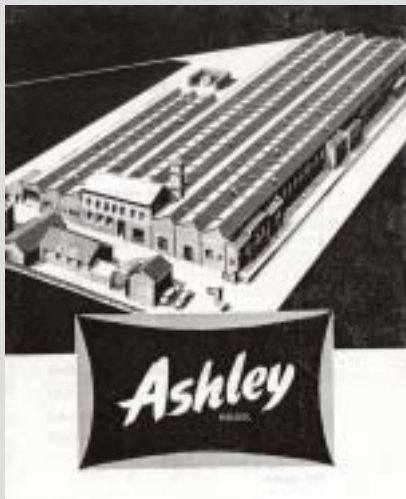

## Wall Products

<b>Profileplus - White Moulded Range</b>	
Range - Specification Notes	6
Wall Switches	7
Fan Isolator Switches	7
Data Front Plate	8
Wall Dimmers	8
13A Socket Outlets	9
Fused Connection Units	10
20 & 45A Double Pole Switches	11
Cooker Control	12
Shaver Socket	12
Voice & Data Outlets	13
Euro Frontplates & Modules	14
Mounting Boxes	15
<b>system<sup>3</sup>grid Range</b>	
Range - Features & Benefits	16
Frontplates	17
10 & 20A Switches	17
Voice, Data and Image Outlets	18
Power Outlets	18

## Ceiling Products

<b>Safety Lampholders</b>	
Range - Specification Notes	19
Lampholders	20
Pendant Sets	21
<b>Ceiling switches</b>	
Range - Specification Notes	22
6A Pull Switches	23
50A Pull Switches	23
3 pole Fan Isolating Switches	23
Accessories	24

## Connection

<b>Junction Boxes</b>	
Range - Specification Notes	25
20 & 32A Standard Junction Boxes	26
Heating Control/Alarm with/without Connection Strip	26

<b>Technical</b>	27
------------------	----

# Specification Notes



Cage terminals accept up to 5 x 2.5mm<sup>2</sup> conductors for easy installation



Double pole switching for assured disconnection



New 'sharp white' colour blends with brilliant white emulsion paint



Terminal screws are 'taptite' to prevent loss in transit



Cage terminals for secure connection without excessive conductor damage



Modern profiled frontplate blends with all environments



Smooth 'low gloss' finish allows easy cleaning



Flat top edge allows easy removal of any emulsion over-paint



Shutters on live and neutral pins for protection against accidental contact



White rocker printed 'ON' blends in any installation

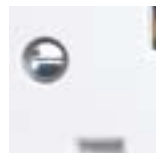

Hard 'urea' frontplate provides high resistance to scratching



Terminal screws have 'hardened' heads that accept flat driver blades for confident torquing



Dual earth terminals provide easy termination for high integrity earthing



Unique blue functional mouldings provide assurance of ashley quality



Recessed rivets allow simple patress or trunking installations

## Wall Switches

**new**

- complies with BS EN 60669-1, a.c. only
- 'x' rated - no need to derate for fluorescent loads
- min. flush denotes minimum depth flush metal box required to BS 4662
- for mounting boxes see selection chart on page 28
- supplied with M3.5 x 25mm long fixing screws
- capacity of each terminal 2 x 2.5mm<sup>2</sup> conductors
- two way switches can be wired either 1 way or 2 way
- terminal markings denote: L1 = one way L2 = two way
- for multigang switches use of a 25mm mounting box will allow for increased wiring space



PPS12



PPS32

<i>description</i>	<i>mounting min. flush</i>	<i>fixing centres</i>	<i>Pack qty.</i>	<i>cat. ref.</i>
plate switch 1 gang 1 way 10 Amp <i>dimensions: h = 86mm w = 86mm d = 7mm</i>	16mm	60.3mm	10	<b>PPS11</b>
plate switch 1 gang 2 way 10 Amp <i>dimensions: h = 86mm w = 86mm d = 7mm</i>	16mm	60.3mm	10	<b>PPS12</b>
intermediate plate switch 1 gang 10 Amp <i>dimensions: h = 86mm w = 86mm d = 7mm</i>	16mm	60.3mm	10	<b>PPS16</b>
plate switch 2 gang 2 way 10 Amp <i>dimensions: h = 86mm w = 86mm d = 7mm</i>	16mm	60.3mm	10	<b>PPS22</b>
plate switch 3 gang 2 way 10 Amp <i>dimensions: h = 86mm w = 86mm d = 7mm</i>	16mm	60.3mm	10	<b>PPS32</b>
plate switch 4 gang 2 way 10 Amp = 7mm <i>dimensions: h = 86mm w = 120mm d = 7mm</i>	25mm	120.6mm	5	<b>PPS42</b>

## Bell Push

**new**

- bell push can be wired to make or break 250V a.c. or 24V d.c.
- marking of bell push can be varied i.e. "press" see printing section on page 34



PPBP12

<i>description</i>	<i>mounting min. flush</i>	<i>fixing centres</i>	<i>Pack qty.</i>	<i>cat. ref.</i>
1 gang bell push, marked with "Bell" symbol <i>dimensions: h = 86mm w = 86mm d = 7mm</i>	16mm	60.3mm	10	<b>PPBP12</b>

## Isolator Switches

**new**

- **3 pole isolator switches**
- for isolation of 2 poles and neutral for fan maintenance in electrical installations
- available with or without fan symbol



PPS3PIF

<i>description</i>	<i>mounting min. flush</i>	<i>fixing centres</i>	<i>Pack qty.</i>	<i>cat. ref.</i>
3 pole fan isolator plate switch 10 Amp <i>dimensions: h = 86mm w = 86mm d = 7mm</i>	25mm	60.3mm	10	<b>PPS3PI</b>
3 pole fan isolator plate switch - marked "fan" 10 Amp <i>dimensions: h = 86mm w = 86mm d = 7mm</i>	25mm	60.3mm	10	<b>PPS3PIF</b>

## Data Front Plate

new

- The data front plate can accept 2 gang euro type modules - 2x25mm x 50mm. typical installation includes RJ11, RJ12, RJ45 and BT type modules. Allows data outlets to co-ordinate with profile plus white moulded wiring accessories.
- See page 14 for full range including modules



PTS02/EURO

<i>description</i>	<i>mounting min. flush</i>	<i>fixing centres</i>	<i>Pack qty.</i>	<i>cat. ref.</i>
1 gang euro type data front plate <i>dimensions: h = 86 mm w = 86mm d = 7mm</i>	25mm	60.3mm	1	PTS01/EURO
2 gang euro type data front plate <i>dimensions: h = 86mm w = 86mm d = 7mm</i>	25mm	60.3mm	1	PTS02/EURO
4 gang euro type data front plate <i>dimensions: h = 86mm w = 120mm d = 7mm</i>	25mm	120.6mm	1	PTS04/EURO

## Wall Dimmers

new

- The dimmer range can be used on incandescent lighting up to 400w.
- Please consult our technical services hotline for other application information.



PSD1



PSD2



PSD3



<i>description</i>	<i>W Max</i>	<i>mounting min. flush</i>	<i>fixing centres</i>	<i>Pack qty.</i>	<i>cat. ref.</i>
1 gang 2 way dimmer <i>dimensions: h = 86mm w = 86mm d = 7mm</i>	400w	25mm	60.3mm	1	PSD1
2 gang 2 way dimmer <i>dimensions: h = 86mm w = 86mm d = 7mm</i>	250w	25mm	60.3mm	1	PSD2
3 gang 2 way dimmer <i>dimensions: h = 86mm w = 120mm d = 7mm</i>	250w	25mm	120.6mm	1	PSD3
4 gang 2 way dimmer <i>dimensions: h = 86mm w = 120mm d = 7mm</i>	250w	25mm	120.6mm	1	PSD4

## 13 Amp Socket Outlets

**new**

### 13 Amp socket outlets

- complies with BS 1363 Pt 2, a.c. only
- double pole switching mechanism on switched sockets
- all terminal screws grouped in-line and upward facing for ease of installation
- flat head terminal screws
- twin socket comes with twin earth as standard
- rocker is printed 'ON'
- capacity of each terminal: 5 x 2.5mm<sup>2</sup> conductors switched; 4 x 2.5mm<sup>2</sup> unswitched (for other sized conductors see terminal capacities on page 31)
- tough plastic back for durability
- min. flush denotes minimum depth flush metal box to BS 4662
- for mounting boxes see selection chart on page 28
- supplied with M3.5 x 30mm long fixing screws

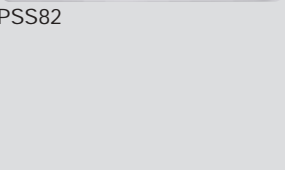
	<i>description</i>	<i>mounting min. flush</i>	<i>fixing centres</i>	<i>Pack qty.</i>	<i>cat. ref.</i>
	single unswitched socket 13 Amp <i>dimensions: h = 86mm w = 86mm d = 9mm</i>	25mm	60.3mm	10	<b>PS81</b>
PS81					
	twin unswitched socket 13 Amp (with twin earth) <i>dimensions: h = 86mm w = 146mm d = 9mm</i>	25mm	120.6mm	5	<b>PS82</b>
PS82					
	single switched socket 13 Amp <i>dimensions: h = 86mm w = 86mm d = 9mm</i>	25mm	60.3mm	10	<b>PSS81</b>
PSS81					
	twin switched socket 13 Amp (with twin earth) <i>dimensions: h = 86mm w = 146mm d = 9mm</i>	25mm	120.6mm	5	<b>PSS82</b>
PSS82					

## Fused Connection Units

**new**

- complies with BS 1363 Pt 4 a.c. only
- all switched units are double pole
- all terminal screws face upwards for ease of installation
- cable clamp accommodates up to 2.5mm<sup>2</sup> flexible cord
- flat head terminal screws
- tough plastic back for durability
- all units fitted with a 13 Amp fuse link to BS 1362, can be supplied with a 3 Amp fuse link. Simply add '3' as a suffix to the catalogue reference e.g. PSSU83/3
- flex outlet at edge of plate consists of removable insert - for choice of use
- min. flush denotes minimum depth flush metal box to BS 4662
- for mounting boxes see selection chart on page 28
- supplied with M3.5 x 30mm long fixing screws
- capacity of each terminal: switched; 5 x 2.5mm<sup>2</sup> ; unswitched 4 x 2.5mm<sup>2</sup> conductors (for other sized conductors see terminal capacities on page 31)
- many more printing options are available. Units can be marked according to individual needs i.e. "Microwave", "Freezer" see page 34

<i>description</i>	<i>mounting min. flush</i>	<i>fixing centres</i>	<i>Pack qty.</i>	<i>cat. ref.</i>
--------------------	----------------------------	-----------------------	------------------	------------------



PSSU83

unswitched unit 13 Amp <i>dimensions: h = 86mm w = 86mm d = 13mm</i>	25mm	60.3mm	10	<b>PSU83</b>
---	------	--------	----	--------------

switched unit 13 Amp <i>dimensions: h = 86mm w = 86mm d = 13mm</i>	25mm	60.3mm	10	<b>PSSU83</b>
---	------	--------	----	---------------

switched unit with neon 13 Amp <i>dimensions: h = 86mm w = 86mm d = 13mm</i>	25mm	60.3mm	10	<b>PSSU83N</b>
---	------	--------	----	----------------



PSSU83N

**printed units**

switched unit 13 Amp, marked "Washing Machine"	25mm	60.3mm	1	<b>PSSU83/WM</b>
--	------	--------	---	------------------

switched unit 13 Amp marked "Microwave"	25mm	60.3mm	1	<b>PSSU83/MW</b>
---	------	--------	---	------------------

switched unit 13 Amp marked "Dishwasher"	25mm	60.3mm	1	<b>PSSU83/DW</b>
--	------	--------	---	------------------

switched unit 13 Amp marked "Freezer"	25mm	60.3mm	1	<b>PSSU83/FR</b>
---------------------------------------	------	--------	---	------------------

\* many other printed units are available (see printing section for more detailed listing - page 34)



PSSU83 printed "Microwave"





PSSU83 printed "Freezer"

## 20 Amp Double Pole Switches



- complies with BS EN 60669-1 a.c. only
- min. flush denotes minimum depth flush metal box to BS 4662
- supplied with M3 x 30mm long fixing screws
- capacity of each terminal: 3 x 2.5mm<sup>2</sup> conductor

	<i>description</i>	<i>mounting min. flush</i>	<i>fixing centres</i>	<i>Pack qty.</i>	<i>cat. ref.</i>
	DP switch 20 Amp <i>dimensions: h = 86mm w = 86mm d = 13mm</i>	25mm	60.3mm	10	<b>PDP84</b>
PDP84	DP switch with neon 20 Amp <i>dimensions:h = 86mm w = 86mm d = 13mm</i>	25mm	60.3mm	10	<b>PDP84N</b>
	DP switch - marked "waterheater" 20 Amp <i>dimensions: h = 86mm w = 86mm d = 13mm</i>	25mm	60.3mm	10	<b>PDP85</b>
PDP84N	DP switch with neon, marked "waterheater" 20 Amp <i>dimensions: h = 86mm w = 86mm d = 13mm</i>	25mm	60.3mm	10	<b>PDP85N</b>

## 45 Amp Double Pole Switches



- complies with BS EN 60669-1 a.c. only
- min. flush denotes minimum depth flush metal box to BS 4662
- supplied with M3.5 x 40mm long fixing screws
- capacity of each terminal: 1 x 16mm<sup>2</sup> conductor  
1 x 10mm<sup>2</sup> earth conductor (for other sized conductors see terminal capacities on page 31)

	<i>description</i>	<i>mounting min. flush</i>	<i>fixing centres</i>	<i>Pack qty.</i>	<i>cat. ref.</i>
	1 gang plate, neon <i>dimensions: h = 86mm w = 86mm d = 13mm</i>	35mm	60.3mm	5	<b>PDP445N</b>
PDP445N	2 gang vertical plate, neon <i>dimensions: h = 146mm w = 86mm d = 13mm</i>	35mm	120.6mm vertical	1	<b>PDP845N</b>
	also printed variants, cooker, hob etc. see page 12				

## Cooker Controls

new

**cooker control units**

- complies with BS 4177, a.c. only

**45 Amp double pole switches**

- complies with BS EN 60669 - 1, a.c. only

**cooker cable outlets**

- complies with BS 5733 a.c. only
- combined switch / sockets have double pole 45 Amp

main switch and 13 Amp switched socket outlet

- min. flush denotes minimum depth flush metal box to BS 4662
- supplied with M3.5 x 40mm long fixing screw
- capacity of each terminal:  
1 x 16mm<sup>2</sup> conductor  
1 x 10mm<sup>2</sup> earth conductor (for other sized conductors)

see terminal capacities on page 31)

- marking on cooker control units: ON, OFF and circuit identification cooker
- see printing section for more details on printed options available on page 34

<i>description</i>	<i>mounting min. flush</i>	<i>fixing centres</i>	<i>Pack qty.</i>	<i>cat. ref.</i>
<b>45 Amp cooker control unit</b> DP cooker control switch 45 Amp <i>dimensions: h = 86mm w = 146mm d = 13mm</i>	35mm	120.6mm	1	<b>PCCU2000</b>
DP cooker control switch with neon 45 Amp <i>dimensions: h = 86mm w = 146mm d = 13mm</i>	35mm	120.6mm	1	<b>PCCU2000N</b>
<b>45 Amp double pole switches</b> 1 gang plate with neon, marked "cooker" 45 Amp <i>dimensions: h = 86mm w = 86mm d = 13mm</i>	35mm	60.3mm	5	<b>PDP445N/CK</b>
1 gang plate with neon, marked "hob" 45 Amp <i>dimensions: h = 86mm w = 86mm d = 13mm</i>	35mm	60.3mm	5	<b>PDP445N/HB</b>
1 gang plate with neon, marked "oven" 45 Amp <i>dimensions: h = 86mm w = 86mm d = 13mm</i>	35mm	60.3mm	5	<b>PDP445N/OV</b>
<b>cooker cable outlets</b> cooker cable outlet - no terminals <i>dimensions: h = 86mm w = 86mm d = 23mm</i>	35mm	60.3mm	10	<b>CCO503</b>
<b>flex outlet plate</b> <i>dimensions: h=86mm w=86mm d=13mm</i>	16mm	60.3mm	10	<b>FOP102</b>



PCCU2000N



PDP445N/CK

## Shaver Socket

**shaver socket**

- shaver socket complies with BS EN 60742 / BS 3535 and BS EN 55014
- designed for use in bathrooms and washrooms and incorporates a double wound isolating transformer for an earth free supply.

Input 230V a.c. output dual voltage 230V a.c. and 110V a.c. outlets rating 20VA on either voltage

- primary circuit is protected by a self- resetting thermal overload device. Insertion of shaver plug automatically switches on the

transformer, removal automatically switches it off. A positive interlock prevents 2 plugs being inserted simultaneously

- capacity of each terminal: 2 x 2.5mm<sup>2</sup> conductors
- See page 15 for mounting boxes

<i>description</i>	<i>mounting mini flush</i>	<i>fixing centres</i>	<i>Pack qty.</i>	<i>cat. ref.</i>
shaver socket outlet - dual voltage, neon <i>dimensions: h= 146mm w = 86mm d= 13mm</i>	47mm	120.6mm vertical	1	<b>SO100</b>



SO100

## TV Socket Outlets

**new**

### Co-axial socket outlets

- suitable as indoor terminations for VHF and UHF systems up to 860MHz (bands)
- will accept standard co-axial plugs to BS 3041
- isolated co-axial outlets suitable for use in multi-outlet communal aerial systems, providing necessary safety isolation rated at 2000 volts a.c.



PTV102



PTV202

<i>description</i>	<i>mounting mini flush</i>	<i>fixing centres</i>	<i>Pack qty.</i>	<i>cat. ref.</i>
single co-axial TV socket outlet <i>dimensions: h = 86mm w = 86mm d = 7mm</i>	16mm	60.3mm	10	<b>PTV102</b>
double tv / fm co-axial socket outlet <i>dimensions: h = 86mm w = 86mm d = 7mm</i>	16mm	60.3mm	10	<b>PTV202</b>
single co-axial socket outlet, isolated <i>dimensions: h = 86mm w = 86mm d = 7mm</i>	16mm	60.3mm	10	<b>PTVI103</b>

## Telephone Socket Outlet

**new**

### telephone socket outlets

- complies with BS 6312 Pt. 2
- all sockets have rapid connection, insulation displacement connections (IDC)
- each socket supplied with IDC tool, cable tie and installation instructions



PTSO3/1A

<i>description</i>	<i>mounting mini flush</i>	<i>fixing centres</i>	<i>Pack qty.</i>	<i>cat. ref.</i>
master telephone socket outlet - flush <i>dimensions: h = 86mm w = 86mm d = 7mm</i>	25mm	60.3mm	10	<b>PTSO3/1A</b>
secondary telephone socket outlet - flush <i>dimensions: h = 86mm w = 86mm d = 7mm</i>	25mm	60.3mm	10	<b>PTSO3/3A</b>

## Moulded Blank Plates

**new**



PPSB2

<i>description</i>	<i>mounting mini flush</i>	<i>fixing centres</i>	<i>Pack qty.</i>	<i>cat. ref.</i>
1 gang <i>dimensions: h = 86mm w = 86mm d = 7mm</i>	16mm	60.3mm	20	<b>PPSB81</b>
2 gang <i>dimensions: h = 86mm w = 146mm d = 7mm</i>	16mm	120.6mm	10	<b>PPSB82</b>

## Euro Frontplates & Modules

**new**

- Allows data and power accessories to aesthetically co-ordinate
- The front plates can be used to fit a variety of industry standard modules
- Accepts standard 25 x 50mm ■
- Please consult us for other module colour options

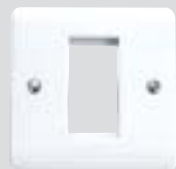

PTS01/EURO



PTS04/EURO

<i>description</i>	<i>width</i>	<i>fixing centres</i>	<i>Pack qty.</i>	<i>cat. ref.</i>
<b>single moulded front plates</b> 1 Gang 1 module europlate <i>dimensions: h = 86mm x w = 86mm x d = 7mm</i>	1 ■	60.3mm	1	PTS01/EURO
1 Gang 2 module europlate <i>dimensions: h = 86mm x w = 86mm x d = 7mm</i>	2 ■	60.3mm	1	PTS02/EURO
2 Gang 2 module europlate <i>dimensions: h = 86mm x w = 146mm x d = 7mm</i>	4 ■	120.6mm	1	PTS04/EURO



PPS10EW



PPS14EW



PPS6EW





PPS8EW

<i>description</i>	<i>euro module width</i>	<i>Pack qty.</i>	<i>cat ref.</i>
single IEC - female - non isolated	■	1	PPS1EW
single IEC - male - non isolated	■	1	PPS2EW
single satellite 'F' connector	■	1	PPS3EW
single blank	■	1	PPS4EW
diplexer - TV & FM Radio	■■	1	PPS5EW
diplexer - TV & Satellite	■■	1	PPS6EW
triplexer - TV, Satellite, FM Radio	■■■	1	PPS7EW
quadplexer - TV, Satellite, FM Radio & return	■■■	1	PPS8EW
BT telephone secondary	■	1	PPS9EW
BT telephone master	■	1	PPS10EW
RJ11 - modem	■	1	PPS11EW
RJ45 - data (cat 5e)	■	1	PPS12EW
phono plugs - red/black - gold plated	■	1	PPS13EW
speaker terminal posts - gold plated	■	1	PPS14EW

## Mounting Boxes

- for use with white moulded products (see selection chart on page 28)
- knockouts are provided in base and sides for cable entry
- earth terminals are provided in P815, and P825
- cable clamps in P81XD and P82XD accommodate 4mm<sup>2</sup> to 16mm<sup>2</sup> cable
- partition wall boxes**
  - partition wall boxes are for installation in walls / boards up to 15mm thick
  - MB81 / MB82 fixing lugs are snapped into position after insertion in the wall, flange around edge stops box falling into wall space
- all products manufactured from flame retardant material
- MB81, MB82 knockouts in side and base.

	<i>description</i>	<i>fixing centres</i>	<i>Pack qty.</i>	<i>cat. ref.</i>
 P815	<b>single moulded boxes</b> mounting box - 20mm deep, 1 gang earth <i>dimensions: h = 87mm x w = 87mm x d = 20mm</i>	60.3mm	10	<b>P815</b>
	mounting box - 28mm deep, 1 gang <i>dimensions: h = 87mm x w = 87mm x d = 28mm</i>	60.3mm	10	<b>P81D</b>
	mounting box - 46mm deep, 1 gang <i>dimensions: h = 87mm x w = 87mm x d = 46mm</i>	60.3mm	5	<b>P81XD</b>
 P81D	<b>twin moulded box</b> mounting box - 28mm deep, 2 gang <i>dimensions: h = 87mm x w = 148mm x d = 28mm</i>	120.6mm	5	<b>P82D</b>
	mounting box - 46mm deep, 2 gang cable clamp <i>dimensions: h = 87mm x w = 148mm x d = 46mm</i>	120.6mm	1	<b>P82XD</b>
 P82D	<b>twin converter frame</b> 2 gang, 18mm deep <i>dimensions: h = 147mm x w = 87mm x d = 18mm</i>	60.3mm to 120.6mm	5	<b>CF2</b>
	<b>partition wall boxes</b> partition wall box - 35mm deep, 1 gang <i>dimensions: h = 83mm x w = 83mm x d = 35mm</i>	60.3mm to	10	<b>MB81</b>
	partition wall box - 35mm deep, 2 gang <i>dimensions: h = 83mm x w = 144mm x d = 35mm</i>	120.6mm to	5	<b>MB82</b>

## Shaver Box

	<i>description</i>	<i>fixing centres</i>	<i>Pack qty.</i>	<i>cat. ref.</i>
 SB105	shaver box - 51mm deep <i>dimensions: h = 146mm x w = 85mm x d = 51mm</i>	120.6mm (vertical)	1	<b>SB105</b>

system<sup>3</sup>grid

Specification Notes



rugged clip in system between modules and frames ensure secure location of module with no risk of pushing out of back



modules clip straight into the frame from the front, allowing wire up prior to installation. And can be easily removed from the front for rewiring without the need to remove the frame



large cage terminals with back-out combi head screws allow fast and secure installation of up to 2 x 4 mm<sup>2</sup> conductors



clear marking on modules: part reference; functional description; wiring symbols; orientation marker, terminal identification and strip length indicator



modules and moulded plates are made from a tough polycarbonate for high impact resistance



slimline screwless plate and sophisticated satin matt finish of modules provides excellent aesthetic appeal



over 100 modules to choose from and 56 plates providing excellent breadth of range



lifetime guarantee on majority of products



How to build system<sup>3</sup>grid

1. Select the required functional modules and count the total ● modules (see pages 17 & 18)



+

2. Select the front plate. (no frame is required for white moulded front plates)



For our full range of decorative and metalclad front plates please consult us.

## Clip In Front Plates

### clip in moulded plates

- comply with BS 5733
- accept any combination of *system:grid* module
- polished frontplate finish
- tough honeycomb design of backplate provides extra strength and durability
- no frame is required for installation - modules clip straight into the back of the plate

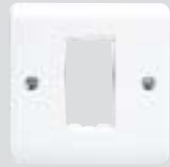

AM1P



AM2P

<i>description</i>	<i>dimensions mm (h x w x d)</i>	<i>fixing centres</i>	<i>Pack qty.</i>	<i>cat. ref.</i>
1 module	86 x 86 x 9	60.3mm	10	AM1P
2 module	86 x 86 x 9	60.3mm	10	AM2P
4 module	86 x 146 x 9	120.6mm	5	AM4P

**note:** see main catalogue for the full extensive grid range of modules and plate finishes.

## 10 Amp and 20 Amp Switches

### 10 and 20 Amp switches

- comply with BS EN 60669-1
- current rating 10AX - 20AX
- voltage 250V a.c.
- terminal capacity 2 x 4mm<sup>2</sup>
- these switches do not have to be de-rated for fluorescent loads
- all modules are 45 x 25mm
- operating temperature -5 to 40°C
- operational life up to 40,000 operations
- modules made from polycarbonate for high impact resistance
- modules clip into frame without use of tools
- modules can easily be removed from the plate

#### dimensions:

- h=45mm w=25mm
- h=45mm w=50mm



GS12

GPS12



GS201

GSDP2N



GKS211

GPS12B

<i>description</i>	<i>dimensions</i>	<i>mounting min. flush</i>	<i>Pack qty.</i>	<i>cat. ref.</i>
10 Amp				
1 way single pole	■	35mm	10	GS11
2 way single pole	■	35mm	10	GS12
intermediate	■	35mm	10	GS16
2 way push switch	■	35mm	10	GPS12
1 way double pole	■	35mm	10	GSDP1
2 way and off	■	35mm	10	GS201
20 Amp				
1 way single pole	■	35mm	10	GS211
2 way single pole	■	35mm	10	GS212
intermediate	■	35mm	10	GS216
1 way double pole	■	35mm	10	GSDP2
1 way double pole with neon	■	35mm	10	GSDP2N
2 way single pole key	■	35mm	10	GKS211
intermediate key	■	35mm	10	GKS216
1 way double pole key	■	35mm	10	GKSDP2
2 way double pole key biased	■	35mm	10	GKS212B
double pole push to make	■	35mm	10	GPMDP21
double pole push to break	■	35mm	10	GPBDP21

## Voice, Data and Image

### TV / satellite outlets

- comply with BS 3041
- for direct connection to TV, FM or satellite aerial co-axial download. Not to be used in same enclosure as mains exceeding 50V
- performance:  
TV : D.C. to 95MHz  
Satellite: D.C. to 1.75GHz

### telephone outlets

- complies with BS 6312 : part 2
- RJ45**
- enhanced cat 5 performance (Cat 5e)
  - suitable for both 568A and 568B wiring schemes
  - supplied with cable tie and anchors to secure wires in the connectors
  - complies with:  
TIA / EIA 568-A : Cat 5e  
TIA / EIA TSB40A : Cat 5e  
ISO / IEC 11801 : Cat 5e

### dimensions:

- 45 x 25mm
- 40 x 50mm

<i>description</i>	<i>dimensions</i>	<i>mounting min. flush</i>	<i>Pack qty.</i>	<i>cat. ref.</i>
TV co-axial outlet isolated	■	35mm	5	<b>GTVI</b>
TV co-axial outlet non isolated	■	35mm	5	<b>GTV</b>
satellite F connector non isolated	■	35mm	5	<b>GTVS</b>
BNC connector (with adaptor)	■ ■	35mm	5	<b>GBNC</b>
BT master	■	35mm	5	<b>GBTM</b>
BT secondary	■	35mm	5	<b>GBTS</b>
RJ45	■	35mm	5	<b>GRJ45</b>



GTVI



GBNC

## Power Outlets

### 13 Amp socket outlets

- comply with BS 1363 part 2, a.c. only
- shuttered openings
- clips straight into frame

### 5 Amp socket outlet

- complies with BS 546
- clips straight into frame

### universal socket

- comes supplied with adaptor to fit frame (cat ref GA45)

### fuse unit

- complies with BS 5733
- terminal capacity 2 x 2.5mm<sup>2</sup>
- comes with 13 Amp cartridge fuse link to BS 1362

### dimensions:

- h=45mm w=25mm
- h=45mm w=50mm

<i>description</i>	<i>dimensions</i>	<i>mounting min. flush</i>	<i>Pack qty.</i>	<i>cat. ref.</i>
13 Amp fused connection unit	■	35mm	10	<b>GFU13</b>
single 13 Amp socket outlet	■ ■	35mm	1	<b>GS81</b>
single 5 Amp socket outlet	■ ■	35mm	1	<b>GS51</b>
16 amp universal socket 2 pins (with adaptor)	■	35mm	10	<b>GSU16</b>



GFU13



GS81

## Safety Range Specification Notes



The inner body of the lampholder is a separate moving part which rotates as the lamp is twisted into place.



The solid switching action ensures that the contacts only become live when a lamp is fully inserted and held correctly in place by the 'J' slots.



Clip on terminal cover prevents casual removal. Integral cordgrip and easier to access screws and terminals allow faster wiring.



Made from an advanced high temperature polymer (resistant up to 210°C), all lampholders are T2 rated.



All products are designed and tested to comply with new British Standard BS 7895 for safety enhanced products.



Large multiple knockouts for easier cable installation and twin earth terminals will easily accommodate up to 4 earth conductors and are positioned for ease of cable access.



Angled terminal back for ease of wiring. Cables can be cut to the same length because all terminals are in-line.



Access base has feet to help mounting on uneven surfaces.



Lifetime guarantee on majority of products.



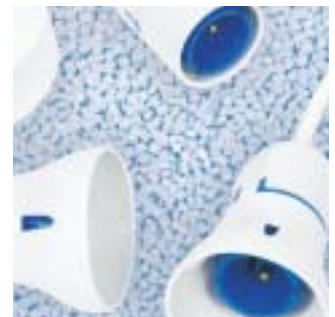

Safety products are designed to make life easy for you. When the lamp is removed from the lamp holder body the power is automatically disconnected at the contacts - ensuring that there is no risk of access to live parts.

You can be sure that your clients or tenants are safe from risk of shock. In addition the safety range is the only product on the market to comply with the new British Standard BS 7895 for safety enhanced products with high temperature resistance. And with a Lifetime Guarantee as standard you can just fit and forget!



## Safety Lampholders

- complies with BS 7895
- T2 = heat resistance rating (210°C)
- automatically disconnect power at the contacts when the lamp is removed
- 50.8mm fixing centres for non-access versions. Use with mounting blocks MB326E/MT
- solid brass plungers and copper plated steel springs maintain plunger pressure throughout their long life
- body angle of angled battens set at 30°
- access lampholders have integral RL624 ceiling rose base and heat resisting PVC tails
- all pendants incorporate automatic cord grips and sleeve caps for ease of flexible cord stripping
- home office shield encloses the lamp cap for extra safety (enabling compliance with BS 7671 in locations containing bath or shower)

	<i>description</i>	<i>Pack qty.</i>	<i>cat. ref.</i>
 SEL212	<b>bayonet cap cord grip lampholders</b> safety cord grip lampholders - short skirt	20	<b>SEL212</b>
	safety cord grip lampholders - home office shield	20	<b>SEL214</b>
 SEL214	<b>straight BC batten lampholder</b> 3 terminal, home office shield	20	<b>SEL354</b>
 SEL354	<b>access BC batten lampholder</b> straight, 2 terminal body, 3 terminal and earth base, home office shield	10	<b>SEL96T</b>
 SEL96T	angled, 2 terminal body, 3 terminal and earth base, home office shield	10	<b>SEL106T</b>

## Safety Pendant Sets

### Ceiling rose

- pendant set complies with BS EN 60598 -1 : 2000
- capacity of each terminal: 3 x 1.00mm<sup>2</sup> conductor
- common base with 'access' batten lampholders
- barriers between terminals
- flexible pendant cord restraining hooks
- fixing centres 50.8mm
- feet on base to aid mounting on uneven surfaces
- 3 separate knockouts accept 1, 2 or 3 x 1.5mm<sup>2</sup> conductors
- optional halo RL602 (see page 24)

	<i>description</i>	<i>Pack qty.</i>	<i>cat. ref.</i>			
 624SEL2126	<b>pendant sets with access ceiling rose</b> safety pendant set 6", short skirt	10	<b>624SEL2126</b>			
	safety pendant set 9", short skirt	10	<b>624SEL2129</b>			
	safety pendant set 12", short skirt	10	<b>624SEL21212</b>			
	safety shield pendant set 6", home office shield	10	<b>624SEL2146</b>			
	safety shield pendant set 9", home office shield	10	<b>624SEL2149</b>			
	safety shield pendant set 12", home office shield	10	<b>624SEL21412</b>			
 624SEL2129	<b>super access terminal bank type ceiling rose</b> access terminal bank type ceiling rose 3 terminal <i>dimensions: 81mm dia x 26mm (halo = 108dia)</i>	10	<b>RL624</b>			
	 624SEL2146					
 624SEL21412						

## Ceiling Switches Specification Notes



Integral base makes installation easier.



All ceiling switches are unobtrusive and are finished in brilliant white to match all other moulded accessories in the Ashley range.



Fixing screws are retained for easier installation.



Mechanical flag indicator can be seen from all angles.



50 Amp rated switch facilities control of electric showers and other equipment up to 11.5kW of rating.

The range of Ashley ceiling switches have superior specification and performance standards.

The range includes the 50 Amp double pole ceiling switch for the control of electric showers and other equipment up to 11.5kW of rating, together with the latest 3 pole 10 Amp isolator ceiling switch. Each has a mechanical flag 'OFF' indicator to enable compliance with BS 7671 (the current IEE Wiring regulations). The 6 Amp ceiling switch versions incorporate an integral base as standard for ease of installation.



## Ceiling Switches

- complies with BS EN 60669 -1
  - 'x' rated - no need to derate for fluorescent loads
  - earth terminal in base
- 6 Amp**
- optional halo available, RL602 (see page 24)
- switch will operate at up to an angle of 45°
  - pull cords 1.5m long
  - capacity of each terminal: 6 Amp = 2 x 1.5mm<sup>2</sup> conductors (for other sized conductors see terminal capacities on page 31)
- 10 Amp 3 pole isolating switch**
- terminal capacity: 3 x 1.5mm<sup>2</sup>
- 50 Amp**
- complies with BS 3676 -1 : 1989
  - suitable for use with showers up to 11.5kW
  - flag indicator with 'OFF' marked in green is compliant with 16th edition wiring regulations 3mm contact gap identification
  - supplied with M3.5 x 30mm fixing screws
  - capacity of each terminal: 1 x 16mm<sup>2</sup> conductors



CS160

<i>description</i>	<i>halo dia</i>	<i>fixing centres</i>	<i>Pack qty.</i>	<i>cat. ref.</i>
<b>6 Amp single pole ceiling switches</b> ceiling switch 1 way 6 Amp <i>dimensions: 81mm dia x 36mm depth</i>	108mm	50.8mm	10	<b>CS160</b>
ceiling switch 2 way 6 Amp <i>dimensions: 81mm dia x 36mm depth</i>	108mm	50.8mm	10	<b>CS260</b>

## Ceiling Switches



CS445N



CS3PIF

<i>description</i>	<i>mounting min. flush</i>	<i>fixing centres</i>	<i>Pack qty.</i>	<i>cat. ref.</i>
<b>50 Amp double pole isolating ceiling switch</b> ceiling switch with neon 50 Amp <i>dimensions: h = 86mm w = 86mm d = 36mm (15mm rear projection)</i>	35mm	60.3mm	5	<b>CS445N</b>
<b>3 pole isolating ceiling switched</b> 3 pole isolating ceiling switch 10 Amp <i>dimensions: h = 86mm w = 86mm d = 19mm</i>	25mm	60.3mm	5	<b>CS3PI</b>
3 pole isolating ceiling switch with fan symbol 10 Amp <i>dimensions: h = 86mm w = 86mm d = 19mm</i>	25mm	60.3mm	5	<b>CS3PIF</b>

## Accessories

- capacity of earth terminal for mounting blocks:  
3 x 1.5mm<sup>2</sup> cables
- cable knockout entries:  
**MB326E/MT** - centrally in base. 4 on periphery will accept 16mm x 16mm or 16mm x 25mm mini trunking

	<i>description</i>	<i>dimensions dia x h (mm)</i>	<i>Pack qty.</i>	<i>cat. ref.</i>
 MB326E/MT	<b>mounting blocks</b> round mounting box with earth terminal	84mm dia x 19mm	20	<b>MB326E/MT</b>
	round surface box - 30mm deep	84mm dia x 30mm	10	<b>MB2</b>
 MB2	<b>lampholder skirts, home office shield and shade ring</b> (suitable for use with any lampholder or batten lampholder)			
	short skirts		50	<b>HAL70</b>
	home office shield		50	<b>HAL72</b>
 221329/W	<b>ceiling switch pull cord</b> pull cord - white		5	<b>221329/W</b>
 RL602	<b>halo</b> halo, 108mm dia		20	<b>RL602</b>

## Junction Boxes Specification Notes



Solid brass terminals and screws, for excellent conductivity and positive clamping of conductors.



Extra strong terminals to hold multiple conductors.



Selective entry for cables.



Large capacity slot terminals for unbroken ring circuit installations.

Ashley is a market leader renowned for the quality of its junction boxes. The most comprehensive range available. Slot terminals and knockout entries facilitate ease of wiring and cable positioning.



## Junction Boxes

- complies with BS 6220
- slot terminals are ideal for taking spurs off uncut ring or loop circuit cables
- solid machined brass terminals
- junction box covers secured by single centre screws (apart from J701 which has two screws)
- J701 and J701/TB junction / adaptable box will accept 16mm x 16mm and /or 16mm x 25mm mini-trunking

	<i>description</i>	<i>fixing centres</i>	<i>terminal capacity</i>	<i>Pack qty.</i>	<i>cat. ref.</i>
	<b>knockout slot terminal junction box</b> junction box - brown 20 Amp 4 terminal <i>dimensions: 59mm dia x 25mm</i>	32mm	3 x 1.5mm <sup>2</sup>	20	<b>J201</b>
	<b>selective entry slot terminal junction boxes</b> junction box - brown 20 Amp 4 terminal <i>dimensions: 79mm dia x 26mm</i>	50.8mm	3 x 1.5mm <sup>2</sup>	10	<b>J301</b>
	junction box - brown 30 Amp 3 terminal <i>dimensions: 89mm dia x 32mm</i>	50.8mm	4 x 2.5mm <sup>2</sup>	10	<b>J401</b>
	junction box - brown 20 Amp 6 terminal <i>dimensions: 89mm dia x 26mm</i>	50.8mm	3 x 1.5mm <sup>2</sup>	10	<b>J601</b>
	<b>junction / adaptable box</b> junction box - no terminals <i>dimensions: h = 122mm x w = 156mm x d = 32mm</i>			5	<b>J701</b>
	junction box - with terminal block, cable ties and related wiring card <i>dimensions: h = 122mm x w = 156mm x d = 32mm</i>		4 x 1.5mm <sup>2</sup>	5	<b>J701/TB</b>
					<b>JB701/TB</b>

## Technical and Service Information

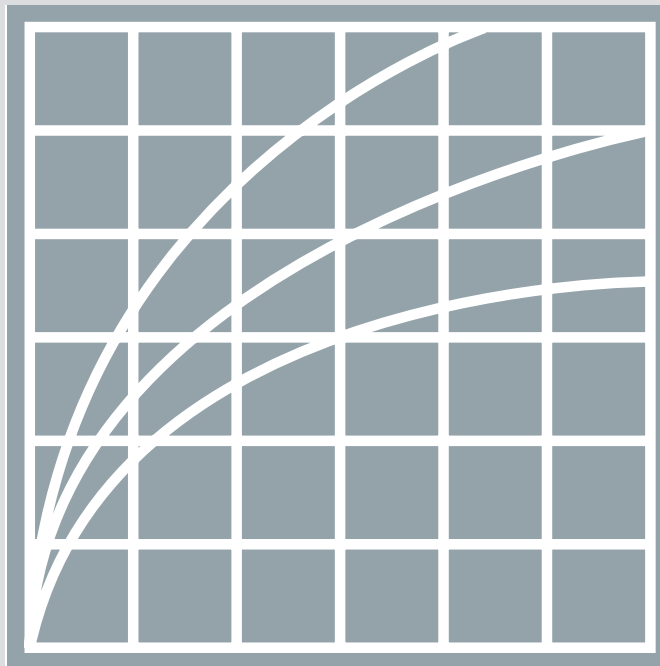

## White Products Selection Chart

cat. ref.	standard surface box ref.	deep box ref.
<b>Wall Switches</b>		
PPS11	P815	P81D
PPS12	P815	P81D
PPS16	P815	P81D
PPS22	P815	P81D
PPS32	P815	P81D
PPBP12	P815	P81D
<b>Fan Isolator Switches</b>		
PPS3PI	P81D	P81XD
PPS3PIF	P81D	P81XD
<b>Sockets</b>		
PS81	P81D	P81XD
PS82	P82D	P82XD
PSS81	P81D	P81XD
PSS82	P82D	P82XD
<b>Fused Connection Units</b>		
PSSU83	P81D	P81XD
PSSU83N	P81D	P81XD
PSU83	P81D	P81XD
<b>20 Amp Double Pole Switches</b>		
PDP84	P81D	P81XD
PDP84N	P81D	P81XD
PDP85	P81D	P81XD
PDP85N	P81D	P81XD
<b>45 Amp double pole switches</b>		
PDP445N	P81XD	n/a
PDP845	P82XD	n/a
PDP845N	P82XD	n/a
<b>Cooker controls</b>		
PCCU2000	P82XD	n/a
PCCU2000N	P82XD	n/a
<b>Cooker cable outlets</b>		
CCO503	P81XD	n/a
<b>Ancillaries</b>		
SO100	SB105	n/a
FOP102	P815	P81D
PTV102	P815	P81D
PTVI103	P815	P81D
PTS03/1A	P81D	P81XD
PPSB81, PPSB82	P81D	P81XD

### Compliance with standards

Regulation 511-01-01 of BS 7671 : 1992 Requirements for Electrical Installations, IEE Wiring Regulations Sixteenth Edition is of particular importance to specifiers and installers with respect to product standards.

Regulation 511-01-01 requires every item of equipment to comply with the relevant requirements of the applicable British Standard, or Harmonised Standard appropriate to the intended use of the equipment.

### British Standards (BS)

The BSI (British Standards Institution) was the first national standards body in the world. There are now more than 100 similar organisations which belong to the International Organisation for Standardisation (ISO) and the International Electrotechnical Commission (IEC).

British Standards are drawn up by all those who have a particular interest in the subject i.e. manufacturers, users, research organisations, government departments and consumers. This work is co-ordinated by BSI staff, acting as secretaries to the committees where the work is done. All standards are made available for public comment before they are published.

### Harmonised standards

A Harmonised standard is a European standard formally presented by CENELEC, to the European Commission and published in the commission's official journal. CENELEC is the Comité Européen de Normalisation Electrotechnique i.e. European Committee for Electrotechnical Standardisation.

BS 7671 part 2 defines a harmonised standard as a standard which has been drawn up by common agreement between national standards bodies notified to the European Commission by all member states and published under national procedures. The UK national standards body is the British Standards Institution. In the UK a harmonised standard will normally be published as a British Standard European Norm i.e. BS EN.

### British Standard European Norm (BS EN)

CENELEC European standards are pre-fixed EN (European Norm). Adoption of the European Standard within the EC is mandatory and member countries of CENELEC are obliged to publish them unchanged. In the UK such standards are further endorsed with the additional prefix 'BS', for example BS EN 60669-1 : 1996 is the British Standard European Norm for Switches for household and similar fixed electrical installations.

Whilst a European Standard can be a direct replica of an IEC standard, discussions within CENELEC may result in the formulation of a standard which includes commonly agreed variations and Special National Conditions.

### International Electrotechnical Commission (IEC)

Founded in 1906 the International Electrotechnical Commission (IEC) is the world organisation that prepares and publishes international standards for all electrical, electronic and related technologies. The membership consists of 60 participating countries, including all the world's major trading nations and a growing number of industrialising countries.

Foreign national standards based on IEC standards are permitted to be used by BS 7671. However the specifier must verify that any differences between the foreign standard and the corresponding British Standard or Harmonised Standard does not result in any lesser degree of safety than that afforded by compliance with the British Standard. This assessment would probably need to be made by specialists.

### Conclusion

BS 7671 (IEE Wiring Regulations) recognises equipment which complies with a British Standard or Harmonised Standard appropriate to the intended use of the equipment without the need for further qualification.

Ashley and Rock products have always been designed and manufactured to a high standard to ensure compliance with the current British or Harmonised Standard. See the table below for further information.

product description	Ashley product identification	BS number	description
system:grid switches	GS	BS EN 60669-1 : 2000	Switches for household and similar fixed electrical installations
Indicators	GSIN	BS 5733 : 1995	General requirements for Electrical Accessories
Fused Connection Unit, cord outlets	GFU13	BS 5733 : 1995	Switches for household and similar fixed electrical installations with particular requirements for timedelay switches (TDS)
Dimmers	GD	BS EN 60669-2 :1998	Switches for household and similar fixed electrical installations with particular requirements for timedelay switches (TDS)
Frames and Plates	GF, GP	BS 5733 : 1995	Switches for household and similar fixed electrical installations with particular requirements for timedelay switches (TDS)
Boxes	MP, PB	BS 4662 : 1980 or BS 5733 : 1995	Specification for boxes for the enclosure of electrical accessories
10 Amp Wall Switch	PS, PBP, SMPS GMPS, MCPS REPS, PBPS, MPS	BS EN 60669-1 : 2000 BS 3676 : 1 : 2000	Switches for household and similar fixed electrical installations
Dimmer Switches	PBSD4,MCSD4 RES4,GMSD4 SMSD4	BS 5518 : 1977	Electronic variable control switches (dimmer switches) for tungsten filament lighting

## Product Standards

product description	Ashley product identification	BS number	description
13 Amp Socket Outlets	PS, PSS	BS 1363 : Part 2 : 1995	13A plugs, socket-outlets, adaptors and connection units
20 Amp D.P. Switches	PDP	BS EN 60669-1 : 2000 BS 3676 : 1 : 2000	Switches for household and similar fixed electrical installations
13 Amp Fused Connection Unit	PSU, PSSU	BS 1363 : Part 4 : 1995	Specification for 13A fused connection units switched and unswitched
45 Amp D.P. Switches	PDP	BS EN 60669-1 : 2000 BS 3676 : 1 : 2000	Switches for household and similar fixed electrical installations
45 Amp Cooker Control Units	PCCU	BS 4177 : 1992	Cooker control units
Cooker Cable Outlets	CCO	BS 5733 : 1995	General Requirements for Electrical Accessories
Shaver Socket Outlet	SO	BS 3535 : 1990 BS EN 60742 : 1996	General Requirements Isolating transformers and safety isolating transformers Electromagnetic compatibility, immunity requirements for household appliances tools and similar apparatus.
15 Amp Flex Outlet Plate	FOP	BS 5733 : 1995	General Requirements for Electrical Accessories
Safety Enhanced Lampholder	SEL	BS 7895 : 1997	Specification for bayonet lampholders with enhanced safety
6 Amp S.P. Ceiling Switches Installations	CS	BS EN 60669-1 : 2000	Switches for household and similar fixed electrical installations
50 Amp D.P. Ceiling Switch Isolating	CS	BS 3676 : 2000	Switches for household and similar fixed electrical installations
Ceiling Switch 3 Pole, 10 Amp	CS	BS EN 60669-1 : 2000	Switches for household and similar fixed electrical installations
Super Access Terminal Bank Type Ceiling Rose	RL	BS 67 : 1987	Ceiling Roses
Knockout Slot Terminal junction boxes	J	BS 6220 : 1983	Junction Boxes for use in electrical installations with rated voltages not exceeding 250V
Selective Entry Terminal Bank Junction Box	J	BS 6220 : 1983	Junction Boxes for use in electrical installations with rated voltages not exceeding 250V
Selective Entry Terminal Bank Junction Box	J	BS 6220 : 1983	Junction Boxes for use in electrical installations with rated voltages not exceeding 250V

## Terminal Capacities

product	No. of cable cores to each terminal hole						
	1.0 mm <sup>2</sup>	1.5 mm <sup>2</sup>	2.5 mm <sup>2</sup>	4.0 mm <sup>2</sup>	6.0 mm <sup>2</sup>	10 mm <sup>2</sup>	16 mm <sup>2</sup>
<b>Wall range</b>							
10 Amp switches	4	3					
<b>Power range</b>							
13 Amp & 15 Amp socket outlets - switched			5	3	2		
13 Amp & 15 Amp socket outlets - unswitched			4	3	2		
20 Amp double pole switches			3	2	1	1	
20 Amp double pole switches / earth term only			4	3	2		
13 Amp fused connection units - switched			5	3	2		
13 Amp fused connection units - unswitched			4	3	2		
45 Amp double pole switches				3	2	1	1
45 Amp double pole switch / earth term only			4	3	2	1	
<b>Cooker control units</b>							
All 45 Amp units				3	2	1	1
Cooker cable outlets				4	3	1	1
<b>Accessories</b>							
Shaver socket outlet	3	2					
Flex outlet plate	5	4	3				
Dimmer units	4	3					
<b>Lampholders</b>							
Batten lampholders & safety	3	2	1				
<b>Ceiling switches</b>							
6 Amp ceiling switches	3	2					
15 Amp ceiling switches	5	4	3				
45 Amp ceiling switches				3	2	1	1
<b>Ceiling roses</b>							
Ceiling roses RL624	3	2	1				
<b>Junction boxes</b>							
20 Amp junction boxes	5	3	2				
30 Amp junction boxes			4	3	2		
JB701/TB	5	4	3				
<b>system<sup>3</sup>grid</b>							
Switches				2			
Indicators			2				
Emergency lamp			2				
Fused connection units				2			
Dimmers			2				

## Technical specification

	switches	indicators		buzzers	
Current rating	10AX - 20AX	0.9VA	0.26VA	8VA	
Voltage rating	250 Vac	24V	250Vac	24Vca	230Vac
Terminal capacity	2 x 4mm <sup>2</sup>	-	2 x 2.5mm <sup>2</sup>		
Contact gap	>3mm				
Operating temperature	-5 + 40°C	-5 + 40°C		-5 + 40°C	
Installation altitude	2000m	2000m		2000m	
Operational life	40.000 operations	>2.000h	<25.000h	according to BS 5733	

	emergency lamp	fuse unit	dimmers
Current rating	23mA	13A	100-500W 60-500W
Voltage rating	230 Vac	250Vac	230Vac
Terminal capacity	2 x 2.5mm <sup>2</sup>	2 x 4mm <sup>2</sup>	2 x 2.5mm <sup>2</sup>
Contact gap	-	-	minigap construct.
Operating temperature	-5 + 40°C	-5 + 40°C	-5 + 40°C
Installation altitude	2000m	2000m	2000m
Operational life	1000 charge - discharge cycles	according to BS 5733	40.000 operations

Installation instructions

**Note:** Isolate circuit before installation

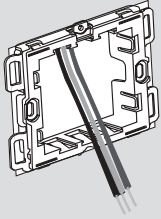

Install the back box, connect earthing conductors to back box and frame, pull cables through and mount frame to box. Cut and strip cables to length.

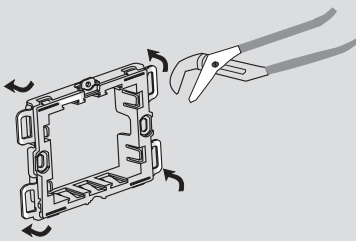

For surface mount installations bend the wings back by 90°

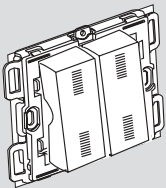

Connect the cables to the switch or accessory and clip in position.

Repeat until all accessories have been fitted.

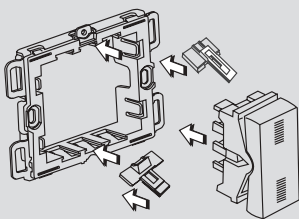

For fitting System 45 accessories using GA45 adaptor. Slide the adaptor into the frame until it clicks home. Two adaptors are supplied per module. Clip the relevant accessory to the adaptor.

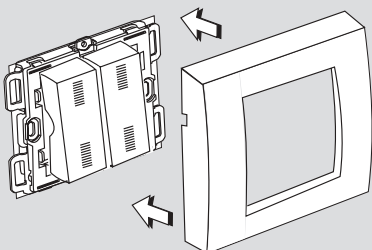

Fit the front plate to complete to complete the installation. Plastic plates clip to the frame offering a neat screwless appearance. All metal plates fix to the frame with captive screws supplied in each plate.

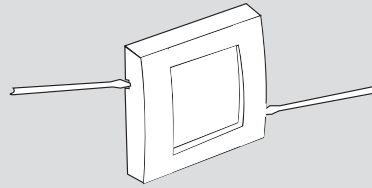

**Removing plastic front plates.**

Place a flat screwdriver in each aperture in turn and gently lever the plate free.

Apertures are so placed that leverage is between the frame wings and plate.

Removing modules. Remove front plate. Place a flat screwdriver in the slot and gently prise open the clip while pulling the module forward. Repeat with the lower clip.

**If in doubt consult a qualified electrician.**

Please refer to 2002/2003 catalogue for product selection

Available with Ashley is a front plate marking service, where relevant legends or marks can be included on the accessory during manufacture.

This is offered as an added value service to all our customers.

### Process

Each legend is produced by a touch printing process using Epoxy inks.

Periodic random sampling of each batch is carried out, where the marking is subject to solvent and abrasion tests that far exceed BS 3955 indelibility of markings requirements.

The result is a clean well defined legend which has no dirt catching apertures, that will look good for many years, can be applied to any type of front plate finish e.g. Metalclad.

### Range

A number of accessories include relevant legends on the front plate as standard i.e. 'Water heater' on a profile 20Amp D.P. switch - cat. ref. DP85. As well as this standard marking it is possible to print face plates with other information. Available marks are listed opposite. The standard colour of printing is black.

Other special markings can be supplied, please contact National Sales Hotline on 0870 240 2400 with details of marking required and availability.

### Ordering

Each order for printing of front plate must be confirmed in writing with exact description of the marking and order quantity before any order can be processed.

These are non-standard products therefore please ring to check for availability prior to placing an order.

Pack quantities apply to these orders as per those of the base unit.

**Contact National Sales Hotline on 0870 240 2400**

Available markings

#### mark

Air conditioner

Bell

Boiler

Central heating

Central heating  
use 3 Amp fuse

Cooker

Cooker Hood

Dishwasher

Extract Fan

Fan

Fan heater

Freezer

Fridge

Fridge / freezer

Heater

Heating

Heating Circuit

Heating Pump

Hob

Intruder Alarm Syst.

Microwave

Off/On

On

Oven

Press

Press to exit

Pump

Refrigerator

Refrigerator  
using 3 Amp fuse

Shower

Socket below

Tumble Dryer

Towel rail

Water heater

Washerdryer

Washing Machine

Washing machine  
use 13Amp fuse

Waste Disposal

**Objective of CE marking.**

CE marking is a “technical passport” which indicates that a product conforms to all relevant directives which require CE marking, thus enabling the product to travel within the E.U.

A directive is a piece of mandatory European Legislation implemented by regulations in all member countries. Its purpose is to allow free movement of goods that are safe and fit for use into and within the European Union.

CE marking is not a quality mark and it does not indicate that any testing or certification has been carried out.

**The marking.**

CE marking is a statement by the manufacturer that the product complies with the essential requirements of all relevant Directives, notably in the area of technical safety and conformity assessment.

CE marking can appear on the product or packaging or documentation or combination thereof dependant upon which directive it has to comply with.

CE marking is a very specific graphical symbol and must be clearly separated from other marks.

**Directives.**

It is the responsibility of the manufacturer or his authorised representative who places the product onto the EC market to decide which Directive(s) apply and to ensure the CE marking is affixed by the dates stated in the relevant directive(s)

For the majority of Ashley products only one directive is applicable this is referred to as the Low Voltage Directive. Where some products incorporate electronic devices the Low voltage Directive and the Electromagnetic Compatibility Directive are applicable.

**The Low Voltage Directive.**

EC directives are requirements adopted by the European Council and published in the Official Journal of the European Communities and are addressed to the member states.

European Council Directive 73/23/EEC with an amendment 93/68/EEC is known as the Low Voltage Directive.

The Low Voltage Directive has been implemented into UK law by the “Electrical Equipment (Safety) Regulations 1994” and apply to all electrical / electronic equipment operating at a voltage of 50-1000 V a.c. or 75-1500 V d.c.. They do not apply to plugs, socket outlets and adapters which are covered by the Plugs and Sockets (Safety) Regulations 1994.

***Relationship between the Electrical Equipment (Safety) Regulations, Harmonised standards and the IEE Wiring Regulations Sixteenth Edition.***

The Electrical Equipment (Safety) Regulations requires electrical equipment to be safe. Electrical equipment which satisfies the safety provisions of Harmonised standards shall be taken to comply with this requirement, unless there are reasonable grounds for suspecting that the equipment does not so comply.

Regulation 511-01-01 of BS 7671 Requirements for Electrical Installations, IEE Wiring Regulations Sixteenth Edition requires every item of equipment to comply with the relevant requirements of the applicable British Standard, or Harmonised Standard appropriate to the intended use of the equipment.

Ashley products have always been designed and manufactured to a high standard to ensure compliance with the current British or Harmonised Standard.

## IP Rating

The International Protection (IP) code for all low voltage enclosures up to 1000 V a.c. and 1500 V d.c. is defined in identical fashion by the standards BS EN 60529 - IEC 529 it comprises the letters IP followed by two character numerals:

**The first character numeral** indicates the degree of protection provided by the enclosure with respect to persons, also to the equipment inside the enclosure

**The second character numeral** indicates the degree of protection provided by the enclosure with respect to harmful ingress of water; a third character may be used to indicate mechanical strength. An x signifies that no test has been carried out

### The first character numeral protection against solid substances

IP	test	short description	definition
0		non-protected	no special protection
1		protected against solid objects greater than 50 mm	a large surface of the body, such as a hand (but no protection against deliberate access) solid objects exceeding 50 mm in diameter
2		protected against solid objects greater than 12.5 mm	fingers or similar objects not exceeding 80 mm in length; solid objects exceeding 12.5 mm in diameter
3		protected against solid objects greater than 2.5 mm	tools, wires, etc..., of diameter or thickness greater than 2.5 mm; solid objects exceeding 2.5 mm in diameter
4		protected against solid objects greater than 1.0 mm	wires or strips of thickness greater than 1.0 mm; solid objects exceeding 1.0 mm in diameter
5		dust-protected	ingress of dust is not totally prevented but dust does not enter in sufficient quantity to interfere with satisfactory operation of the equipment
6		dust-tight	no ingress of dust

### The second character numeral protection against liquid substances

IP	test	short description	definition
0		non-protected	no special protection
1		protected against dripping water	dripping water (vertically falling drops) shall have no harmful effect
2		protected against dripping water when tilted up to 15°	vertically dripping water shall have no harmful effect when the enclosure is tilted at any angle up to 15° from its normal position
3		protected against spraying water	water falling as a spray at an angle up to 60° from the vertical shall have no harmful effect
4		protected against splashing water	water splashed against the enclosure from any direction shall have no harmful effect
5		protected against water jets	water projected by a nozzle against the enclosure from any direction shall have no harmful effect
6		protected against heavy seas	water from heavy seas or water projected in powerful jets shall not enter the enclosure in harmful quantities
7		protected against the effect of immersion	ingress of water in a harmful quantity shall not be possible when the enclosure is immersed in water under defined conditions of pressure and time
8		protected against submersion	the equipment is suitable for continuous submersion in water under conditions which shall be specified by the manufacturer





Please consult us for our latest copy of terms and conditions of sale

Specifying the system to suit your project, or ordering the necessary components really couldn't be easier. However, if you need any assistance please consult our sales or technical helpline.

**Sales Hotline**      **0870 240 2400**  
e-mail:                [sales@hager.co.uk](mailto:sales@hager.co.uk)

**Technical Helpline**      **0870 607 6677**  
e-mail:                [technical@hager.co.uk](mailto:technical@hager.co.uk)

Information regarding products featured in this brochure can be found on our website.

[www.hagergroup.co.uk](http://www.hagergroup.co.uk)



### Ceiling Products

The market leading range of Ashley ceiling products has become the industry benchmark for quality, reliability, and ease of installation.



**profile<sup>+</sup>**  
**plus**

### White Moulded

The new Profile plus range has distinctive and stylish aesthetics. The smooth clean white scratch resistant frontplates will blend with any installation. In addition a new range of euro modules allow power and data to share common aesthetics.



### Junction Boxes

The market leading installers choice of junction boxes will shortly be enhanced with the addition of a torpedostyle box. This is ideal for installations where a narrow profile but generous cable space is required.



### Metalclad

The Metalclad range has recently been extended to provide installers with a wider choice of solutions. Additional metalclad configurations can be provided using metalclad grid.



### Decorative

The Ashley decorative range has recently been extended to provide a cost effective solution where an enhanced finish is required. Matching decorative grid solutions are also available to compliment the range.



### Flat Plate - **Coming Soon**

Flat plate is a high quality product with integral high density foam seals to provide a neat fit to the wall. Installation is enhanced by the shallow modules that make installation in 25mm boxes possible for most products.

---

Hager Ltd  
Hortonwood 50  
Telford  
Shropshire  
TF1 7FT  
Tel: 01952 677899  
Fax: 01952 675581

**hager group**

**National Sales Hotline**  
0870 240 2400

**National Technical Support Helpline**  
0870 607 6677

**National Sales Faxline**  
0870 240 0400