

Deep groove ball bearings, single row

Principal dimensions			Basic load ratings		Fatigue load limit P_u	Speed ratings		Mass	Designation
d	D	B	dynamic	static		Reference speed	Limiting speed		
mm			kN		kN	r/min		kg	-
65	120	23	58,5	40,5	1,73	-	3600	0,99	6213-2RS1 *

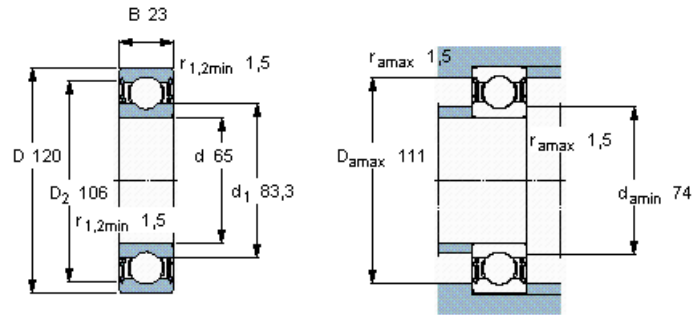

Calculation factors

k_r 0,025
 f_0 15