



APPLICATION SPECIFICATION

ASSEMBLY INSTRUCTIONS FOR THE 130199 MAXLOC

1.0 SCOPE

To ensure that all components are correctly assembled and the shielded cable is correctly terminated

2.0 PRODUCT DESCRIPTION

<u>PART NO.</u>	<u>DESCRIPTION</u>
1301990030	1 AWG GRIP ASSEMBLY, HNBR (SINGLE ASSEMBLY)
1301990130	1 AWG GRIP ASSEMBLY, HNBR (KIT ASSEMBLY, 420 LOOSE PCS)
1301990230	1 AWG GRIP ASSEMBLY, SILICONE (SINGLE ASSEMBLY)
1301990330	1 AWG GRIP ASSEMBLY, SILICONE (KIT ASSEMBLY, 420 LOOSE PCS)
1301990020	1/0 AWG GRIP ASSEMBLY, HNBR (SINGLE ASSEMBLY)
1301990120	1/0 AWG GRIP ASSEMBLY, HNBR (KIT ASSEMBLY, 420 LOOSE PCS)
1301990220	1/0 AWG GRIP ASSEMBLY, SILICONE (SINGLE ASSEMBLY)
1301990320	1/0 AWG GRIP ASSEMBLY, SILICONE (KIT ASSEMBLY, 420 LOOSE PCS)
1301990025	2/0 AWG GRIP ASSEMBLY, HNBR (SINGLE ASSEMBLY)
1301990125	2/0 AWG GRIP ASSEMBLY, HNBR (KIT ASSEMBLY, 420 LOOSE PCS)
1301990225	2/0 AWG GRIP ASSEMBLY, SILICONE (SINGLE ASSEMBLY)
1301990325	2/0 AWG GRIP ASSEMBLY, SILICONE (KIT ASSEMBLY, 420 LOOSE PCS)

3.0 REFERENCE DOCUMENTS

- PK-130199-001
- PS-130199-001
- SD-130199-001
- MAXLOC is designed to accept the Molex 1AWG, 1/0AWG & 2/0AWG Battery Cable Lugs. Reference SD-19221-010 and SD-19221-011.

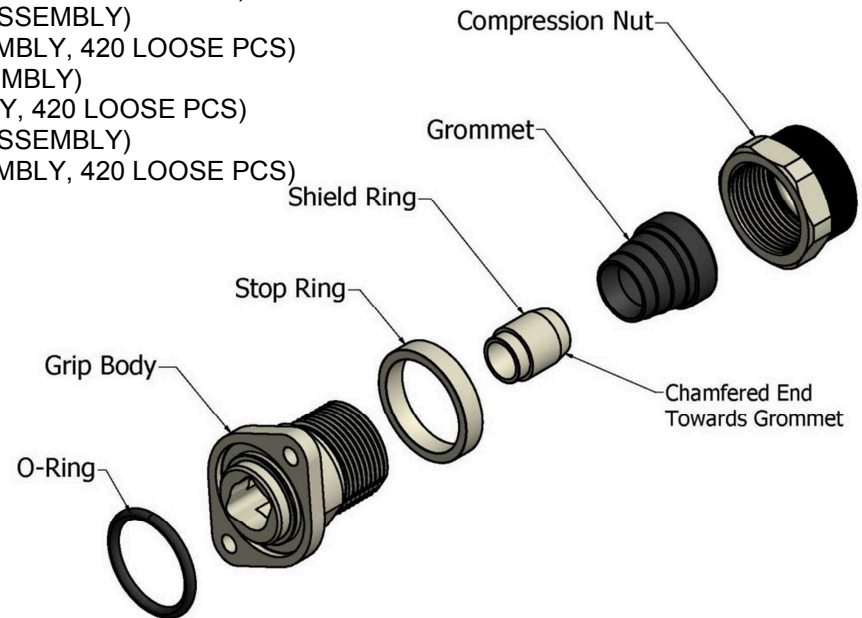

<u>REVISION:</u> H	<u>ECR/ECN INFORMATION:</u> <u>EC No:</u> IPG2013-2040 <u>DATE:</u> 2013 / 08 / 26	<u>TITLE:</u> ASSEMBLY INSTRUCTIONS FOR THE 130199 MAXLOC 1AWG, 1/0AWG, 2/0AWG	<u>SHEET No.</u> 1 of 2
<u>DOCUMENT NUMBER:</u> AS-130199-001	<u>CREATED / REVISED BY:</u> WLEUNG	<u>CHECKED BY:</u> KJOZWIK	<u>APPROVED BY:</u> JFMURPHY



APPLICATION SPECIFICATION

4.0 ASSEMBLY INSTRUCTIONS

- Strip both the Cable Jacket and the Cable Shield, Strip Length "X" = "L" + 9.4mm [.37inch]
- Then strip the Cable Jacket an additional 12.7mm [.50inch], so the Cable Shield is exposed

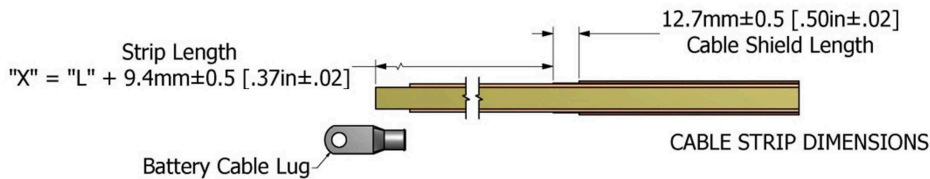
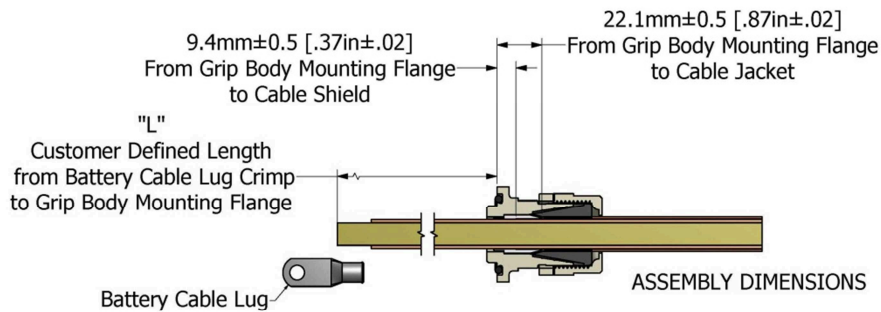

- Slide the Compression Nut, Friction Ring, and Grommet onto the Cable Jacket

- Slide the Shield Ring onto the Cable Insulation

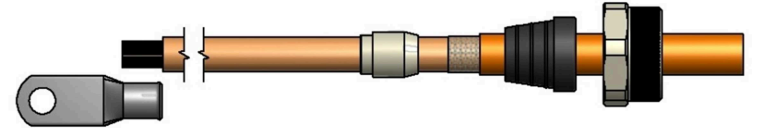

- Optional (Strip the Cable Insulation and crimp a Battery Cable Lug onto the Cable Conductor)*

- Fold the exposed Cable Shield back around the Grommet

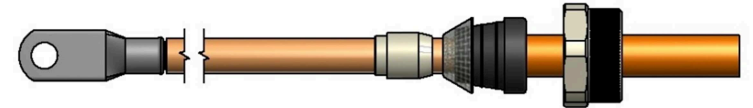

- Slide the Stop Ring and Grip Body onto the Cable
- Slide the O-Ring into the Grip Body O-Ring Groove

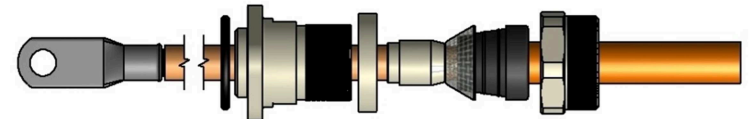

- Tighten the Compression Nut to the Stop Ring. Then apply the recommended torque to Compression Nut. Recommended Torque: 24 ft-lbf (32.5 N-m) ±20% Maximum Torque: 30 ft-lbf (40.7 N-m)

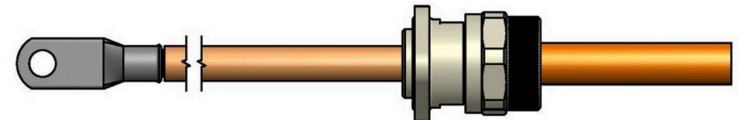

REVISION: H	ECR/ECN INFORMATION: EC No: IPG2013-2040 DATE: 2013 / 08 / 26	TITLE: ASSEMBLY INSTRUCTIONS FOR THE 130199 MAXLOC 1AWG, 1/0AWG, 2/0AWG	SHEET No. 2 of 2
DOCUMENT NUMBER: AS-130199-001	CREATED / REVISED BY: WLEUNG	CHECKED BY: KJOZWIK	APPROVED BY: JFMURPHY