

TOKO DEM2810C SAMPLE KIT DATA SHEET

DEM2810C



Features

- Low profile (2.8x3.0mm. square, 1.0mm Max. height).
- Magnetically shielded construction and low DC resistance.
- Ideal for a variety of DC-DC converter inductor applications.
- RoHS compliant.
- Halogen free.

Electrical characteristics

Inductance range

DEM2810C : 1 ~ 12 μ H

Recommended patterns

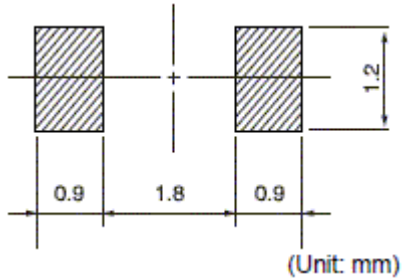

Dimensions

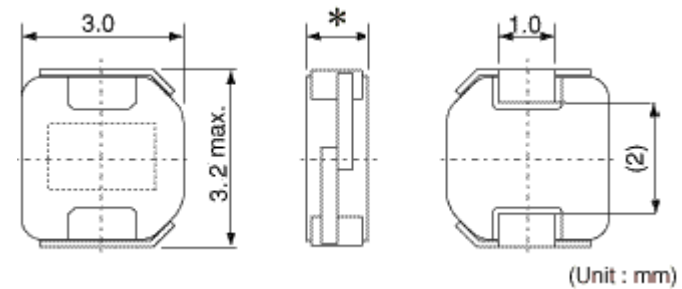

* DEM2810C : 1.0mm Max.

TOKO DEM2810C SAMPLE KIT DATA SHEET

<u>TOKO PART NUMBER</u>	<u>INDUCTANCE (μH)</u>	<u>TOLERANCE (%)</u>	<u>DC RESISTANCE (mΩ) Max. (Typ.)</u>	<u>Temperature Rise Current⁽³⁾ T=40C (A) Max. (Typ.)</u>	<u>QUANTITY PER SAMPLE BOX</u>
1224AS-H-1R0N	1.0	+/-30	66 (55)	1.90 (2.20)	5
1224AS-H-1R5N	1.5	+/-30	78 (65)	1.70 (2.00)	5
1224AS-H-2R2M	2.2	+/-20	102 (85)	1.40 (1.60)	5
1224AS-H-3R3M	3.3	+/-20	144 (120)	1.20 (1.40)	5
1224AS-H-4R7M	4.7	+/-20	204 (170)	1.00 (1.20)	5
1224AS-H-6R8M	6.8	+/-20	300 (250)	0.85 (1.00)	5
1224AS-H-100M	10.0	+/-20	432 (360)	0.71 (0.84)	5
1224AS-H-120M	12.0	+/-20	540 (450)	0.55 (0.65)	5

1) Inductance is measured with a LCR meter 4284A (Agilent Technologies) or equivalent. Test frequency at 100kHz

(2) DC resistance is measured with 34420A (Agilent Technologies) or 3541(HIOKI). (Reference ambient temperature 25°C)

(3) Maximum allowable DC current is that which causes a 30% inductance reduction from the initial value, or coil temperature to rise by 40°C, whichever is smaller. (Reference ambient temperature 20°C)