

mounting accessories for tie-rod cylinders KLA1

TURCK

Industrial
Automation

mounting accessories for magnetic-inductive sensors and for mounting on tie-rod cylinders with diameters of 32...50 mm, aluminium

general description

The sensor programme comprises inductive, magnetic-inductive, capacitive, photoelectric and ultrasonic sensors as well as pressure and flow controls.

A broad range of practice-oriented accessories ensure optimal adaption to your system.

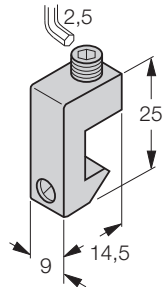

Type	KLA1
Ident-No.	69700
Housing	accessories for rectangular types, AKT
Dimensions	20 x 14.5 x 9 mm
Housing material	metal, AL

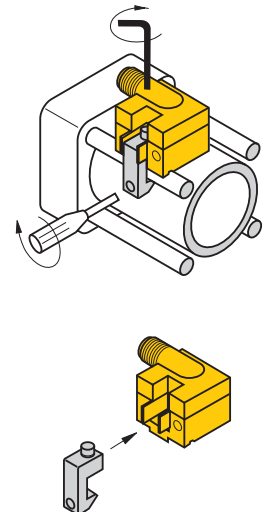

**mounting accessories
for tie-rod cylinders
KLA1**

TURCK

Industrial
Automation

• Edition: • 26.07.2008