

## Flush-type connector - SACC-E-M 8MS-5CON-M 8/0,5 DN - 1440119

Please be informed that the data shown in this PDF Document is generated from our Online Catalog. Please find the complete data in the user's documentation. Our General Terms of Use for Downloads are valid (<http://download.phoenixcontact.com>)



Bus system flush-type connector, plug, DeviceNet, 5-pos., M8, front/screw mounting with M8 fastening thread, with 0.5 m PVC litz wire, 5 x 0.25 mm<sup>2</sup>



### Key commercial data

Packing unit	1 pc
GTIN	 4 046356 481328
Weight per Piece (excluding packing)	16.2 g
Custom tariff number	85444290
Country of origin	Poland

### Technical data

#### Dimensions

Length of cable	0.5 m
-----------------	-------

#### Ambient conditions

Ambient temperature (operation)	-25 °C ... 85 °C
Degree of protection	IP67

#### General

Rated current at 40°C	4 A
Rated voltage	30 V
Number of positions	5
Contact resistance	≤ 3 mΩ
Insulation resistance	≥ 100 MΩ
Coding	A - standard
Standards/regulations	M8 connector IEC 61076-2-104
Signal type/category	DeviceNet™
Status display	No
Surge voltage category	II
Pollution degree	3

# Flush-type connector - SACC-E-M 8MS-5CON-M 8/0,5 DN - 1440119

## Technical data

### General

Connection method	Individual wires
Mounting type	Front mounting M8 x 0.5

### Material

Inflammability class according to UL 94	HB
Contact material	Cu alloy
Contact surface material	Au
Contact carrier material	PUR / PA66
Material, knurls	Nickel-plated brass
Sealing material	Viton

### Cable

Cable type	PVC litz wire
Conductor cross section	0.25 mm <sup>2</sup>
AWG signal line	26
Wire colors	Gray, red, white, black, blue
Material conductor insulation	PVC
Conductor material	Tin-plated Cu litz wires

## Classifications

### eCl@ss

eCl@ss 4.0	27250313
eCl@ss 4.1	27250313
eCl@ss 5.0	27143423
eCl@ss 5.1	27143423
eCl@ss 6.0	27143423
eCl@ss 7.0	27449001
eCl@ss 8.0	27449001

### ETIM

ETIM 3.0	EC002061
ETIM 4.0	EC002061
ETIM 5.0	EC002061

### UNSPSC

UNSPSC 6.01	31251501
UNSPSC 7.0901	31251501
UNSPSC 11	31251501
UNSPSC 12.01	31251501
UNSPSC 13.2	31251501

## Drawings

# Flush-type connector - SACC-E-M 8MS-5CON-M 8/0,5 DN - 1440119

Schematic diagram

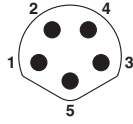

Pin assignment M8 plug, 5-pos., B-coded, view plug side

Dimensioned drawing

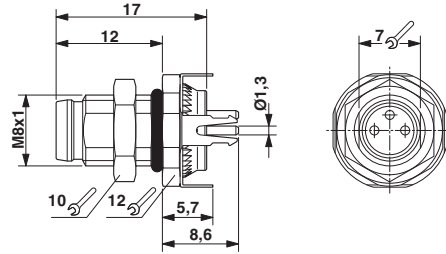

M8 flush-type plug, front mounting