



CIRCUIT-BREAKER SZ S00,
 A-REL. 0.14...0.2A,N-REL.2.6A,
 SCREW CONNECTION, SCREW CONNECTION,
 STANDARD SW. CAPACITY,
 W. TRANSVERSE AUX. SWITCH 1NO+1NC

| General technical data: | | |
|--|----|----------------------|
| product brand name | | SIRIUS |
| Product designation | | 3RV2 circuit breaker |
| Size of the circuit-breaker | | S00 |
| Number of poles / for main current circuit | | 3 |
| Product function | | |
| • removable terminal for auxiliary and control circuit | | No |
| • overload protection | | Yes |
| • phase disturbance recognition | | Yes |
| • short-circuit to earth recognition | | No |
| Product component | | |
| • auxiliary switch | | Yes |
| • undervoltage release mechanism | | No |
| • trip indicator | | No |
| Product extension | | |
| • auxiliary switch | | Yes |
| • optional / motor drive | | No |
| Impulse voltage resistance / rated value | kV | 6 |
| Protection class IP / on the front | | IP20 |
| Protection against electrical shock | | finger-safe |

| | | |
|---|----|-------------|
| Installation altitude / at a height over sea level / maximum | m | 2,000 |
| Resistance against shock | | 25g / 11 ms |
| Ambient temperature | | |
| • during transport | °C | -50 ... +80 |
| • during storage | °C | -50 ... +80 |
| • during operating | °C | -20 ... +60 |
| Active power loss / total / typical | W | 5.3 |

Main circuit:

| | | |
|---|-----|---------|
| Operating voltage / rated value | V | 690 |
| Service power / at AC-3 / at 400 V / rated value | kW | 0.06 |
| Operating current / at AC-3 / at 400 V / rated value | A | 0.2 |
| Mechanical operating cycles as operating time / of the main contacts / typical | | 100,000 |
| Frequency of operation / at AC-3 / according to IEC 60947-6-2 | 1/h | 15 |

Auxiliary circuit:

| | | |
|---|---|------------|
| Design of the auxiliary switch | | transverse |
| Number of changeover contacts / for auxiliary contacts | | 0 |
| Operating current / of the auxiliary contacts / at AC-15 / at 24 V | A | 2 |
| Operating current / of the auxiliary contacts | | |
| • at AC-15 / at 230 V | A | 0.5 |
| • at DC-13 | | |
| • at 24 V | A | 1 |
| • at 60 V | A | 0.15 |

Protective and monitoring functions:

| | | |
|--|----|--------------|
| Trip class | | CLASS 10 |
| Adjustable response current / of the current-dependent overload release | A | 0.14 ... 0.2 |
| Breaking capacity limit short-circuit current (I_{cu}) | | |
| • at 400 V / rated value | kA | 100 |
| • at 500 V / rated value | kA | 100 |
| • at 690 V / rated value | kA | 100 |

Installation/ mounting/ dimensions:

| | | |
|--------------------------|----|--|
| Type of mounting | | screw and snap-on mounting onto 35 mm standard mounting rail according to DIN EN 60715 |
| mounting position | | any |
| Depth | mm | 91 |
| Height | mm | 97 |
| Width | mm | 45 |

Connections/ terminals:

| | | |
|---|--|--|
| Arrangement of electrical connectors / for main current circuit | | Top and bottom |
| Design of the electrical connection <ul style="list-style-type: none">• for main current circuit• for auxiliary and control current circuit | | screw-type terminals screw-type terminals |
| Type of the connectable conductor cross-section <ul style="list-style-type: none">• for main contacts<ul style="list-style-type: none">• solid• finely stranded<ul style="list-style-type: none">• with conductor end processing• for AWG conductors / for main contacts• for auxiliary contacts<ul style="list-style-type: none">• solid• finely stranded / with conductor end processing• for AWG conductors / for auxiliary contacts | | 2x (0.75 ... 2.5 mm ²), 2x 4 mm ² 2x (0.5 ... 1.5 mm ²), 2x (0.75 ... 2.5 mm ²) 2x (18 ... 14), 2x 12 2x (0.5 ... 1.5 mm ²), 2x (0.75 ... 2.5 mm ²) 2x (0.5 ... 1.5 mm ²), 2x (0.75 ... 2.5 mm ²) 2x (20 ... 16), 2x (18 ... 14) |

Certificates/ approvals:

General Product Approval other



[other](#)

[Environmental Confirmations](#)

Further information:

Information- and Downloadcenter (Catalogs, Brochures,...)

<http://www.siemens.com/industrial-controls/catalogs>

Industry Mall (Online ordering system)

<http://www.siemens.com/industrial-controls/mall>

Cax online generator

<http://www.siemens.com/cax>

Service&Support (Manuals, Certificates, Characteristics, FAQs,...)

<http://support.automation.siemens.com/WWW/view/en/3RV6011-0BA15/all>

Image database (product images, 2D dimension drawings, 3D models, device circuit diagrams, ...)

http://www.automation.siemens.com/bilddb/cax_en.aspx?mlfb=3RV6011-0BA15

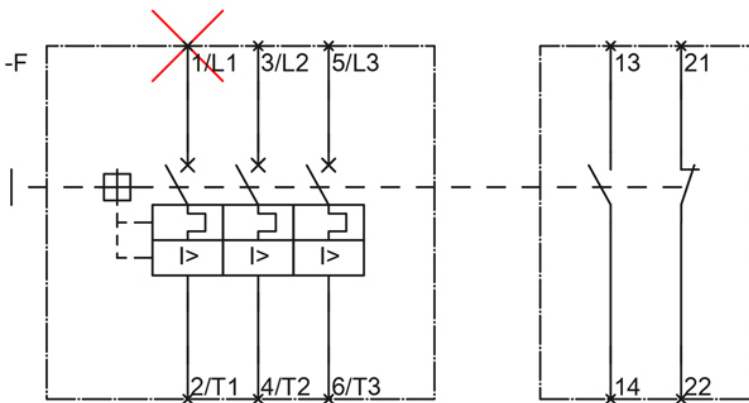
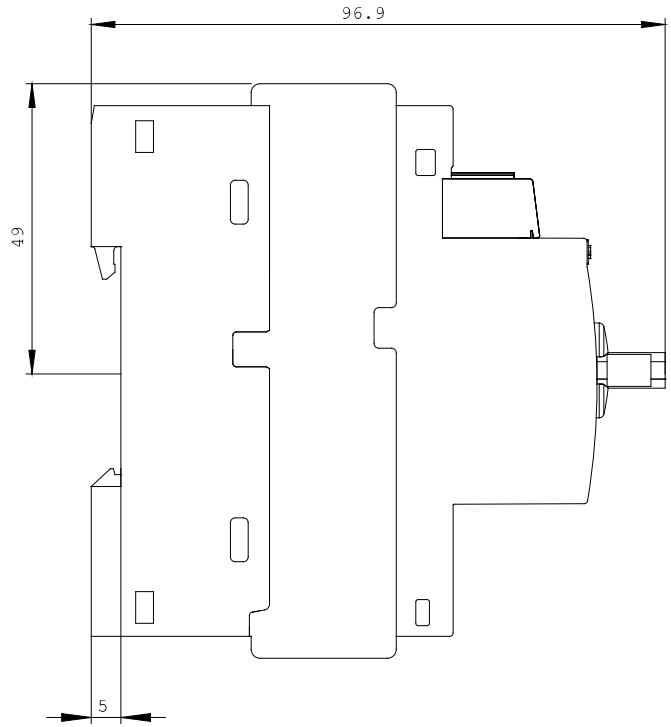

last change:

Oct 28, 2013