

## D-SUB crimp contact - VS-ST-CD-1,0/14,8/0,5 - 1688968

Please be informed that the data shown in this PDF Document is generated from our Online Catalog. Please find the complete data in the user's documentation. Our General Terms of Use for Downloads are valid (<http://download.phoenixcontact.com>)



Crimp contact, for D-SUB contact inserts with standard contact density, pin, connection cross section AWG 24 ... 20, turned, gold-plated

Similar figure



### Key commercial data

Packing unit	30 pc
Minimum order quantity	30 pc
GTIN	 4 017918 822880
Weight per Piece (excluding packing)	0.24 g
Custom tariff number	85369010
Country of origin	Germany

### Technical data

#### Mechanical characteristics

Insertion/withdrawal cycles	≥ 200
Connection method	Crimp connection
Conductor cross section	0.2 mm <sup>2</sup> ... 0.5 mm <sup>2</sup>
Connection cross section AWG	24 ... 20

#### Ambient conditions

Ambient temperature (operation)	-55 °C ... 125 °C
---------------------------------	-------------------

#### Material data

Contact material	Copper alloy
Contact surface material	Hard gold-plated over nickel

#### Electrical characteristics

Rated voltage (III/3)	125 V
Rated surge voltage	1 kV
Rated current	5 A

# D-SUB crimp contact - VS-ST-CD-1,0/14,8/0,5 - 1688968

## Technical data

### Electrical characteristics

Insulation resistance	$\geq 5 \text{ G}\Omega$
-----------------------	--------------------------

## Classifications

### eCl@ss

eCl@ss 4.0	27140816
eCl@ss 4.1	27140816
eCl@ss 5.0	27260701
eCl@ss 5.1	27260701
eCl@ss 6.0	27261202
eCl@ss 7.0	27440204
eCl@ss 8.0	27440204

### ETIM

ETIM 2.0	EC000796
ETIM 3.0	EC000796
ETIM 4.0	EC000796
ETIM 5.0	EC000796

### UNSPSC

UNSPSC 6.01	31261501
UNSPSC 7.0901	31261501
UNSPSC 11	31261501
UNSPSC 12.01	31261501
UNSPSC 13.2	31261501

## Accessories

### Accessories

#### Crimping tool

Crimping pliers - CRIMPFOX RC 2,5 - 1205448



Crimping pliers. with positioner, for turned connector contacts 0.14 mm<sup>2</sup> to 2.5 mm<sup>2</sup>

## D-SUB crimp contact - VS-ST-CD-1,0/14,8/0,5 - 1688968

### Accessories

Tool - VS-IET-DSUB-SIGNAL-STD - 1658794



Insertion/extraction tool, to insert and extract the D-SUB standard signal contacts

---

### Drawings

Dimensioned drawing

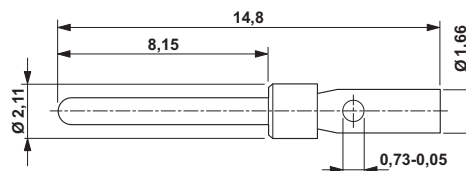

D-SUB crimp contact pin