

Datasheet

Insulated Crimp Bootlace Ferrule 12mm Pin Length

RS Stock number [513-2663](#)

Drawing (mm):

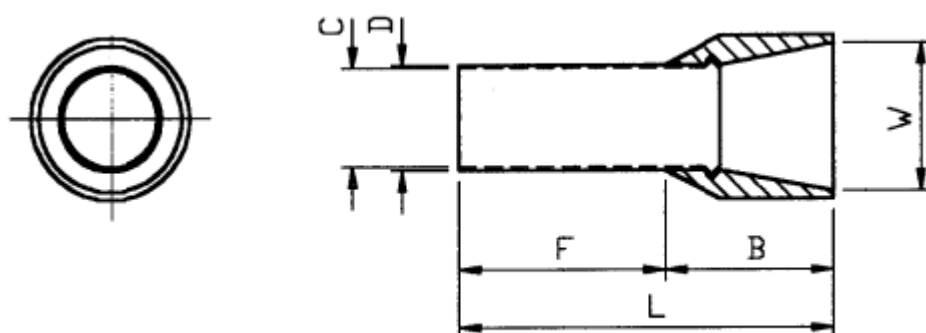

Stock Number	F ± 0.50	L ± 1.00	W ± 0.30	B ± 0.50	D ± 0.10	C ± 0.10	Colour
513-2663	12	22	8.7	10	6.2	5.8	BLUE

Specifications:

1. MAXIMUM ELECTRICAL RATING: 105°C 300 VOLTS MAX.
2. INSULATION MATERIAL: NYLON
3. TERMINAL MATERIAL: COPPER TUBE.
4. WIRE RANGE: 6A.W.G. (16mm²)