

# H 312

## Dimensions

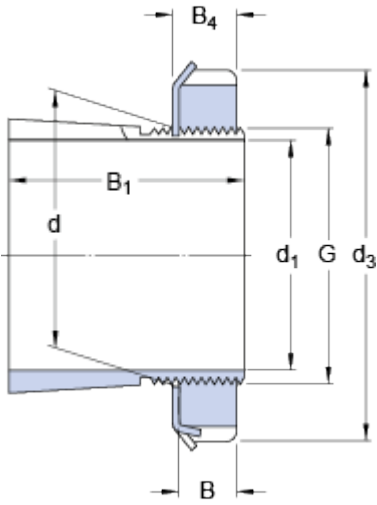

$d_1$	55	mm
$d$	60	mm
$d_3$	80	mm
$B_1$	47	mm
$B$	11	mm
$B_4$	13	mm
$G$	M 60x2	

## Mass

Mass adapter sleeve assembly

0.36 kg

## Appertaining products

Lock nut

KM 12

Locking device

MB 12

## Appropriate products

Hydraulic nut

HMV 12 E