



*Our Focus is in Plastics*

## Polymer Optics Ltd.

6 Kiln Ride, Wokingham,  
Berks., RG40 3JL, England  
Tel/Fax: +44 (0) 1189 893341  
www.polymer-optics.co.uk

### 6 Degree LED Collimator Lens - Part No. 120



- Designed for LUXEON® I, III and K2 LED's
- High light collection efficiency of >85%
- Suitable for all LUXEON® "Lambertian" and "Bat-wing" LED designs
- Precision moulded in optical grade Polycarbonate for thermal stability and system durability
- Part of the Polymer Optics "Modular LED Optics"® range

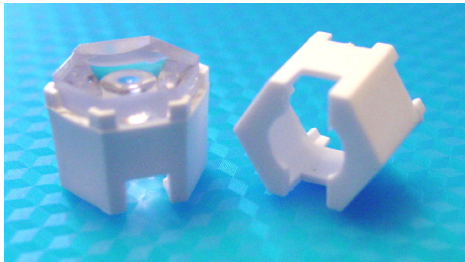

Typical dimensional tolerances  
to +/-0.2mm

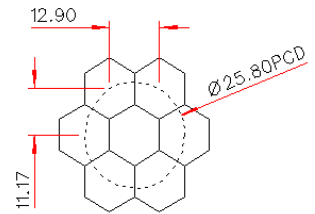
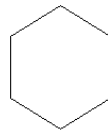

NESTED COMPONENTS ON 25,8MM PCD  
(ACTUAL SIZE)



Polymer Optics Limited is a certified  
Lumileds-Future Partner

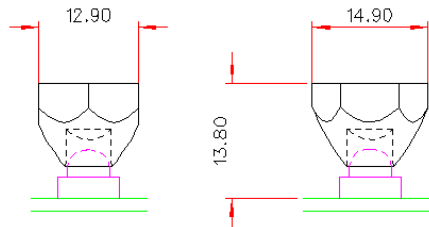

Polymer Optics "Modular LED Optics"® design, based on a hexagonal format, allows maximum packing density and assembly flexibility

Holder (Part No. 121) available for mounting optics onto LUXEON® I Star or LUXEON® Emitter PCB's

Star Holder (Part No. 128) available for LUXEON® III Star formats only.

K2 Holder (Part No. 151) available for LUXEON® K2 LED range.

Please refer to POL's "LUXEON® LED Optic Selection Table" to determine your optimum product configuration.

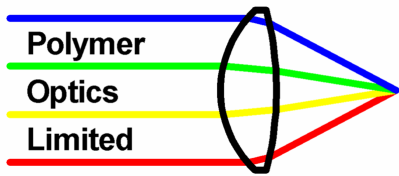

*Our Focus is in Plastics*

**Polymer Optics Ltd.**

6 Kiln Ride, Wokingham,  
Berks., RG40 3JL, England  
Tel/Fax: +44 (0) 1189 893341  
www.polymer-optics.co.uk

**6 Degree LED Collimator Lens - Part No. 120**

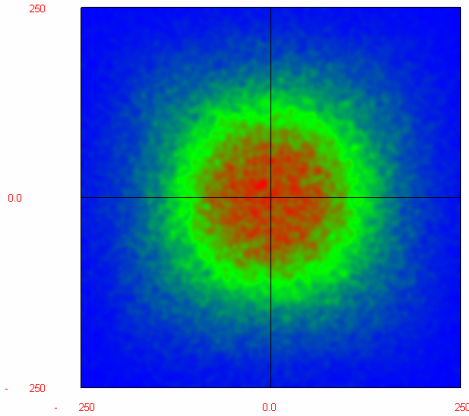

Raytrace Simulation of Typical Beam at 1m with 1W White LED

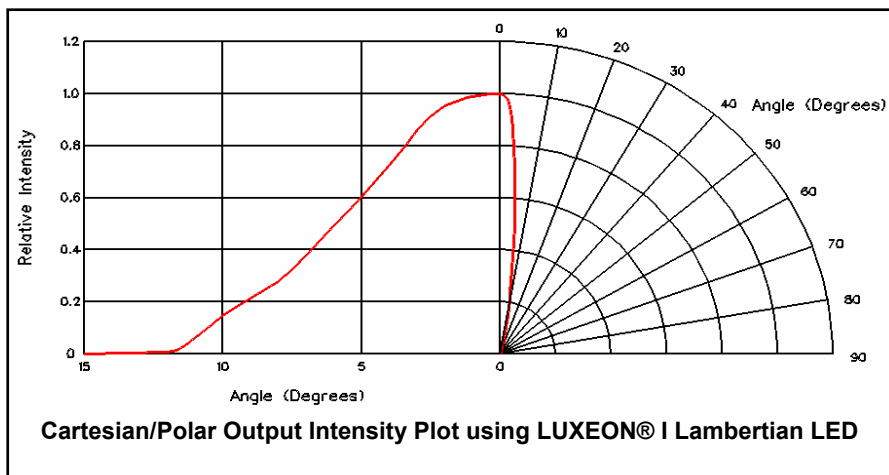
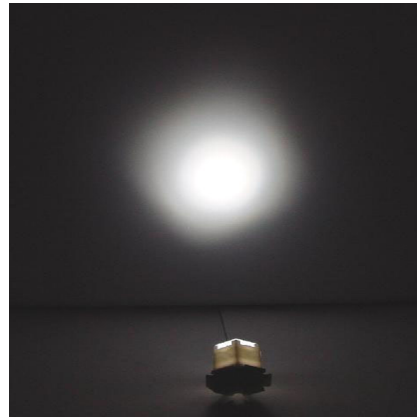

Typical illuminance values using 25 lumen white LUXEON® I Emitter = 16cd/lumen			
Range	0.5m	1m	2m
Illuminance	1600 lux	400 lux	100 lux

Performance values given are typical values and will vary dependant on LED binning, colour and drive profile

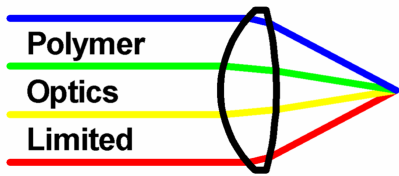

*Our Focus is in Plastics*

## Polymer Optics Ltd.

6 Kiln Ride, Wokingham,  
Berks., RG40 3JL, England  
Tel/Fax: +44 (0) 1189 893341  
www.polymer-optics.co.uk

### LUXEON® K2 Lens Holder - Part No. 151

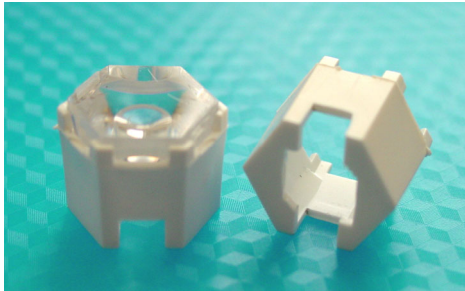

- Designed for use with Polymer Optics “Modular LED Optics”® and other custom Polymer Optics designs
- Designed for LUXEON® K2 Emitters
- Simply mounts onto PCB and self-aligns to LUXEON® K2 LED
- Precision moulded in optical grade Polycarbonate for thermal stability and system durability
- Part of the Polymer Optics “Modular LED Optics”® range

Polymer Optics “Modular LED Optics”® design, based on a hexagonal format, allows maximum packing density and assembly flexibility

Alternative Holders (Part Nos. 121 and 128) available for LUXEON® I, III and V Emitters and Star formats which have different mounting heights and package shapes.

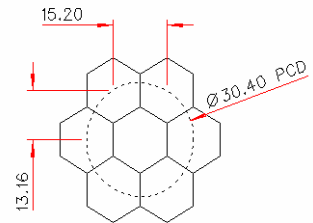
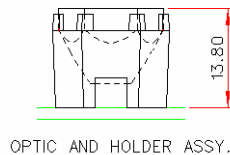
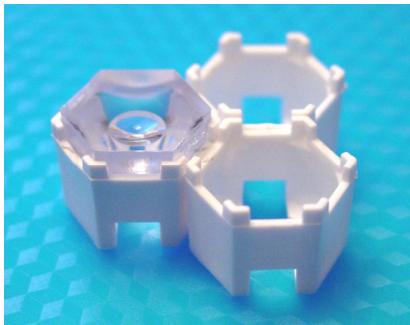

NESTED COMPONENTS ON 30.4MM PCD  
Typical dimensional tolerances to +/-0.2mm

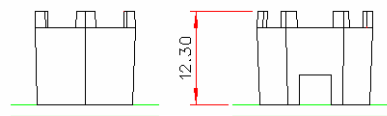
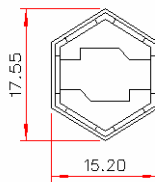

Polymer Optics Limited is a certified Lumileds-Future Partner

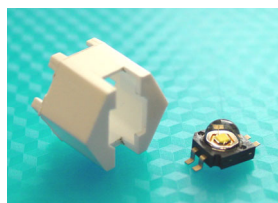

**151 Holder and LUXEON® K2 LED**

