

Product Specification

Material
 Insulator :Glass-Filled Thermoplastic PBT,UL94V-0 rated,Blue
 Contact :Brass ,Gold flash selective gold
 Shell :Steel, 100u" Tin Over 50u" min Nickel.

Electrical
 Contact Resistance :20 milliohms Max at 1 AMP DC.
 Insulation Resistance :1000 megohms at 500 VDC
 Dielectric Withstanding Voltage : 1000 VAC/rms 60Hz for 1 minute
 Current Rating :3 AMP
 Voltage Rating :250 VAC/rms 60Hz

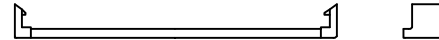
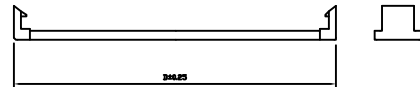
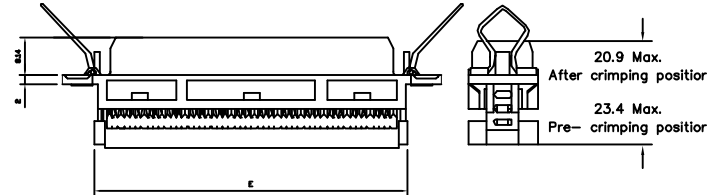
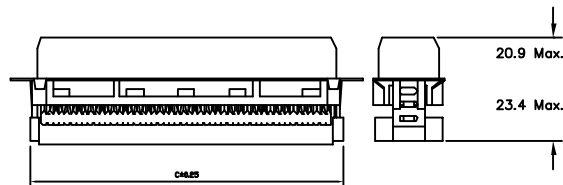

Matal shell (Male)

Matal shell (Female)

Dimensions Positions

	A	B	C	D
④ 24	23.76	48.6	35.5	37.5
④ 36	36.72	61.6	53.3	54.4
④ 50	51.84	76.7	68.5	70.5

Dimensions Positions

	A±0.25	B±0.13	C±0.13	D±0.20	E±0.25	F±0.25
④ 24	54.70	46.78	23.76	45.68	35.50	37.50
④ 36	67.80	59.75	36.72	58.65	51.50	58.80
④ 50	82.80	74.85	51.84	73.75	68.50	70.90

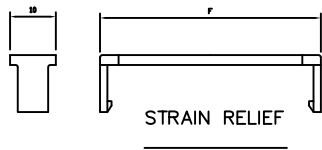

STRAIN RELIEF

RoHS compliant

Scale	Free					Date	Name	Customer-No.
TOLERANCE						Drawn	17.05.2006	Hellwig
X.	±0.38							
X.X	±0.25	④	Add this dimension for 36 poles & 50 poles	04.12.2012	Winnie	Approved	04.12.2012	Winnie
X.XX	±0.13	③	Update	13.12.2010	Alex			
Angle		②	Update	30.06.2009	Dean			
X.°	±3°	①	Drawn	17.05.2006	Hellwig			
X.X°	±1°							
		Id.	Modification	Date	Name			

ASSMANN WSW-No. A-57/xx FFR-N A-57/xx MFR-N	
Drawing-No. ASS 0126 CO	rev04
Replace	Sheet

