

## Printed-circuit board connector - PCV 35 HC/ 2-GF-15,00 - 1762796

Please be informed that the data shown in this PDF Document is generated from our Online Catalog. Please find the complete data in the user's documentation. Our General Terms of Use for Downloads are valid (<http://phoenixcontact.com/download>)

Header, Nominal current: 125 A, Rated voltage (III/2): 1000 V, Number of positions: 2, Pitch: 15 mm, Color: green, Contact surface: Silver, Mounting: Soldering



### Why buy this product

- ✓ PC 35 HC headers for use in combination with PC 35 plugs and IPC 35 headers
- ✓ Integrated double flange for fixing with PC 35 connector and housing panel
- ✓ Integrated threaded flange for screw connection with the PCB



### Key commercial data

Packing unit	25 pc
Minimum order quantity	25 pc
GTIN	 4 046356 444057
Weight per Piece (excluding packing)	48.31 g
Custom tariff number	85366990
Country of origin	Poland
Note	Made to Order (non-returnable)

### Technical data

#### Dimensions

Length	28.5 mm
Height	42.6 mm
Pitch	15 mm
Dimension a	15 mm
Pin dimensions	2,4 x 2,5 mm
Pin spacing	11.00 mm
Hole diameter	3.6 mm

#### General

Range of articles	PCV 35 HC/..-GF
Insulating material group	IIIa

# Printed-circuit board connector - PCV 35 HC/ 2-GF-15,00 - 1762796

## Technical data

### General

Rated surge voltage (III/3)	8 kV
Rated surge voltage (III/2)	8 kV
Rated surge voltage (II/2)	8 kV
Rated voltage (III/3)	1000 V
Rated voltage (III/2)	1000 V
Rated voltage (II/2)	1000 V
Connection in acc. with standard	EN-VDE
Nominal current $I_N$	125 A
Maximum load current	125 A
Insulating material	PBT
Inflammability class according to UL 94	V0
Color	green
Number of positions	2

## Classifications

### eCl@ss

eCl@ss 4.0	272607xx
eCl@ss 4.1	27260701
eCl@ss 5.0	27260701
eCl@ss 5.1	27260701
eCl@ss 6.0	27260704
eCl@ss 7.0	27440402
eCl@ss 8.0	27440402

### ETIM

ETIM 3.0	EC001121
ETIM 4.0	EC002637
ETIM 5.0	EC002637

### UNSPSC

UNSPSC 6.01	30211810
UNSPSC 7.0901	39121409
UNSPSC 11	39121409
UNSPSC 12.01	39121409
UNSPSC 13.2	39121409

## Approvals

### Approvals

# Printed-circuit board connector - PCV 35 HC/ 2-GF-15,00 - 1762796

## Approvals

### Approvals

UL Recognized / cUL Recognized / CCA / IEC EE CB Scheme / VDE Gutachten mit Fertigungsüberwachung / EAC / cULus Recognized

### Ex Approvals

### Approvals submitted

### Approval details

UL Recognized 		
	B	C
Nominal current IN	115 A	115 A
Nominal voltage UN	600 V	600 V

cUL Recognized 		
	B	C
Nominal current IN	105 A	105 A
Nominal voltage UN	600 V	600 V

CCA
-----

IECEE CB Scheme 	
Nominal current IN	125 A
Nominal voltage UN	1000 V

VDE Gutachten mit Fertigungsüberwachung 	
Nominal current IN	125 A
Nominal voltage UN	1000 V

# Printed-circuit board connector - PCV 35 HC/ 2-GF-15,00 - 1762796

## Approvals

EAC

cULus Recognized

## Accessories

### Additional products

Printed-circuit board connector - PC 35 HC/ 2-STF-15,00 - 1762592



Plug component, Nominal current: 125 A, Rated voltage (III/2): 1000 V, Number of positions: 2, Pitch: 15 mm, Connection method: Screw connection, Color: green, Contact surface: Silver

Printed-circuit board connector - IPC 35 HC/ 2-GF-15,00 - 1784910



Header, Nominal current: 125 A, Rated voltage (III/2): 1000 V, Number of positions: 2, Pitch: 15 mm, Color: green, Contact surface: Silver, Mounting: Soldering

Printed-circuit board connector - IPCV 35 HC/ 2-GF-15,00 - 1793558



Header, Nominal current: 125 A, Rated voltage (III/2): 1000 V, Number of positions: 2, Pitch: 15 mm, Color: green, Contact surface: Silver, Mounting: Soldering

## Drawings

Drilling diagram

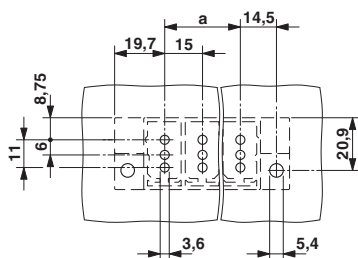

Dimensioned drawing

