

942D SERIES 32mm (37mm motor) PLANETRY (EPICYCLIC) METAL GEARBOX

GEARBOX DIMENSIONS

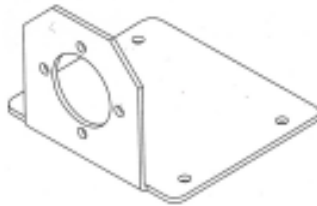
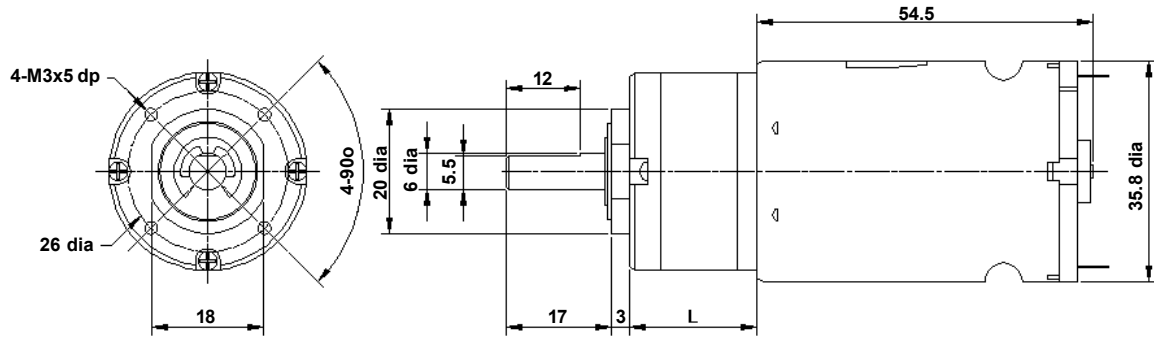

Pt. No. 727/1
Geared motor bracket (90 degree)

GEARBOX REF.	L
942D51 (5:1)	20.8
942D271 (27:1)	26.5
942D511 (51:1)	32.5
942D1001 (100:1)	33.6
942D1391 (139:1)	33.4
942D2641 (264:1)	40.0
942D5161 (516:1)	40.0
942D7211 (721:1)	40.0

FOR ACCESSORIES TO FIT THIS SERIES GEARBOX, REFER TO 919D SERIES PAGE.

ADVANTAGES OF PLANETARY GEARBOXES.

EFFICIENCY:	Efficiencies of planetary gearboxes can be above 90% while some other types of transmission can be 50% or less. This allows the use of smaller motors.
SIZE:	Planetary gearboxes can be half the size of conventional boxes.
WEIGHT:	Weight savings can be as high as 60%, allowing smaller, lighter support structures.
MAINTENANCE:	Other than routine oil changes, no maintenance is required, eliminating the need to hold spares.
REVERSIBLE:	Planetary gears can be equally efficient in either direction. This is an advantage for use in running machinery in both clockwise and anti-clockwise directions.
COAXIAL:	The coaxial configuration of input and output shafts allows planetary gears to be installed in line with a motor and a machine.

Subject to minimum order quantities of 100 units, the following ratios are also available with a six week lead-time. The physical dimensions of these other gearboxes may vary from the data as illustrated above. Details of individual gearboxes are available upon request.

GEARBOX 14:1 WITH 540/1 MOTOR	GEARBOX 19:1 WITH 540/1 MOTOR.
GEARBOX 27:1 WITH 540/1 MOTOR.	GEARBOX 35:1 WITH 540/1 MOTOR
GEARBOX 51:1 WITH 540/1 MOTOR	GEARBOX 71:1 WITH 540/1 MOTOR.
GEARBOX 139:1 WITH 540/1 MOTOR	GEARBOX 189:1 WITH 540/1 MOTOR
GEARBOX 264:1 WITH 540/1 MOTOR	GEARBOX 721:1 WITH 540/1 MOTOR
GEARBOX 939:1 WITH 540/1 MOTOR	