

Subminiature Fuse, 3.8 x 10 mm, Time-Lag T, 125 VAC, 125 VDC



125 VAC · 125 VDC · Time-Lag T



**Description**

- Low Breaking Capacity

**References**

[Packaging Details](#)

**Weblinks**

[General Product Information](#), [Approvals](#), [RoHS](#), [CHINA-RoHS](#), [e-Store](#), [SCHURTER-Stock-Check](#), [Distributor-Stock-Check](#)

**Technical Data**

Rated Voltage	65 - 125VAC, 65 - 125VDC
Rated Current	0.125 - 10A
Breaking Capacity	40A - 100A
Characteristic	Time-Lag T
Admissible Ambient Air Temp.	-40 °C to 85 °C
Climatic Category	40/085/56 acc. to IEC 60068-1
Material: Tube	Ceramic
Material: Axial Leads	Tin-Plated Copper
Unit Weight	0.6 g
Storage Conditions	0 °C to 60 °C, max. 70% r.h.
Product Marking	Current, Characteristic

Soldering Methods	Wave
Solderability	235 °C / 2 sec acc. to IEC 60068-2-20, Test Ta, method 1
Resistance to Soldering Heat	260 °C / 5 sec acc. to IEC 60068-2-20, Test Tb, method 1A

**Dimensions**

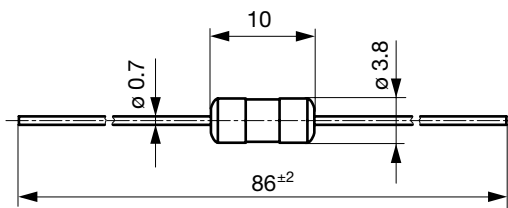
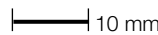

**Pre-Arcing Time**

Rated Current In	1.0 x In min	2.0 x In max	10.0 x In min.	10.0 x In max.	5.71 x In max.	8.57 x In min.	8.57 x In max.	10.0 x In max.	10.0 x In min.	10.0 x In max.
0.125 A - 10 A	4 h	1 s	120 s	200 ms	3 s	20 ms	100 ms			

### Variants

Rated Current [A]	Rated Voltage [VAC]	Rated Voltage [VDC]	Breaking Capacity	Voltage Drop 1.0 In typ. [mV]	Melting I <sup>2</sup> t 10.0 Intyp. [A <sup>2</sup> s]	Order Number
0.125	125	125	1)	1200	0.024	7010.1607.xx
0.16	125	125	1)	900	0.038	7010.1608.xx
0.2	125	125	1)	480	0.092	7010.1609.xx
0.25	125	125	1)	320	0.13	7010.1610.xx
0.315	125	125	1)	190	0.16	7010.1611.xx
0.4	125	125	1)	170	0.2	7010.1612.xx
0.5	125	125	1)	155	0.4	7010.1613.xx
0.63	125	125	1)	140	0.64	7010.1614.xx
0.8	125	125	1)	110	1.3	7010.1615.xx
1	125	125	1)	110	2.1	7010.1616.xx
1.25	125	125	1)	90	3.7	7010.1617.xx
1.6	125	125	1)	80	4.4	7010.1618.xx
2	125	125	1)	80	7.2	7010.1619.xx
2.5	125	125	1)	75	13.5	7010.1620.xx
3.15	125	125	1)	75	22	7010.1621.xx
4	125	125	1)	75	37	7010.1622.xx
5	125	125	1)	75	60	7010.1623.xx
6.3	125	125	1)	70	94	7010.1624.xx
8	65	65	2)	70	175	7010.1625.xx
10	65	65	2)	70	260	7010.1626.xx

- 1) 40 A @ 125 VDC  
50 A @ 125 VAC
- 2) 100 A @ 65 VAC/VDC

**Packaging Unit**    .xx = .12 Plastic Bag (50 pcs.)  
                               .xx = .46 Taped 19 cm Reel (1000 pcs.)

### Time-Current-Curves

