

## 1.0 ELECTRICAL

- 1.1 FREQUENCY RANGE: DC-3 GHz INTERNAL  
DC-8 GHz EXTERNAL
- 1.2 NOMINAL IMPEDANCE: 50 OHMS
- 1.3 WORKING VOLTAGE: 335 VOLTS MAX.
- 1.4 PROOF VOLTAGE: 1000 VOLTS
- 1.5 VSWR: 1.5MAX.

## 2.0 MATERIALS

- 2.1 BODIES: BRASS PER JIS-C3604
- 2.2 CENTER CONTACT: BERYLLIUM COPPER PER ASTM B196 UNS C17800  
BRASS PER JIS-C3604
- 2.3 INSULATION: TEFLON PER ASTM D1487 AND ASTM D1710

## 3.0 FINISHES AND OTHERS

- 3.1 SEE BELOW TABLE FOR DETAILS.

## 4.0 MECHANICAL

- 4.1 INTERFACE IN ACCORDANCE WITH: CROC 03220

## 5.0 ENVIRONMENTAL

- 5.1 OPERATING TEMPERATURE RANGE: -50° C TO +150° C

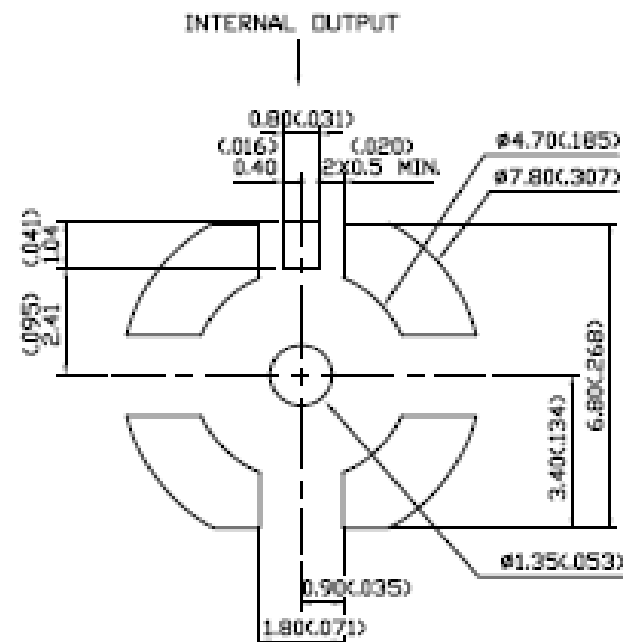

RECOMMENDED LAND PATTERN

APPROVED

by

DATE:

DESCRIPTION | MCX STRAIGHT SURFACE MOUNT JACK SWITCHING

製圖	DRAWN	TOLERANCE	品名	27-30	T.G.G	日期	DATE	版次	REV.
Yoko	Yoko	X ±0.2	TITLE	\RDHS COMPLIANT (500)		05.24.10'			A-0
檢圖	CHECK	XX ±0.1	單位	mm(in)	DWG.NO.	27-0101			
核定	APPROVAL	XXX ±0.05	比例	SCALE					
Lewis	Lewis	ANGLE ±5°	比例	8:1					



NO	DESCRIPTION	MATERIAL	Q'TY	FINISH
9	TAPE	SM 9480PC	1	NONE
8	INSULATION III	TEFLON	1	NONE
7	CENTER CONTACT III	BRASS	1	GOLD 3μ <sup>2</sup> MIN.
6	INSULATION II	LCP	1	BLACK
5	SPRING	STAINLESS STEEL	1	NONE
4	CENTER CONTACT II	BRASS	1	GOLD 10μ <sup>2</sup> MIN.
3	INSULATION I	TEFLON	1	NONE
2	CENTER CONTACT I	BERYLLIUM COPPER	1	GOLD 10μ <sup>2</sup> MIN.
1	BODY	BRASS	1	GOLD 3μ <sup>2</sup> MIN.
NO	DESCRIPTION	MATERIAL	Q'TY	FINISH