

Ordering number FP10997_LISA2-WW-PIN

Family	Lisa2	FWHM	(simulated) 60
Type	Assembly	Efficiency	(simulated) 0 %
LED	Double Dome (GM2BB)	cd/lm	-
Color	Black	Gerber File	Available
Diameter	9.9 mm		
Height	7 mm		
Style	Round		
Optic Material	PMMA		
Holder Material	PC		
Fastening	Pin, glue		
Status	Ready		

Ordering number FP11851_LISA2-O-90-PIN

Family	Lisa2	FWHM	(simulated) 48+20
Type	Assembly	Efficiency	(simulated) 0 %
LED	Double Dome (GM2BB)	cd/lm	-
Color	Black	Gerber File	Available
Diameter	9.9 mm		
Height	6.8 mm		
Style	Round		
Optic Material	PMMA		
Holder Material	PC		
Fastening	Pin, glue		
Status	Ready		

Ordering number FP11125_LISA2-O-PIN

Family	Lisa2	FWHM	10+32 degrees
Type	Assembly	Efficiency	(simulated) 0 %
LED	Double Dome (GM2BB)	cd/lm	-
Color	Black	Gerber File	Available
Diameter	9.9 mm		
Height	6.8 mm		
Style	Round		
Optic Material	PMMA		
Holder Material	PC		
Fastening	Pin, glue		
Status	Ready		

Ordering number FP11055_LISA2-RS-PIN

Family	Lisa2	FWHM	18 degrees
Type	Assembly	Efficiency	90 %
LED	Double Dome (GM2BB)	cd/lm	-
Color	Black	Gerber File	Available
Diameter	9.9 mm		
Height	6.8 mm		
Style	Round		
Optic Material	PMMA		
Holder Material	PC		
Fastening	Pin, glue		
Status	Ready		

**Ordering number FP10995_LISA2-M-PIN**

Family	Lisa2	FWHM	28 degrees
Type	Assembly	Efficiency	88 %
LED	Double Dome (GM2BB)	cd/lm	-
Color	Black	Gerber File	Available
Diameter	9.9 mm		
Height	6.8 mm		
Style	Round		
Optic Material	PMMA		
Holder Material	PC		
Fastening	Pin, glue		
Status	Ready		

Ordering number FP10996_LISA2-W-PIN

Family	Lisa2	FWHM	44 degrees
Type	Assembly	Efficiency	88 %
LED	Double Dome (GM2BB)	cd/lm	-
Color	Black	Gerber File	Available
Diameter	9.9 mm		
Height	6.8 mm		
Style	Round		
Optic Material	PMMA		
Holder Material	PC		
Fastening	Pin, glue		
Status	Ready		

NOTE: The typical divergence will be changed by different color, chip size and chip position tolerance. The typical total divergence is the full angle measured where the luminous intensity is half of the peak value.



PRODUCT DATASHEET

Lisa2 series

last update 3/5/2012

SHARP

GENERAL INFORMATION

- Product series especially designed & optimized for Double Dome (GM2BB) series of LEDs.
- Special care taken to make light distribution as uniform as possible.
- Lens material optical grade PMMA with high UV and temperature resistance. Allows use of high current and temperature conditions.

Please find more information about used material from below:

http://ledil.fi/sites/default/files/Documents/Technical/Material/PMMA%20N%20UL94_Yellow%20Card.pdf

<http://ledil.fi/sites/default/files/Documents/Technical/Material/PMMA%20N%20PLEXIGLAS-Datasheet.pdf>

- Optic holder molded by high quality PC material (120 degrees of Celcius / 248 degrees of Fahrenheit).

Relative intensity of FA10996_Lisa2-W-Pin-DD

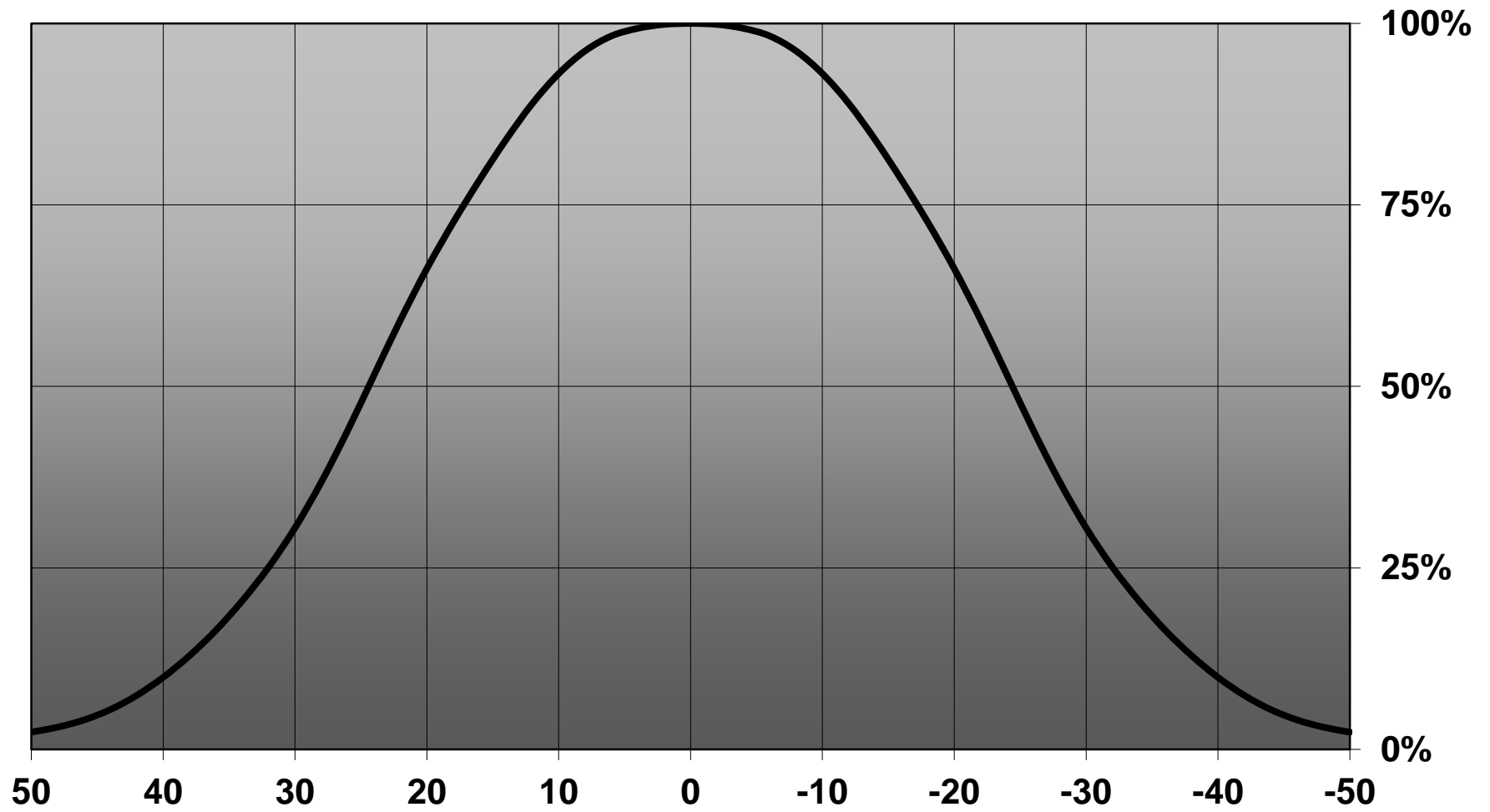

D

C

B

A

4

4

3

3

2

2

1

1

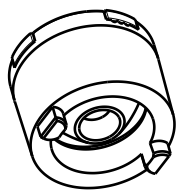
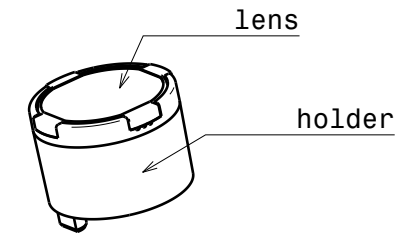

Isometric view
Scale: 2:1

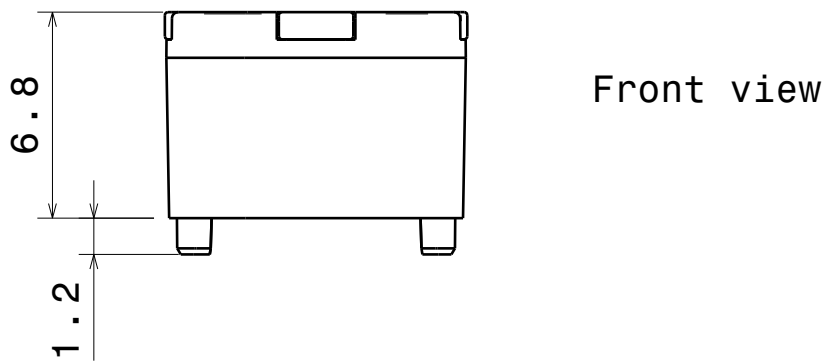
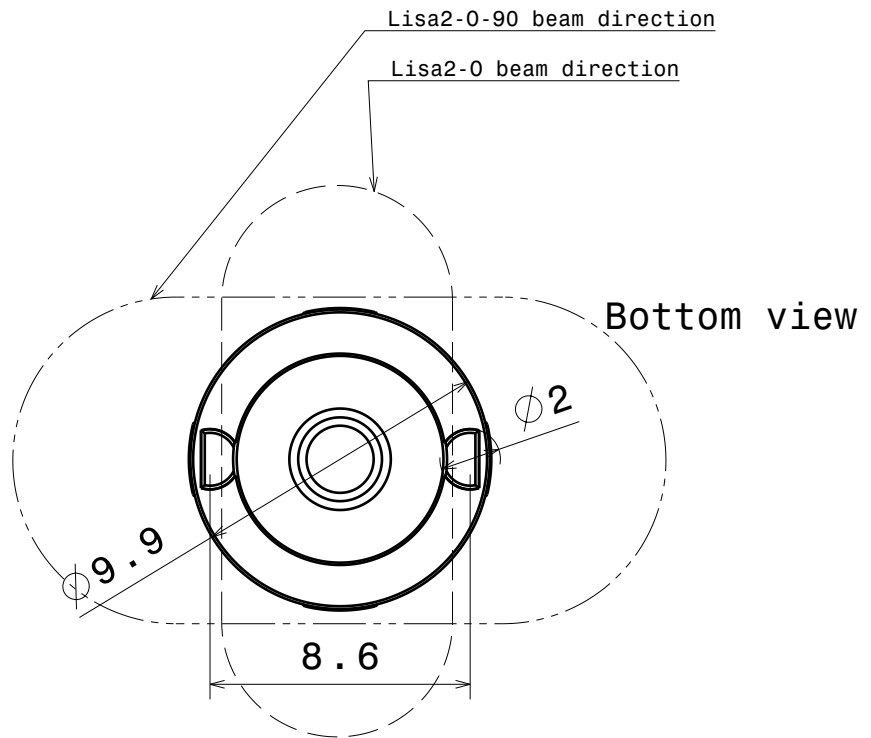

Materials:
Lens PMMA
Holder PC

Part no.s:
FA10995_Lisa2-M-Pin-XP
FA10996_Lisa2-W-Pin-XP
FA11055_Lisa2-RS-Pin-XP
FA11125_Lisa2-0-Pin-XP
FA11851_Lisa2-0-90-Pin-XP

This drawing is our property.
It can't be reproduced
or communicated without
our written agreement.



L
T
F
F

e
e
i
i
N
n

d
h

DRAWING TITLE

Datasheet Lisa2-Pin-XP Series Assy

DRAWN BY
p

DATE
02.11.2010

CHECKED BY
s n

DATE
02.11.2010

DESIGNED BY
hh

DATE
19.10.2009

SIZE A4

DRAWING NUMBER

REV 1

SCALE 4:1

WEIGHT (g)

SHEET 1/1

D

A