

# XALD164H29H7

dark grey station - 1 red mushroom head pushbutton  
Ø40 spring return 1NC "STOP"



## Main

|                             |   |
|-----------------------------|---|
| Range of product            | Harmony XALD  |
| Product or component type   | Complete control station                                  |
| Device short name           | XALD  |
| Product destination         | For XB5 Ø 22 mm control and signalling units              |
| Control station application | Stop function   |
| Colour of base of enclosure | Light grey RAL 7035                                       |
| Colour of cover             | Dark grey RAL 7016  |
| Material                    | Polycarbonate   |
| Operator profile            | 1 mushroom head push-button                               |
| Operators description       | Red "STOP" 1 NC   |
| Control station composition | 1 mushroom head Ø 40 mm push-button red 1 NC STOP marking |
| Marking location            | Marking on legend holder                                  |
| Contacts operation          | Slow-break  |

## Complementary

|  |  |
|--|--|
| Cable entry  | 1 knock-out for cable entry, clamping capacity: <= 14 mm<br>2 knock-outs for Pg 13 cable gland and ISO M20, clamping capacity: <= 12 mm  |
| Product weight   | 0.182 kg   |
| Resistance to high pressure washer                       | 7000000 Pa at 55 °C, distance: 0.1 m   |
| Positive opening   | With conforming to EN/IEC 60947-5-1 appendix K   |
| Operating travel   | 1.5 mm (NC changing electrical state)<br>4.3 mm (total travel)   |
| Operating force  | 3.5 N (NC changing electrical state)   |
| Mechanical durability                                    | 5000000 cycles   |
| Connections - terminals                                  | Screw clamp terminals : <= 2 x 1.5 mm <sup>2</sup> with cable end conforming to EN/IEC 60947-1<br>Screw clamp terminals : >= 1 x 0.22 mm <sup>2</sup> without cable end conforming to EN/IEC 60947-1   |
| Tightening torque  | 0.8...1.2 N.m conforming to EN/IEC 60947-1   |
| Shape of screw head                                      | Cross, Philips no 1<br>Cross, pozidriv No 1<br>Slotted, flat Ø 4 mm<br>Slotted, flat Ø 5.5 mm  |
| Contacts material  | Silver alloy (Ag/Ni)   |
| Short circuit protection                                 | 10 A by gG cartridge fuse conforming to EN/IEC 60947-5-1   |
| [I <sub>th</sub> ] conventional free air thermal current | 10 A conforming to EN/IEC 60947-5-1  |
| [U <sub>i</sub> ] rated insulation voltage               | 600 V (degree of pollution: 3) conforming to EN/IEC 60947-1  |
| [U <sub>imp</sub> ] rated impulse withstand voltage      | 6 kV conforming to EN/IEC 60947-1  |
| [I <sub>e</sub> ] rated operational current              | AC-15, A600: U <sub>e</sub> = 120 V I <sub>e</sub> = 6 A conforming to EN/IEC 60947-5-1<br>AC-15, A600: U <sub>e</sub> = 240 V I <sub>e</sub> = 3 A conforming to EN/IEC 60947-5-1<br>AC-15, A600: U <sub>e</sub> = 600 V I <sub>e</sub> = 1.2 A conforming to EN/IEC 60947-5-1<br>DC-13, Q600: U <sub>e</sub> = 125 V I <sub>e</sub> = 0.55 A conforming to EN/IEC 60947-5-1<br>DC-13, Q600: U <sub>e</sub> = 250 V I <sub>e</sub> = 0.27 A conforming to EN/IEC 60947-5-1<br>DC-13, Q600: U <sub>e</sub> = 600 V I <sub>e</sub> = 0.1 A conforming to EN/IEC 60947-5-1                                   |
| Electrical durability                                    | 1000000 cycles AC-15, 2 A at 230 V, operating rate: 3600 cyc/h, load factor: 0.5 conforming to EN/IEC 60947-5-1 appendix C<br>1000000 cycles AC-15, 3 A at 120 V, operating rate: 3600 cyc/h, load factor: 0.5 conforming to EN/IEC 60947-5-1 appendix C<br>1000000 cycles AC-15, 4 A at 24 V, operating rate: 3600 cyc/h, load factor: 0.5 conforming to EN/IEC 60947-5-1 appendix C<br>1000000 cycles DC-13, 0.2 A at 110 V, operating rate: 3600 cyc/h, load factor: 0.5 conforming to EN/IEC 60947-5-1 appendix C<br>1000000 cycles DC-13, 0.5 A at 24 V, operating rate: 3600 cyc/h, load factor: 0.5 |

The information provided in this documentation contains general descriptions and/or technical characteristics of the products contained herein. This information is not intended as a substitute for and is not to be used for determining suitability or reliability of these products for specific user applications. It is the duty of any such user or integrator to perform the appropriate and complete risk analysis, evaluation and testing of the products with respect to the relevant specific application or use thereof. Neither Schneider Electric Industries SAS nor any of its affiliates or subsidiaries shall be responsible or liable for misuse of the information contained herein.

## Environment

|                                       |   |
|---------------------------------------|---|
| protective treatment                  | TH  |
| ambient air temperature for storage   | -40...70 °C   |
| ambient air temperature for operation | -40...70 °C   |
| overvoltage category                  | Class II conforming to IEC 60536  |
| IP degree of protection               | IP66 conforming to IEC 60529<br>IP69K<br>IP69   |
| NEMA degree of protection             | NEMA 13<br>NEMA 4X  |
| IK degree of protection               | IK03 conforming to EN 50102   |
| standards                             | EN/IEC 60947-1<br>EN/IEC 60947-5-1<br>EN/IEC 60947-5-4<br>EN/IEC 60947-5-5<br>JIS C 4520<br>UL 508<br>CSA C22.2 No 14 |
| product certifications                | CSA<br>UL listed  |
| vibration resistance                  | 5 gn (12...500 Hz) conforming to IEC 60068-2-6  |
| shock resistance                      | 10 gn (duration = 11 ms) for half sine wave acceleration conforming to IEC 60068-2-27                                 |

## Contractual warranty

|                 |           |
|-----------------|-----------|
| Warranty period | 18 months |
|-----------------|-----------|

## Dimensions

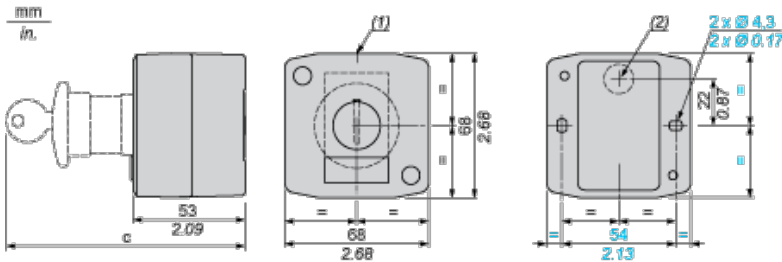

(1) 2 knock-outs for Pg 13.5 cable gland, maximum capacity 12 mm/0.47 in.

(2) Knock-out for cable entry, maximum capacity 14 mm/0.55 in.

| Control station fitted with:                              | c in mm | c in in. |
|---|---------|----------|
| Flush pushbutton  | 62      | 2.44     |
| Pilot light   | 64      | 2.52     |
| Illuminated pushbutton                                    | 65.5    | 2.58     |
| Projecting pushbutton                                     | 66      | 2.60     |
| Selector switch   | 80      | 3.15     |
| Mushroom head pushbutton                                  | 91.5    | 3.58     |
| Latching mushroom head Emergency stop pushbutton with key | 115     | 4.53     |
| Key switch  | 105.5   | 4.15     |