

C-152647

1st ANGLE (AMERICAN) PROJECTION

DIMENSIONS IN INCHES DO NOT SCALE PRINT
DIMENSIONS THUS [] IN MM.

INSULATION COLOUR BROWN.

.031 TONGUE THICKNESS.
[0.79]

.281 DIA.
[7.14]

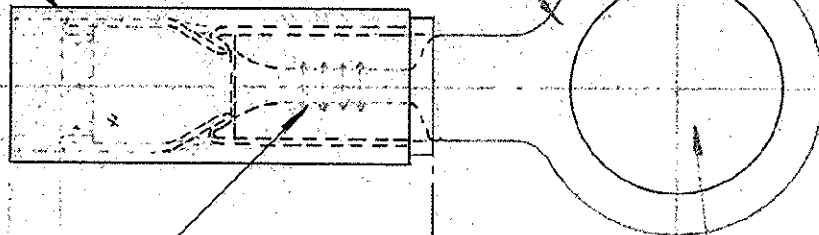

FOR INSULATION DIA.

.035 - .075
[0.89 - 1.90]

SERRATIONS

.031 MIN.
[0.79]

.242 MIN.
[6.15]

.640 MAX.
[16.26]

.787 MAX.
[19.99]

.1975 ± .003 DIA.
[5.008]

FOR #10 STUD.

**ENGINEERING
OFFICE
MASTER**

© AIRCRAFT-MARINE PRODUCTS
(GREAT BRITAIN) LTD 19

CUSTOMER COPY
REFERENCE ONLY

E	242 DIM. REPOSITIONED	DR		19/12/77
D	.787, .242 & .035/.075 WAS .795, .250, .035/.085	DR		29/7/77
C	PICTORIAL CHANGE ONLY	AWVC		5-4-75
B	CHANGED PICTORIALY	PCA		5-4-72
A	.035/.085 WAS .040/.100	DR		22/1/71
LTR	REVISION RECORD	DR	CHK	DATE
DR	Wells 27/10/69	DE		
CHK	Pat 27.1.69	APP		Walmsley 25/7/70

MATERIAL AND FINISH	AMP Industrial		A DIVISION OF AIRCRAFT-MARINE PRODUCTS (GREAT BRITAIN) LTD. STANMORE, MIDD.	
COPPER - ANNEALED, NICKEL PLATED	CLASS	STRATOTHERM P.L.D.G.		
WIRE RANGE - INSULATION	TYPE	RING TONGUE		
24-22				
TOLERANCE EXCEPT AS NOTED ± 0.15 [0.38] ± 1°	SCALE	LOC	NO	REV
	6:1	E	A	C-152647
NAME	WIRE TERMINAL ASSY.			