

DRAWING FOR REFERENCE: This is subject to change without notice
05/31/2014

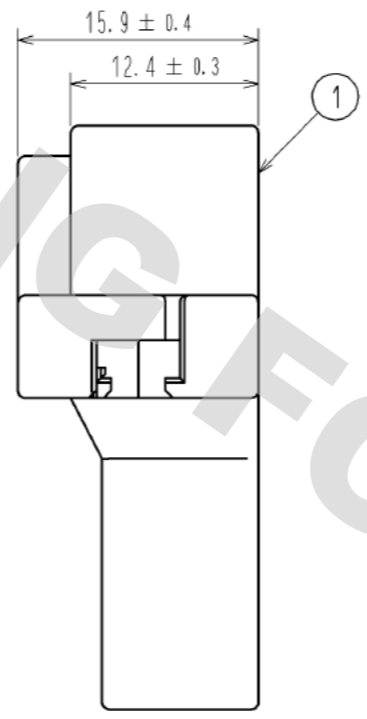

RECOMMENDED PANEL CUT OUT DIMENSION

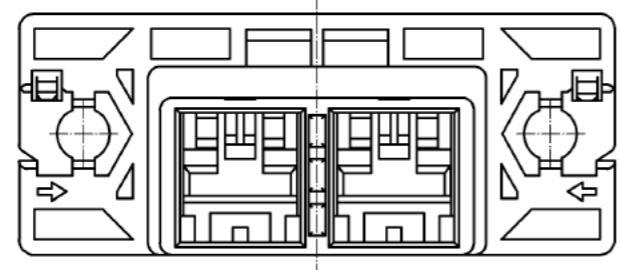
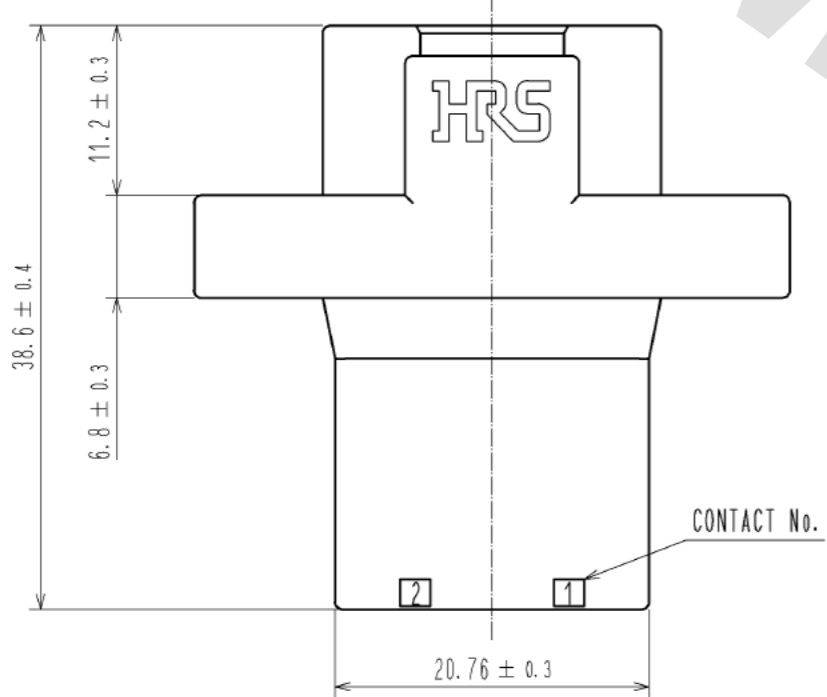
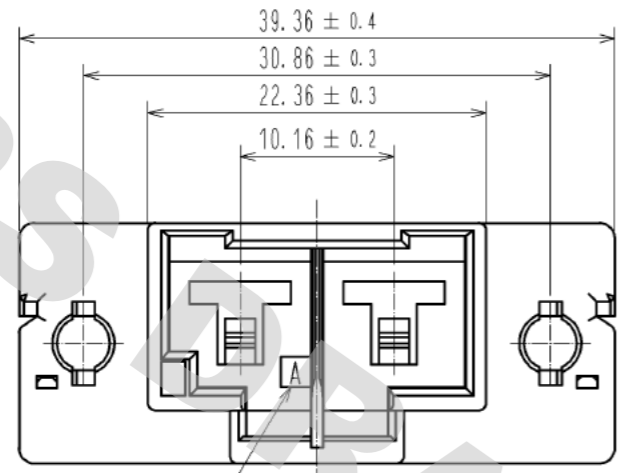
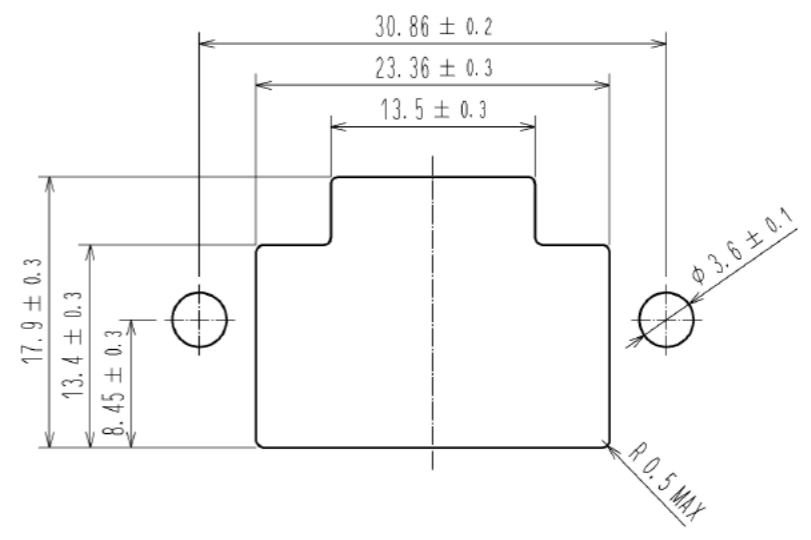

MATING FIGURE

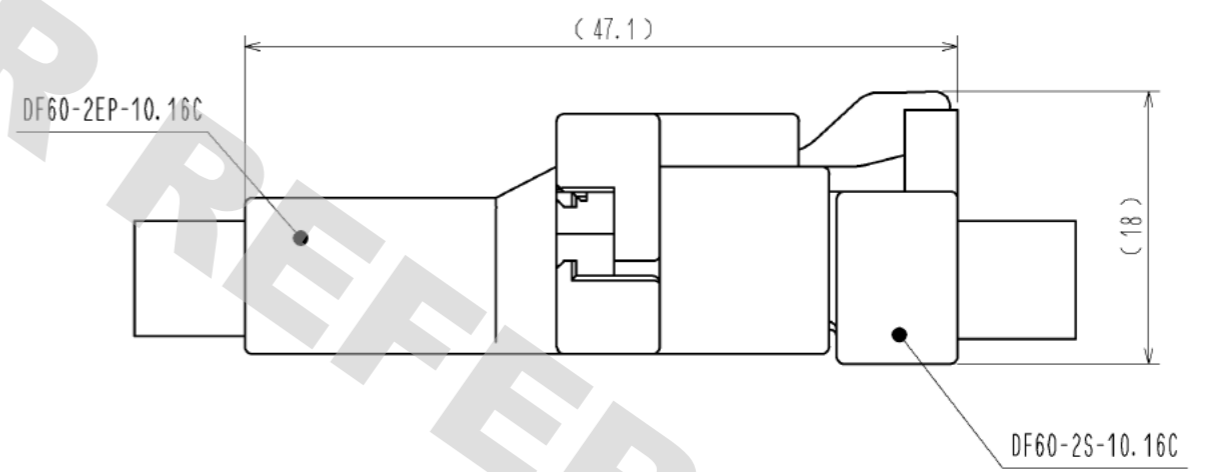

NOTE 1. PER PACK : 100 PIECES.

NO.	MATERIAL	FINISH . REMARKS	NO.	MATERIAL	FINISH . REMARKS
1	PBT	BLACK . UL94V-0			
UNITS	mm	SCALE	2 : 1	COUNT	△
APPROVED : KI. AKIYAMA			13.12.03	DRAWING NO. EDC3-344821-01	
CHECKED : HK. UMEHARA			13.12.03	PART NO. DF60-2EP-10.16C	
DESIGNED : TS. KUMAZAWA			13.12.03	CODE NO. CL680-3025-5-00	
DRAWN : TS. KUMAZAWA			13.12.03	△ 1/2	

DF60 IN-LINE TYPE RECOMMENDED PANEL MOUNTING MANUAL (WHEN NUTS USES)

NUT INSTALLATION PROCESS

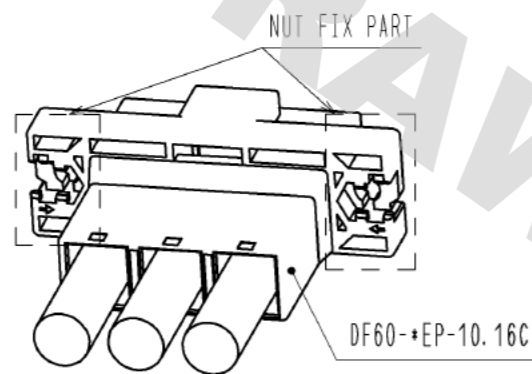

1. SLIDE A NUT (SIZE:M3) TO NUT FIX PART.

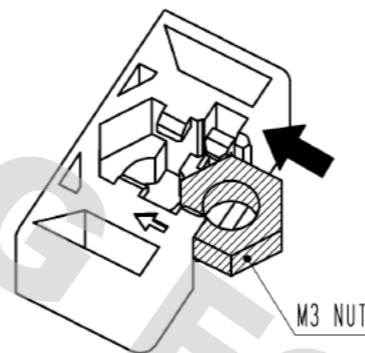

2. PRESS DOWN THE NUT UNTIL IT CLICKS, THEN THIS SOUND MEANS THE NUT HAS INSERTED INTO NUT HOLDER.

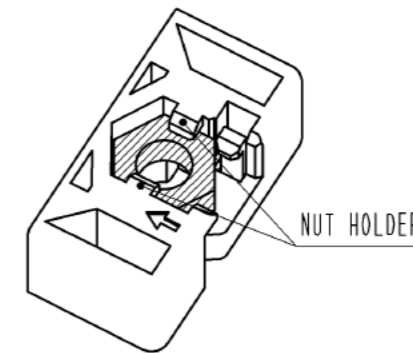

PANEL MOUNTING PROCESS

1. INSERT CONNECTOR INTO PANEL CUT OUT PART.

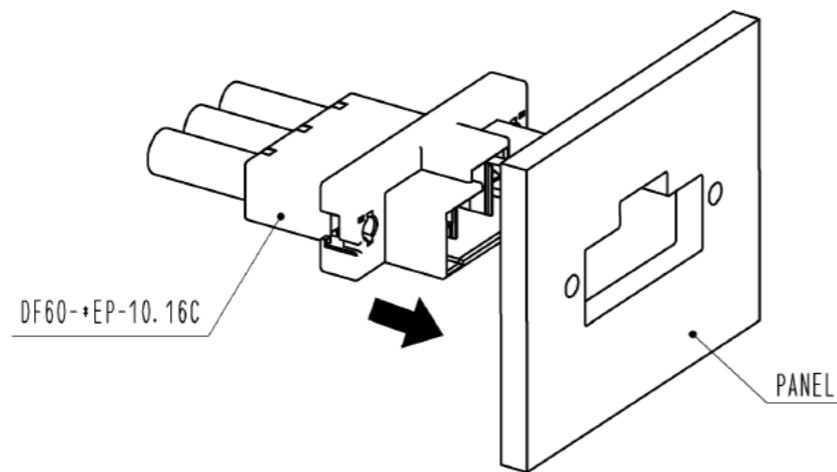

2. TIGHTEN A SCREW (SIZE:M3) TO FIX WITH PANEL. RECOMMENDED TORQUE : LESS THAN 49N · cm

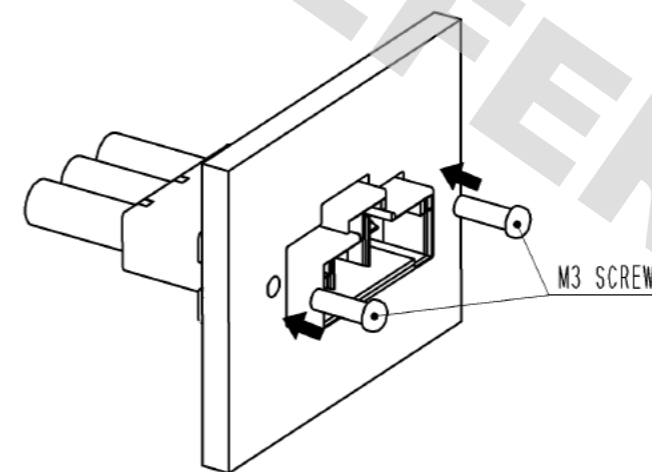

HRS	DRAWING NO.	EDC3-344821-01
	PART NO.	DF60-2EP-10.16C
	CODE NO.	CL680-3025-5-00
		△ 2/2

DRAWING FOR REFERENCE: This is subject to change without notice
05/31/2014