

EAN CODE : 3760244880253

12V REMOTE-SENSING ALE1205

- PRECISE** : Switching power supply offering a ripple <math><3\text{mV rms}</math>.
- Output voltage adjustable from 10 to 15V
- SMALL** : Modular,
- EASY** : Direct DIN rail or panel mounting.
- PROTECTED** : against short circuits and reverse polarity.
- RESISTANT TO SHOCK**



60 WATTS

12V (Adj. 10 to 15V)

5A

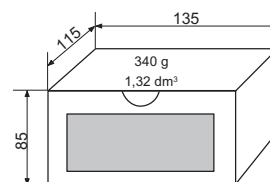
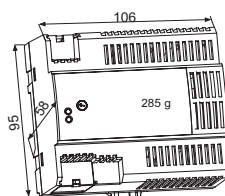

Specifications

Voltage

- Floating outputs on spring terminal block with levers for 2,5mm² (AWG 12) wires.
- Output voltage : adjustable from 10 to 15V.
- Regul : <math><20\text{mV}</math> for a load variation from 0 to 100%
<math><2\text{mV}</math> for a line variation from 190 to 264V.
- Ripple : <math><3\text{mV rms}</math> including:
<math><2\text{mV}</math> peak to peak of the signal at 100 KHz
<math><4\text{mV}</math> peak to peak of the signal at 100 Hz
<math><10\text{mV}</math> peak to peak of switching spikes
- Hold-up time : 25 ms at half load and 12 ms at full load (190V line input).
- Indicator : green power-on LED indicator.
Overheat or overcurrent red LED "status" indicator

Current

- Max I : 5,5A in short circuit condition.
5A from 10 to 12V
4A to 15V

Power

- Max output power : 60W.

Protection

- Short circuit protection, by current limit.
- Against overcurrent on primary circuit by fuse.
- Against overtemperature, by thermal shutdown.
- Cover on input output terminal block.

Remote sensing

- Correction of the voltage drop in the wires (4 wires method)
- Input on spring terminal block with levers for 2,5mm² wires (AWG12)
- Correction : Max 3V (1,5V per wire)
- Ripple : <math><30\text{mV}</math> for a load variation from. 0 to max.

Other specifications

- Safety : Class II, Safety Extra Low Voltage (SELV), complies with EN 60950.
- EMC : Complies with EN 61000-6-2 and EN 61000-6-4.
- Protection level : IP 30.
- Operating temperature : from -25 to +60°C ; derating : 1W/°C from +40°C
- Input voltage : 190 to 264 Volts, 50 / 60 Hz.
- Mains input : spring terminal block with levers for 2,5 mm² (AWG 12) wires.
- Power consumption : 74W max.
- Dielectric strength : 3000V from input to output.
- Presentation : modular polycarbonate case (6 x 17,5mm screenprinted).
- Mounting : Clips package integrated in modular case for DIN rails profile 35x7,5mm or 35x15mm.
Removable wall mouting integrated to the case for 4mm screws.