

Bell Mounts - Type CFBMS



Applications

- Gensets
- Engines
- Toolroom Machinery
- Pumps
- Special Equipment
- HVAC
- Pumps

The CFBMS range of mounts offer a high level of insulation - especially useful on Generators, Engines etc. with an operating frequency of around 25 Hz (1500 RPM).

Axial stresses are perfectly absorbed and side deflections are limited to guarantee good stability.

These Bell Mounts are designed with a fail-safe function making it an ideal solution for applications where safety is paramount.

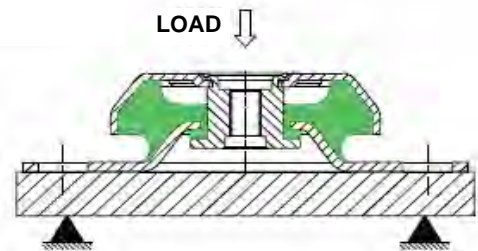
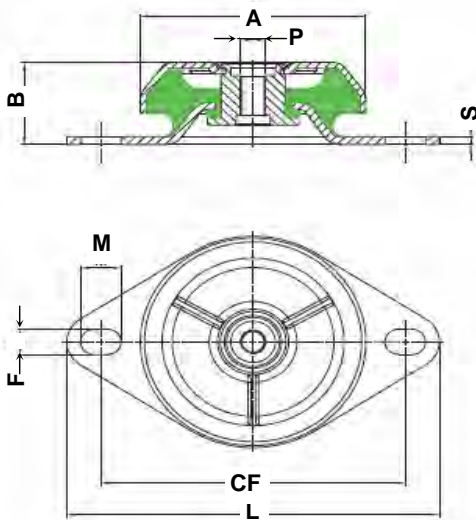

| RS Ref: | Fibet Ref: | Hardness (IRHD) | A | B | P | FxM | CF | L | S | Average Stiffness (daN/mm) | Maximum Load (daN) | Maximum Deflection (mm) |
|----------|---------------|-----------------|-----|----|-----|---------|-----|-----|---|----------------------------|--------------------|-------------------------|
| 720-3489 | CFBMS633510W | 40 | 63 | 35 | M10 | 9x12 | 88 | 110 | 2 | 7.0 | 30.0 | 4.3 |
| 720-3483 | CFBMS633510M | 60 | 63 | 35 | M10 | 9x12 | 88 | 110 | 2 | 15.8 | 60.0 | 3.8 |
| 720-3492 | CFBMS833512W | 40 | 83 | 35 | M12 | 11.5x15 | 110 | 135 | 3 | 17.8 | 80.0 | 4.5 |
| 720-3495 | CFBMS833512M | 60 | 83 | 35 | M12 | 11.5x15 | 110 | 135 | 3 | 44.5 | 180.0 | 4.0 |
| 720-3499 | CFBMS1064216W | 40 | 106 | 42 | M16 | 13x19 | 143 | 175 | 4 | 33.5 | 167.0 | 5.0 |
| 720-3509 | CFBMS1064216M | 60 | 106 | 42 | M16 | 13x19 | 143 | 175 | 4 | 67.0 | 335.0 | 5.0 |
| 720-3502 | CFBMS1505416W | 40 | 150 | 54 | M16 | 14x18 | 182 | 218 | 4 | 37.5 | 450.0 | 12.0 |
| 720-3506 | CFBMS1505416M | 60 | 150 | 54 | M16 | 14x18 | 182 | 218 | 4 | 78.7 | 800.0 | 10.2 |