

Datasheet

RS Pro Self-Lock Collet Chuck: MT-2 Taper Shank

RS Stock No: 523-0616



Specifications:

Autolock S-Milling Cutter Chuck

Supplied in a metal storage box, complete with collets

Metric chucks are supplied with 6, 10, 12, 16mm collets, enabling them to hold any cutter from 1.5 to 20mm diameters

Self-centring & automatic locking, this ensures the cutter is unable to slip, pull out, or push back

The heavier the cut applied to the material, the tighter the grip produced on the milling cutter.

Order Code	Manufacturers Code	Description
523-0616	91-020-020	Self-Lock Collet Chuck



ENGLISH

Datasheet RS Pro Self-Lock Collet Chuck: MT-2 Taper Shank

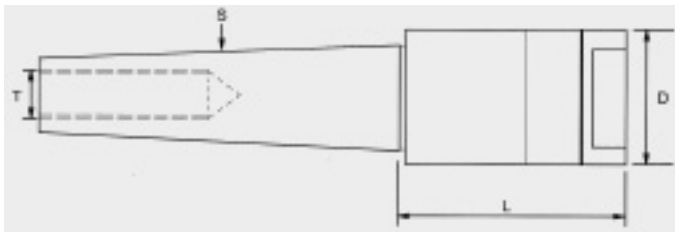

Type	Shank	Collets	Cutter Range
Metric	MT-2	6, 10, 12 & 16mm	1.5 – 20mm

Drawbar Thread T	D (mm)	L (mm)
M10	44	58

Instructions:

Select a Chuck to suit the machine spindle taper style

Select a collet to suit the shank diameter of the cutter

Insert the Chuck into the machine spindle and secure by using the drawbar fitted to the machine

Unscrew the Nose End of the chuck and insert the Collet, locating the flat into the slot in the Nose End.

Screw the Nose End and Collet onto the Chuck body finger tight.

Insert the Cutter into the Collet and screw in until it stops against the stop centre situated inside the chuck body.

Tighten the Nose End using the spanner provided.

The cutter is now ready to use