

Characteristics of single-pole splitter blocks AK2 and AB3

Rated insulation voltage (Ui)	a 750 V conforming to NF C 20-040 a 600 V conforming to CSA
Vibration resistance	10...55 Hz, amplitude 1 mm, conforming to NF C 63-065
Flame resistance	VO conforming to UL 94
Enclosure material and colour	Polyamide 6.6, grey RAL 7032
Mounting	AB3-RV162U : clip-on mounting on 1, 5, 4 mounting rails and on Telequick pre-slotted mounting plates
Upstream connection	
AK2-BA162U	On 5 or 6 mm thick copper bar by means of screw clamp connector Tightening torque : 10 N.m
AB3-RV162U	For flexible copper cable with cable end, from 4 to 25 mm ² For solid cable from 6 to 35 mm ²
Downstream connection	6 screw connectors, size 4 conforming to NF C 63-062 Connector capacity (conforming to § 8.2.4.3 IEC Recommendation 947.1) : - Solid conductor : 1 to 6 mm ² - Flexible conductor with cable end : 0.34 to 1 mm ² (1 or 2 wires) – 1.5 to 2.5 mm ² (1 wire) Rated current : I _e = 25 A x 6 Screw heads protected by removable markable cover.
Marking	By 6 AB1-R or AB1-G clip-in markers upstream and/or 4 AB1-R or AB1-G clip-in markers for each tap-off outlet.

Assembly recommendations

Screw clamp connector AK2-BA01 On copper bar only.
Connection of copper cables fitted with cable ends.

Connector plates AK2-SP Chamfered face in contact with the clamp of the screw clamp connector.

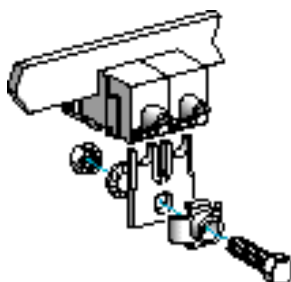

Terminal clamp AK2-SE
with screws, washers and nuts

Terminal clamp AK2-SE For two cables of similar c.s.a.



c.s.a. mm ²		Type of clamp required
min.	max.	
6	16	AK2-SE20
16	35	AK2-SE25
16	50	AK2-SE30
25	95	AK2-SE40

Cable c.s.a. adaptor AK2-SC01 for use under terminal clamp For two cables of substantially different c.s.a.



c.s.a. mm ² with adaptor	
min.	max.
1...4	6...16
1...6	16...35
1...10	16...50
1...16	25...95

Insulated busbar supports

Application	Busbar dimensions mm	Kit reference	Weight kg
For 3 or 4-pole busbar systems	12 x 5 or 20 x 5	AK2-SB31	0.250
	30 x 5 or 40 x 5	AK2-SB32	0.265
	50 x 5 or 60 x 5	AK2-SB33	0.270

The pre-assembled kit comprises 2 insulated supports, 3 insulated tubes, 2 Allen head screws, 2 H6 nuts. Suitable for mounting on AM1-P pre-slotted plates or 1, 7 or 4 mounting rails using M6 screws.

Copper bars (for use with insulated supports)

Dimensions	mm	12 x 5	20 x 5	30 x 5	40 x 5	50 x 5	60 x 5
Current carrying capacity conforming to DIN 43671	A	200	270	380	480	580	690

Associated screw clamp connector

Application	Sold in lots of	Unit reference	Weight kg
For clamping onto 5 mm thick copper bar, without drilling and with maximum capacity of 2 x 10 mm ² cables with cable ends. Markable with 5 AB1-R or AB1-G clip-in markers.	12	AK2-BA01	0.050

Connector plates

Width mm	Maximum tap-off current A	Fixing	Sold in lots of	Unit reference	Weight kg
20	200	on 1 screw clamp connector	10	AK2-SP20	0.020
30	600	on 2 associated screw clamp connectors	10	AK2-SP30	0.050
40	700	on 2 associated screw clamp connectors	10	AK2-SP40	0.090

Terminal clamps

Application	Fixing	Sold in lots of	Unit reference	Weight kg
For 2 cables from 6 to 16 mm ²	on 20 mm connector plate using M8 screws (not supplied)	20	AK2-SE20	0.005
For 2 cables from 16 to 35 mm ²	on 30 mm connector plate using M10 screws (not supplied)	20	AK2-SE25	0.010
For 2 cables from 16 to 50 mm ²	on 30 mm connector plate using M10 screws (not supplied)	20	AK2-SE30	0.010
For 2 cables from 25 to 95 mm ²	on 40 mm connector plate using M12 screws (not supplied)	20	AK2-SE40	0.020

Single-pole splitter blocks

Cabling Upstream	Downstream	Sold in lots of	Unit reference	Weight kg
6 flexible cables up to 2.5 mm ² with cable ends	Clamping onto 5 or 6 mm thick copper bar, without drilling	10	AK2-BA162U	0.095
	4 to 25 mm ² flexible cable or 6 to 35 mm ² solid cable	10	AB3-RV162U	0.095



AB3-RV162U

Busbar system supports + protective covers
AK2-SB3p + AK2-CBppp + AK2-CPppp



AK2-	bar size	b	H
SB31	12 x 5	98	57 ± 3
	20 x 5	106	65 ± 3
SB32	30 x 5	116	75 ± 3
	40 x 5	126	85 ± 3
SB33	50 x 5	136	95 ± 3
	60 x 5	146	105 ± 3

- (1) Protective cover AK2-CB.
- (2) Protective cover AK2-CP mounted on AK2-CB.

Connector plates
AK2-SP20



Thickness : 3 mm

AK2-SP30

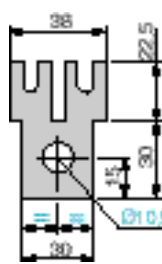

Thickness : 4 mm

AK2-SP40

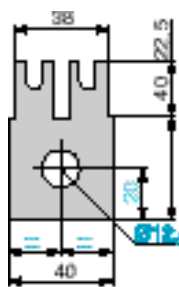

Thickness : 5 mm

Associated screw clamp connector
AK2-BA01

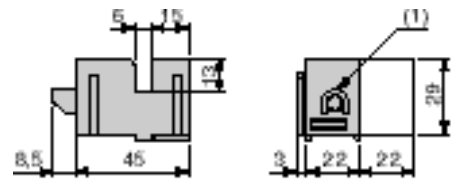

- (1) CHc M6 screw.

Terminal clamps
AK2-SEpp

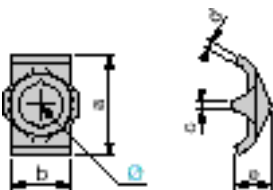

AK2-	a	b	c	d	e	Ø
SE20	20	13	5	2.5	8	8.8
SE25	25	15	6.5	3	9.5	10.8
SE30	30	15	6.5	3	11	10.8
SE40	40	19	9	3	12	12.8

Single-pole splitter blocks
AK2-BA162U, AB3-RV162U

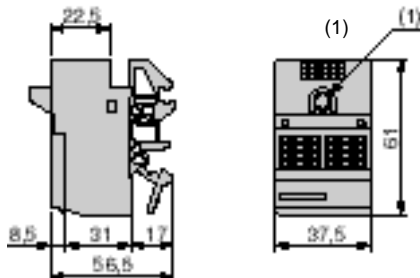

- (1) CHc M6 screw.

Mounting

