



Datasheet

Stock No: 267-4439

ENGLISH

## RS Pro Red Insulated Crimp Tab

Terminal, 4.75 x 0.8mm, 22 → 16 AWG



### Product Details:

#### RS Nylon Insulated Crimp Male Crimp Tab Terminals

Nylon insulated brass male double crimp tab terminals with a copper sleeved double crimp barrel. These insulated male tab connectors are colour coded for use with different wire ranges and are available with various tab sizes. For suitable crimp tool see stock number 267-3133.

- Red 0.5 - 1.5 mm<sup>2</sup>
- Blue 1 - 2.6 mm<sup>2</sup>
- Yellow 2.5 - 6.5 mm<sup>2</sup>

# Specifications:

Gender: Male  
 Wire Size: 12 → 10 AWG  
 Hooked: Yes  
 Insulation: Insulated  
 Shrouded: Unshrouded  
 Insulation Material: Nylon  
 Colour: Yellow  
 Overall Length: 30.2mm  
 Inner Diameter: 7mm  
 Blade Length: 17.2mm  
 Blade Width: 4.6mm  
 Blade Thickness: 1mm  
 Contact Material: Copper  
 Contact Plating: Tin

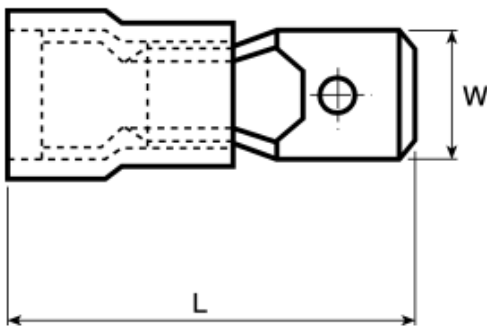
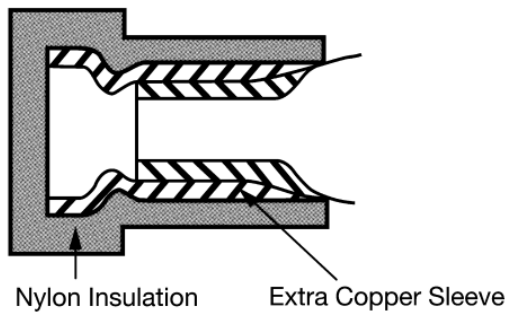

Type	Red		Blue		Yellow	
	W	L	W	L	W	L
Size A	6.4	21.7	6.4	21.7	6.4	24.0
Size B	4.8	19.7	4.8	19.7		
Size C	4.8	19.7	4.8	19.7		