

## DETAILS

<b>Product Number</b>	F14344_FLORENCE-1R-ZT25
<b>Family</b>	Florence
<b>Type</b>	Lens
<b>Color</b>	clear
<b>Diameter</b>	19,5 x 286 mm
<b>Height</b>	7,13 mm
<b>Style</b>	rectang
<b>Optic Material</b>	PMMA
<b>Holder Material</b>	
<b>Fastening</b>	glue
<b>Status</b>	ready
<b>ROHS Compliant</b>	Yes
<b>Date Updated</b>	5/05/2015

## OPTICAL PROPERTIES

LED	Viewing Angle	Light Beam	Efficiency	cd/lm	Connector
Fortimo LED Line 1ft 1100lm 8x0 1R xV2	Asym deg	Asymmetric	94 %	1.000	-
Duris S5 (2 chip)	Asymmetric deg	Asymmetric	93 %	0.920	-
NF2x757D	Asymmetric deg	Asymmetric	93 %	0.910	-
LM302A	Asym deg	Asymmetric	94 %	1.000	-
SEOUL 3030	Asym deg	Asymmetric	93 %	1.000	-
MP-2016	Asymmetric deg	Asymmetric	94 %	1.300	-
Luxeon 3030 2D	Asymmetric deg	Asymmetric	93 %	1.000	-



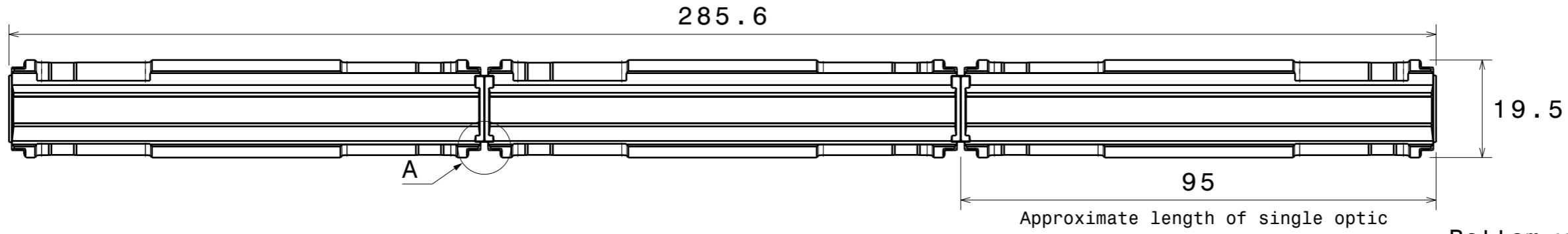

Bottom view

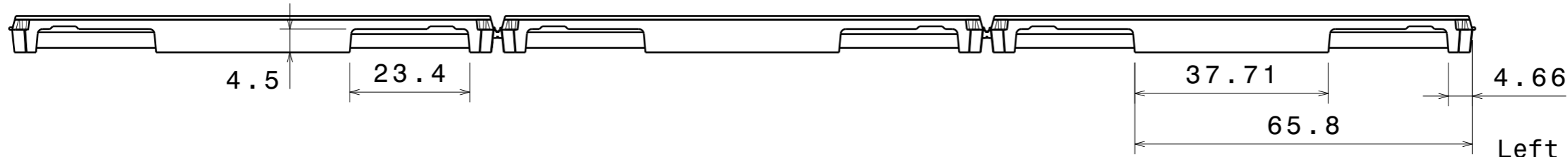

Left view

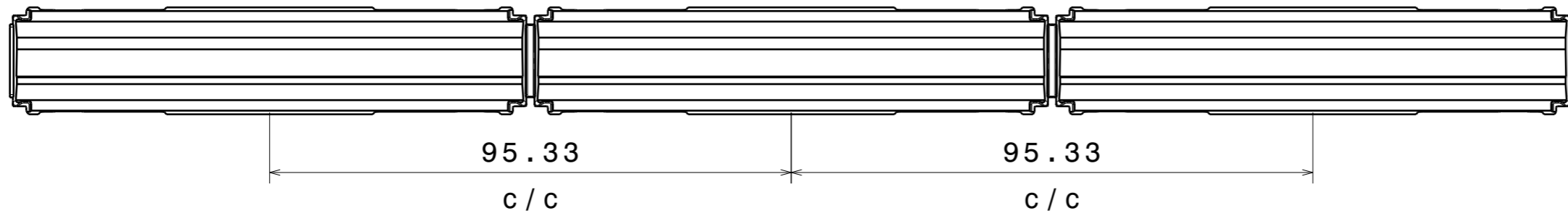

Top view

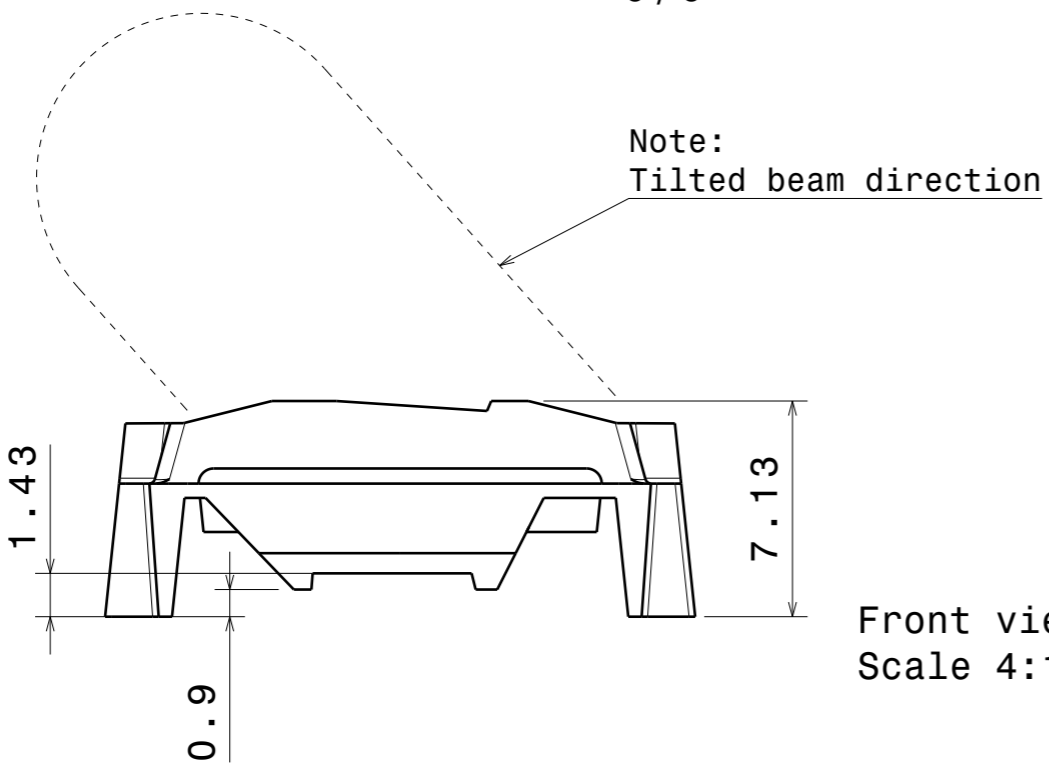

Front view  
Scale 4:1

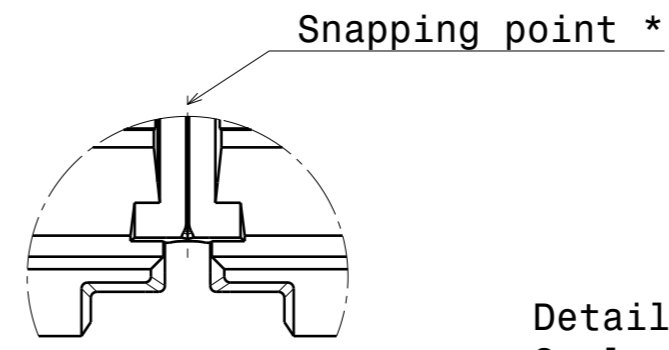

Detail A  
Scale 4:1

\* Optics can be snapped along this line and used also as single parts.

INDEX	PART NO	DESCRIPTION	MATERIAL	COLOUR
1	F14344	FLORENCE-1R-ZT25	PMMA	

Tolerances if not otherwise shown  
According to DIN ISO 2768-1  
Linear measures:  
Up to 30mm class M, otherwise class C.  
According to DIN ISO 2768-2  
Form and position: class L

**LEDiL** LediL Oy  
Salorankatu 10  
FIN 24240 SALO  
Finland

THIRD ANGLE PROJECTION:

DRAWING TITLE  
**F14344\_FLORENCE-1R-ZT25**

This drawing is the property of LEDiL Oy. It may not be reproduced, copied or communicated without a written agreement with LEDiL Oy.

SIZE PART NUMBER  
**A3 F14344**

SCALE 1:1 SHEET 1/1

H G F E D C B A

4

4

3

3

2

2

1

1

H G B A



# Ledil F14344\_FLORENCE-1R-ZT25\_(Duris\_S5) / LDC (Linear)

Luminaire: Ledil F14344\_FLORENCE-1R-ZT25\_(Duris\_S5)  
Lamps: 1 x Osram\_Duris\_S5\_x11\_(GW\_PSLRS1.EC-LQLS-5H7I-1)  
\_1016.86lm@100mA\_P=8W\_I=0.1000A

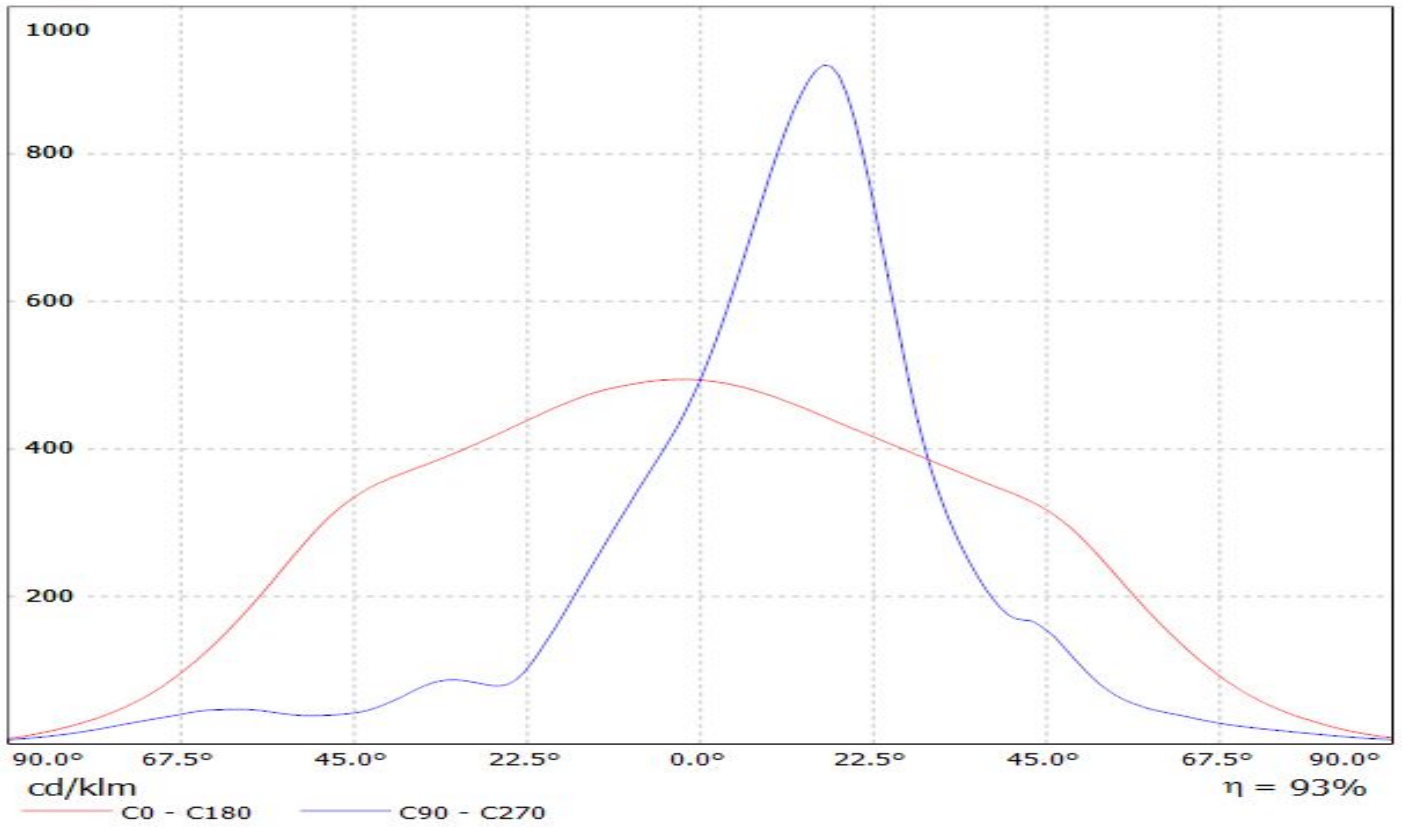

# Ledil F14344\_FLORENCE-1R-ZT25\_(NF2x757D) / LDC (Linear)

Luminaire: Ledil F14344\_FLORENCE-1R-ZT25\_(NF2x757D)

Lamps: 1 x Nichia\_NF2x757D\_2chip\_x22 (NF2W757DRT)\_2050.61lm@200mA\_P=12.95W\_I=0.2A

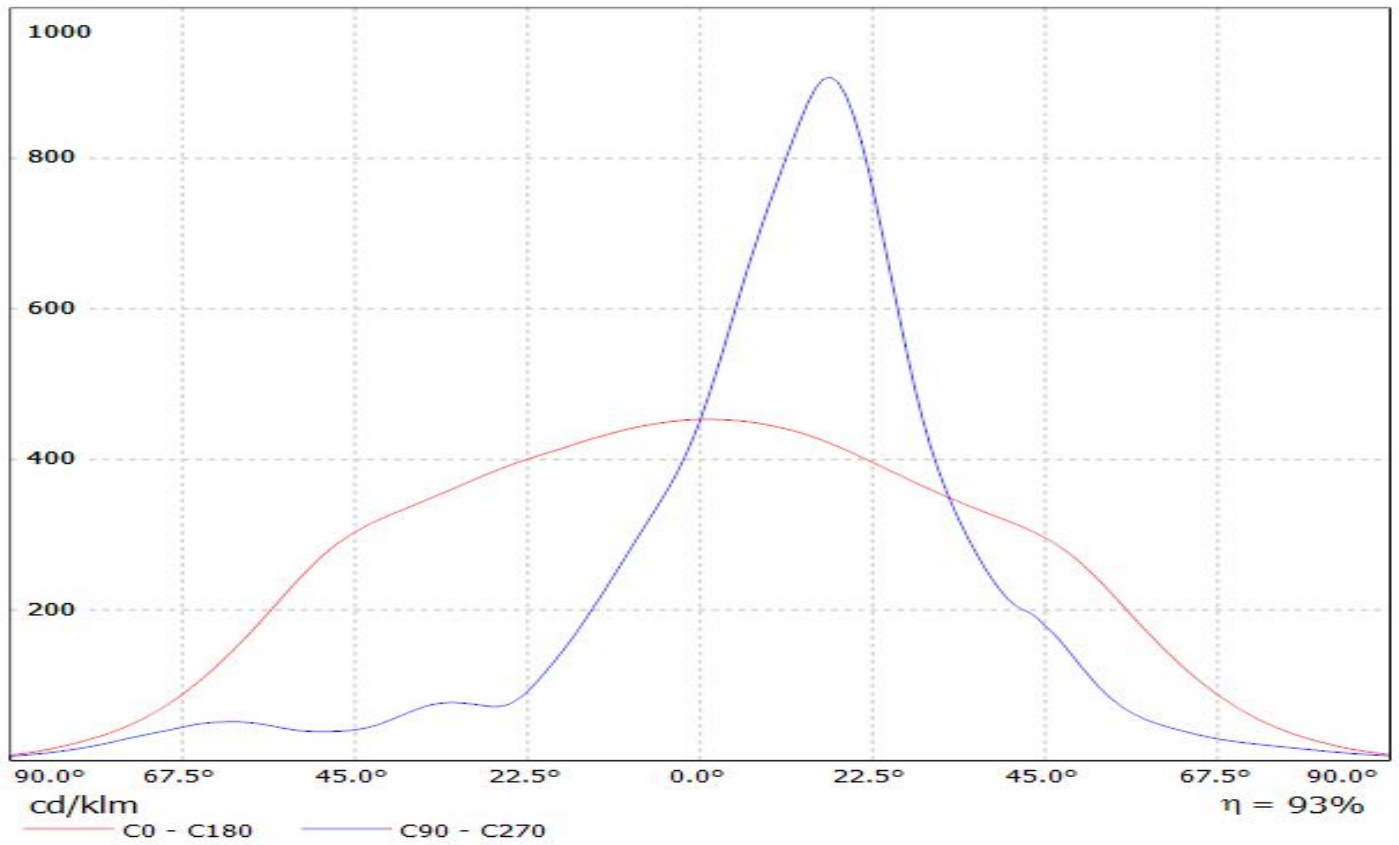

Luminaire: LEDiL Oy F14344\_FLORENCE-1R-ZT25\_(LM302A)  
Lamps: 1 x Samsung\_LM302A\_865.46lm@100mA\_P=6.64694W\_I=0.1001A

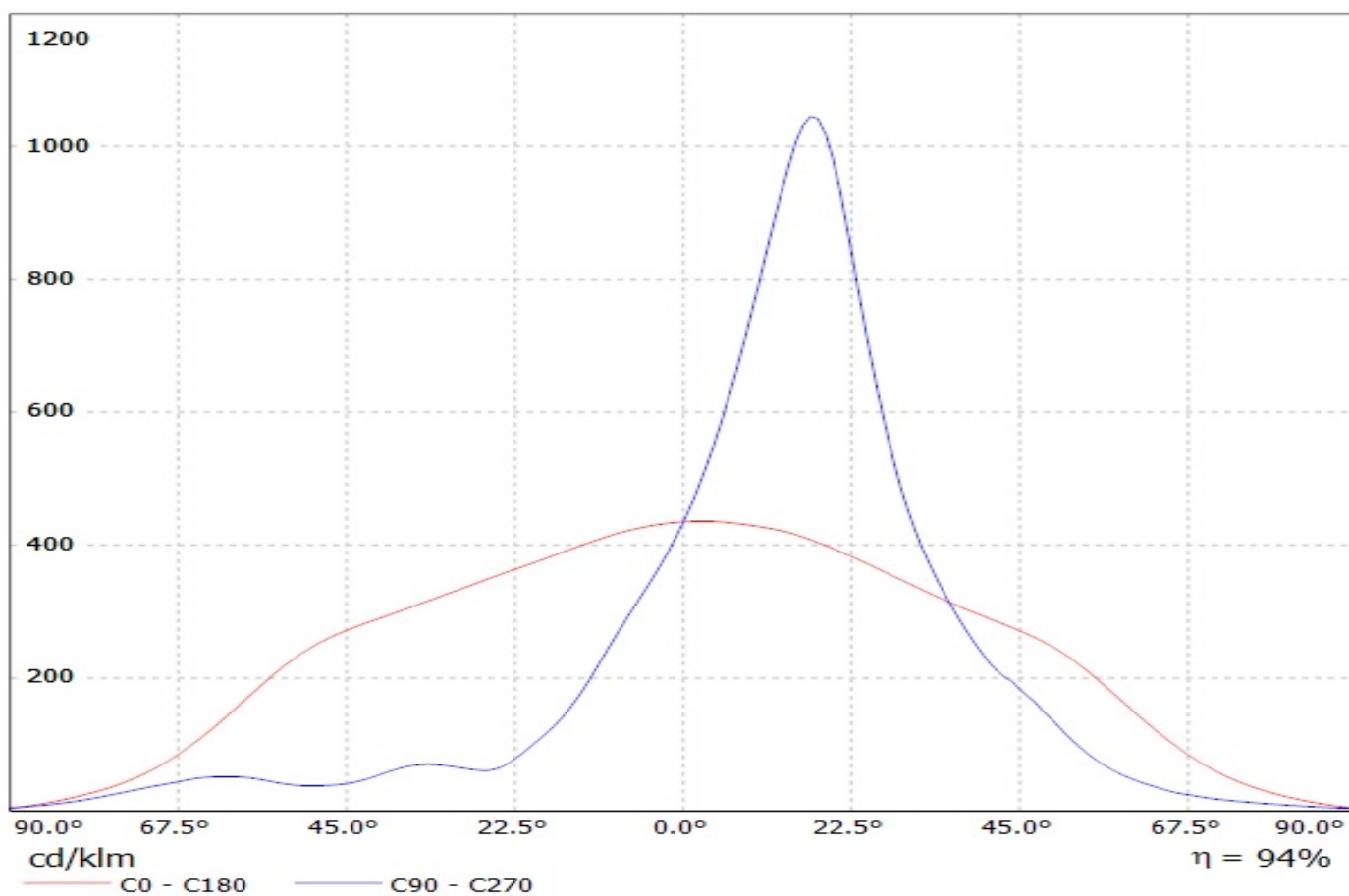

**Ledil F14344\_FLORENCE-1R-ZT25\_(Seoul\_3030) / LDC (Linear)**

Luminaire: Ledil F14344\_FLORENCE-1R-ZT25\_(Seoul\_3030)

Lamps: 1 x Seoul\_3030\_x11\_(STW8C2SA)\_785.296lm@100mA\_P=6.5W\_I=0.1A

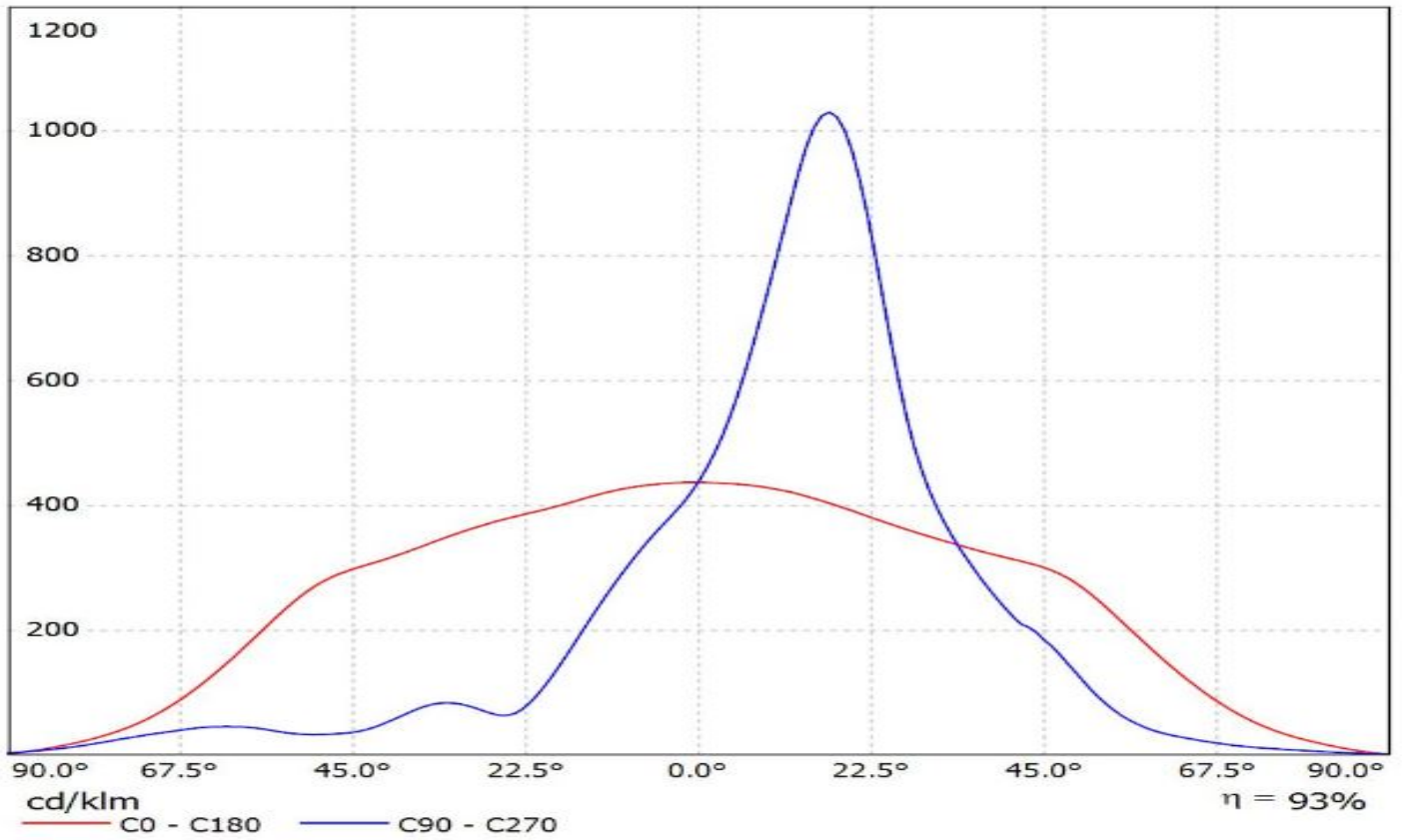



# Ledil F14344\_FLORENCE-1R-ZT25\_(Luxeon\_3030\_2D) / LDC (Linear)

Luminaire: Ledil F14344\_FLORENCE-1R-ZT25\_(Luxeon\_3030\_2D)

Lamps: 1 x Luxeon\_3030\_2D\_x22\_(L130-4080003000W21)

\_1601.44lm@200mA\_CCT=4000K\_P=12.8W\_I=0.2A

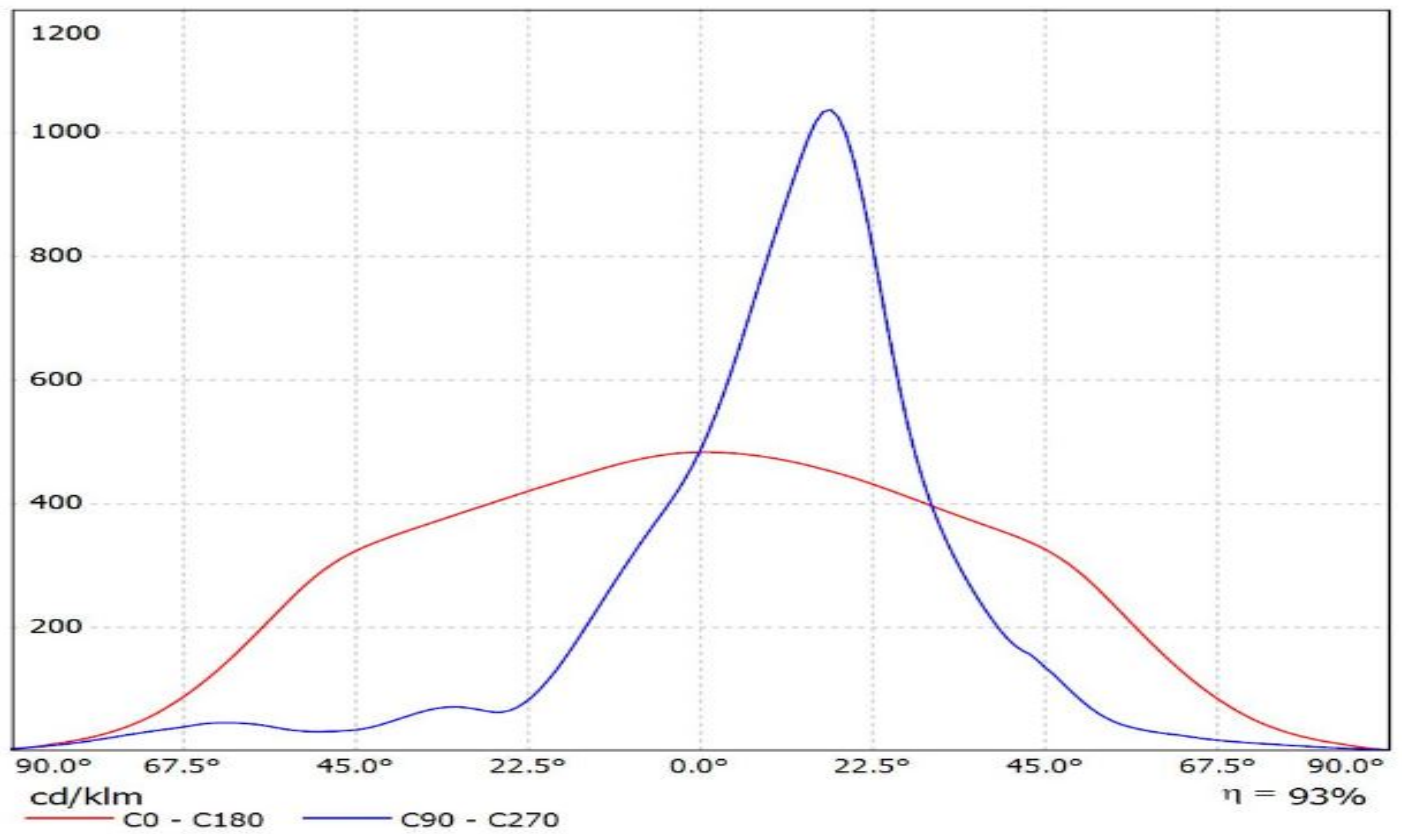

Luminaire: LEDiL Oy F14344\_FLORENCE-1R-ZT25\_1

Lamps: 1 x FORTIMO-1R\_PCB\_1063.12lm@250mA\_P=8.02029W\_I=249.9mA

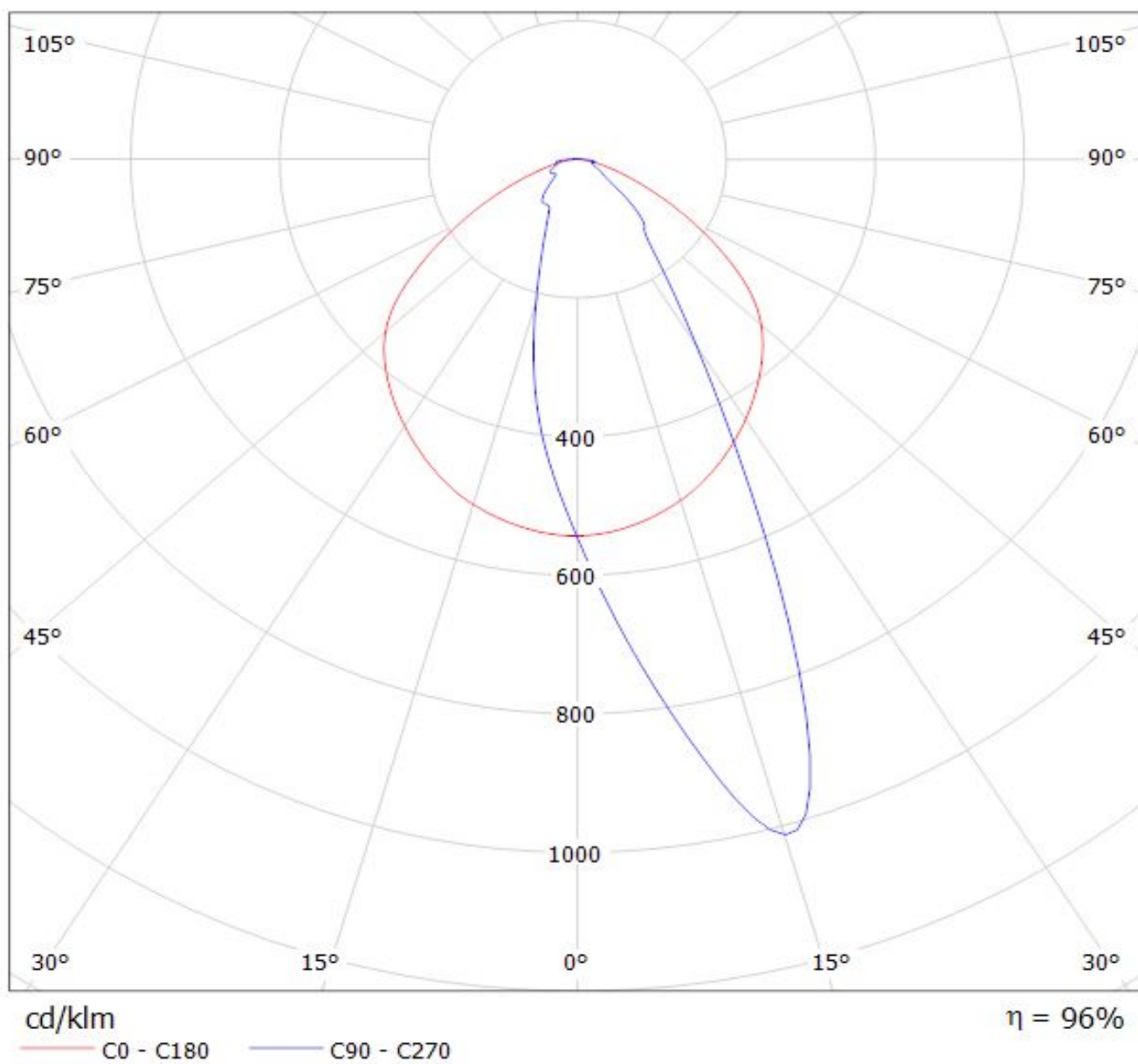

# Ledil F14344\_FLORENCE-1R-ZT25\_(Duris\_S5) / LDC (Polar)

Luminaire: Ledil F14344\_FLORENCE-1R-ZT25\_(Duris\_S5)

Lamps: 1 x Osram\_Duris\_S5\_x11\_(GW\_PSLRS1.EC-LQLS-5H7I-1)

\_1016.86lm@100mA\_P=8W\_I=0.1000A

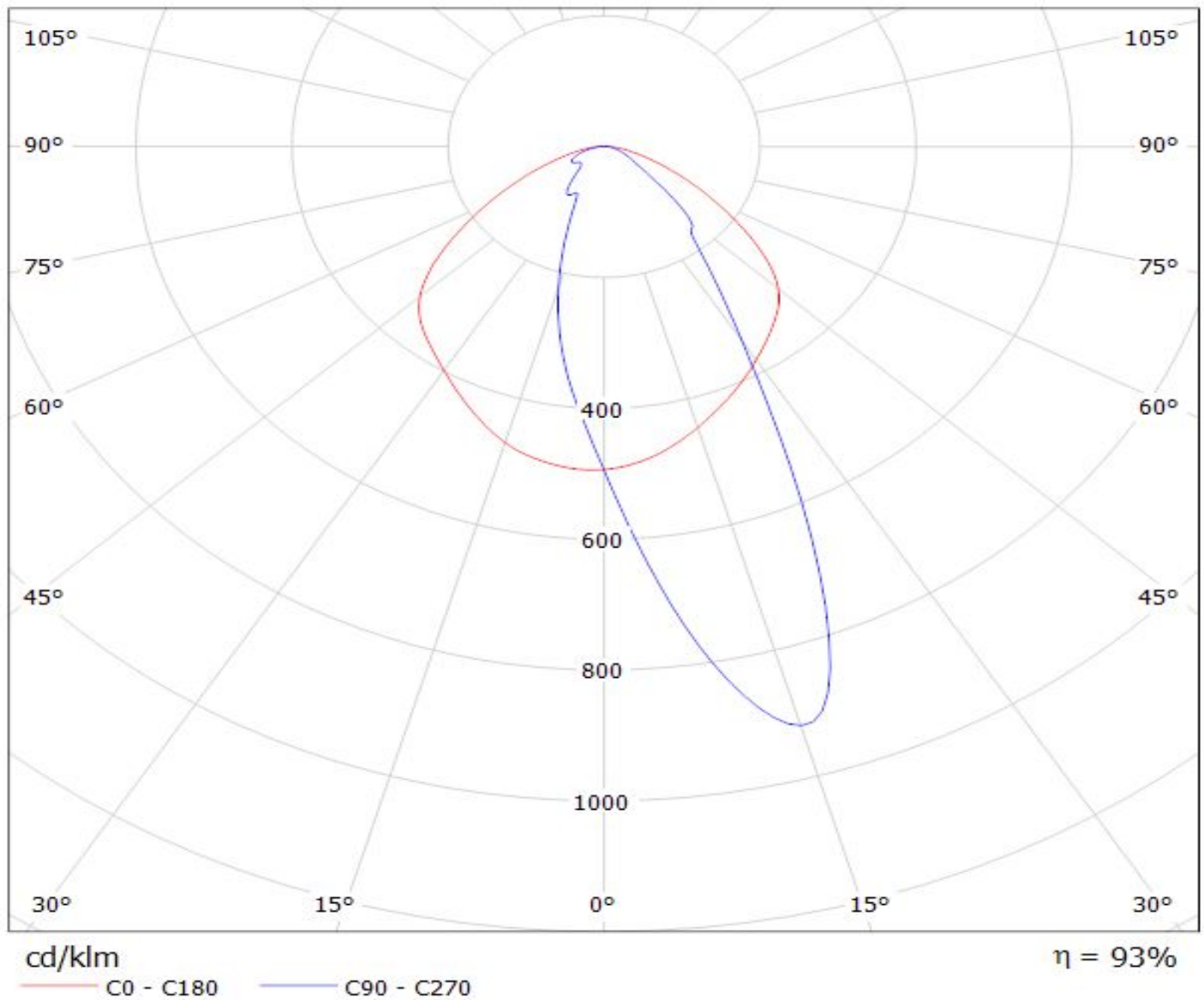

# Ledil F14344\_FLORENCE-1R-ZT25\_(NF2x757D) / LDC (Polar)

Luminaire: Ledil F14344\_FLORENCE-1R-ZT25\_(NF2x757D)

Lamps: 1 x Nichia\_NF2x757D\_2chip\_x22 (NF2W757DRT)\_2050.6lm@200mA\_P=12.95W\_I=0.2A

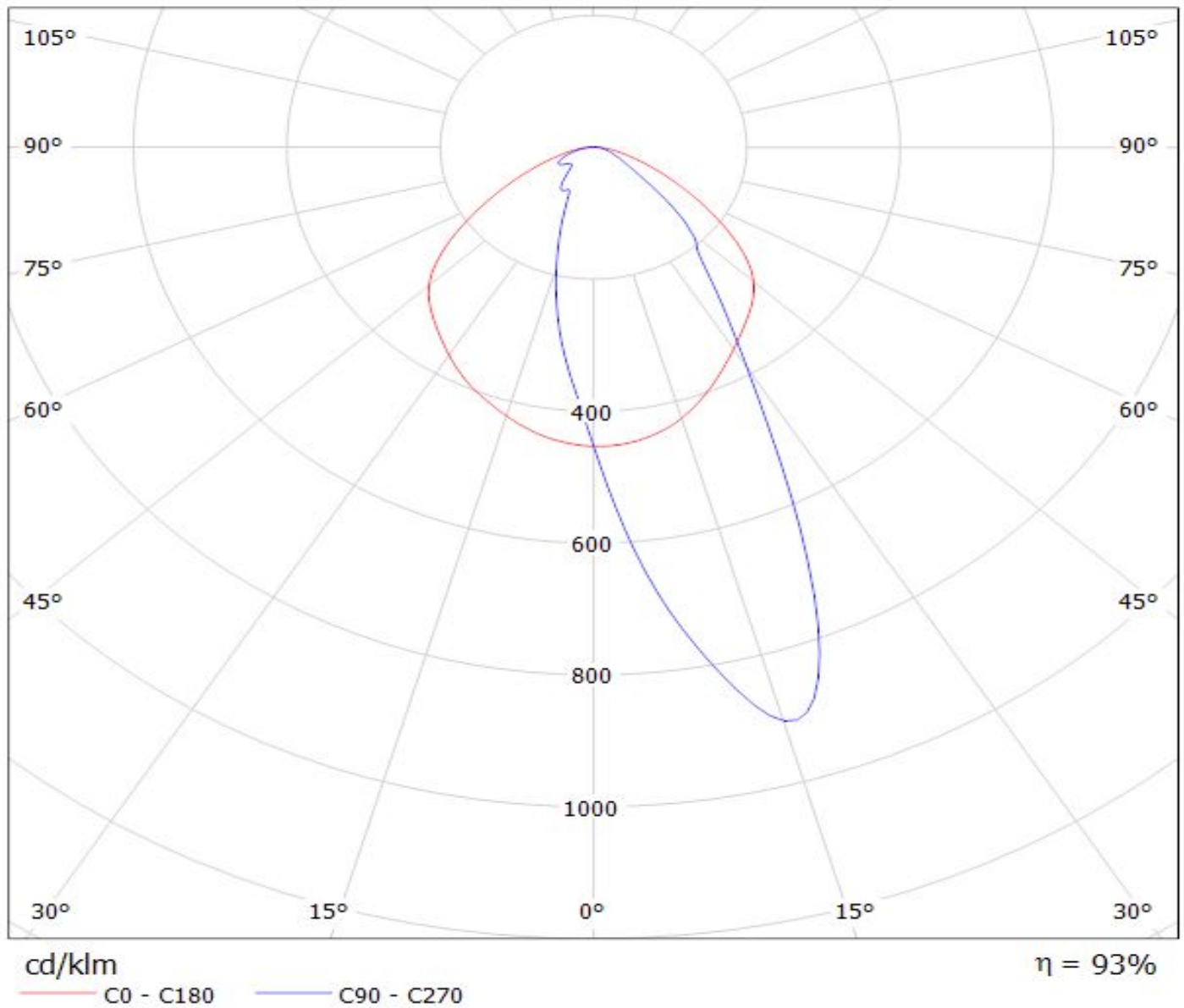

Luminaire: LEDiL Oy F14344\_FLORENCE-1R-ZT25\_(LM302A)

Lamps: 1 x Samsung\_LM302A\_865.46lm@100mA\_P=6.64694W\_I=0.1001A

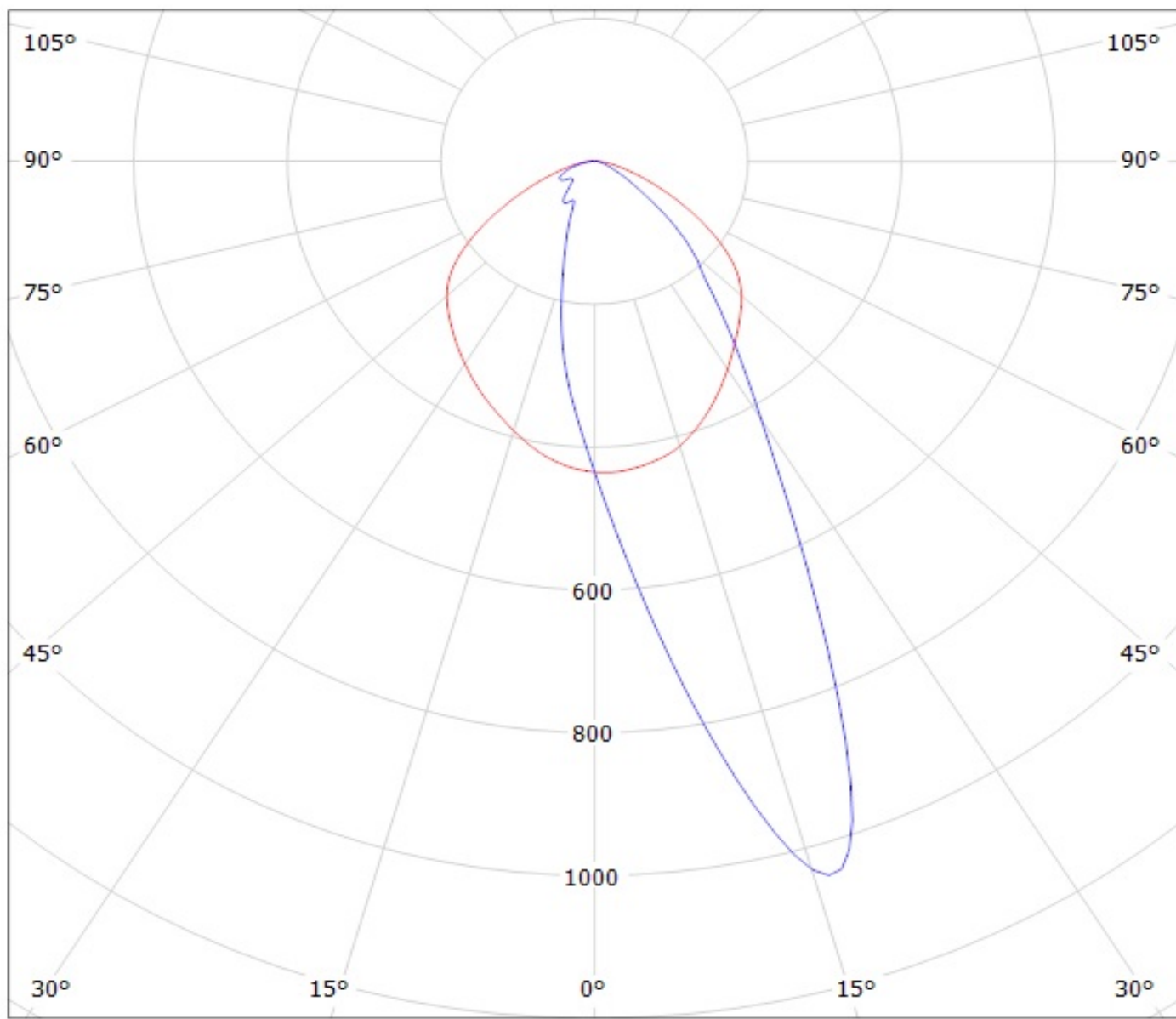

cd/klm

— C0 - C180

— C90 - C270

$\eta = 94\%$

# Ledil F14344\_FLORENCE-1R-ZT25\_(Seoul\_3030) / LDC (Polar)

Luminaire: Ledil F14344\_FLORENCE-1R-ZT25\_(Seoul\_3030)

Lamps: 1 x Seoul\_3030\_x11\_(STW8C2SA)\_785.296lm@100mA\_P=6.5W\_I=0.1A

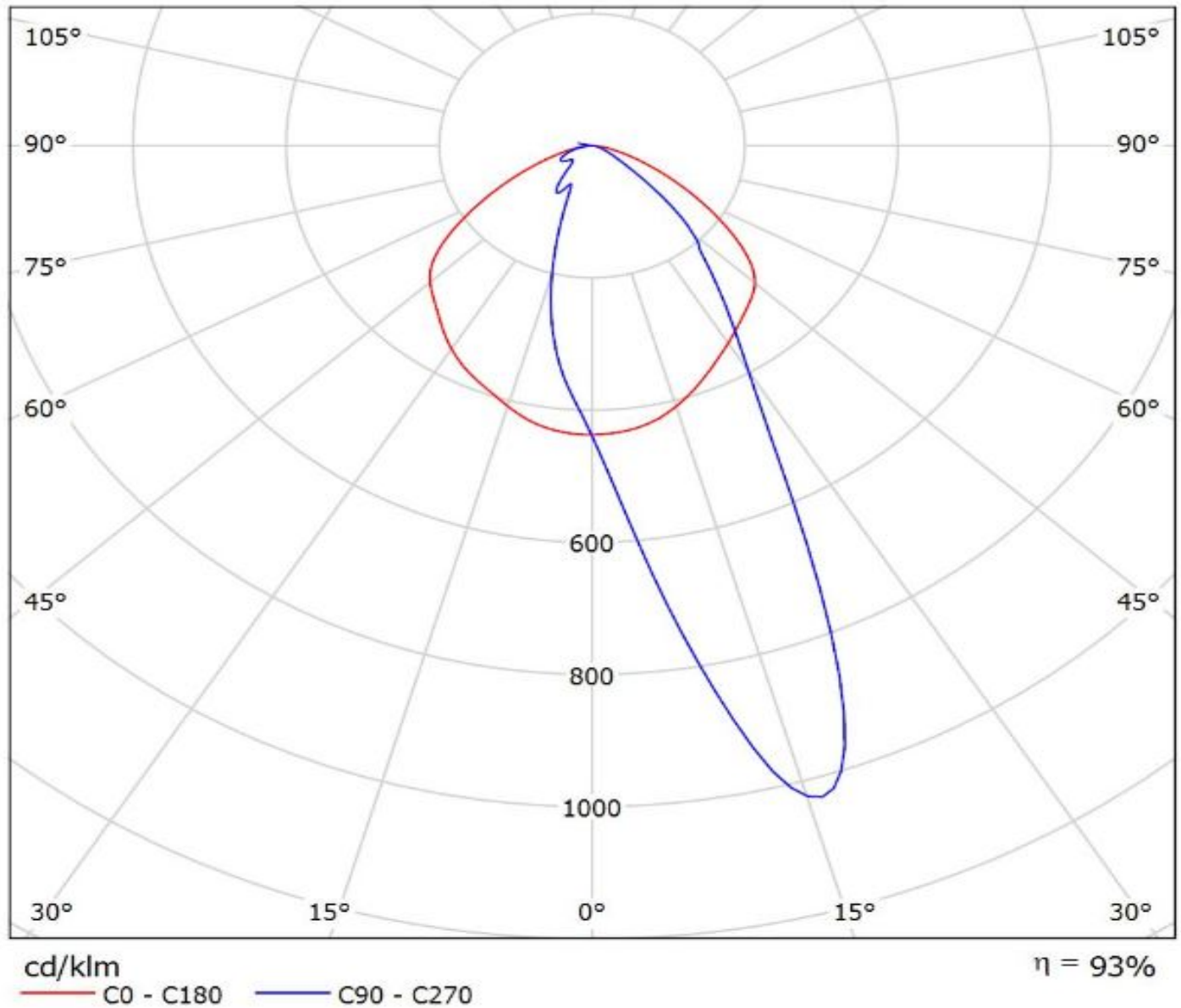

# Ledil F14344\_FLORENCE-1R-ZT25\_(Luminus\_MP-2016) / LDC (Polar)

Luminaire: Ledil F14344\_FLORENCE-1R-ZT25\_(Luminus\_MP-2016)

Lamps: 1 x Luminus\_MP-2016\_1x22\_(LUMMP-1100-30-80)\_471.904lm@120mA\_P=4W\_I=0.12A

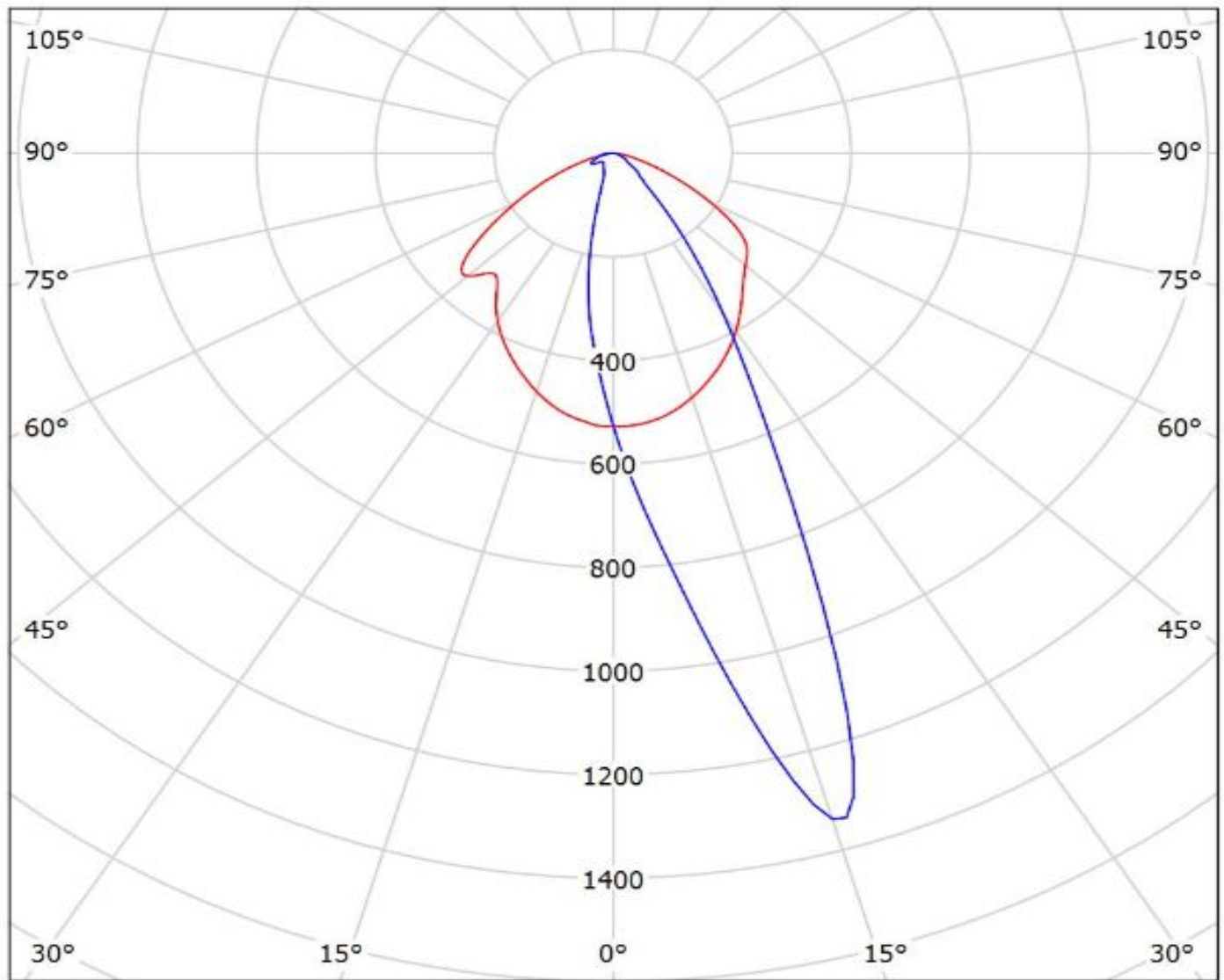

cd/klm

— C0 - C180 — C90 - C270

$\eta = 94\%$

# Ledil F14344\_FLORENCE-1R-ZT25\_(Luxeon\_3030\_2D) / LDC (Polar)

Luminaire: Ledil F14344\_FLORENCE-1R-ZT25\_(Luxeon\_3030\_2D)  
Lamps: 1 x Luxeon\_3030\_2D\_x22\_(L130-4080003000W21)  
\_1601.44lm@200mA\_CCT=4000K\_P=12.8W\_I=0.2A

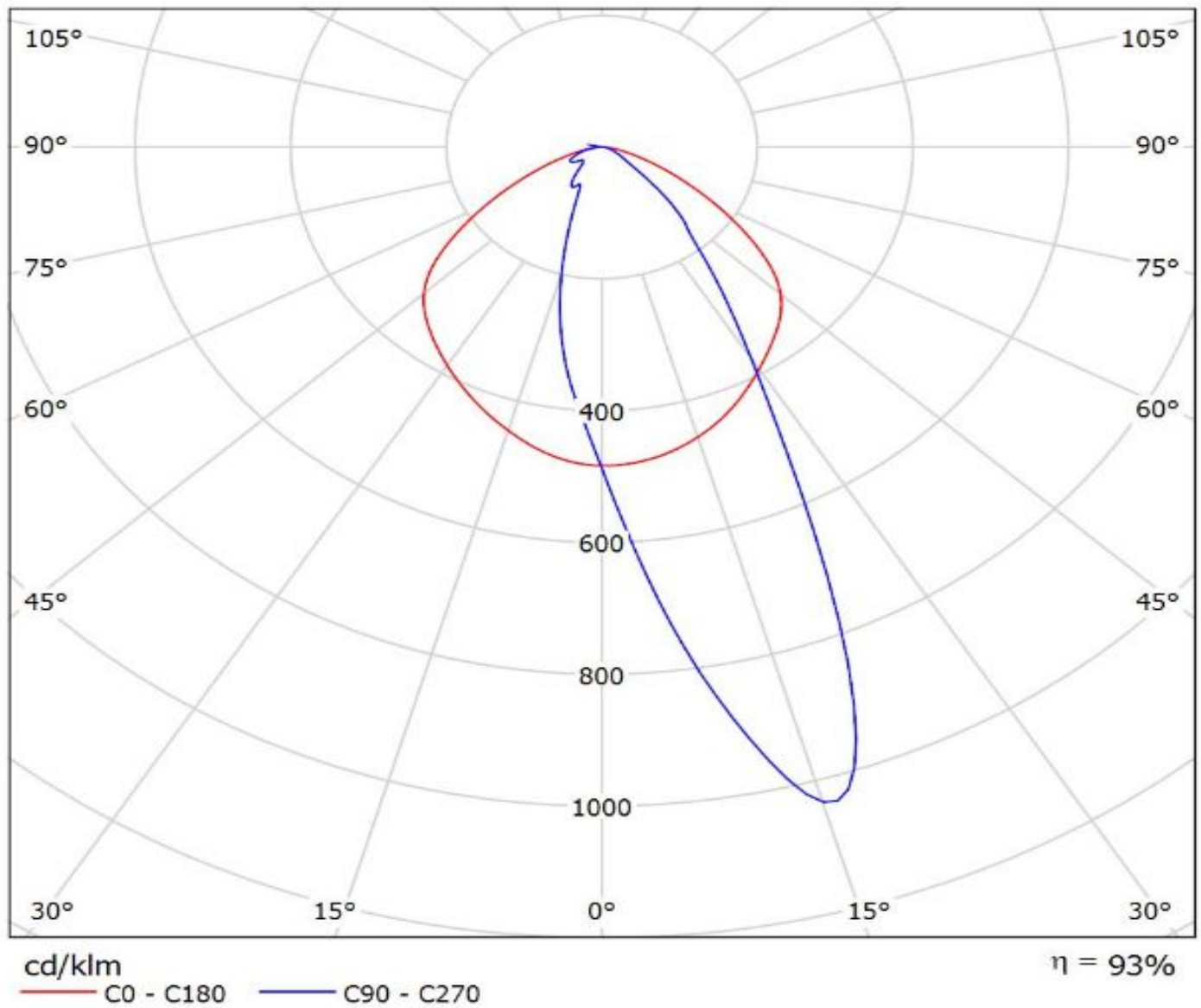

**NOTE: The typical divergence will be changed by different color, chip size and chip position tolerance. The typical total divergence is the full angle measured where the luminous intensity is half of the peak value.**

### **GENERAL INFORMATION**

- Product series especially designed & optimized for series of LEDs.
- Special care taken to make light distribution as uniform as possible.
- Fastening to PCB with appropriate adhesive. By clicking link below you can find Ledil recommended glue options.  
[http://www.ledil.com/datasheets/DataSheet\\_GLUES.pdf](http://www.ledil.com/datasheets/DataSheet_GLUES.pdf)

**NOTE 1: We advise customer to ensure the suitability and sufficiency of the bond in the end product. For example, mechanical stress, vibration and holes on the surface of the circuit board weaken the strength of the glue.**

**NOTE 2: All surfaces where glue is applied must be clean, dry and free from grease and dirt. If cleaning of PCB surfaces is needed, please follow strictly the cleaning instructions of your LED manufacturer -this is important as cleaning shall under no circumstances damage LEDs or other electronics components on the PCB.**

**Further note that optical components shall not be cleaned with any chemicals - only micro fiber cloth may be used to remove fingerprints or other traces from handling.**