

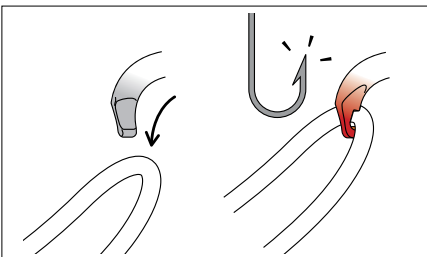

Hydrokarst, Voreppe, Isère France © Lafouche

To meet the many different needs encountered in the field, there exists a wide selection of connectors. Each product is designed for a specific use based on its materials, shape, size, gate-opening capacity and locking system.



Keylock system

To ensure optimal efficiency, all Petzl carabiners use the Keylock system: the body/gate interface does not have a hook that could snag on anchors, ropes, harness equipment loops, etc..



Visual unlocked indicator

To facilitate equipment checks, SCREW-LOCK manual locking carabiners have a red band that is visible only when the carabiner is not locked.

Shapes



Oval shape

Versatile symmetrical shape specially adapted for devices with widely-spaced side plates (FIXE pulley, ASCENSION rope clamps, etc.).



D-shape

Asymmetrical shape allows easy connection and good positioning of the device along the major axis.

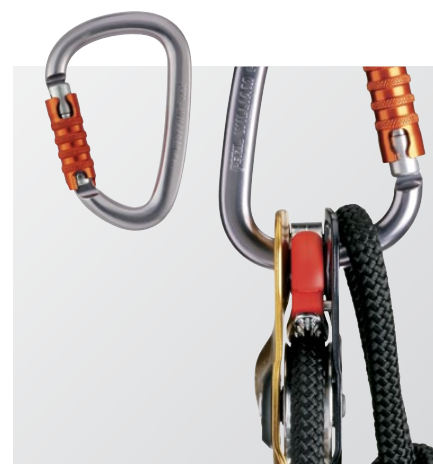

Pear shape

Asymmetrical shape has a wide opening and great capacity.

Locking systems

For occasional manipulation: manual locking

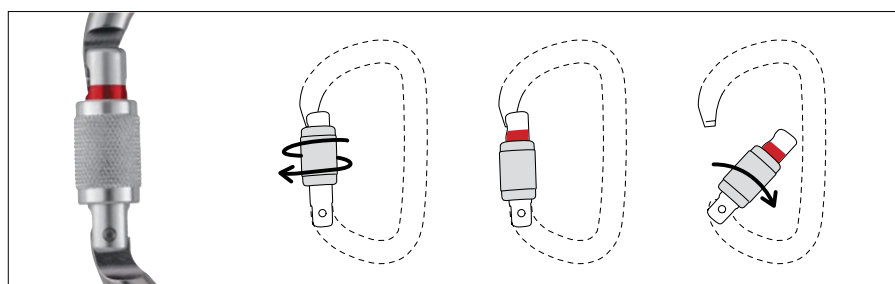

SCREW-LOCK

Manual screw gate locking system

- The red band provides a visual warning when the carabiner is unlocked
- Recommended for harsh environments (mud, ice), where dust and dirt could cause an automatic locking mechanism to malfunction
- Recommended when a carabiner needs to be opened and closed occasionally

For frequent manipulation: automatic locking

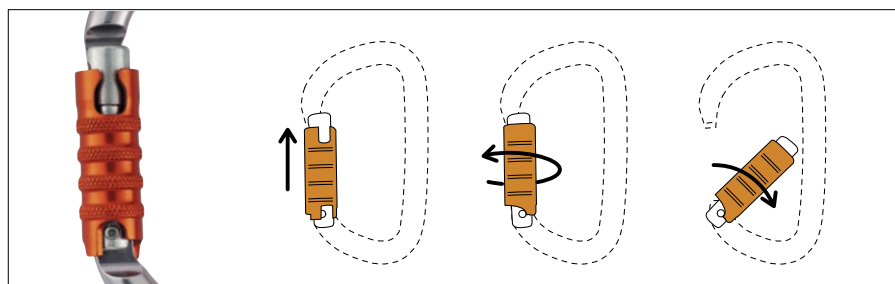

TRIACT-LOCK

Auto-locking system

- Unlocks quickly in two steps, by raising and then turning the sleeve
- Recommended when a carabiner needs to be frequently opened and closed

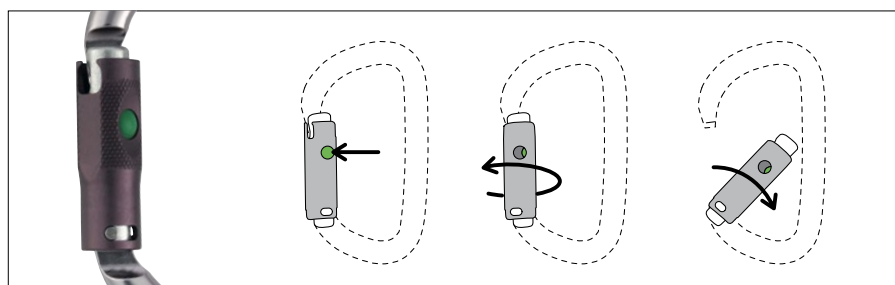

BALL-LOCK

Auto-locking system with lock indicator

- Green dot indicates when sleeve is locked
- Quick to unlock in two steps, by pressing on the green dot and turning the sleeve
- Can be opened and closed with one hand
- Recommended when a carabiner needs to be frequently opened and closed

Aluminum carabiners

Lightweight carabiners with an optimal weight-to-strength ratio, designed for the worker at height.



WILLIAM



Am'D



OK

Steel carabiners

Carabiners suitable for difficult environments, primarily used for setting up anchors and for connecting to metal structures.

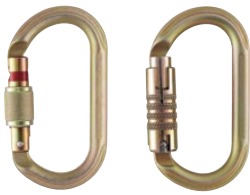

OXAN

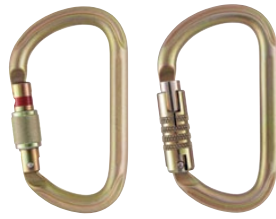

VULCAN

Large connectors

Connectors with a wide gate opening designed for connecting to thick structures.



MGO 110



MGO 60

Special aluminum carabiners

Lightweight carabiners designed for specific uses: harness fastening, use at the end of a lanyard, additional braking on a descender, etc..



OMNI

NEW
2014



VERTIGO TWIST-LOCK



FREINO



SPIRIT

Quick links

Screw links for semi-permanent connection of equipment.



DELTA



GO



DEMI ROND



WILLIAM SCREW-LOCK



Am'D SCREW-LOCK



OK SCREW-LOCK



WILLIAM TRIACT-LOCK



Am'D TRIACT-LOCK



OK TRIACT-LOCK



WILLIAM BALL-LOCK



Am'D BALL-LOCK

WILLIAM

Large capacity aluminum carabiner

- Large size and opening to allow easy anchoring of several ropes and slings
- Wide pear shape facilitates belaying with a Munter hitch
- Keylock system helps prevent snagging of the carabiner during maneuvers
- Red indicator provides a visual warning when the carabiner is unlocked (on SCREW-LOCK version)
- Available in three different locking systems:
 - WILLIAM (M36 SL): SCREW-LOCK
 - WILLIAM (M36 TL): TRIACT-LOCK
 - WILLIAM (M36 BL): BALL-LOCK
- Also available in black:
 - WILLIAM (M36 SLN): SCREW-LOCK black
 - WILLIAM (M36 TLN): TRIACT-LOCK black

Am'D

Asymmetrical aluminum carabiner

- Specially adapted for attaching equipment
- Excellent strength-to-weight ratio
- Keylock system helps prevent snagging of the carabiner during maneuvers
- Red indicator provides a visual warning when the carabiner is unlocked (on SCREW-LOCK version)
- Available in three different locking systems:
 - Am'D (M34 SL): SCREW-LOCK
 - Am'D (M34 TL): TRIACT-LOCK
 - Am'D (M34 BL): BALL-LOCK
- Also available in black:
 - Am'D (M34 TLN): TRIACT-LOCK black

OK

Oval aluminum carabiner

- Versatile oval symmetric shape for optimal positioning of equipment (pulleys, ascenders, mobile fall arresters, etc.)
- Ideal for hauling
- Keylock system helps prevent snagging of the carabiner during maneuvers
- Red indicator provides a visual warning when the carabiner is unlocked (on SCREW-LOCK version)
- Two locking systems available:
 - OK (M33 SL): SCREW-LOCK
 - OK (M33 TL): TRIACT-LOCK
- Also available in black:
 - OK (M33 SLN): SCREW-LOCK black
 - OK (M33 TLN): TRIACT-LOCK black

HARNESSES

HELMETS

LANYARDS AND ENERGY ABSORBERS

MOBILE FALL ARRESTERS

CONNECTORS

DESCENDERS

ASCENDERS

PULLEYS

ANCHORS AND ROPES

PACKS AND ACCESSORIES



OXAN SCREW-LOCK



VULCAN SCREW-LOCK



OXAN TRIACT-LOCK



VULCAN TRIACT-LOCK



MGO 110



MGO 60

OXAN

Oval steel carabiner

- Steel adapted to difficult use conditions
- Keylock system helps prevent snagging of the carabiner during maneuvers
- Red indicator provides a visual warning when the carabiner is unlocked (on SCREW-LOCK version)
- Two locking systems available:
 - OXAN (**M72 SL**): SCREW-LOCK
 - OXAN (**M72 TL**): TRIACT-LOCK
- Also available in black and in specific versions that meet European and North American work standards (see summary table):
 - OXAN (**M72 SLN**): SCREW-LOCK black
 - OXAN (**M72 TLA**): TRIACT-LOCK (European and North American work standards)
 - OXAN (**M72 TLN**): TRIACT-LOCK black (European and North American work standards)

VULCAN

High-strength steel carabiner

- Steel adapted to difficult use conditions
- For use with heavy loads
- Large size allows easier connection of multiple elements
- Wide opening for connection to thick anchors
- Keylock system helps prevent snagging of the carabiner during maneuvers
- Red indicator provides a visual warning when the carabiner is unlocked (on SCREW-LOCK version)
- Two locking systems available:
 - VULCAN (**M73 SL**): SCREW-LOCK
 - VULCAN (**M73 TL**): TRIACT-LOCK
- Also available in black and in specific versions that meet European and North American work standards (see summary table):
 - VULCAN (**M73 SLN**): SCREW-LOCK black
 - VULCAN (**M73 TLA**): TRIACT-LOCK (European and North American work standards)
 - VULCAN (**M73 TLN**): TRIACT-LOCK black (European and North American work standards)

MGO

Very large automatic locking directional connector

- Designed for connection to metallic structures or to large-diameter cables and bars
- Ergonomic unlocking handle
- Available in two versions:
 - MGO (**MGO 110**): 110 mm gate opening
 - MGO (**MGO 60**): 60 mm gate opening



OMNI SCREW-LOCK

NEW
2014



VERTIGO TWIST-LOCK

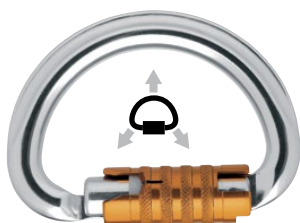

OMNI TRIACT-LOCK



FREINO



SPIRIT



DELTA (P11-8)



DELTA (P11-8B)



DELTA (P11)



GO



DEMI ROND

OMNI

Multi-directional semi-circle carabiner

- Multi-directional carabiner for:
 - fastening the NEWTON and FALCON ASCENT harnesses by joining the two attachment points
 - connecting a fall arrest system (NEWTON) or a CROLL ventral rope clamp (FALCON ASCENT)
- Strength: 15 kN (in all directions)
- Keylock system helps prevent snagging of the carabiner during maneuvers
- Red indicator provides a visual warning when the carabiner is unlocked (on SCREW-LOCK version)
- Two locking systems available:
 - OMNI (M37 SL): SCREW-LOCK
 - OMNI (M37 TL): TRIACT-LOCK
- Also available in black:
 - OMNI (M37 SLN): SCREW-LOCK black
 - OMNI (M37 TLN): TRIACT-LOCK black

VERTIGO

TWIST-LOCK M40A RLA

Carabiner for progression lanyard

Complete description of the VERTIGO TWIST-LOCK carabiner on page 76.

FREINO M42

Carabiner with friction spur for descenders

- The spur helps increase the friction for improved control of the descent of a heavy load (e.g. two-person rescues)
- Rope is easily inserted into the spur, without opening the carabiner
- TWIST-LOCK automatic locking sleeve, unlocked by a simple rotation
- Keylock system helps prevent snagging of the carabiner during maneuvers
- Used, for example, with the I'D and RIG self-braking descenders

SPIRIT M53 S

Non-locking progression carabiner

- Should be used only for progression using climbing techniques
- Non-locking, clips easily
- Keylock system helps prevent snagging of the carabiner during maneuvers

DELTA

Triangular steel quick link

- When closed with a wrench, it becomes a semi-permanent anchor ring
- Available in three versions:
 - DELTA (P11): 10 mm diameter rod stock
 - DELTA (P11 8): 8 mm diameter rod stock
 - DELTA (P11 8B): 8 mm diameter rod stock (with bar for positioning the CROLL on a harness)
- Also available in black version: DELTA (P11 8BN)

GO P15

Oval steel quick link

- When closed with a wrench, it becomes a semi-permanent anchor ring

DEMI ROND P18

Semi-circle aluminum alloy quick link

- Used to close any harness having two attachment points that must be joined with a connector
- When closed with a wrench, it becomes a semi-permanent anchor ring

HARNESSES

HELMETS

LANYARDS AND
ENERGY ABSORBERS

MOBILE FALL
ARRESTERS

CONNECTORS



DESCENDERS

ASCENDERS

PULLEYS

ANCHORS AND
ROPES

PACKS AND
ACCESSORIES

	Locking system	Reference					Certification(s)	Weight
Aluminum carabiners								
WILLIAM	SCREW-LOCK	M36 SL / SLN	25 mm	25 kN	7 kN	7 kN	CE EN 362	90 g
	TRIACT-LOCK	M36 TL / TLN	24 mm					
	BALL-LOCK	M36 BL	24 mm					
Am'D	SCREW-LOCK	M34 SL	21 mm	28 kN	7 kN	8 kN	CE EN 362	75 g
	TRIACT-LOCK	M34 TL	21 mm					
	BALL-LOCK	M34 BL	22 mm					
OK	SCREW-LOCK	M33 SL / SLN	19 mm	24 kN	10 kN	7 kN	CE EN 362	75 g
	TRIACT-LOCK	M33 TL / TLN	19 mm		8 kN			
Steel carabiners								
OXAN	SCREW-LOCK	M72 SL / SLN	20 mm	27 kN	16 kN	7 kN	CE EN 362 NFPA 1983 Technical Use	195 g
	TRIACT-LOCK (European standards)	M72 TL	19 mm					215 g
	TRIACT-LOCK (North American and European standards)	M72 TLA / TLN	18 mm				CE EN 362 ANSI Z359.1 NFPA 1983, Technical Use CSA Z259.12	235 g
VULCAN	SCREW-LOCK	M73 SL / SLN	29 mm	40 kN	16 kN	11 kN	CE EN 362 NFPA 1983, General Use	265 g
	TRIACT-LOCK (European standards)	M73 TL	28 mm					285 g
	TRIACT-LOCK (North American and European standards)	M73 TLA / TLN	27 mm				CE EN 362 ANSI Z359.1 NFPA 1983, General Use CSA Z259.12	305 g
Large connectors								
MGO	Automatic	MGO60	60 mm	25 kN	-	-	CE EN 362	455 g
		MGO110	110 mm	23 kN	15 kN	7 kN	CE EN 362	940 g
Special aluminum carabiners								
OMNI	SCREW-LOCK	M37 SL / SLN	22 mm	20 kN	15 kN	7 kN	CE EN 362	85 g
	TRIACT-LOCK	M37 TL / TLN	22 mm					90 g
FREINO	TWIST-LOCK	M42	15 mm	25 kN	10 kN	9 kN	CE EN 362	85 g
SPIRIT	-	M53 S	21 mm	23 kN	8 kN	9 kN	CE EN 12275 type B	39 g
Quick links								
DELTA	Quick link	P11	12 mm	25 kN	10 kN	-	CE EN 362 type Q	150 g
		P11-8 / P11-8B	10 mm	25 kN	10 kN	-	CE EN 362 type Q	85 / 95 g
GO	Quick link	P15	16 mm	25 kN	10 kN	-	CE EN 362 type Q	60 g
DEMI ROND	Quick link	P18	10 mm	25 kN	10 kN	-	CE EN 362 type Q	55 g

Carabiners are the key element in the belay chain that is part of all vertical activities. This is why it is essential to understand their different uses and limitations. A carabiner is very strong when it is loaded along its major axis.



A carabiner may become weaker under certain conditions:

- if it is not loaded along its major axis (figures 1 and 2)
- if the gate is open (figure 3)
- if it is subjected to external pressure (figure 4)

1	2	3	4
Solutions: Put a STRING on the lanyard	Use a three-directional carabiner	Lengthen or shorten the sling	Lengthen or shorten the sling

Always keep an eye on your carabiners

Which connector should be used with the NEWTON?

<p>The connector to use with the NEWTON harness depends on the attachment point used for connecting the fall arrest system.</p> <p>NEWTON</p>	<p>Use of sternal attachment point The connector acts as a connection point and is loaded along three axes. Use the OMNI type EN 362 locking three-directional connector.</p> <p>OK!</p> <p>NO!</p>	<p>Use of dorsal attachment point The connector acts only to fasten the harness and is loaded along the major axis. You can use an OK type EN 362 locking connector. Warning: Only the dorsal attachment points may be used to connect the fall arrest system.</p> <p>OK!</p>
---	--	--